



Field Book: _____ Page: _____

F (EAST QUARTER CORNER)

Field Book: 2 Page: 33

A (NORTHWEST CORNER)

Field Book: _____ Page: _____

G (SOUTHWEST CORNER)

Field Book: 17 Page: 32

B (NORTH QUARTER CORNER)

Field Book: 14 Page: 9

H (SOUTH QUARTER CORNER)

Field Book: _____ Page: _____

C (NORTHEAST CORNER)

Field Book: 2 Page: 33 UPDATED 14 R 10

I (SOUTHEAST CORNER)

Field Book: 2 Page: 62
 UPDATED 9/29/16 D R MOYER

D (WEST QUARTER CORNER)

Field Book: _____ Page: _____

ADDITIONAL NOTES

[illegible]

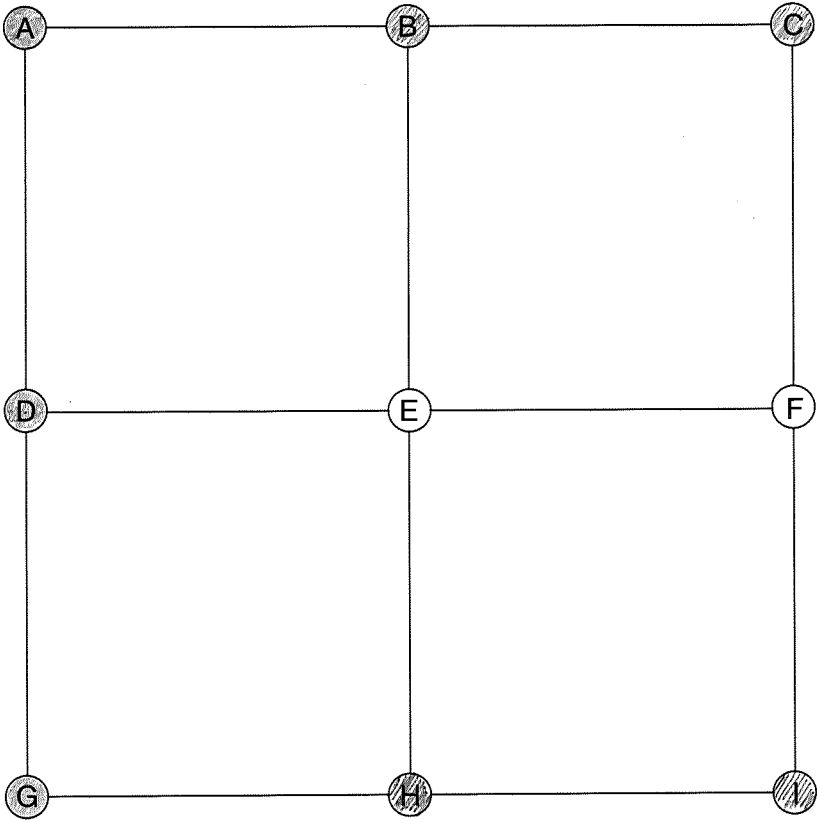

E (CENTER OF SECTION)

Date Located: _____
By: _____
Monument Description: _____
Monument Witnesses: _____

Field Book: _____ Page: _____

F (EAST QUARTER CORNER)

Date Located: _____
By: _____
Monument Description: _____
Monument Witnesses: _____

Field Book: _____ Page: _____

A (NORTHWEST CORNER)

Date Located: 5/15/19
By: SEM MWH
Monument Description: SEE PAGE 361 "C"
Monument Witnesses: NE COR. 21-31-5

Field Book: 14 Page: 10

G (SOUTHWEST CORNER)

Date Located: _____
By: _____
Monument Description: RR SPIKE WITH MAG NAIL OVER
Monument Witnesses: SEE PAGE 361 "I"
SE COR. 21-31-5

Field Book: 2 Page: 62 UPDATED 9/29/16

B (NORTH QUARTER CORNER)

Date Located: 9/26/19
By: DR MOYER MWH HUFFMAN
Monument Description: FO MAG NAIL
Monument Witnesses: NAIL IN B. CAP POWER POLE NW 48.95'
4" RR RAIL FCP N 20.26'
1/2" REBAR W/CAP SW 30.83'

Field Book: 17 Page: 55

H (SOUTH QUARTER CORNER)

Date Located: 9/29/16
By: SEM
Monument Description: 3/4" I. PIPE WITH MAG NAIL INSIDE
Monument Witnesses: SEE Pg 367 "B"

Field Book: 5 Page: 8

C (NORTHEAST CORNER)

Date Located: 9/26/19
By: SEM MWH
Monument Description: MAG NAIL
Monument Witnesses: NAIL IN B. CAP NIPSCO POLE NW 46.73'
NAIL IN B. CAP NIPSCO POLE NE 27.80'
NAIL IN B. CAP NIPSCO POLE SE 47.11'

Field Book: 15 Page: 56

I (SOUTHEAST CORNER)

Date Located: 7/13/16
By: SEM
Monument Description: FO RR SPIKE
Monument Witnesses: SEE Pg 367 "C"

Field Book: 3 Page: 29

D (WEST QUARTER CORNER)

Date Located: _____
By: _____
Monument Description: _____
Monument Witnesses: SEE PAGE 361 "F"
E 1/4 POST 21-31-5

Field Book: _____ Page: _____

ADDITIONAL NOTES

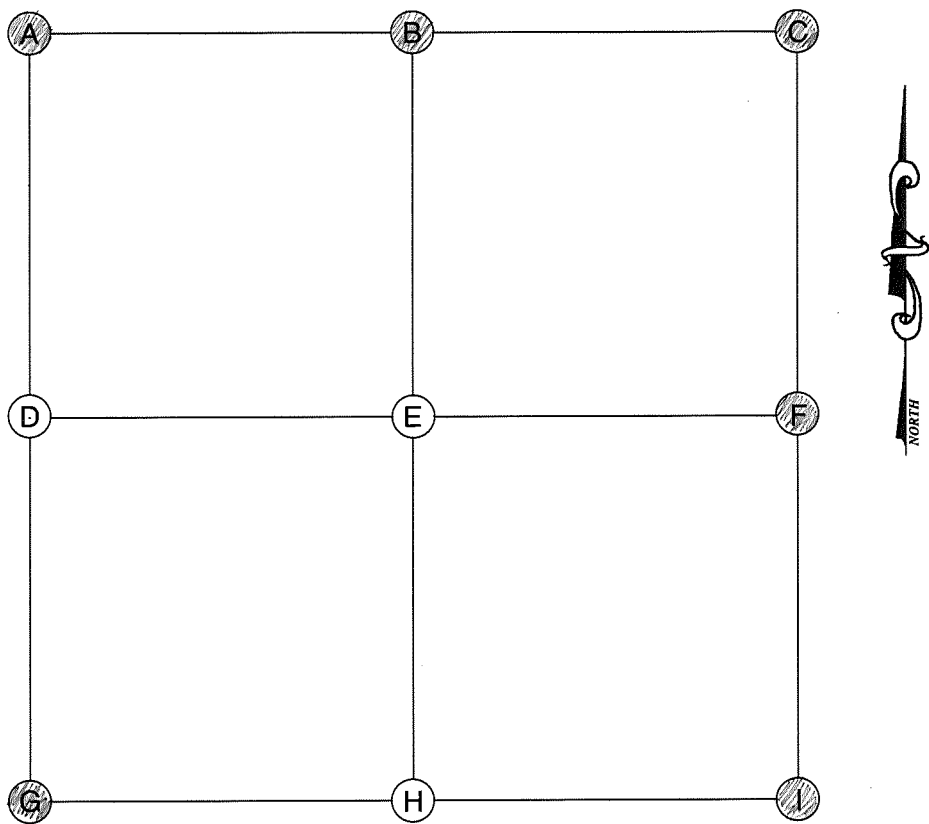

A (NORTHWEST CORNER)

Date Located: 9/26/19
By: SEM MNH
Monument Description: MAG NAIL W/ CO TAG
Monument Witnesses: 1/2" REBAR W/ CAP NE 27.18'
1/2" REBAR W/ CAP SE 46.34'
NAIL IN B. CAP NIPSCO POLE SW 30.79

Field Book: 17 Page: 66

B (NORTH QUARTER CORNER)

Date Located: 9/11/18
By: SEM
Monument Description: MAG NAIL W/ CO TAG
Monument Witnesses: SEE Pg 357 "H"

Field Book: 11 Page: 13

C (NORTHEAST CORNER)

Date Located: 1/30/18
By: SEM
Monument Description: FO RR SPIKE
Monument Witnesses: SEE Pg 19 "A"

Field Book: 8 Page: 56

D (WEST QUARTER CORNER)

Date Located: _____
By: _____
Monument Description: _____
Monument Witnesses: _____

Field Book: _____ Page: _____

E (CENTER OF SECTION)

Date Located: _____
By: _____
Monument Description: _____
Monument Witnesses: _____

Field Book: _____ Page: _____

F (EAST QUARTER CORNER)

Date Located: 1/30/18
By: SEM
Monument Description: MAG NAIL W/ CO TAG
Monument Witnesses: SEE Pg 19 "D"

Field Book: 8 Page: 57

G (SOUTHWEST CORNER)

Date Located: 11/8/17
By: SEM
Monument Description: FO BRONZE / COPPER MONUMENT
Monument Witnesses: SEE Pg 366 "C"

Field Book: 8 Page: 25

H (SOUTH QUARTER CORNER)

Date Located: _____
By: _____
Monument Description: _____
Monument Witnesses: _____

Field Book: _____ Page: _____

I (SOUTHEAST CORNER)

Date Located: 1/30/18
By: SEM
Monument Description: 1/2" REBAR W/ CO CAP
Monument Witnesses: SEE Pg 19 "G"

Field Book: 8 Page: 58

ADDITIONAL NOTES

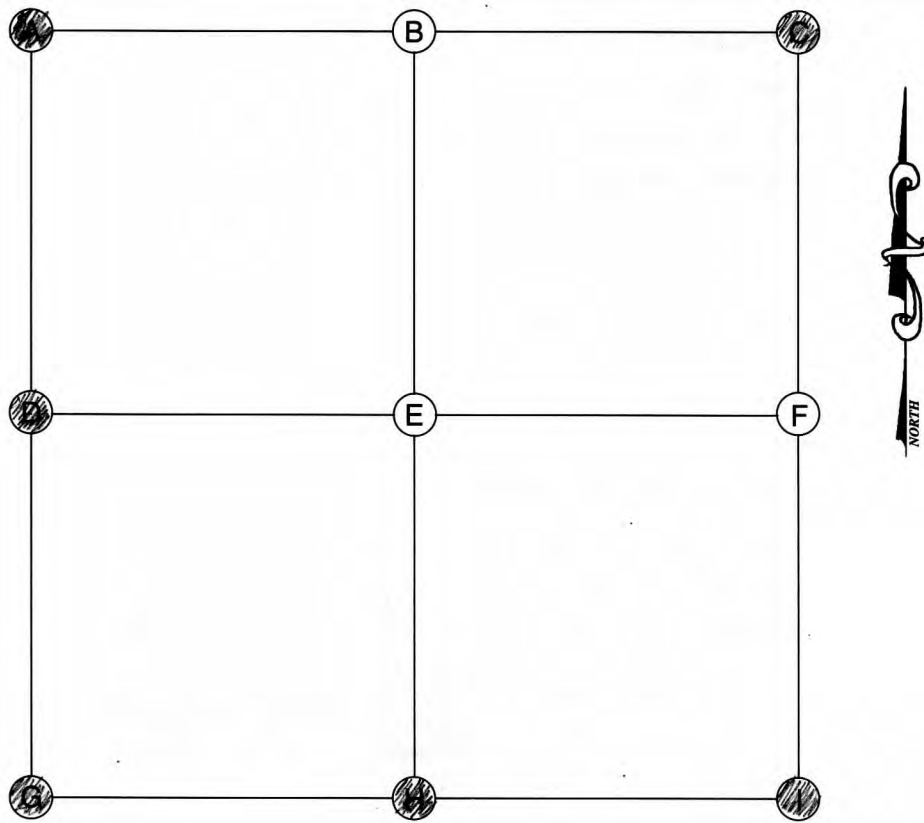

A (NORTHWEST CORNER)

Date Located: 11/8/17
By: SRM
Monument Description: FO BRONZE / COPPER MONUMENT
Monument Witnesses: SEE Pg 366 "C"

Field Book: 8 Page: 25

B (NORTH QUARTER CORNER)

Date Located: _____
By: _____
Monument Description: _____
Monument Witnesses: _____

Field Book: _____ Page: _____

C (NORTHEAST CORNER)

Date Located: 1/30/18
By: SRM
Monument Description: 1/2" REBAR W/CAP
Monument Witnesses: SEE Pg 19 "G"

Field Book: 8 Page: 58

D (WEST QUARTER CORNER)

Date Located: 1/25/18
By: SRM
Monument Description: FO STONE 8" DEEP
Monument Witnesses: SEE Pg 366 "F"

Field Book: 8 Page: 54

E (CENTER OF SECTION)

Date Located: _____
By: _____
Monument Description: _____
Monument Witnesses: _____

Field Book: _____ Page: _____

F (EAST QUARTER CORNER)

Date Located: _____
By: _____
Monument Description: _____
Monument Witnesses: _____

Field Book: _____ Page: _____

G (SOUTHWEST CORNER)

Date Located: 4/13/18
By: MEK & SRM
Monument Description: SET RR SPIKE
Monument Witnesses: NAIL IN B. CAP IN FENCE POST NW 23.53'
1/2" REBAR W/CAP NE 28.28'
1/2" REBAR W/CAP SE 53.88'
1/2" REBAR S 35.32'

Field Book: 9 Page: 34

H (SOUTH QUARTER CORNER)

Date Located: 2/8/18
By: SRM
Monument Description: FO 1/2" PK NAIL REPLACED W RR SPIKE
Monument Witnesses: 4 RR RAIL FCP N 19.95'
NAIL IN B. CAP IN POWER POLE NE 55.54'

Field Book: 8 Page: 64

I (SOUTHEAST CORNER)

Date Located: 2/2/18
By: SRM
Monument Description: FO RR SPIKE 5 1/2" DEEP
Monument Witnesses: 4 RR RAIL FCP N 19.97'
1/2" REBAR W/CAP SE 38.63'
NAIL IN B. CAP IN POWER POLE SSW 67.17'
NAIL IN B. CAP IN POWER POLE WSW 59.09'

Field Book: 8 Page: 63

ADDITIONAL NOTES

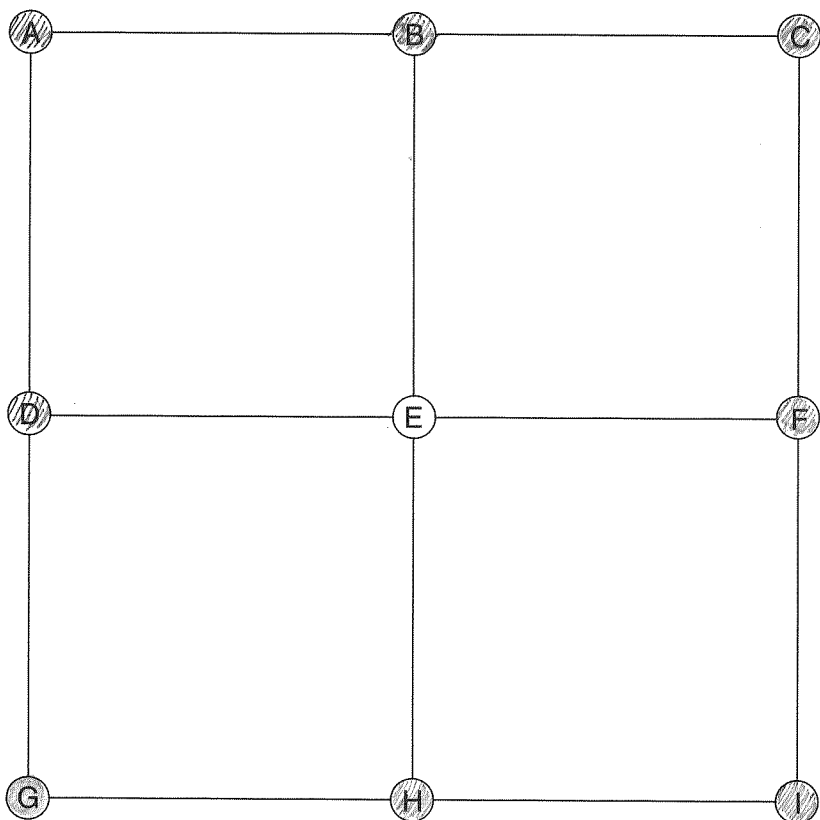

Date Located: _____
By: _____
Monument Description: _____
Monument Witnesses: _____

Field Book: _____ Page: _____

Date Located: 1/25/12
By: SEM
Monument Description: FO STONE 8" DEEP
Monument Witnesses: NAIL IN B. CAP P. POLE NW 31.36'
NAIL IN B. CAP REMC 8777 ENE 19.67'
& RR RAIL FCP E 20.05'
NAIL IN B. CAP REMC POLE 8778 WSW 52.59'

Field Book: 8 Page: 54

Date Located: 7/13/16
By: SEM
Monument Description: FORR SPIKE
Monument Witnesses: SEE Pg 367 "C"

Field Book: 4 Page: 29

Date Located: 5/15/19
By: SEM MWH
Monument Description: 3"x3" CONC MONUMENT
Monument Witnesses: _____

Field Book: 14 Page: 13

Date Located: 10/26/16
By: DEM
Monument Description: FG RR SPIKE 3" DEEP
Monument Witnesses: 4 RR RAIL FCP N 19.5'
1/2" REBAR WITH CAP SE 29.80'
NAIL IN WASHER IN POWER POLE SW 55.00'

Field Book: 5 Page: 21

Date Located: 9/4/19
By: DEM MWH
Monument Description: 2 1/2" DIA IRON PIPE
Monument Witnesses: ± RR RAIL FCP E 40.3'
± RR RAIL FCP S 40.2'

Field Book: 17 Page: 13

Date Located: 11/8/17
By: SEM
Monument Description: FD BRONZE / COPPER MONUMENT 4" DEEP
Monument Witnesses: 1/2" REBAR W/CAP NW 41.54'
1/2" REBAR W/CAP NE 38.93'
NAIL IN B. CAP POWER POLE SSW 64.29'
NAIL IN B. CAP POWER POLE WSW 47.31'

Field Book: 8 Page: 25

Date Located: 4/13/18
By: MEK & JEM
Monument Description: SET R/R SPIKE
Monument Witnesses: NAIL IN B. CAP FCP NW 23.53'
1/2" REBAR W/CAP NE 23.28'
1/2" REBAR W/CAP SE 53.88'
1/2" REBAR S 35.32'

Field Book: 9 Page: 34

Date Located: 7/13/16
By: SRM
Monument Description: FDRR SPIKE
Monument Witnesses: SEE Pg 307 "F"

Field Book: 3 Page: 30

ADDITIONAL NOTES

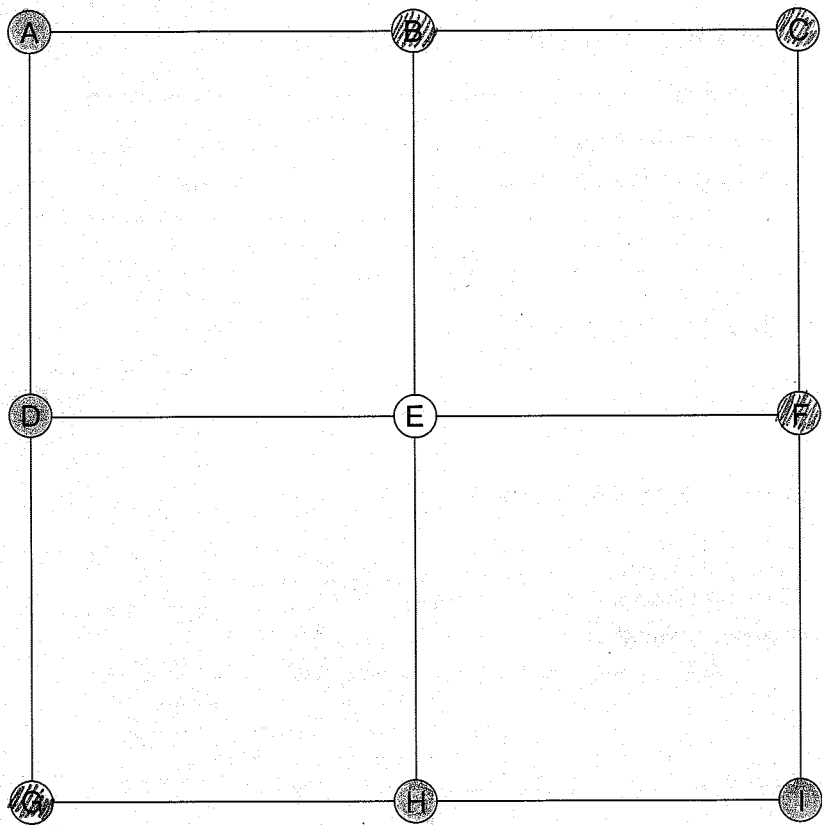

A (NORTHWEST CORNER)

Date Located: _____
By: _____
Monument Description: RR SPIKE WITH MAG NAIL OVER
Monument Witnesses: SEE PAGE 361 "I"
SE COR. 21-31-5

Field Book: 2 Page: 62 UPDATED 9/28/16 SRM

B (NORTH QUARTER CORNER)

Date Located: 9/29/16
By: SRM
Monument Description: 3/4" I. PIPE WITH MAG NAIL INSIDE
Monument Witnesses: NAIL IN B CAP IN REMC POLE N 13.43'
S. FACE OF AN 18" SQ CONC FCP N 16.15'
E RR RAIL FCP S 17.01'
REBAR WITH CAP SW 44.66'

Field Book: 5 Page: 8

C (NORTHEAST CORNER)

Date Located: 7/13/16
By: SRM
Monument Description: FO RR SPIKE 3" DEEP
Monument Witnesses: NAIL IN B CAP IN REMC POLE NW 23.14'
NEAREST EDGE CONC FCP NW 25.7'
2" IRON PIPE FCP NE 24.45'
NAIL IN B CAP IN REMC POLE SE 51.00'

Field Book: 4 Page: 29

D (WEST QUARTER CORNER)

Date Located: _____
By: _____
Monument Description: RR SPIKE
Monument Witnesses: SEE PAGE 368 "F"
E 1/4 POST 28-31-5

Field Book: 2 Page: 62 UPDATED 9/29/16 SRM

E (CENTER OF SECTION)

Date Located: _____
By: _____
Monument Description: _____
Monument Witnesses: _____

Field Book: _____ Page: _____

F (EAST QUARTER CORNER)

Date Located: 7/13/16
By: SRM
Monument Description: FO PK NAIL
Monument Witnesses: FACE 2" SQ CONC FCP W 19.65'
NAIL IN B CAP IN POWER POLE NW 18.73'
2" IRON PIPE FCP E 19.15'
1/2" REBAR WITH CAP 11' FROM E/P SE 25.55'

Field Book: 4 Page: 30

G (SOUTHWEST CORNER)

Date Located: 7/13/16
By: SRM
Monument Description: FO MAG NAIL
Monument Witnesses: NAIL IN B CAP IN P POLE NW 58.55'
CHISELED TRIANGLE DNR TBM KKK 109 NE 53.31'
BRASS TABLET DNR BM KOS 103 SSW 21.46'
NAIL IN B CAP IN P POLE SW 64.95'

Field Book: 4 Page: 31

H (SOUTH QUARTER CORNER)

Date Located: 5/15/19
By: SRM MWH
Monument Description: 6" CONC FCP
Monument Witnesses: _____

Field Book: 14 Page: 12

I (SOUTHEAST CORNER)

Date Located: 6/21/2006 5/15/19 SRM MWH
By: MEL + JA
Monument Description: 4" SQUARE CONC. POST W/ REBAR
(EXPOSED 0.5')
Monument Witnesses: * SEE NOTES BELOW
IRON REBAR W/ PLASTIC WALKER CAP 15.45' WEST
1/2" REBAR W/ PLASTIC CAP 70' SE
FENCE 0.8' NORTH

Field Book: 14 Page: 13

ADDITIONAL NOTES

"I" NOTES: FOUND 1.5" I. PIPE BURIED 0.5'
1/2" REBAR FOUND 0.3' NORTH



Date Located: _____
By: _____
Monument Description: _____
Monument Witnesses: _____

Date Located: 8/27/92
By: J A MOYER - ECHAINES
Monument Description: RA SPIKE
Monument Witnesses:

ment Witnesses: _____
SET NAIL IN BOTTLE CAP IN NE FACE OF REMC PP WNW 16.90
" " " " " " " " " " POWCAP ESE 81.82

Date Located: _____
By: _____
Monument Description: _____
Monument Witnesses: _____

Date Located: 8/27/90
By: J.B. MOYGA-ECHAINES
Monument Description: PK NAIL

Monument Witnesses: CENTER OF A RR RAIL FCP S 23.36
SET NAIL IN BOTTLE CAP IN N. FACE OF PP ESE 77.54

Date Located: _____
By: _____
Monument Description: _____
Monument Witnesses: _____

Date Located: 8/27/92
By: J. A. MOYER-ELCHAINS
Monument Description: PK NAIL

Monument Witnesses: CENTER OF A RR BAIL FCP N 10.11
CENTER OF A RR BAIL FCP \$ 17.89

Date Located: _____
By: _____
Monument Description: RR SPIKE WITH MAG NAIL OVER
Monument Witnesses: SEE PAGE 361 "I"
SE COR. 21-31-5

Date Located: 7/13/16
By: SEM

Monument Description: FO MAG NAIL

Monument Witnesses: SEE Pg 367 "G"

Date Located: _____
By: _____
Monument Description: _____
Monument Witnesses: _____

ADDITIONAL NOTES

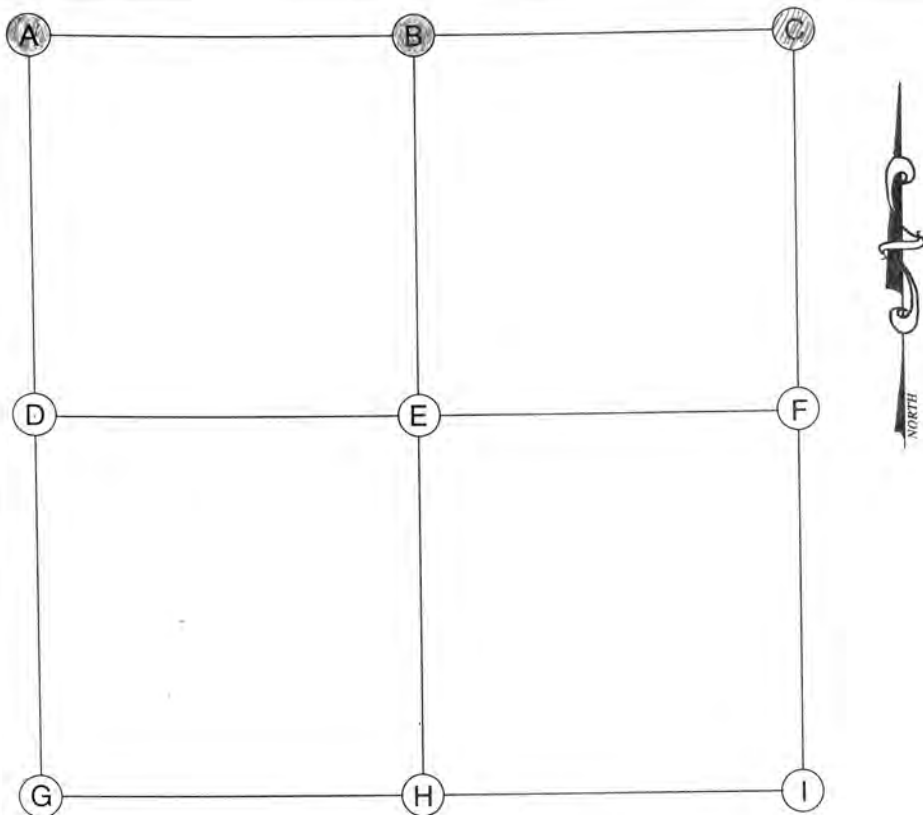

A (NORTHWEST CORNER)

Date Located: _____
By: _____
Monument Description: _____
Monument Witnesses: SEE PAGE 368 "G"
SW cor. EB-315

Field Book: _____ Page: _____

B (NORTH QUARTER CORNER)

Date Located: _____
By: _____
Monument Description: _____
Monument Witnesses: _____ SEE PAGE 368 "H"
S/A Post 207-5-5

Field Book: _____ Page: _____

C (NORTHEAST CORNER)

Date Located: 7/13/16
By: DRM
Monument Description: FO MAG NAIL
Monument Witnesses: SEE Pg 367 "G"

Field Book: 3 Page: 31

D (WEST QUARTER CORNER)

Date Located: _____
By: _____
Monument Description: _____
Monument Witnesses: _____

Field Book: _____ Page: _____

E (CENTER OF SECTION)

Date Located: _____
By: _____
Monument Description: _____
Monument Witnesses: _____

Field Book: _____ Page: _____

F (EAST QUARTER CORNER)

Date Located: _____
By: _____
Monument Description: _____
Monument Witnesses: _____

Field Book: _____ Page: _____

G (SOUTHWEST CORNER)

Date Located: _____
By: _____
Monument Description: _____
Monument Witnesses: _____

Field Book: _____ Page: _____

H (SOUTH QUARTER CORNER)

Date Located: _____
By: _____
Monument Description: _____
Monument Witnesses: _____

Field Book: _____ Page: _____

1 (SOUTHEAST CORNER)

Date Located: _____
By: _____
Monument Description: _____
Monument Witnesses: _____

Field Book: _____ Page: _____

ADDITIONAL NOTES

ಪುನಃಪ್ರಾಪ್ತಿ

6

NG
ON
EM

Seward
34-31-5

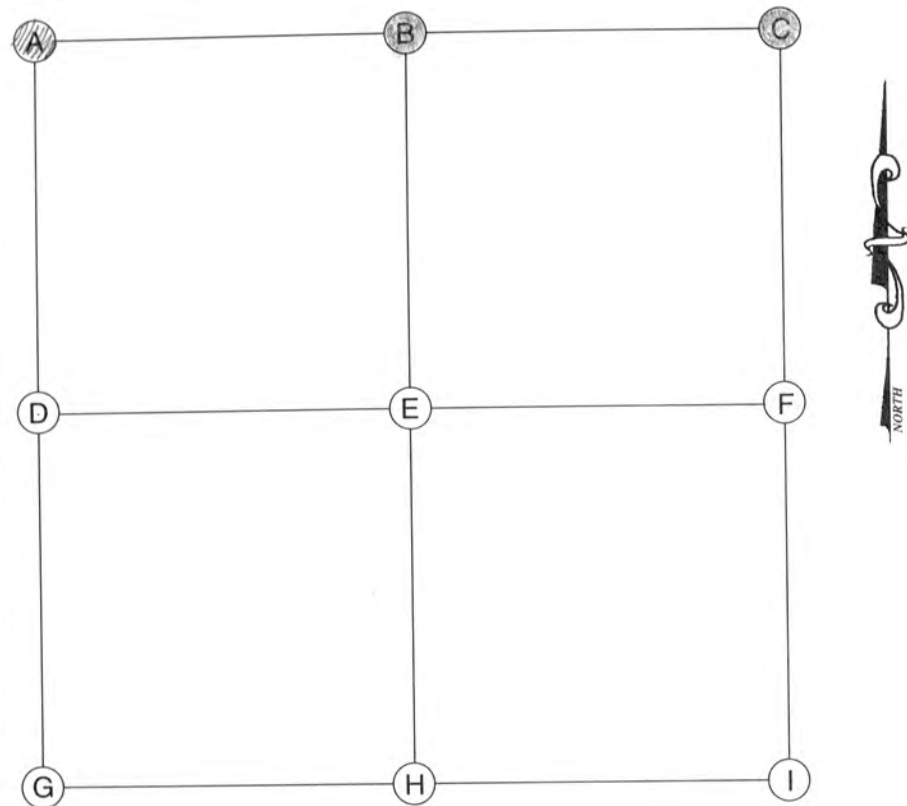

A (NORTHWEST CORNER)

Date Located: 7/13/10
 By: SEM
 Monument Description: FO MAG NAIL
 Monument Witnesses: SEE PG 367 'G'

Field Book: 3 Page: 31

B (NORTH QUARTER CORNER)

Date Located: 6/21/2006
 By: MEK & JA
 Monument Description: CONCRETE FENCE CORNER POST
(GONE FOR 1 MILE)
SEE DEED SURVEY BK 3 PAGE 207

Field Book: _____ Page: _____

C (NORTHEAST CORNER)

Date Located: _____
 By: _____
 Monument Description: _____
 Monument Witnesses: SEE PAGE 367 'I'
SE COR. 27-31-5

Field Book: _____ Page: _____

D (WEST QUARTER CORNER)

Date Located: _____
 By: _____
 Monument Description: _____
 Monument Witnesses: _____

Field Book: _____ Page: _____

E (CENTER OF SECTION)

Date Located: _____
 By: _____
 Monument Description: _____
 Monument Witnesses: _____

Field Book: _____ Page: _____

F (EAST QUARTER CORNER)

Date Located: _____
 By: _____
 Monument Description: _____
 Monument Witnesses: _____

Field Book: _____ Page: _____

G (SOUTHWEST CORNER)

Date Located: _____
 By: _____
 Monument Description: _____
 Monument Witnesses: _____

Field Book: _____ Page: _____

H (SOUTH QUARTER CORNER)

Date Located: _____
 By: _____
 Monument Description: _____
 Monument Witnesses: _____

Field Book: _____ Page: _____

I (SOUTHEAST CORNER)

Date Located: _____
 By: _____
 Monument Description: _____
 Monument Witnesses: _____

Field Book: _____ Page: _____

ADDITIONAL NOTES

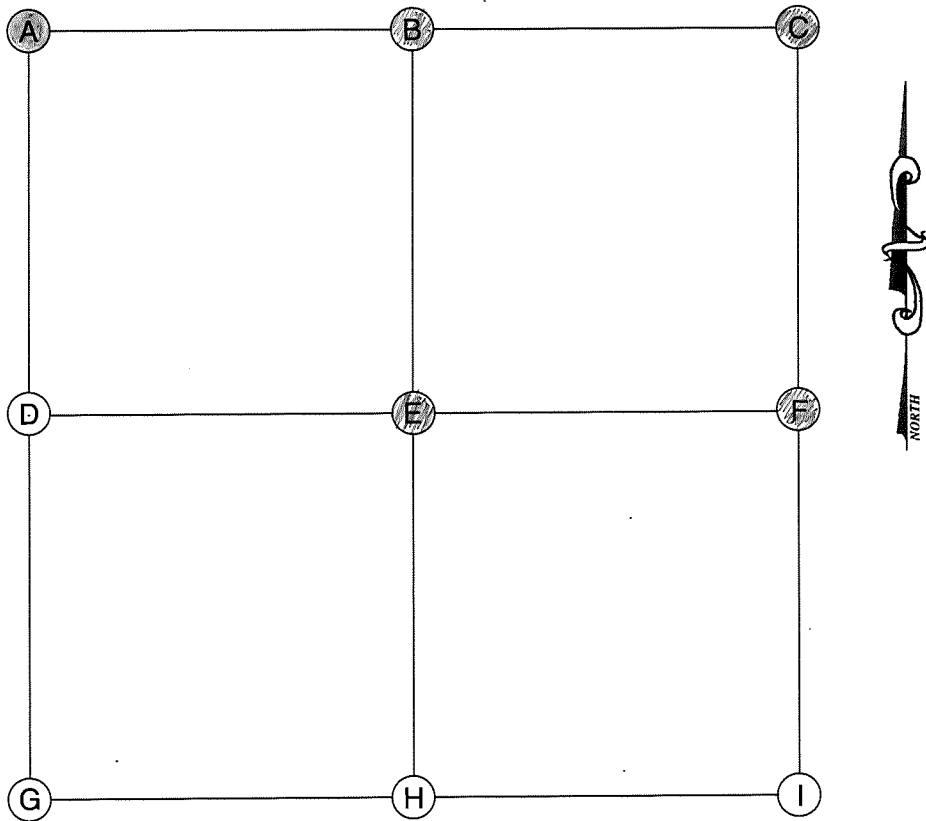

E (CENTER OF SECTION)

Date Located: 7/29/16
By: SEM
Monument Description: RR SPIKE
Monument Witnesses: 1/2" REBAR W/CAP NW 42.44'
& RR RAIL FCP N 20.15'
NAIL IN B. CAP POWER POLE SW 32.80'

Field Book: 16 Page: 18

F (EAST QUARTER CORNER)

Date Located: 12/5/17
By: SEM
Monument Description: MAG NAIL W/ CO TAG
Monument Witnesses: 1/2" REBAR W/CAP NW 43.67'
1/2" REBAR W/CAP NE 38.28'
1/2" REBAR W/CAP SE 34.98'

Field Book: 8 Page: 42

A (NORTHWEST CORNER)

Date Located: _____
By: _____
Monument Description: _____
Monument Witnesses: SEE PAGE 367 "I"
SE COR. 27-31-5

Field Book: _____ Page: _____

G (SOUTHWEST CORNER)

Date Located: _____
By: _____
Monument Description: _____
Monument Witnesses: _____

Field Book: _____ Page: _____

B (NORTH QUARTER CORNER)

Date Located: 9/4/19
By: SEM MWH
Monument Description: 2 1/2" DIA IRON PIPE
Monument Witnesses: SEE Pg 366 "H"

Field Book: 17 Page: 13

H (SOUTH QUARTER CORNER)

Date Located: _____
By: _____
Monument Description: _____
Monument Witnesses: _____

Field Book: _____ Page: _____

C (NORTHEAST CORNER)

Date Located: 4/13/18
By: SEM + MEK
Monument Description: SET RR SPIKE
Monument Witnesses: NAIL IN B. CAP FCP NW 23.53'
1/2" REBAR W/CAP NE 28.28'
1/2" REBAR W/CAP SE 53.88'
1/2" REBAR S 35.32'

Field Book: 9 Page: 34

I (SOUTHEAST CORNER)

Date Located: _____
By: _____
Monument Description: _____
Monument Witnesses: _____

Field Book: _____ Page: _____

D (WEST QUARTER CORNER)

Date Located: _____
By: _____
Monument Description: _____
Monument Witnesses: _____

Field Book: _____ Page: _____

ADDITIONAL NOTES

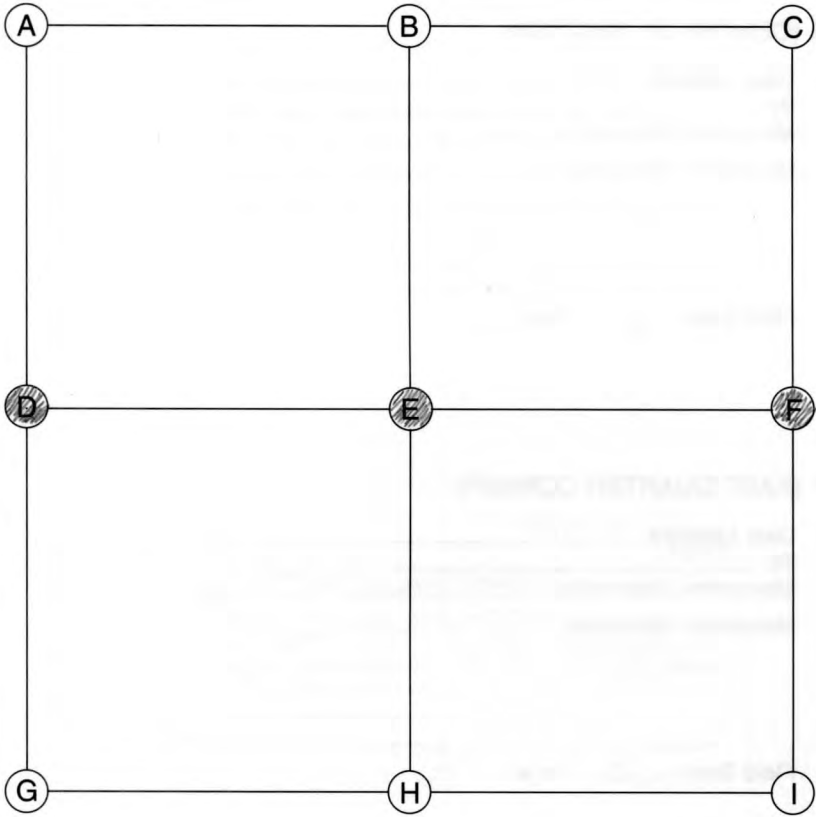

E (CENTER OF SECTION)
Date Located: 11/28/17
By: SRM
Monument Description: MAG NAIL WITH CO TAG
Monument Witnesses: 1/2" REBAR w/CAP NW 25.96'
NAIL IN B. CAP IN POWER POLE NNE 22.64'
1/2" REBAR w/CAP NE 42.35'

Field Book: 8 Page: 38

F (EAST QUARTER CORNER)
Date Located: 11/28/17
By: SRM
Monument Description: MAG NAIL WITH CO TAG
Monument Witnesses: 1/2" REBAR w/CAP NW 27.32'
1/2" REBAR w/CAP NE 36.75'
1/2" REBAR w/CAP SE 17.28'

Field Book: 8 Page: 39

A (NORTHWEST CORNER)
Date Located: _____
By: _____
Monument Description: _____
Monument Witnesses: _____
Field Book: _____ Page: _____

G (SOUTHWEST CORNER)
Date Located: _____
By: _____
Monument Description: _____
Monument Witnesses: _____
Field Book: _____ Page: _____

B (NORTH QUARTER CORNER)
Date Located: _____
By: _____
Monument Description: _____
Monument Witnesses: _____
Field Book: _____ Page: _____

H (SOUTH QUARTER CORNER)
Date Located: _____
By: _____
Monument Description: _____
Monument Witnesses: _____
Field Book: _____ Page: _____

C (NORTHEAST CORNER)
Date Located: _____
By: _____
Monument Description: _____
Monument Witnesses: _____
Field Book: _____ Page: _____

I (SOUTHEAST CORNER)
Date Located: _____
By: _____
Monument Description: _____
Monument Witnesses: _____
Field Book: _____ Page: _____

D (WEST QUARTER CORNER)
Date Located: 12/5/17
By: SRM
Monument Description: MAG NAIL IN CO TAG
Monument Witnesses: 1/2" REBAR w/CAP NW 43.67'
1/2" REBAR w/CAP NE 38.28'
1/2" REBAR w/CAP SE 34.98'

Field Book: 8 Page: 42

ADDITIONAL NOTES