

E (CENTER OF SECTION)

Date Located: 8/13/20
By: SEM MWH
Monument Description: FO 1 1/2" IRON PIN
Monument Witnesses: 1/2" REBAR W/CAP NW 36.23'
1/2" REBAR W/CAP SNE 19.75'
1/2" VALVED" MAG NAIL N 7.68'
Field Book: 19 Page: 19

F (EAST QUARTER CORNER)

Date Located: _____
By: _____
Monument Description: _____
Monument Witnesses: _____
Field Book: _____ Page: _____

G (SOUTHWEST CORNER)

Date Located: 2/12/18
By: SEM
Monument Description: FO RR SPIKE 2" DEEP
Monument Witnesses: 1/2" REBAR W/CAP NW 35.62'
NAIL IN B. CAP POWER POLE N 15.87'
NAIL IN B. CAP POWER POLE SSE 75.18'
Field Book: 8 Page: 66

H (SOUTH QUARTER CORNER)

Date Located: 2/12/18
By: SEM
Monument Description: FO RR SPIKE 2" DEEP
Monument Witnesses: NAIL IN B. CAP POWER POLE WNW 57.87'
NAIL IN B. CAP POWER POLE NNW 62.87'
Field Book: 8 Page: 67

I (SOUTHEAST CORNER)

Date Located: 2/12/18
By: SEM
Monument Description: FO RR SPIKE 2" DEEP
Monument Witnesses: 1/2" REBAR W/CAP NW 47.55'
1/2" REBAR W/CAP 1.5' TO FENCE N 32.46'
FACE 8" X 14" BRIDGE BEAM FCP N 25.8'
Field Book: 8 Page: 68

ADDITIONAL NOTES

A (NORTHWEST CORNER)

Date Located: _____
By: _____
Monument Description: _____
Monument Witnesses: _____
Field Book: _____ Page: _____

B (NORTH QUARTER CORNER)

Date Located: _____
By: _____
Monument Description: _____
Monument Witnesses: _____
Field Book: _____ Page: _____

C (NORTHEAST CORNER)

Date Located: _____
By: _____
Monument Description: _____
Monument Witnesses: _____
Field Book: _____ Page: _____

D (WEST QUARTER CORNER)

Date Located: _____
By: _____
Monument Description: _____
Monument Witnesses: _____
Field Book: _____ Page: _____

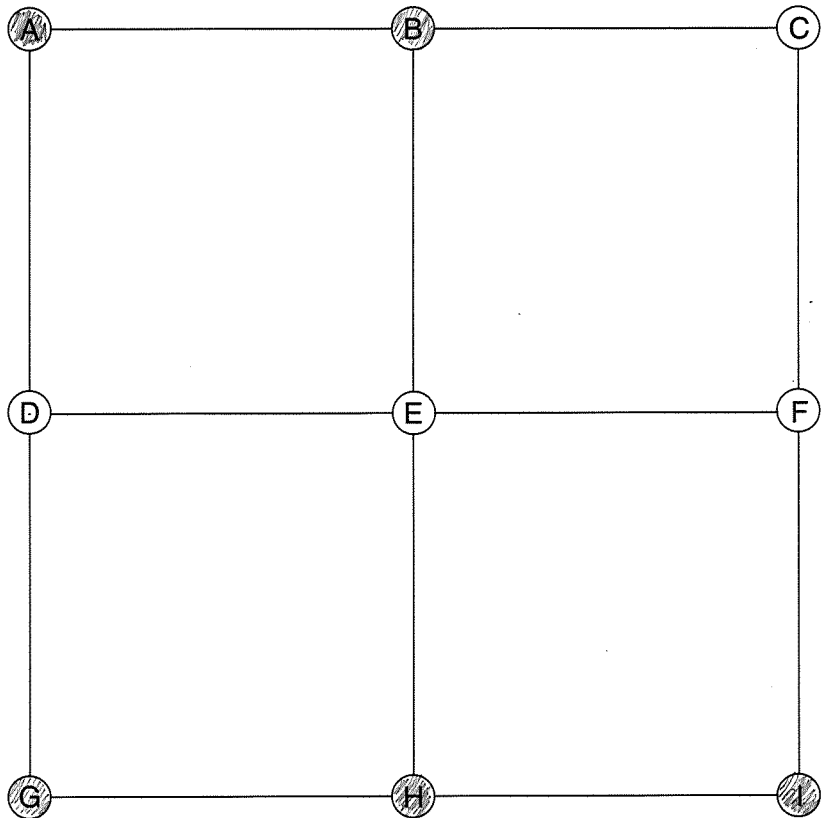

A (NORTHWEST CORNER)

Date Located: 7/25/19
By: SRM MMH
Monument Description: FO 1/2" REBAR
Monument Witnesses: NAIL IN B. CAP P. POLE NW 21.24'
1/2" REBAR W/CAP SE 38.48'
NAIL IN B. CAP POWER POLE SSW 56.41'

Field Book: 16 Page: 16

B (NORTH QUARTER CORNER)

Date Located: 7/25/19
By: SRM MMH
Monument Description: FO 1/2" REBAR
Monument Witnesses: NAIL IN B. CAP P. POLE WSW 55.73'
"WALKER" CAPPED IRON S 25.00'
1/2" REBAR W/CAP SE 33.63'

Field Book: 16 Page: 17

C (NORTHEAST CORNER)

Date Located: _____
By: _____
Monument Description: _____
Monument Witnesses: _____

Field Book: _____ Page: _____

D (WEST QUARTER CORNER)

Date Located: _____
By: _____
Monument Description: _____
Monument Witnesses: _____

Field Book: _____ Page: _____

E (CENTER OF SECTION)

Date Located: _____
By: _____
Monument Description: _____
Monument Witnesses: _____

Field Book: _____ Page: _____

F (EAST QUARTER CORNER)

Date Located: _____
By: _____
Monument Description: _____
Monument Witnesses: _____

Field Book: _____ Page: _____

G (SOUTHWEST CORNER)

Date Located: 5/17/17
By: SRM
Monument Description: FO MAG NAIL
Monument Witnesses: SEE Pg 220 "I"

Field Book: 7 Page: 8

H (SOUTH QUARTER CORNER)

Date Located: 2/12/18
By: SRM
Monument Description: FORR SPIKE
Monument Witnesses: 4 STATE RD 13 N 39.5'
NAIL IN B. CAP POWER POLE ESE 76.24'
1/2" REBAR W/CAP SE 37.81'
NAIL IN B. CAP POWER POLE SW 28.91'
FO 4" CUT IN CONC HOWALL NW 44.80'

Field Book: 8 Page: 65

I (SOUTHEAST CORNER)

Date Located: 2/12/18
By: SRM
Monument Description: FORR SPIKE 2" DEEP
Monument Witnesses: 1/2" REBAR W/CAP NW 35.62'
NAIL IN B. CAP POWER POLE N 15.87'
NAIL IN B. CAP POWER POLE SSE 75.18'

Field Book: 8 Page: 66

ADDITIONAL NOTES

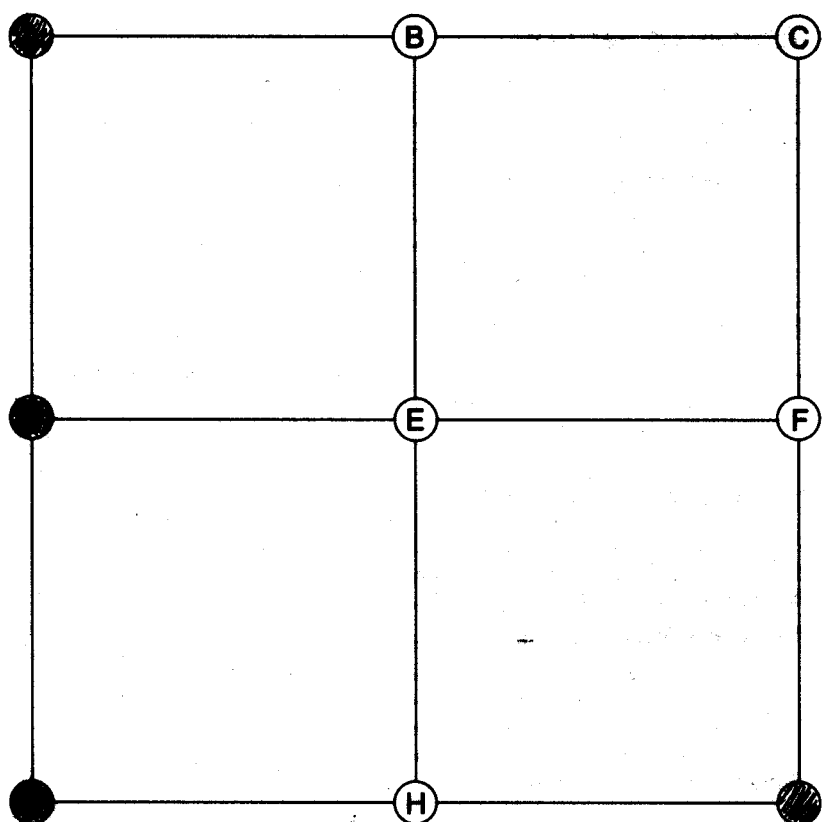

Date Located: _____
By: _____
Monument Description: _____
Monument Witnesses: _____

Field Book: _____ Page: _____

Date Located: _____
By: _____
Monument Description: _____
Monument Witnesses: _____

Field Book: _____ Page: _____

Date Located: _____
By: _____
Monument Description: _____
Monument Witnesses: SEE PAGE 881 "I"
SE 4-31-7

Field Book: _____ Page: _____

Date Located: _____
By: _____
Monument Description: _____
Monument Witnesses: _____

Field Book: _____ Page: _____

Date Located: 5/17/17
By: JEN
Monument Description: FO MAG NAIL
Monument Witnesses: NAIL IN TAG P. POLE NW 70.10'
1/2" REBAR W/ CAP NE 39.46'
4 RR RAIL FCP S 50.14'

Field Book: _____ Page: _____

ADDITIONAL NOTES

Date Located: 1/12/17
By: JRM
Monument Description: FEEDER RAIL FEP 0.3' WEST
Monument Witnesses: SEE Pg 221 "C"

Field Book: 5 Page: 48

Date Located: _____
By: _____
Monument Description: _____
Monument Witnesses: _____

Field Book: _____ Page: _____

Date Located: _____
By: _____
Monument Description: _____
Monument Witnesses: _____

Field Book: _____ Page: _____

Date Located: _____
By: _____
Monument Description: _____
Monument Witnesses: *SEE PAGE 221 "F"*
8/14/74 4-31-7

Field Book: _____ Page: _____

Field Book: 5 Page: 46

Field Book: 2 Page: 58 UPDATED IN FB 5 P. 47

Field Book: 2 Page: 13

Field Book: 2 Page: 15 UPDATED 1/23/17

Field Book: _____ Page: _____

Field Book: 5 Page: 49

Field Book: 5 Page: 48

Field Book: 2 Page: 58 UPDATED 11/3/17

Field Book: 2 Page: 14 (1986 NICKEL C.38' WGR.)
 UPDATED 1/23/17
 NEW TIE: 5/25/06
 RIP 84.17' NE
 1/2" CAPPED REBAR 52.31' NW
 " " " 13.88' SW
 " " " 51.41' SE

ADDITIONAL NOTES

Monroe
5-31-7

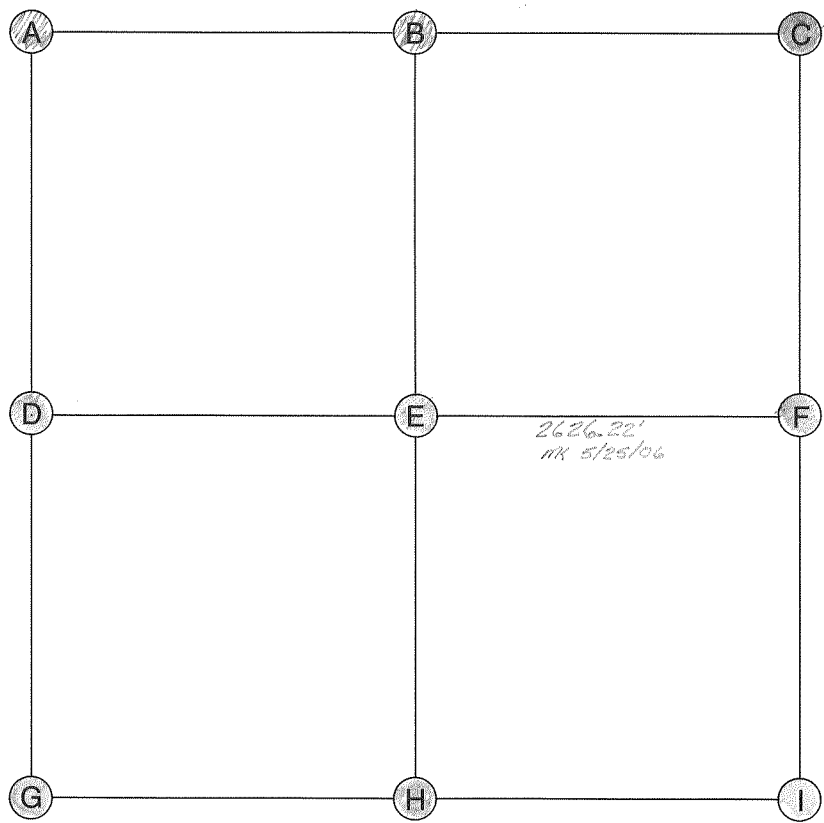

E (CENTER OF SECTION)

Date Located: 11-7-05
By: DKEMPER M KISSINGER
Monument Description: PK NAIL
Monument Witnesses: _____
RIP 19.90' N
" 19.79' S
1/2" CAPPED REBAR 29.77' NW
" " " 23.07' NE

Field Book: 3 Page: 15, 17 6/2006: HARRISON SET
BY MK, MKG
NAIL FOUND
0.4' EAST, REMOVED.

F (EAST QUARTER CORNER)

Date Located: 7/7/21
By: SEM MWH
Monument Description: HARRISON MONUMENT
Monument Witnesses: SEE PAGE 221 "D"
W/VA 4-31-7

Field Book: 20 Page: 35

A (NORTHWEST CORNER)

Date Located: 9/24/18
By: SEM
Monument Description: RR SPIKE
Monument Witnesses: 1/2" REBAR W/CAP SW 50.76'
1/2" RR RAIL FCP S 20.00'
NAIL IN B. CAP IN POWER POLE SE 33.16'

Field Book: 11 Page: 40

G (SOUTHWEST CORNER)

Date Located: 9/24/18
By: SEM
Monument Description: RR SPIKE
Monument Witnesses: 1/2" RR RAIL FCP W 16.42'
NAIL IN B. CAP IN POWER POLE NE 49.02'
NAIL IN B. CAP IN POWER POLE ENE 42.53'

Field Book: 11 Page: 41

B (NORTH QUARTER CORNER)

Date Located: 8/20/20
By: SEM MWH
Monument Description: MAG NAIL W/ CO TAG
Monument Witnesses: 1/2" REBAR W/CAP WSW 34.74'
N FACE RR RAIL FCP S 20.0'
1/2" REBAR W/CAP SE 25.83'

Field Book: 19 Page: 22

H (SOUTH QUARTER CORNER)

Date Located: 7/11/2001 UPDATED 9/24/18 SEM
By: MEX
Monument Description: RR SPIKE
Monument Witnesses: FACE OF RIP 20.92' N. ("OLD TIE" "RIP 20' N")
RIP 21.1' SW
1st FNC POST E. OF N-S ROAD 30.3'

Field Book: 11 Page: 42

C (NORTHEAST CORNER)

Date Located: _____
By: _____
Monument Description: _____
Monument Witnesses: SEE PAGE 221 "A"
NAIL COR SEC 4

Field Book: _____ Page: _____

I (SOUTHEAST CORNER)

Date Located: _____
By: _____
Monument Description: _____
Monument Witnesses: SEE PAGE 221 "G"
SW COR 4-31-7

Field Book: _____ Page: _____

ADDITIONAL NOTES

D (WEST QUARTER CORNER)

Date Located: 11-3-05
By: DKEMPER M KISSINGER
Monument Description: HARRISON MONUMENT
Monument Witnesses: _____
NEAR EDGE RIP 44.83' ESE
" " " 49.78' SW
" " " 51.10' WSW
PK IN PP REMC 3082 55.90' WNW

Field Book: 3 Page: 15

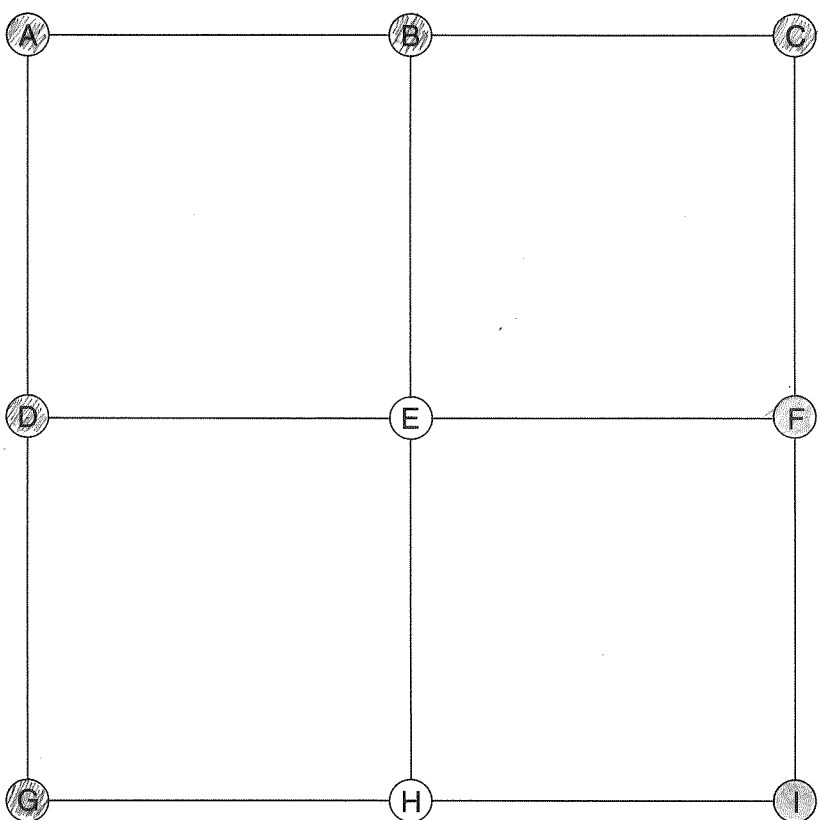

E (CENTER OF SECTION)

Date Located: _____
By: _____
Monument Description: _____
Monument Witnesses: _____

Field Book: _____ Page: _____

F (EAST QUARTER CORNER)

Date Located: 11-3-05
By: _____
Monument Description: _____
Monument Witnesses: SEE PAGE 222 "D"
W/4 5-31-7

Field Book: _____ Page: _____

A (NORTHWEST CORNER)

Date Located: 9/26/18
By: SRM
Monument Description: BRONZE MONUMENT
Monument Witnesses: SEE Pg 1 "C"

Field Book: 11 Page: 46

G (SOUTHWEST CORNER)

Date Located: 4/25/19
By: SRM MWH
Monument Description: BRONZE MONUMENT
Monument Witnesses: SEE Pg 224 "A"

Field Book: 13 Page: 51

B (NORTH QUARTER CORNER)

Date Located: 9/26/18
By: SRM
Monument Description: NAIL
Monument Witnesses: NAIL IN B. CAP POWER POLE NE 56.27
NAIL IN B. CAP POWER POLE SE 38.53
RR RAIL FCP S 17.45'

Field Book: 11 Page: 48

H (SOUTH QUARTER CORNER)

Date Located: _____
By: _____
Monument Description: _____
Monument Witnesses: _____

Field Book: _____ Page: _____

C (NORTHEAST CORNER)

Date Located: 9/24/18
By: SRM
Monument Description: RR SPIKE
Monument Witnesses: SEE Pg 222 "A"

Field Book: 11 Page: 40

I (SOUTHEAST CORNER)

Date Located: 9/24/18
By: SRM
Monument Description: RR SPIKE
Monument Witnesses: SEE Pg 222 "G"

Field Book: 11 Page: 41

D (WEST QUARTER CORNER)

Date Located: 8/28/20
By: SRM MWH
Monument Description: FO RR SPIKE 6" DEEP
Monument Witnesses: E FACE RR RAIL FCP W 21.4'
FO CAPPED IRON E 19.9'
1/2" REBAR W/ CAP SW 27.00'

Field Book: 19 Page: 26

ADDITIONAL NOTES

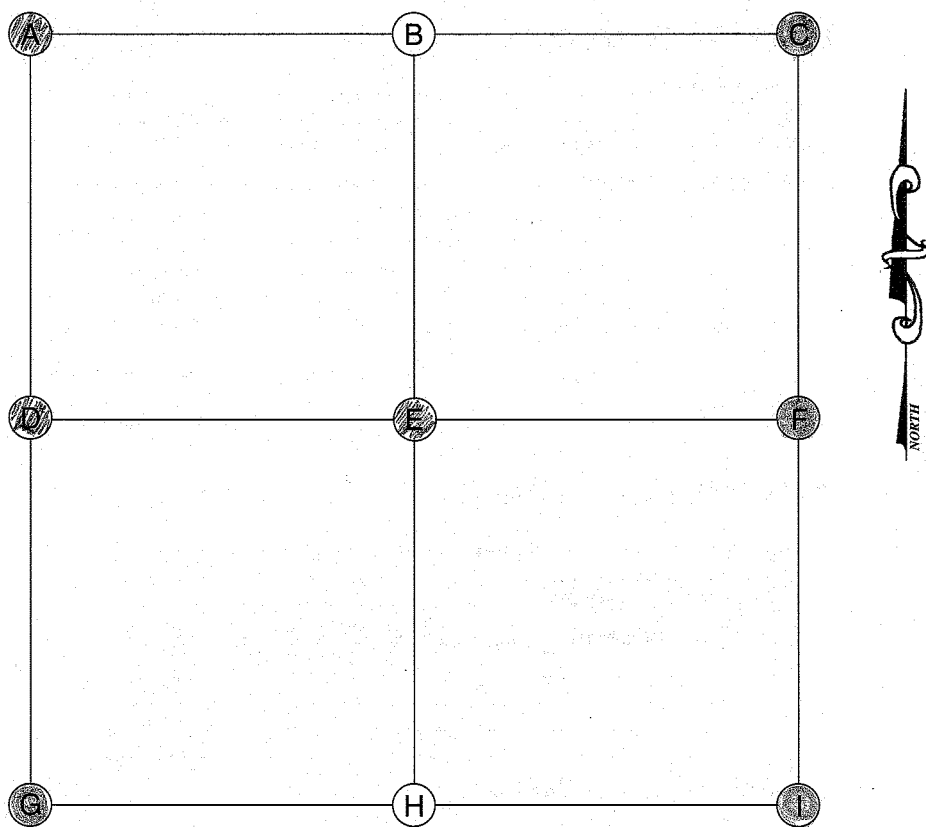

Date Located: 4/25/19
By: SEM MWH
Monument Description: BRONZE MONUMENT
Monument Witnesses: 1/2" REBAR W/CAP NW 24.54'
NAIL IN B. CAP POWER POLE ENE 19.15'
1/2" REBAR W/CAP SW 25.52'

Field Book: 13 Page: 51

Date Located: _____
By: _____
Monument Description: _____
Monument Witnesses: _____

Field Book: _____ Page: _____

Date Located: 7/11/2001
By: MEK
Monument Description: BRONZE MARKER OR SPIKE IN PLATE
Monument Witnesses: RIP 16.3' W. TO FACE
RIP 51.1' NE TO FACE
RIP 42.55' NE TO FACE

Field Book: _____ Page: _____

Date Located: 4/25/19
By: JRM MWH
Monument Description: BRONZE MONUMENT
Monument Witnesses: NAIL IN B. CAP P. POLE WNW 51.58'
1/2" REBAR W/CAP NE 34.90'

Field Book: 13 Page: 53

Date Located: 4/25/19
By: SEN MNH
Monument Description: RR SPIKE
Monument Witnesses: 1/2" REBAR W/CAP SW 39.05'
FO 1/2" REBAR NO CAP S 20.27'

Field Book: 13 Page: 52

Date Located: 7/11/2001
By: MEK
Monument Description: RR SPIKE BURIED 3"
Monument Witnesses: FACE OF RIP 19.19'E
1/2" CAPPED IRON REBAR 41.90' NE
" " " " 45.16' SW

Field Book: _____ Page: _____

Date Located: 7/13/92
By: JH MOYER - EL CHAINES
Monument Description: Pk Nail BRONZE MONUMENT
Monument Witnesses: EAST FACE OF A BA RAIL FCP NW 33.88
SET NAIL IN BOTTLE CAP IN NE FACE OF AN REMC P.B. NNW 37.00
" " " " "SW " " "PHONE POLE SW 34.70

Field Book: 1 Page: 78 UPDATED 9/24/18 JEM

Date Located: _____
By: _____
Monument Description: _____
Monument Witnesses: _____

Field Book: _____ Page: _____

Date Located: 7/13/90
By: JR MOYER - EC HAINES
Monument Description: RR SINK (RESET 7/11/2001)
Monument Witnesses: SET NAIL IN BOTTLE CAP IN NW CORNER OF A.P.P. NE 41.43
NE CORNER OF A BRIDGE RUIN FCP SSW 49.30
" " " " " " " " WSW 42.40

Field Book: 1 Page: 79 UPDATED 3/22/17 SM

ADDITIONAL NOTES

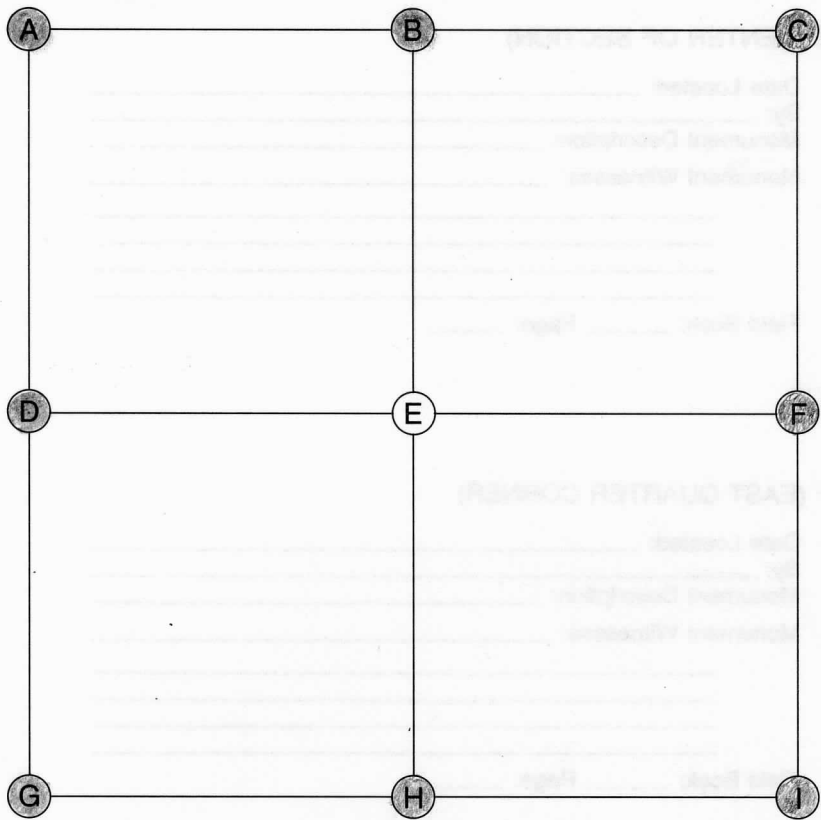
Monroe
8-31-7

E (CENTER OF SECTION)

Date Located: _____
By: _____
Monument Description: _____
Monument Witnesses: _____

Field Book: _____ Page: _____

F (EAST QUARTER CORNER)

Date Located: _____
By: _____
Monument Description: _____
Monument Witnesses: SEE PAGE 226 "D"
W 1/4 Post 9-31-7

Field Book: _____ Page: _____

A (NORTHWEST CORNER)

Date Located: _____
By: _____
Monument Description: _____
Monument Witnesses: SEE PAGE 224 "C"
NECOR 7-31-7

Field Book: _____ Page: _____

G (SOUTHWEST CORNER)

Date Located: _____
By: _____
Monument Description: _____
Monument Witnesses: SEE PAGE 224 "I"
SE 7-31-7

Field Book: _____ Page: _____

B (NORTH QUARTER CORNER)

Date Located: _____
By: _____
Monument Description: _____
Monument Witnesses: SEE PAGE 222 "H"
5 1/4 Post 5-31-7

Field Book: _____ Page: _____

H (SOUTH QUARTER CORNER)

Date Located: _____
By: _____
Monument Description: _____
Monument Witnesses: SEE PAGE 234 "B"
N 1/4 Post 17-31-7

Field Book: _____ Page: _____

C (NORTHEAST CORNER)

Date Located: _____
By: _____
Monument Description: _____
Monument Witnesses: SEE PAGE 221 "G"
SW 4-31-7

Field Book: _____ Page: _____

I (SOUTHEAST CORNER)

Date Located: _____
By: _____
Monument Description: _____
Monument Witnesses: SEE PAGE 234 "C"
NE 17-31-7

Field Book: _____ Page: _____

D (WEST QUARTER CORNER)

Date Located: 7/16/18
By: DRM
Monument Description: FO RR SPIKE
Monument Witnesses: ± RR RAIL FCP E 19.83'
NAIL IN B. CAP POWER POLE ENE A.28'
1/2" REBAR W/CAP SE 39.41'

Field Book: 10 Page: 34

ADDITIONAL NOTES

Monroe
9-31-7

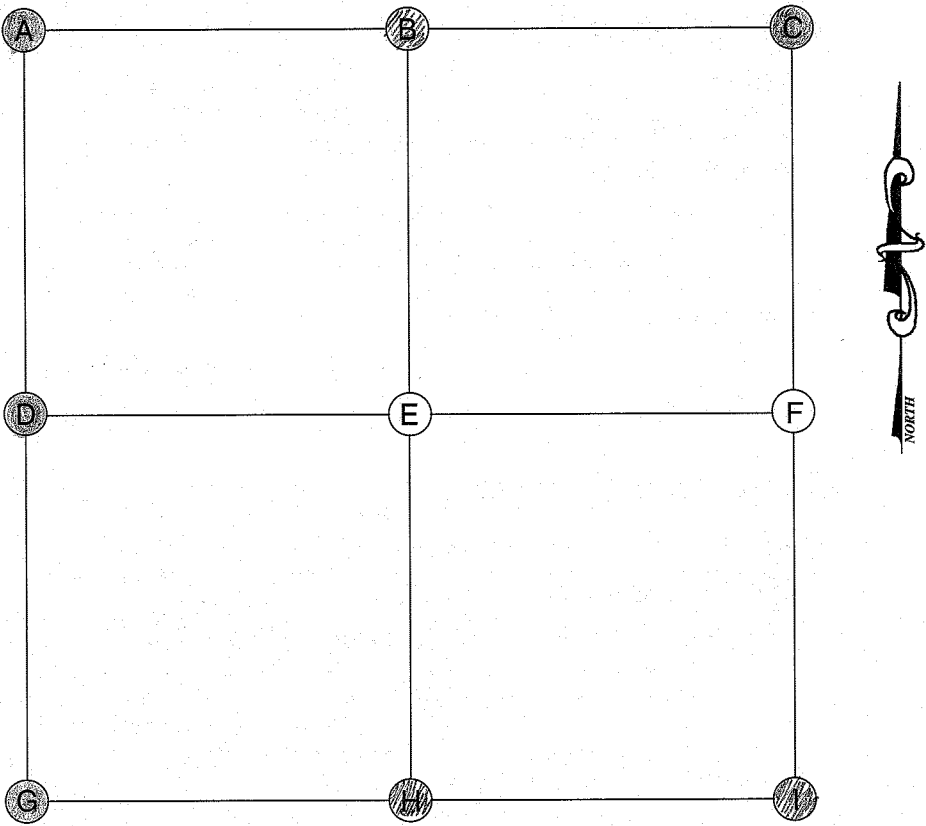

A (NORTHWEST CORNER)

Date Located: _____
By: _____
Monument Description: _____
Monument Witnesses: SEE PAGE 221 "G"
SW 4-31-7

Field Book: _____ Page: _____

B (NORTH QUARTER CORNER)

Date Located: 1/12/17
By: SRM
Monument Description: FO 1/2" SO HEAD BOLT
Monument Witnesses: SEE Pg 221 "H"

Field Book: 5 Page: 49

C (NORTHEAST CORNER)

Date Located: _____
By: _____
Monument Description: _____
Monument Witnesses: SEE PAGE 221 "I"
SE 4-31-7

Field Book: _____ Page: _____

D (WEST QUARTER CORNER)

Date Located: 7/22/98
By: JAMOVER-EL HAINES
Monument Description: RR SPIKE
Monument Witnesses: CENTER OF RR RAILROAD E 24.00' (23.8' TO FACE)
SET ANAIL IN BOTTLE CAP IN SE FACE OF RR SE 27.68'
1/2" CAPPED IRON REBAR NW 25.97'
" " " SW 35.43' BENT
OLD TIE: HSE FOL 109.4' SW

Field Book: Q Page: 14
UPDATED 7/10/18 SRM

E (CENTER OF SECTION)

Date Located: _____
By: _____
Monument Description: _____
Monument Witnesses: _____

Field Book: _____ Page: _____

F (EAST QUARTER CORNER)

Date Located: _____
By: _____
Monument Description: _____
Monument Witnesses: _____

Field Book: _____ Page: _____

G (SOUTHWEST CORNER)

Date Located: _____
By: _____
Monument Description: _____
Monument Witnesses: SEE PAGE 234 "C"
NE 17-31-7

Field Book: _____ Page: _____

H (SOUTH QUARTER CORNER)

Date Located: 4/25/19
By: SRM MWH
Monument Description: RR SPIKE
Monument Witnesses: 1/2" REBAR W/CAP NW 25.91'
NAIL IN B. CAP POWER POLE SE 23.78'

Field Book: 13 Page: 50

I (SOUTHEAST CORNER)

Date Located: 4/25/19
By: SRM MWH
Monument Description: BRONZE MONUMENT
Monument Witnesses: 1/2" REBAR NNE 14.88'
NAIL IN B. CAP POWER POLE NE 31.18'
NAIL IN B. CAP POWER POLE SSE 68.78'

Field Book: 13 Page: 49

ADDITIONAL NOTES



Field Book: _____ Page: _____

Monroe
11-31-7

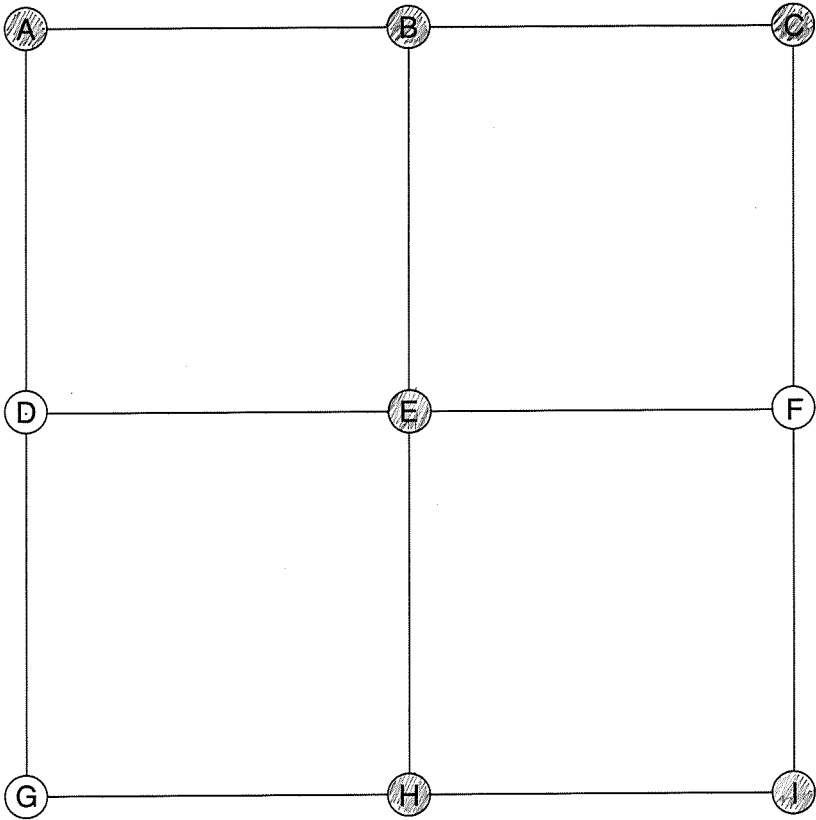

A (NORTHWEST CORNER)

Date Located: 5/17/17
By: SEM
Monument Description: FO MAG NAIL
Monument Witnesses: SEE Pg 220 "I"

Field Book: 7 Page: 8

B (NORTH QUARTER CORNER)

Date Located: 2/12/18
By: SEM
Monument Description: FO RR SPIKE 2" DEEP
Monument Witnesses: 4 STATE ROAD 13 N 89.5'
NAIL IN B. CAP POWER POLE ESE 76.24'
1/2" REBAR W/CAP SE 37.81'
NAIL IN B. CAP IN POWER POLE SW 28.91'
FO "+" CUT IN CONC HOWELL NW 44.80'

Field Book: 8 Page: 65

C (NORTHEAST CORNER)

Date Located: 2/12/18
By: SEM
Monument Description: FO RR SPIKE 2" DEEP
Monument Witnesses: 1/2" REBAR W/CAP NW 35.62'
NAIL IN B. CAP POWER POLE N 15.87'
NAIL IN B. CAP POWER POLE SSE 75.18'

Field Book: 8 Page: 66

D (WEST QUARTER CORNER)

Date Located: _____
By: _____
Monument Description: _____
Monument Witnesses: _____

Field Book: _____ Page: _____

E (CENTER OF SECTION)

Date Located: 7/31/19
By: SEM MWH
Monument Description: FO RR SPIKE
Monument Witnesses: RR RAIL FCP E 19.45'
NAIL IN B. CAP POWER POLE SE 18.98'
1/2" REBAR W/CAP SSE 23.70'

Field Book: 16 Page: 26

F (EAST QUARTER CORNER)

Date Located: _____
By: _____
Monument Description: _____
Monument Witnesses: _____

Field Book: _____ Page: _____

G (SOUTHWEST CORNER)

Date Located: _____
By: _____
Monument Description: _____
Monument Witnesses: _____

Field Book: _____ Page: _____

H (SOUTH QUARTER CORNER)

Date Located: 7/31/19
By: SEM MWH
Monument Description: FO RR SPIKE
Monument Witnesses: FACE OF RR RAIL FCP E 19.90'
NAIL IN B. CAP POWER POLE SE 32.50'
1/2" REBAR W/CAP SW 30.63'

Field Book: 16 Page: 25

I (SOUTHEAST CORNER)

Date Located: 7/31/19
By: SEM MWH
Monument Description: FO RR SPIKE
Monument Witnesses: 4 RR RAIL FCP NW 24.52'
4 RR RAIL FCP W 20.14'
1/2" REBAR W/CAP SE 23.74'

Field Book: 16 Page: 24

ADDITIONAL NOTES

Field Book: 6 Page: 66Field Book: 8 Page: 67Field Book: 8 Page: 68

Field Book: _____ Page: _____

Field Book: _____ Page: _____

Field Book: _____ Page: _____

Field Book: _____ Page: _____

Field Book: _____ Page: _____

Field Book: _____ Page: _____

[The page contains horizontal ruling lines.]

Monroe
13-31-7

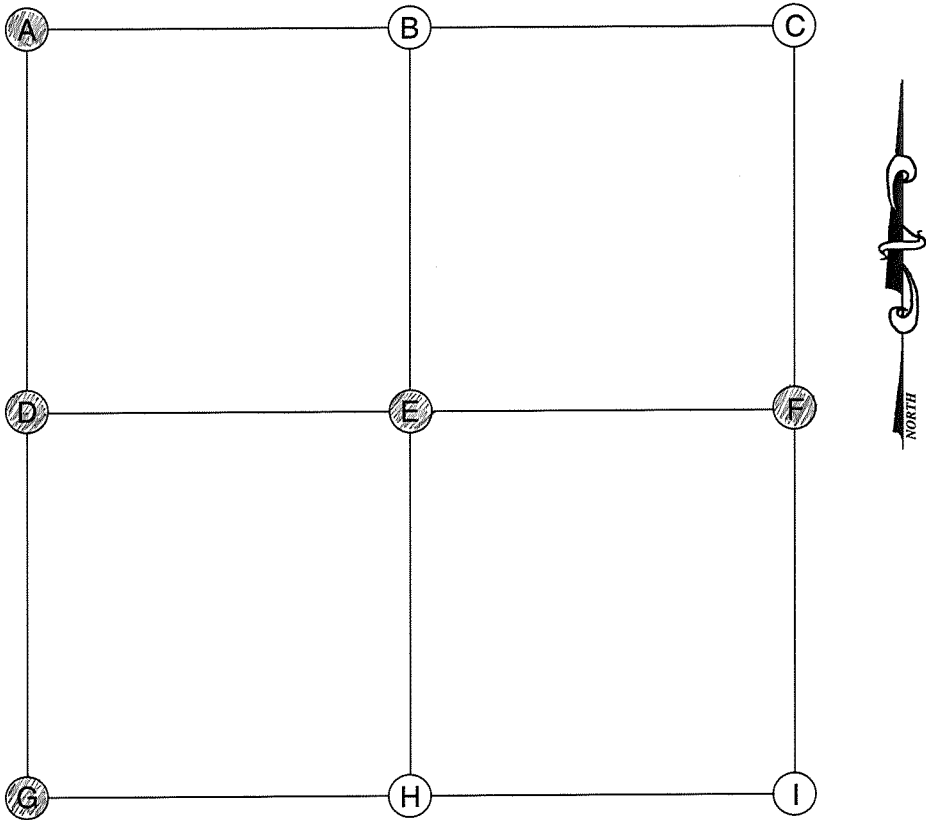

A (NORTHWEST CORNER)

Date Located: 7/31/19
By: SEM MWH
Monument Description: FO RR SPIKE
Monument Witnesses: SEE Pg 228 "I"

Field Book: 16 Page: 24

B (NORTH QUARTER CORNER)

Date Located: _____
By: _____
Monument Description: _____
Monument Witnesses: _____

Field Book: _____ Page: _____

C (NORTHEAST CORNER)

Date Located: _____
By: _____
Monument Description: _____
Monument Witnesses: _____

Field Book: _____ Page: _____

D (WEST QUARTER CORNER)

Date Located: 4/12/18
By: SEM
Monument Description: FO RR SPIKE
Monument Witnesses: NAIL IN B. CAP TEL POLE NNE 56.89'
NAIL IN B. CAP TEL POLE SSE 42.62'
NAIL IN B. CAP POWER POLE SW 30.46'

Field Book: 9 Page: 32

E (CENTER OF SECTION)

Date Located: 5/2/19
By: SEM MWH
Monument Description: RR SPIKE
Monument Witnesses: 1/2" REBAR W/CAP SW 22.51'
1/2" REBAR W/CAP SE 26.85'

Field Book: 13 Page: 55

F (EAST QUARTER CORNER)

Date Located: 4/25/19
By: SEM MWH
Monument Description: RR SPIKE
Monument Witnesses: NAIL IN B. CAP P. POLE NW 58.20'

Field Book: _____ Page: _____

G (SOUTHWEST CORNER)

Date Located: 5/2/19
By: SEM MWH
Monument Description: MACO NAIL
Monument Witnesses: SEE Pg 240 "C"

Field Book: 13 Page: 59

H (SOUTH QUARTER CORNER)

Date Located: _____
By: _____
Monument Description: _____
Monument Witnesses: _____

Field Book: _____ Page: _____

I (SOUTHEAST CORNER)

Date Located: _____
By: _____
Monument Description: _____
Monument Witnesses: _____

Field Book: _____ Page: _____

ADDITIONAL NOTES



Date Located: 4/12/18
By: DEM
Monument Description: FO PK NAIL
Monument Witnesses: FACE STEEL CONC-FILLED FCP NE 33.05
NAIL IN B. CAP POWER POLE ENE 38.95
1/2" REBAR N/CAP IN FENCE SE 38.47

Date Located: 4/12/18
By: DEM
Monument Description: FORR SPIKE
Monument Witnesses: NAIL IN B. CAP TEL POLE NNE 56.89
NAIL IN B. CAP TEL POLE SSE 42.62'
NAIL IN B. CAP POWER POLE SW 30.46'

Date Located: _____
By: _____
Monument Description: _____
Monument Witnesses: _____

Date Located: _____
By: _____
Monument Description: _____
Monument Witnesses: _____

Date Located: _____
By: _____
Monument Description: _____
Monument Witnesses: _____

Date Located: _____
By: _____
Monument Description: _____
Monument Witnesses: _____

Date Located: _____
By: _____
Monument Description: _____
Monument Witnesses: _____

Date Located: _____
By: _____
Monument Description: _____
Monument Witnesses: _____

Date Located: _____
By: _____
Monument Description: _____
Monument Witnesses: _____

ADDITIONAL NOTES

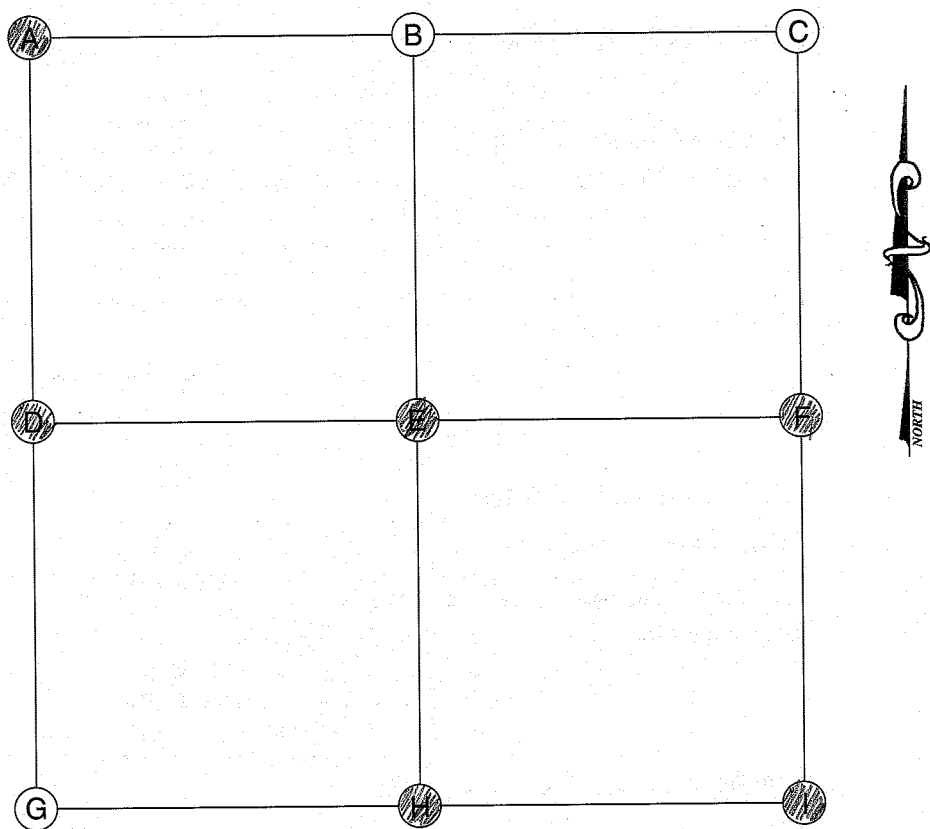

Date Located: 4/25/19
By: SEM MWH
Monument Description: BRONZE MONUMENT
Monument Witnesses: SEE P. 226 "I"

Field Book: 13 Page: 49

Date Located: _____
By: _____
Monument Description: _____
Monument Witnesses: _____

Field Book: _____ Page: _____

Date Located: _____
By: _____
Monument Description: _____
Monument Witnesses: _____

Field Book: _____ Page: _____

Date Located: 5/15/17
By: JEM
Monument Description: FD MAG NAIL
Monument Witnesses: 1/2" REBAR w/CAP NE 61.00'
NAIL IN B. CAP P POLE SE 85.54'
NAIL IN B. CAP P POLE SW 60.10'

Field Book: 7 Page: 5

Date Located: 4/25/19
By: DEM MWH
Monument Description: FD RR SPIKE
Monument Witnesses: 1/2" REBAR w/CAP SW 29.54'
1/2" REBAR w/CAP SE 26.85'

Field Book: 13 Page: 48

Date Located: 4/25/19
By: SEM MNH
Monument Description: MAG NAIL w/CO TAG
Monument Witnesses: 1/2" REBAR w/CAP NE 41.90'
1/2" REBAR w/CAP SE 40.00'

Field Book: 13 Page: 45

Date Located: _____
By: _____
Monument Description: _____
Monument Witnesses: _____

Field Book: _____ Page: _____

Date Located: 4/25/19
By: SEM MWJ
Monument Description: 5/8" REBAR
Monument Witnesses: 1/2" REBAR w/CAP NE 24.74'
S. FACE I REAM FCP N 13.23'

Field Book: 13 Page: 47

Date Located: 4/25/19
By: SEM MWN
Monument Description: FO BOAT SPIKE
Monument Witnesses: HSE FOUNDATION NW 50.00'
X 120N FCP NE 21.92'
1/2" REBAR w/ CAP SE 32.86'

Field Book: 13 Page: 46

ADDITIONAL NOTES

This image shows a single sheet of white paper with horizontal blue or grey ruling lines, typical of notebook paper. The lines are evenly spaced and run across the width of the page. There is no handwriting or other markings on the paper.

Field Book: 20 Page: 34

B (NORTH QUARTER CORNER)

Field Book: 13 Page: 50

C (NORTHEAST CORNER)

Field Book: 13 Page: 49

D (WEST QUARTER CORNER)

Field Book: 7 Page: 43

E (CENTER OF SECTION)

Field Book: _____ Page: _____

F (EAST QUARTER CORNER)

Field Book: 7 Page: 5

G (SOUTHWEST CORNER)

Field Book: 7 Page: 33

H (SOUTH QUARTER CORNER)

Field Book: _____ Page: _____

I (SOUTHEAST CORNER)

Field Book: _____ Page: _____

ADDITIONAL NOTES

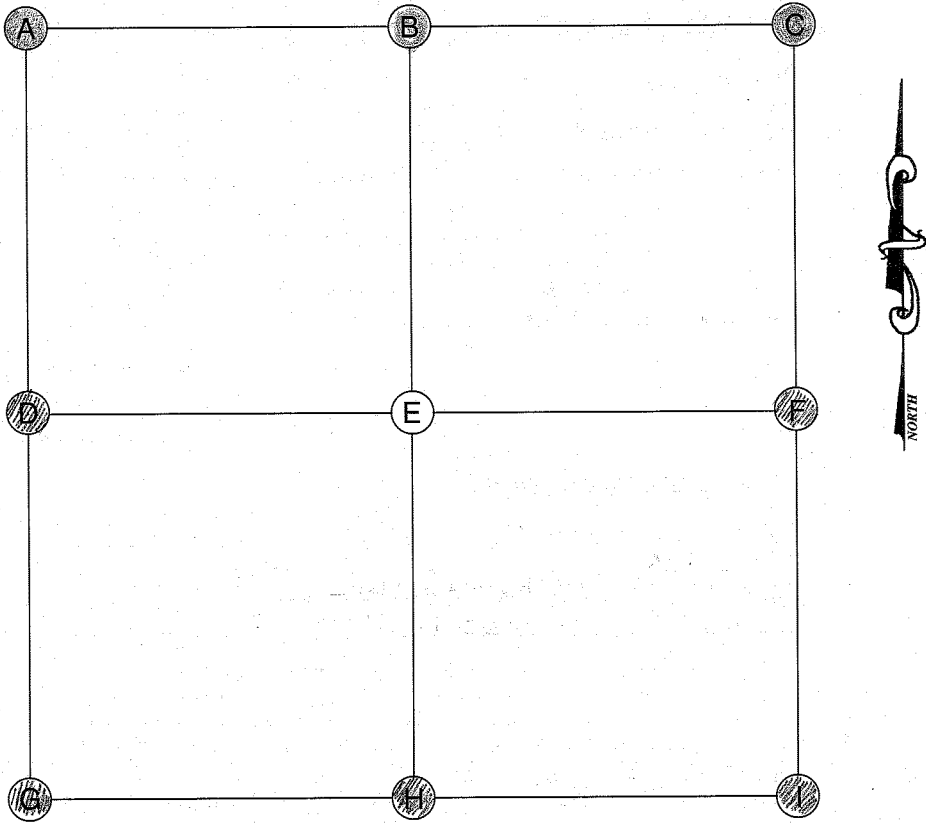

A (NORTHWEST CORNER)

Date Located: _____
By: _____
Monument Description: _____
Monument Witnesses: SEE PAGE 224 "I"
SE 7-31-7

Field Book: _____ Page: _____

B (NORTH QUARTER CORNER)

Date Located: 6/17/91 8/4/17 SRM
By: JR MOYER-EC HAINES
Monument Description: FD MAG NAIL
Monument Witnesses: _____
FACE OF RR RAIL FCP TO FACE OF RR
RAIL FCP 41.40

Field Book: 1 Page: 31 UPDATED 8/4/17

C (NORTHEAST CORNER)

Date Located: 6/17/91 8/4/17 SRM
By: JR MOYER-EC HAINES
Monument Description: BRONZE MARKER
Monument Witnesses: SET NAIL IN BOTTLE CAP IN SW FACE OF P POLE NW 28.85
SET "+" CUT IN W FACE RR RAIL FCP ESE 50.44
" " " " N " " " " SSE 47.45
" " " " E " " " " SW 27.32

Field Book: 1 Page: 31 UPDATED 8/4/17

D (WEST QUARTER CORNER)

Date Located: 3/22/17
By: SRM
Monument Description: FD MAG NAIL
Monument Witnesses: ± RR RAIL FCP E 44.17
NAIL IN B. CAP IN P POLE SE 49.80
NAIL IN B. CAP IN P POLE SW 39.68
± RR RAIL FCP SW 21.38

Field Book: 6 Page: 45

E (CENTER OF SECTION)

Date Located: _____
By: _____
Monument Description: _____
Monument Witnesses: _____

Field Book: _____ Page: _____

F (EAST QUARTER CORNER)

Date Located: 8/4/17
By: SRM
Monument Description: RR SPIKE
Monument Witnesses: ± RR RAIL FCP W 21.24
1/2" REBAR W/CAP NW 34.10
± RR RAIL FCP E 21.18

Field Book: 7 Page: 43

G (SOUTHWEST CORNER)

Date Located: 3/22/16
By: SRM
Monument Description: 1/2" REBAR 3" DEEP
Monument Witnesses: SEE Pg 237 "A"

Field Book: 3 Page: 40

H (SOUTH QUARTER CORNER)

Date Located: 5/2/19
By: SRM MWLH
Monument Description: BOAT SPIKE
Monument Witnesses: 1/2" REBAR W/CAP NE 19.20
1/2" REBAR W/CAP SE 19.33
MAG NAIL W/ WALKER TAG E 140

Field Book: 13 Page: 69

I (SOUTHEAST CORNER)

Date Located: 7/2/17
By: SRM
Monument Description: FD MAG NAIL
Monument Witnesses: SEE Pg 237 "C"

Field Book: 7 Page: 33

ADDITIONAL NOTES

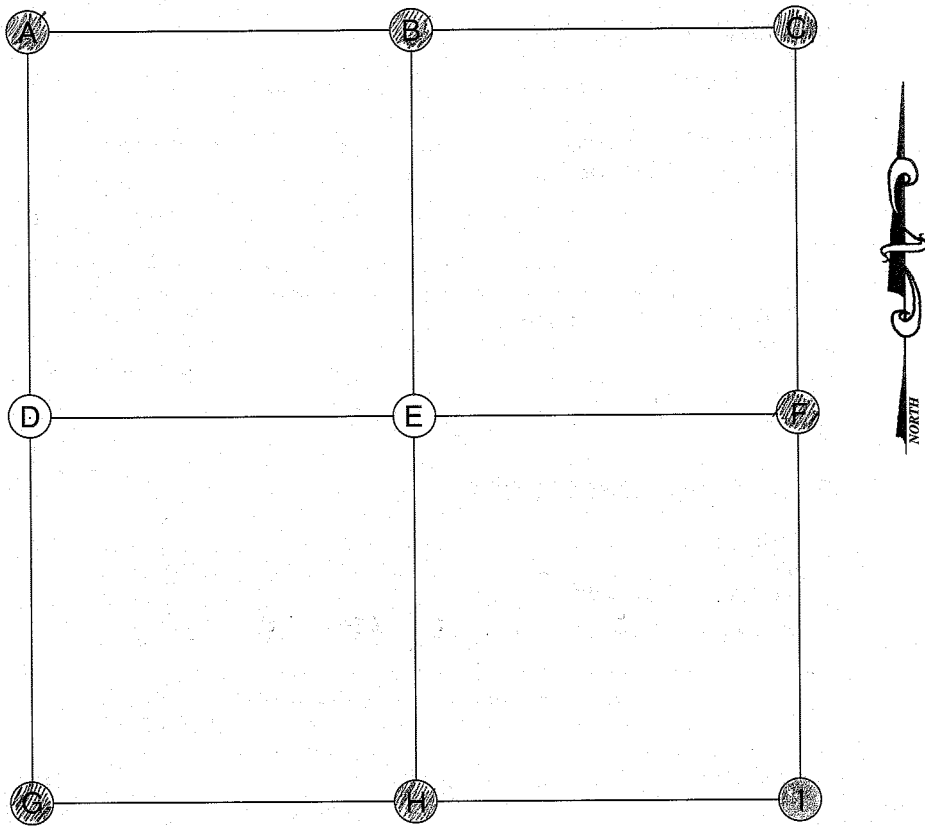

Field Book: _____ Page: _____

Field Book: 13 Page: 54Field Book: 13 Page: 61Field Book: 3 Page: 40

Field Book: _____ Page: _____

Field Book: 11 Page: 63Field Book: 13 Page: 62Field Book: 2 Page: 16

ADDITIONAL NOTES

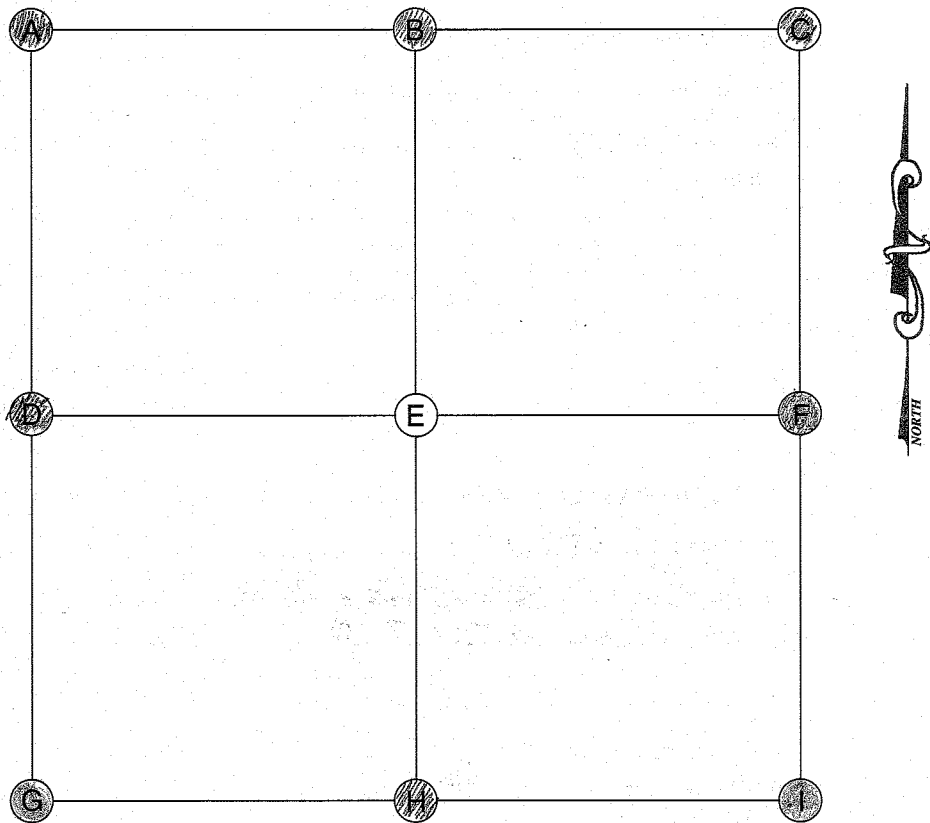

A (NORTHWEST CORNER)

Date Located: 3/22/16
By: SRM
Monument Description: 1/2" REBAR 3" DEEP
Monument Witnesses: SW CORNER 5"x10" BRIDGE BEAM 48.02' NE
1/2" REBAR w/CAP SE 39.64'
1/2" REBAR w/CAP SW 48.06'
NAIL IN BOTTLE CAP IN P POLE NW 40.32'

Field Book: 3 Page: 40

B (NORTH QUARTER CORNER)

Date Located: 5/2/19
By: SRM MWH
Monument Description: BOAT SPIKE
Monument Witnesses: SEE Pg 234 "H"

Field Book: 13 Page: 69

C (NORTHEAST CORNER)

Date Located: 7/2/17
By: SRM
Monument Description: FO MAG NAIL
Monument Witnesses: NAIL IN B. CAP IN P. POLE WNW 74.29'
NAIL IN B. CAP IN POWER POLE NW 42.91'
NAIL IN B. CAP IN FENCE POST 8 ENE 22.73'
1/2"x16" REBAR w/CAP SW 45.45'

Field Book: 7 Page: 33

D (WEST QUARTER CORNER)

Date Located: 4/2/16
By: SRM
Monument Description: FO RR SPIKE 4" DEEP
Monument Witnesses: CENTER OF RR RAIL FCP 19.99' W
NAIL IN BOTTLE CAP IN TRANS POLE 26.21' SW
1/2" REBAR w/CAP 7' FROM E/P 21.77' SE

Field Book: 3 Page: 45

E (CENTER OF SECTION)

Date Located: _____
By: _____
Monument Description: _____
Monument Witnesses: _____

Field Book: _____ Page: _____

F (EAST QUARTER CORNER)

Date Located: _____
By: _____
Monument Description: _____
Monument Witnesses: SEE PAGE 238 "D"
W 1/4 POST 21-31-7

Field Book: _____ Page: _____

G (SOUTHWEST CORNER)

Date Located: 7/22/92
By: JR MOYER - EL HAINES
Monument Description: RR SPIKE FO MAG NAIL FLUSH
Monument Witnesses: SE CORNER OF A RR RAIL FCP NW 43.61
CENTER OF A RR RAIL FCP S 20.20
SET NAIL IN BOTTLE CAP IN NW FACE OF PP SSW 23.90
SET 1/2" REBAR w/CAP 36.39' NE 13' TO E/P
SET 1/2" REBAR w/CAP 21.45' SW 12.8' TO E/P

Field Book: 2 Page: 16 UPDATED 4/2/16 SRM

H (SOUTH QUARTER CORNER)

Date Located: 5/2/19
By: SRM MWH
Monument Description: MAG NAIL
Monument Witnesses: 1/2" REBAR w/CAP NW 19.47
NAIL IN B. CAP P. POLE NNE 40.21'
NAIL IN B. CAP P. POLE ESE 62.60'

Field Book: 13 Page: 63

I (SOUTHEAST CORNER)

Date Located: _____
By: _____
Monument Description: BRONZE MARKER
Monument Witnesses: SEE PAGE 238 "G"
SW 21-31-7

Field Book: 2 Page: 16 UPDATED 11/23/15

ADDITIONAL NOTES



Date Located: _____
By: _____
Monument Description: _____
Monument Witnesses: _____

Date Located: _____
By: _____
Monument Description: _____
Monument Witnesses: _____

Date Located: 7/22/92
By: JR MOYER - ECHAINES
Monument Description: BRONZE MARRIED
Monument Witnesses: FACE OF AN 6" DIA STEEL FCP WNW 75.34
WEST FACE OF AN 8" SQ CONC FCP E 20.00
SETBACK IN BOTTLE CAP IN NW FACE OF FCP NW 27.75

Date Located: 7/2/17
By: SEM
Monument Description: FO MAG NAIL
Monument Witnesses: SEE PG 237 "C"

Date Located: _____
By: _____
Monument Description: _____
Monument Witnesses: _____

Date Located: _____
By: _____
Monument Description: _____
Monument Witnesses: _____

Date Located: _____
By: _____
Monument Description: _____
Monument Witnesses: _____

Date Located: _____
By: _____
Monument Description: _____
Monument Witnesses: _____

Date Located: 7/22/92 UPDATED 7/17/17 JRM
By: JR ROYER - ECHAINES
Monument Description: RR SPIKE
Monument Witnesses: CENTER OF A RR RAIL FCP W 30.00
SET NAIL IN BOTTLE CAP IN SE FACE OF PP ENG 18 23
1/2" X 1/2" REBAR w/CAP 27' FROM RR POST SW 32.50

ADDITIONAL NOTES

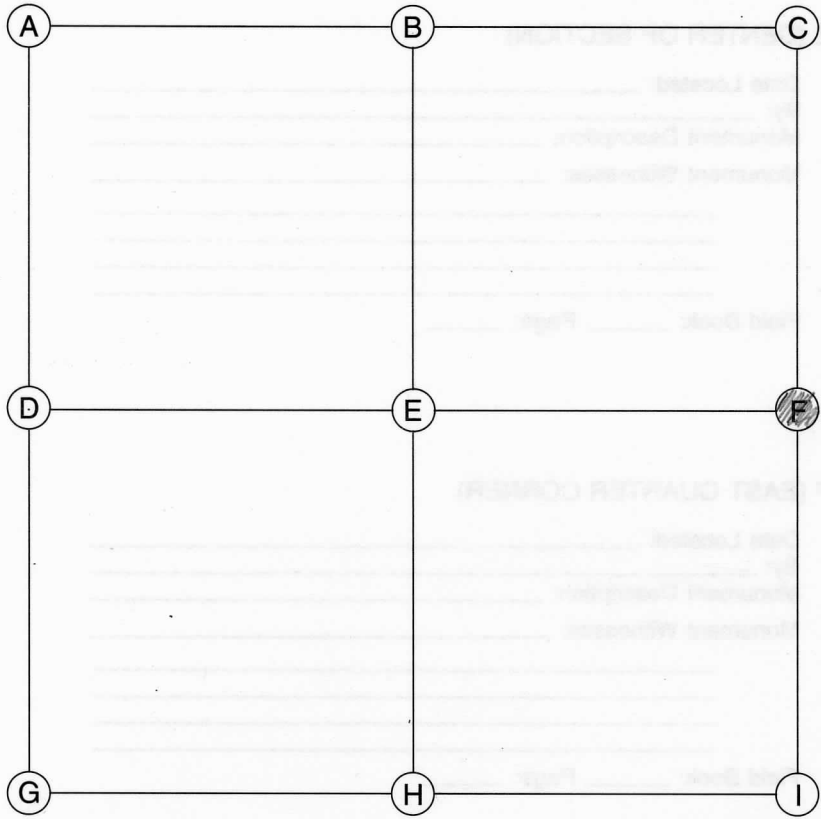

E (CENTER OF SECTION)

Date Located: _____
By: _____
Monument Description: _____
Monument Witnesses: _____

Field Book: _____ Page: _____

F (EAST QUARTER CORNER)

Date Located: 7/30/18
By: JRM
Monument Description: FO RR SPIKE
Monument Witnesses: NAIL IN B. CAP P. POLE NNW 68.42'
NAIL IN B. CAP REMC POLE WNW 47.45'

Field Book: 10 Page: 44

A (NORTHWEST CORNER)

Date Located: _____
By: _____
Monument Description: _____
Monument Witnesses: _____

Field Book: _____ Page: _____

G (SOUTHWEST CORNER)

Date Located: _____
By: _____
Monument Description: _____
Monument Witnesses: _____

Field Book: _____ Page: _____

B (NORTH QUARTER CORNER)

Date Located: _____
By: _____
Monument Description: _____
Monument Witnesses: _____

Field Book: _____ Page: _____

H (SOUTH QUARTER CORNER)

Date Located: _____
By: _____
Monument Description: _____
Monument Witnesses: _____

Field Book: _____ Page: _____

C (NORTHEAST CORNER)

Date Located: _____
By: _____
Monument Description: _____
Monument Witnesses: _____

Field Book: _____ Page: _____

I (SOUTHEAST CORNER)

Date Located: _____
By: _____
Monument Description: _____
Monument Witnesses: _____

Field Book: _____ Page: _____

D (WEST QUARTER CORNER)

Date Located: _____
By: _____
Monument Description: _____
Monument Witnesses: _____

Field Book: _____ Page: _____

ADDITIONAL NOTES

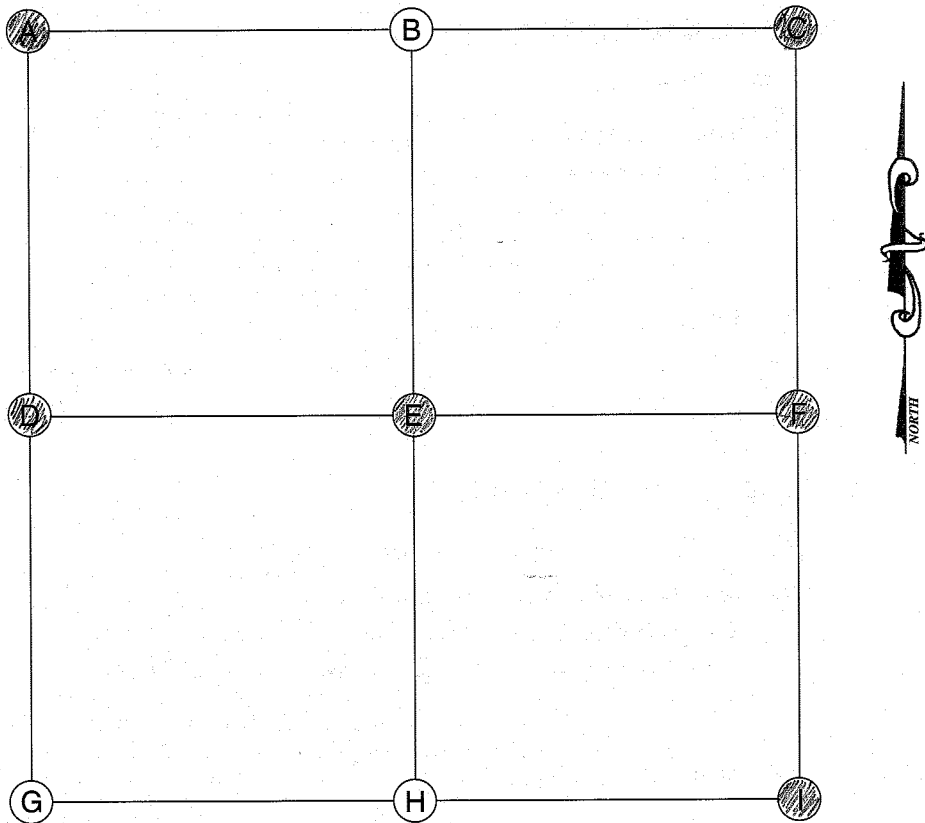

Date Located: 4/25/19
By: DEM MWL
Monument Description: FO BOAT SPIKE
Monument Witnesses: _____

Field Book: 13 Page: 46

Date Located: _____
By: _____
Monument Description: _____
Monument Witnesses: _____

Field Book: _____ Page: _____

Date Located: 5/2/19
By: SEM MMH
Monument Description: MAG NAIL w/ CO TAG
Monument Witnesses: 1/2" REBAR w/CAP SW 28.12'
"WALKER" MAG NAIL N 50.00'
"WALKER" CAPPED IRON NW 55.21'

Field Book: 13 Page: 59

Date Located: 7/30/18
By: JRM
Monument Description: FD RR SPIKE
Monument Witnesses: SEE Pg. 239 "F"

Field Book: 10 Page: 44

Date Located: 5/2/19
By: SEM MWH
Monument Description: RR SPIKE
Monument Witnesses: '1/2" REBAR NO CAP N 19.95'
NAIL IN B. CAP POWER POLE NNE 19.30'
'1/2" REBAR W/CAP NE 27.81'

Field Book: 13 Page: 60

Date Located: 5/2/19
By: SEAN MATH
Monument Description: RR SPIKE
Monument Witnesses: USCGS BM NW 42.41'
1/2" REBAR w/CAP NW 37.20'
1/2" REBAR w/CAP NE 43.17'
NAIL IN B. CAP POWER POLE SW 40.88'

Field Book: 13 Page: 58

Date Located: _____
By: _____
Monument Description: _____
Monument Witnesses: _____

Field Book: _____ Page: _____

Date Located: _____
By: _____
Monument Description: _____
Monument Witnesses: _____

Field Book: _____ Page: _____

Date Located: 9/19/18
By: JRM
Monument Description: R SPIKE
Monument Witnesses: SEE Pg 15 "A"

Field Book: 11 Page: 29

ADDITIONAL NOTES

[illegible]

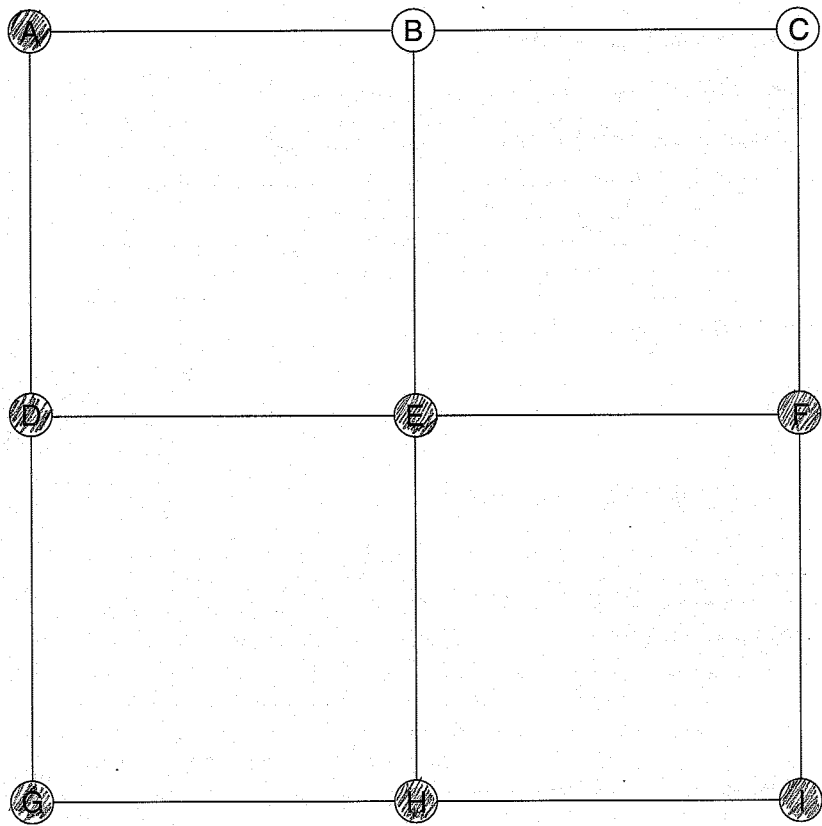

A (NORTHWEST CORNER)

Date Located: 5/2/19
By: SEM MWH
Monument Description: MAG NAIL
Monument Witnesses: SEE Pg 240 "C"

Field Book: 13 Page: 59

B (NORTH QUARTER CORNER)

Date Located: _____
By: _____
Monument Description: _____
Monument Witnesses: _____

Field Book: _____ Page: _____

C (NORTHEAST CORNER)

Date Located: _____
By: _____
Monument Description: _____
Monument Witnesses: _____

Field Book: _____ Page: _____

D (WEST QUARTER CORNER)

Date Located: 5/2/19
By: SEM MWH
Monument Description: RR SPIKE
Monument Witnesses: SEE Pg 240 "F"

Field Book: 13 Page: 58

E (CENTER OF SECTION)

Date Located: 5/2/19
By: SEM MWH
Monument Description: MAG NAIL w/CO TAG
Monument Witnesses: 1/2" REBAR w/CAP NW 22.55'
1/2" REBAR w/CAP SW 25.19'

Field Book: 13 Page: 57

F (EAST QUARTER CORNER)

Date Located: 5/2/19
By: SEM MWH
Monument Description: 3/4" IRON PIN
Monument Witnesses: 1/2" REBAR w/CAP NW 21.74'
1/2" REBAR w/CAP NE 27.31'

Field Book: 13 Page: 56

G (SOUTHWEST CORNER)

Date Located: 9/9/18
By: SEM
Monument Description: RR SPIKE
Monument Witnesses: SEE Pg 151 "A"

Field Book: 11 Page: 29

H (SOUTH QUARTER CORNER)

Date Located: 5/10/17
By: SEM
Monument Description: FO RR SPIKE
Monument Witnesses: SEE Pg 151 "B"

Field Book: 7 Page: 1

I (SOUTHEAST CORNER)

Date Located: 5/10/17
By: SEM
Monument Description: MAG NAIL w/CO TAG
Monument Witnesses: SEE Pg 151 "C"

Field Book: 6 Page: 78

ADDITIONAL NOTES