



## Field Book: \_\_\_\_\_ Page: \_\_\_\_\_

## Field Book: \_\_\_\_\_ Page: \_\_\_\_\_

Field Book: 10 Page: 41

## Field Book: \_\_\_\_\_ Page: \_\_\_\_\_

## Field Book: \_\_\_\_\_ Page: \_\_\_\_\_

## Field Book: \_\_\_\_\_ Page: \_\_\_\_\_

Field Book: 13 Page: 7Field Book: 13 Page: 2Field Book: 13 Page: 18

### ADDITIONAL NOTES



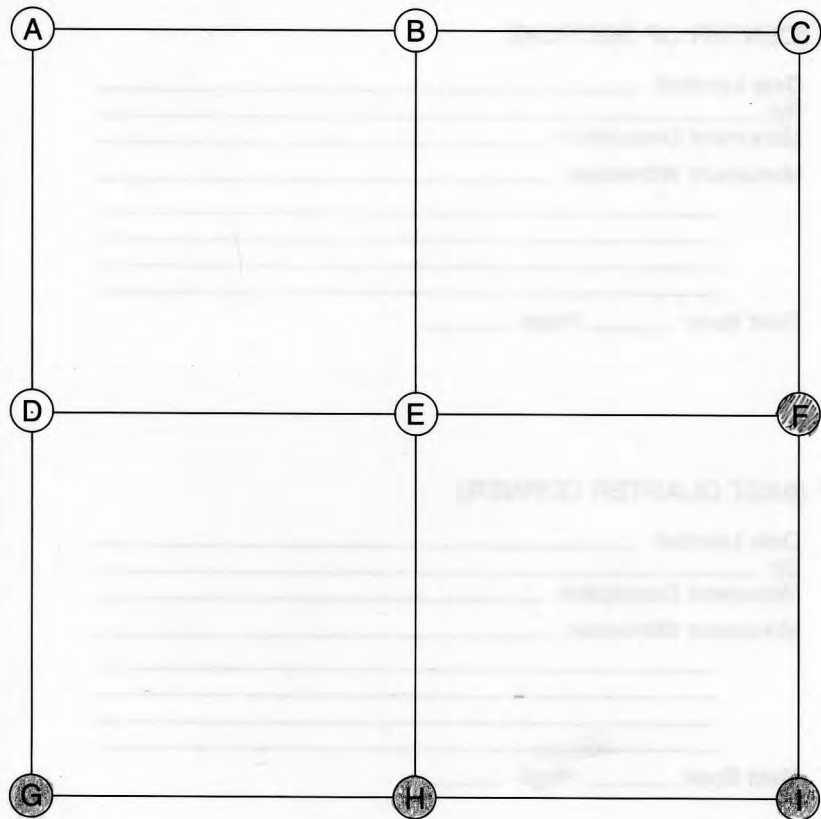

## E (CENTER OF SECTION)

Date Located: \_\_\_\_\_  
 By: \_\_\_\_\_  
 Monument Description: \_\_\_\_\_  
 Monument Witnesses: \_\_\_\_\_  
 \_\_\_\_\_  
 \_\_\_\_\_

Field Book: \_\_\_\_\_ Page: \_\_\_\_\_

## F (EAST QUARTER CORNER)

Date Located: 5/14/18  
 By: SEM  
 Monument Description: 1/2" CARRIAGE BOLT 5" DEEP  
 Monument Witnesses: 1/2" REBAR w/CAP NE 41.00'  
NAIL IN B. CAP IN POWER POLE NNW 62.06'

Field Book: 9 Page: 63

## A (NORTHWEST CORNER)

Date Located: 5/14/18  
 By: SEM  
 Monument Description: 1/2" CARRIAGE BOLT 5" DEEP  
 Monument Witnesses: 1/2" REBAR w/CAP NE 41.00'  
NAIL IN B. CAP IN POWER POLE NNW 62.06'

Field Book: \_\_\_\_\_ Page: \_\_\_\_\_

## G (SOUTHWEST CORNER)

Date Located: \_\_\_\_\_  
 By: \_\_\_\_\_  
 Monument Description: \_\_\_\_\_  
 Monument Witnesses: SEE PAGE 203 "A"  
NW 10-30-6

Field Book: \_\_\_\_\_ Page: \_\_\_\_\_

## B (NORTH QUARTER CORNER)

Date Located: \_\_\_\_\_  
 By: \_\_\_\_\_  
 Monument Description: \_\_\_\_\_  
 Monument Witnesses: \_\_\_\_\_

Field Book: \_\_\_\_\_ Page: \_\_\_\_\_

## H (SOUTH QUARTER CORNER)

Date Located: \_\_\_\_\_  
 By: \_\_\_\_\_  
 Monument Description: \_\_\_\_\_  
 Monument Witnesses: SEE PAGE 203 "B"  
N/4 POST 10-30-6

Field Book: \_\_\_\_\_ Page: \_\_\_\_\_

## C (NORTHEAST CORNER)

Date Located: \_\_\_\_\_  
 By: \_\_\_\_\_  
 Monument Description: \_\_\_\_\_  
 Monument Witnesses: \_\_\_\_\_

Field Book: \_\_\_\_\_ Page: \_\_\_\_\_

## I (SOUTHEAST CORNER)

Date Located: 5/14/18  
 By: SEM  
 Monument Description: 5/8" REBAR 4" DEEP  
 Monument Witnesses: 1/2" REBAR w/CAP NW 39.30'  
NAIL IN B. CAP IN POWER POLE SE 35.98'

Field Book: 9 Page: 64

## D (WEST QUARTER CORNER)

Date Located: \_\_\_\_\_  
 By: \_\_\_\_\_  
 Monument Description: \_\_\_\_\_  
 Monument Witnesses: \_\_\_\_\_

Field Book: \_\_\_\_\_ Page: \_\_\_\_\_

## ADDITIONAL NOTES

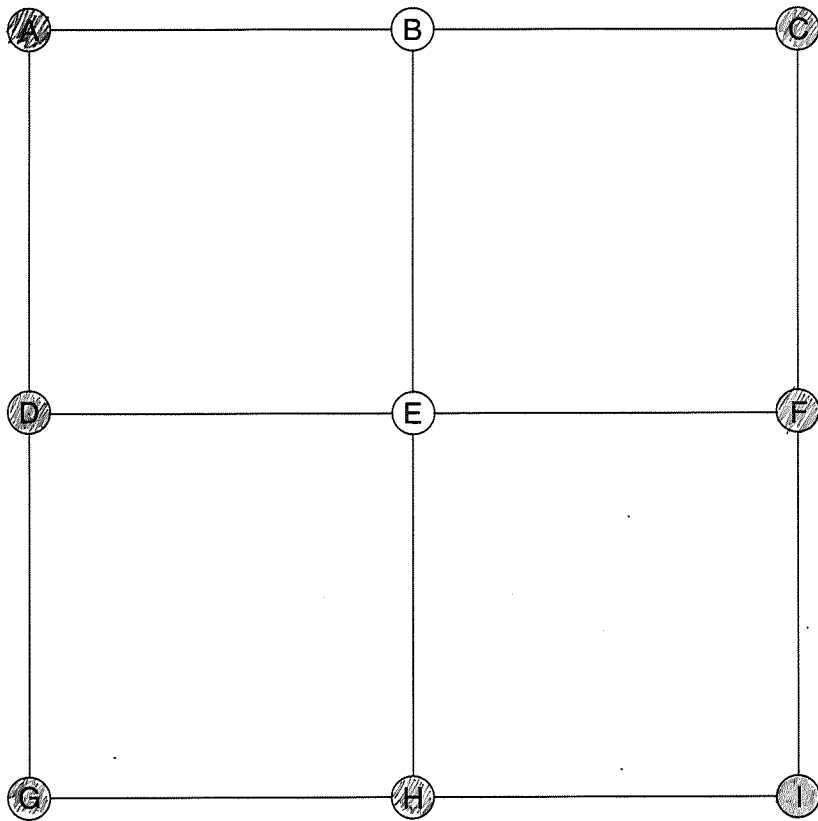

## A (NORTHWEST CORNER)

Date Located: 10/3/19  
 By: SEM MWH  
 Monument Description: FO RR SPIKE  
 Monument Witnesses: 5'x10' I-BEAM POST N 13.90'  
PK NAIL IN POWER POLE NE 21.24'  
1/2" REBAR W/CAP SE 40.77

Field Book: 17 Page: 73

## B (NORTH QUARTER CORNER)

Date Located: \_\_\_\_\_  
 By: \_\_\_\_\_  
 Monument Description: \_\_\_\_\_  
 Monument Witnesses: \_\_\_\_\_

Field Book: \_\_\_\_\_ Page: \_\_\_\_\_

## C (NORTHEAST CORNER)

Date Located: 10/3/19  
 By: SEM MWH  
 Monument Description: FO RR SPIKE  
 Monument Witnesses: RR SPIKE W 13.86'  
RR RAIL FCP ESE 31.35'  
NAIL IN B. CAP POWER POLE SE 47.40'

Field Book: 17 Page: 76

## D (WEST QUARTER CORNER)

Date Located: 10/3/19  
 By: SEM MWH  
 Monument Description: MAG NAIL  
 Monument Witnesses: SEE Pg 198 "F"

Field Book: 17 Page: 78

## E (CENTER OF SECTION)

Date Located: \_\_\_\_\_  
 By: \_\_\_\_\_  
 Monument Description: \_\_\_\_\_  
 Monument Witnesses: \_\_\_\_\_

Field Book: \_\_\_\_\_ Page: \_\_\_\_\_

## F (EAST QUARTER CORNER)

Date Located: 10/3/19  
 By: SEM MWH  
 Monument Description: FO RR SPIKE  
 Monument Witnesses: 1/2" REBAR W/CAP NW 38.92'  
RR RAIL FCP ENE 26.21'  
RR RAIL FCP W 19.89

Field Book: 17 Page: 77

## G (SOUTHWEST CORNER)

Date Located: 3/27/19  
 By: SEM MWH  
 Monument Description: MAG NAIL W/ CO TAG  
 Monument Witnesses: SEE Pg 198 "I"

Field Book: 12 Page: 71

## H (SOUTH QUARTER CORNER)

Date Located: 3/27/19  
 By: SEM MWH  
 Monument Description: MAG NAIL W/ CO TAG  
 Monument Witnesses: SEE Pg 202 "B"

Field Book: 12 Page: 73

## I (SOUTHEAST CORNER)

Date Located: \_\_\_\_\_  
 By: \_\_\_\_\_  
 Monument Description: \_\_\_\_\_  
 Monument Witnesses: SEE PAGE 203 "A"

Field Book: 12 Page: 74

## ADDITIONAL NOTES

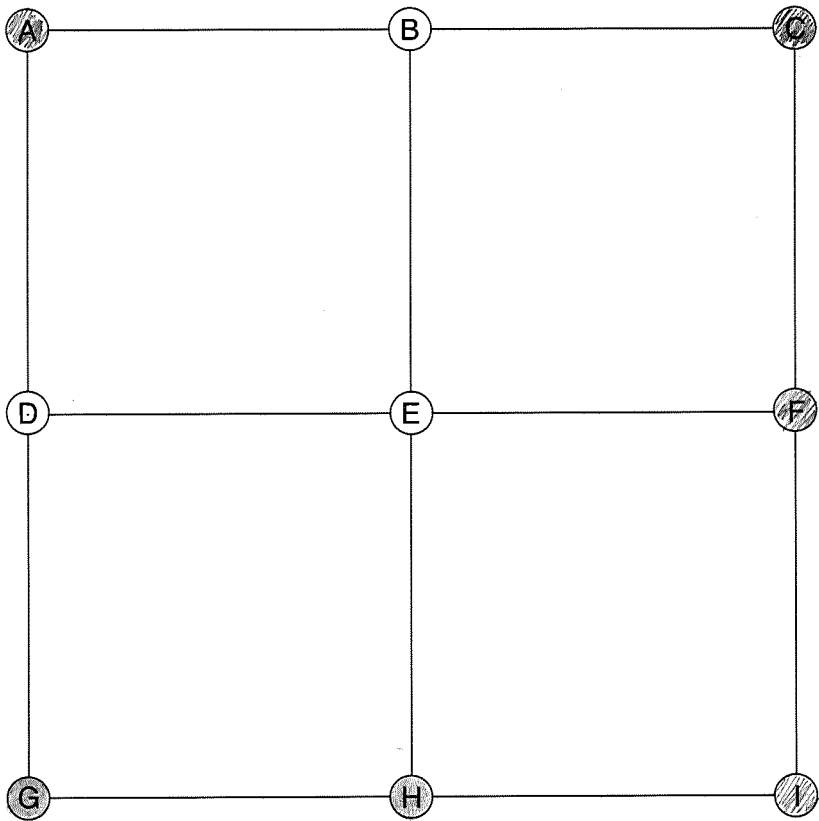

E (CENTER OF SECTION)

Date Located: \_\_\_\_\_  
By: \_\_\_\_\_  
Monument Description: \_\_\_\_\_  
Monument Witnesses: \_\_\_\_\_  
\_\_\_\_\_

Field Book: \_\_\_\_\_ Page: \_\_\_\_\_

F (EAST QUARTER CORNER)

Date Located: 10/3/19  
By: SEM MWH  
Monument Description: MAG NAIL W/ CO TAG  
Monument Witnesses: RR RAIL FCP W 19.35'  
1/2" REBAR W/ CAP NE 28.74'  
1/2" REBAR W/ CAP SE 30.65'

Field Book: 17 Page: 78

A (NORTHWEST CORNER)

Date Located: 12/3/17  
By: SEM  
Monument Description: FO 3/4" IRON PIPE FLUSH  
Monument Witnesses: FO 3/4" I. PIPE W 77' ±  
FO 1/2" I. PIPE E 90' ±

Field Book: 8 Page: 43

G (SOUTHWEST CORNER)

Date Located: \_\_\_\_\_  
By: \_\_\_\_\_  
Monument Description: \_\_\_\_\_  
Monument Witnesses: SEE PAGE 199 "I"  
SE 6-30-6

Field Book: \_\_\_\_\_ Page: \_\_\_\_\_

B (NORTH QUARTER CORNER)

Date Located: \_\_\_\_\_  
By: \_\_\_\_\_  
Monument Description: \_\_\_\_\_  
Monument Witnesses: \_\_\_\_\_  
\_\_\_\_\_

Field Book: \_\_\_\_\_ Page: \_\_\_\_\_

H (SOUTH QUARTER CORNER)

Date Located: \_\_\_\_\_  
By: \_\_\_\_\_  
Monument Description: \_\_\_\_\_  
Monument Witnesses: SEE PAGE 203 "B"  
N 1/4 POST 8-30-6

Field Book: \_\_\_\_\_ Page: \_\_\_\_\_

C (NORTHEAST CORNER)

Date Located: 10/3/19  
By: SEM MWH  
Monument Description: FO RR SPIKE  
Monument Witnesses: SEE Pg 197 "A"

Field Book: 17 Page: 73

I (SOUTHEAST CORNER)

Date Located: 3/27/19  
By: SEM  
Monument Description: MAG NAIL W/ CO TAG  
Monument Witnesses: NAIL IN B. CAP TEL POLE WNW 48.24'  
NAIL IN B. CAP TEL POLE NE 42.36'  
NAIL IN B. CAP POWER POLE SE 31.99'

Field Book: 12 Page: 71

D (WEST QUARTER CORNER)

Date Located: \_\_\_\_\_  
By: \_\_\_\_\_  
Monument Description: \_\_\_\_\_  
Monument Witnesses: \_\_\_\_\_  
\_\_\_\_\_

Field Book: \_\_\_\_\_ Page: \_\_\_\_\_

ADDITIONAL NOTES

\_\_\_\_\_  
\_\_\_\_\_  
\_\_\_\_\_  
\_\_\_\_\_  
\_\_\_\_\_  
\_\_\_\_\_  
\_\_\_\_\_  
\_\_\_\_\_  
\_\_\_\_\_  
\_\_\_\_\_



## ADDITIONAL NOTES



Date Located: \_\_\_\_\_  
By: \_\_\_\_\_  
Monument Description: \_\_\_\_\_  
Monument Witnesses: SEE PAGE 337 "I"  
SE 1-30-5  
\_\_\_\_\_  
\_\_\_\_\_  
\_\_\_\_\_

Field Book: \_\_\_\_\_ Page: \_\_\_\_\_

Date Located: \_\_\_\_\_  
By: \_\_\_\_\_  
Monument Description: \_\_\_\_\_  
Monument Witnesses: \_\_\_\_\_  
\_\_\_\_\_  
\_\_\_\_\_  
\_\_\_\_\_  
Field Book: \_\_\_\_\_ Page: \_\_\_\_\_

Date Located: \_\_\_\_\_  
By: \_\_\_\_\_  
Monument Description: \_\_\_\_\_  
Monument Witnesses: SEE PAGE 199 "I"  
SE 6-30-6  
\_\_\_\_\_  
\_\_\_\_\_  
\_\_\_\_\_

Field Book: \_\_\_\_\_ Page: \_\_\_\_\_

Date Located: 10/4/19  
By: SRM MWH  
Monument Description: RR RAIL FCP  
Monument Witnesses: 3" DIA STEEL FCP NE 9.6'  
  
  
  
Field Book: 18 Page: 3

Date Located: \_\_\_\_\_  
By: \_\_\_\_\_  
Monument Description: \_\_\_\_\_  
Monument Witnesses: \_\_\_\_\_  
\_\_\_\_\_  
\_\_\_\_\_  
\_\_\_\_\_  
\_\_\_\_\_  
Field Book: \_\_\_\_\_ Page: \_\_\_\_\_

Date Located: \_\_\_\_\_  
By: \_\_\_\_\_  
Monument Description: \_\_\_\_\_  
Monument Witnesses: \_\_\_\_\_  
\_\_\_\_\_  
\_\_\_\_\_  
\_\_\_\_\_

Field Book: \_\_\_\_\_ Page: \_\_\_\_\_

Date Located: 10/4/19  
By: JRM MWH  
Monument Description: SET RR SPIKE  
Monument Witnesses: RR RAIL FCP N 18.25'  
1/2" REBAR W/CAP NE 22.30'  
RR RAIL FCP S 18.30'

Field Book: 18 Page: 2

Date Located: 10/4/19  
By: JRM MWH  
Monument Description: FO RR SPIKE  
Monument Witnesses: 1/2" REBAR w/CAP NW 32.16'  
1/2" REBAR w/CAP NNE 20.38'  
RR RAIL FCP NE 23.42'

Field Book: 18 Page: 1

Date Located: \_\_\_\_\_  
By: \_\_\_\_\_  
Monument Description: \_\_\_\_\_  
Monument Witnesses: \_\_\_\_\_  
\_\_\_\_\_  
\_\_\_\_\_  
\_\_\_\_\_  
\_\_\_\_\_  
Field Book: \_\_\_\_\_ Page: \_\_\_\_\_

ADDITIONAL NOTES

Field Book: 12 Page: 70Field Book: 12 Page: 72Field Book: 2 Page: 64

## Field Book: \_\_\_\_\_ Page: \_\_\_\_\_

Field Book: 2 Page: 64

Field Book: 4 Page: 27Field Book: 12 Page: 71Field Book: 4 Page: 26

## Field Book: \_\_\_\_\_ Page: \_\_\_\_\_

[illegible]

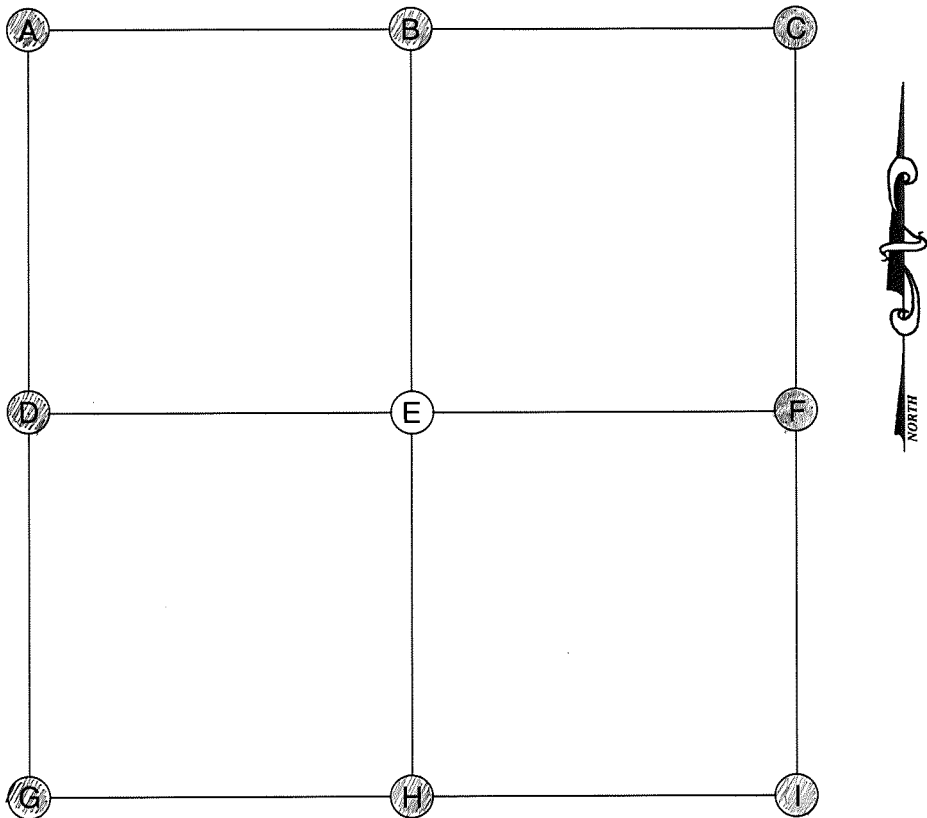

A (NORTHWEST CORNER)

Date Located: 3/27/19  
By: SEM MWH  
Monument Description: MAG NAIL W/ CO TAG  
Monument Witnesses: SEE Pg 198 "T"

Field Book: 12 Page: 71

B (NORTH QUARTER CORNER)

Date Located: 3/27/19  
By: SEM MWH  
Monument Description: MAG NAIL W/ CO TAG  
Monument Witnesses: NAIL IN B. CAP TEL POLE ENE 43.77  
NAIL IN B. CAP POWER POLE SSE 21.11

Field Book: 12 Page: 73

C (NORTHEAST CORNER)

Date Located: \_\_\_\_\_  
By: \_\_\_\_\_  
Monument Description: \_\_\_\_\_  
Monument Witnesses: SEE PAGE 203 "N"  
NW 10-30-6

Field Book: 12 Page: 74

D (WEST QUARTER CORNER)

Date Located: 3/27/19  
By: SEM MWH  
Monument Description: RR SPIKE  
Monument Witnesses: SEE Pg 201 "F"

Field Book: 12 Page: 72

E (CENTER OF SECTION)

Date Located: \_\_\_\_\_  
By: \_\_\_\_\_  
Monument Description: \_\_\_\_\_  
Monument Witnesses: \_\_\_\_\_

Field Book: \_\_\_\_\_ Page: \_\_\_\_\_

F (EAST QUARTER CORNER)

Date Located: \_\_\_\_\_  
By: \_\_\_\_\_  
Monument Description: \_\_\_\_\_  
Monument Witnesses: SEE PAGE 203 "D"  
W 1/4 POST 10-30-6

Field Book: 12 Page: 76

G (SOUTHWEST CORNER)

Date Located: 7/8/16  
By: SEM  
Monument Description: BRONZE MONUMENT  
Monument Witnesses: SEE Pg 201 "I"

Field Book: 4 Page: 26

H (SOUTH QUARTER CORNER)

Date Located: 10/4/19  
By: SEM MWH  
Monument Description: MAG NAIL  
Monument Witnesses: NAIL IN B. CAP POWER POLE NNW 20.40  
NAIL IN B. CAP NE 56.00  
1/2" REBAR W/ CAP SW 32.32

Field Book: 18 Page: 4

I (SOUTHEAST CORNER)

Date Located: 10/4/19  
By: SEM MWH  
Monument Description: RR SPIKE  
Monument Witnesses: 1/2" REBAR W/ CAP NE 57.52  
1/2" REBAR W/ CAP SE 59.92  
NAIL IN B CAP CAP POWER POLE SW 49.56

Field Book: 18 Page: 5

ADDITIONAL NOTES

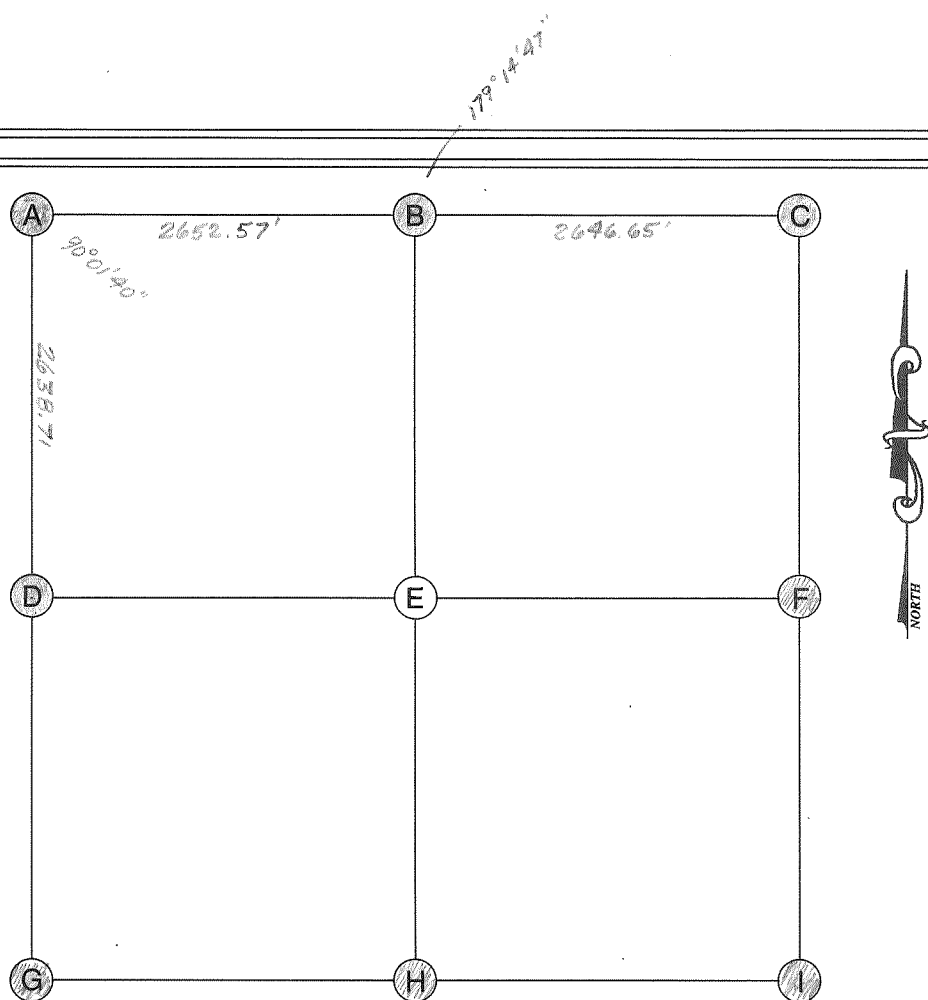

## E (CENTER OF SECTION)

Date Located: \_\_\_\_\_  
By: \_\_\_\_\_  
Monument Description: \_\_\_\_\_  
Monument Witnesses: \_\_\_\_\_  
\_\_\_\_\_  
\_\_\_\_\_

Field Book: \_\_\_\_\_ Page: \_\_\_\_\_

## F (EAST QUARTER CORNER)

Date Located: 10/4/19  
By: SEM MWH  
Monument Description: RR SPIKE  
Monument Witnesses: RR RAIL FCP W 19.60'  
NAIL IN B CAP POWER POLE NW 48.77'  
RR RAIL FCP E 20.1'  
\_\_\_\_\_  
\_\_\_\_\_

Field Book: 18 Page: 6

## A (NORTHWEST CORNER)

Date Located: 3/13/2007 UPDATED 3/27/19 SEM MWH  
By: RJK + MEK  
Monument Description: BRONZE/BRASS MARKER  
Monument Witnesses: 5/85 TIES:  
RIP 77.5' SW  
RIP 101.7' SW  
PL NAIL IN POLE (100' W - 1099.5) 42.0' NE  
\_\_\_\_\_  
\_\_\_\_\_

Field Book: 12 Page: 74

## G (SOUTHWEST CORNER)

Date Located: 10/4/19  
By: SEM MWH  
Monument Description: RR SPIKE  
Monument Witnesses: SEE Pg 202 "I"  
\_\_\_\_\_  
\_\_\_\_\_

Field Book: 18 Page: 5

## B (NORTH QUARTER CORNER)

Date Located: 3/13/2007 UPDATED 3/27/19 SEM MWH  
By: RJK + MEK  
Monument Description: MASONRY NAIL NAIL NAIL  
Monument Witnesses: \_\_\_\_\_  
\_\_\_\_\_  
\_\_\_\_\_

Field Book: 12 Page: 75

## H (SOUTH QUARTER CORNER)

Date Located: 10/4/19  
By: SEM MWH  
Monument Description: FO RR SPIKE  
Monument Witnesses: 1/2" REBAR W/CAP SW 44.94'  
RR RAIL FCP S 20.90'  
1/2" REBAR W/CAP SE 29.60'  
\_\_\_\_\_  
\_\_\_\_\_

Field Book: 18 Page: 8

## C (NORTHEAST CORNER)

Date Located: 3/13/2007 UPDATED 5/14/18  
By: RJK + MEK SEM  
Monument Description: RR SPIKE (BURIED 0.6')  
Monument Witnesses: OLD TIES:  
RIP 31.4' SE  
CONC. HEADWALL (NW COR.) 24.75' NE  
SIGN POST 42.2' NW  
\_\_\_\_\_  
\_\_\_\_\_

Field Book: 9 Page: 04

## I (SOUTHEAST CORNER)

Date Located: 10/4/19  
By: SEM MWH  
Monument Description: BRONZE MONUMENT  
Monument Witnesses: SEE Pg 204 "G"  
\_\_\_\_\_  
\_\_\_\_\_

Field Book: 18 Page: 7

## D (WEST QUARTER CORNER)

Date Located: 3/13/2007 UPDATED 3/27/19 SEM MWH  
By: RJK + MEK  
Monument Description: RR SPIKE  
Monument Witnesses: \_\_\_\_\_  
\_\_\_\_\_  
\_\_\_\_\_

Field Book: 12 Page: 76

## ADDITIONAL NOTES

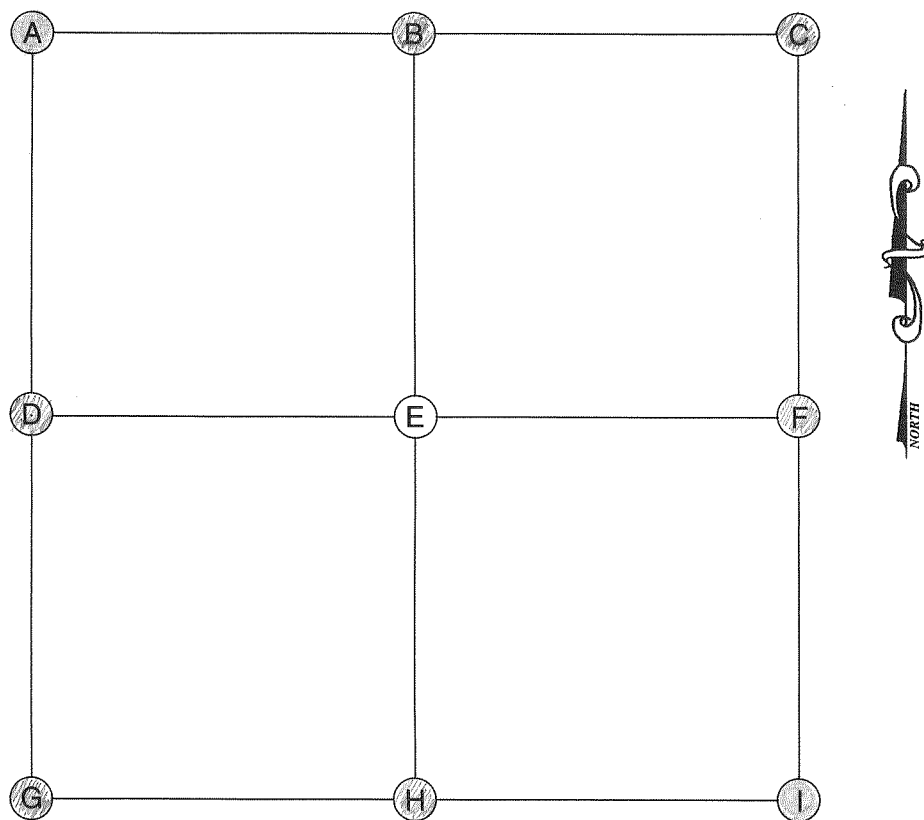

Date Located: 5/14/18  
By: JEM  
Monument Description: 5/8" REBAR 4" DEEP  
Monument Witnesses: SEE Pg 196 "I"

Date Located: 4/3/19  
By: SRM MWH  
Monument Description: BRONZE MONUMENT  
Monument Witnesses: N FACE RR RAIL FCP S 16.75'  
NAIL IN B. CAP POWER POLE SSE 35.54'  
"MCCREA" CAPED IRON SE 76.22'

Date Located: 4/3/19  
By: SEM MWH  
Monument Description: 1/2" REBAR  
Monument Witnesses: NAIL IN B. CAP P. POLE NE 54.9'  
MAG NAIL IN POWER POLE ESE 68.52'  
NAIL IN B. CAP POWER POLE SSE 30.83'

Date Located: 10/4/19  
By: SEM MWL  
Monument Description: RR SPIKE  
Monument Witnesses: SEE Pg 203 "F"

Date Located: \_\_\_\_\_  
By: \_\_\_\_\_  
Monument Description: \_\_\_\_\_  
Monument Witnesses: \_\_\_\_\_  
\_\_\_\_\_  
\_\_\_\_\_  
\_\_\_\_\_

Date Located: 10/23/19  
By: SEM MWH  
Monument Description: MAG NAIL w/co TAG  
Monument Witnesses: 1/2" REBAR w/CAP NE 35.13'  
1/2" REBAR w/CAP SE 22.97'  
E FACE 8" CONE POST W 21.5

Date Located: 10/4/19  
By: SEM MWLH  
Monument Description: BRONZE MONUMENT  
Monument Witnesses: 1/2" REBAR W/CAP NW 43.93'  
1/2" REBAR W/CAP NE 36.22'  
1/2" REBAR W/CAP SW 45.53'

Date Located: 10/23/19  
By: SEM MMH  
Monument Description: MAG NAIL  
Monument Witnesses: NAIL IN B. CAP POWER POLE NNE 19  
FO 5/8" REBAR W/ CAP NE 53.87'  
FO PK NAIL E 50.0'

Date Located: 3/26/19  
By: WZM  
Monument Description: BRONZE MARKER  
Monument Witnesses: SEE Pg 206 "A"

Field Book: 12 Page: 60

## ADDITIONAL NOTES



Lake  
13-30-6

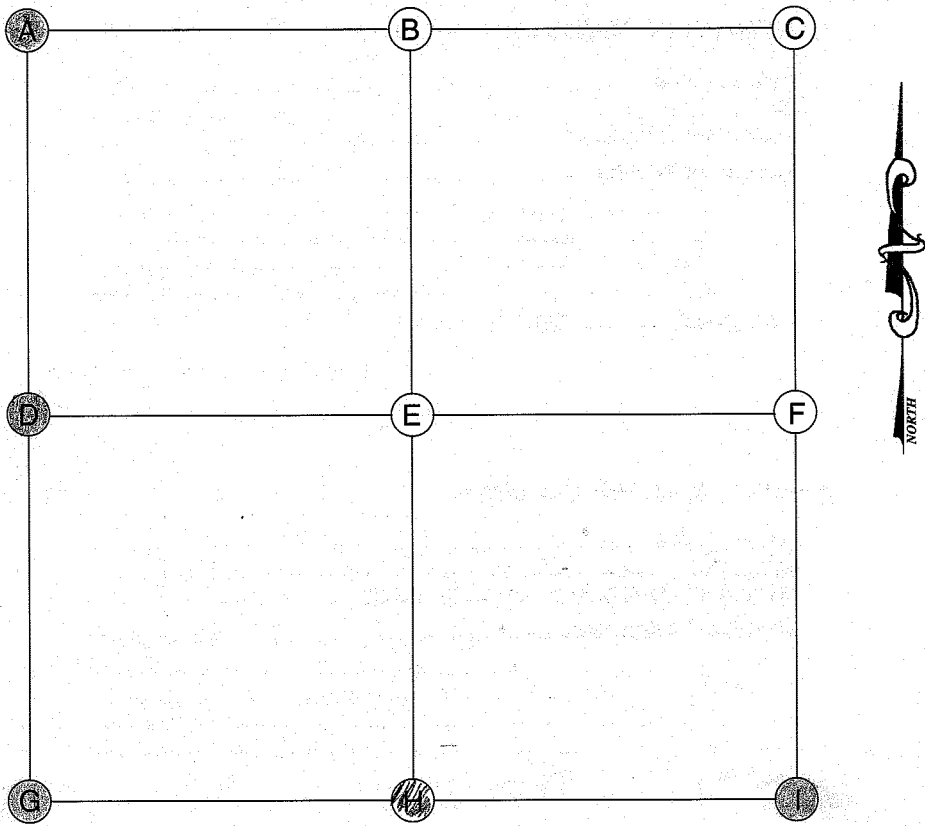

A (NORTHWEST CORNER)

Date Located: 3/26/19  
By: SRM  
Monument Description: BRONZE MONUMENT  
Monument Witnesses: NAIL IN B. CAP REMOVED POLE ENE 68.44'  
NAIL IN B. CAP POWER POLE SE 39.60'

Field Book: 12 Page: 60

B (NORTH QUARTER CORNER)

Date Located: \_\_\_\_\_  
By: \_\_\_\_\_  
Monument Description: \_\_\_\_\_  
Monument Witnesses: \_\_\_\_\_

Field Book: \_\_\_\_\_ Page: \_\_\_\_\_

C (NORTHEAST CORNER)

Date Located: \_\_\_\_\_  
By: \_\_\_\_\_  
Monument Description: \_\_\_\_\_  
Monument Witnesses: \_\_\_\_\_

Field Book: \_\_\_\_\_ Page: \_\_\_\_\_

D (WEST QUARTER CORNER)

Date Located: \_\_\_\_\_  
By: \_\_\_\_\_  
Monument Description: \_\_\_\_\_  
Monument Witnesses: SEE PAGE 207 "F"  
E14 POST 14-30-6

Field Book: \_\_\_\_\_ Page: \_\_\_\_\_

E (CENTER OF SECTION)

Date Located: \_\_\_\_\_  
By: \_\_\_\_\_  
Monument Description: \_\_\_\_\_  
Monument Witnesses: \_\_\_\_\_

Field Book: \_\_\_\_\_ Page: \_\_\_\_\_

F (EAST QUARTER CORNER)

Date Located: \_\_\_\_\_  
By: \_\_\_\_\_  
Monument Description: \_\_\_\_\_  
Monument Witnesses: \_\_\_\_\_

Field Book: \_\_\_\_\_ Page: \_\_\_\_\_

G (SOUTHWEST CORNER)

Date Located: \_\_\_\_\_  
By: \_\_\_\_\_  
Monument Description: \_\_\_\_\_  
Monument Witnesses: SEE PAGE 207 "I"  
SE 14-30-6

Field Book: \_\_\_\_\_ Page: \_\_\_\_\_

H (SOUTH QUARTER CORNER)

Date Located: 3/26/19  
By: SRM  
Monument Description: WABASH CO MONUMENT  
Monument Witnesses: NAIL IN B. CAP P. POLE WNW 71.69'  
E RR RAIL FCP N 19.56'  
E RR RAIL FCP S 22.57'

Field Book: 12 Page: 65

I (SOUTHEAST CORNER)

Date Located: 6/1/2010  
By: MEK  
Monument Description: BRASS / BRONZE MONUMENT (NO PLATE)  
Monument Witnesses: RR SPIKE ON S. EDGE CR1300S 56.46' W-SW  
- NAIL W/ BOT. CAP IN NE FACE OF P. POLE 51.39' NW  
- SW COR. OF SE GUARDRAIL POST 60.76' N-NE  
- SE " " SW " " 65.65' N-NW

Field Book: 12 Page: 64 UPDATED 3/26/19 SRM

ADDITIONAL NOTES

\_\_\_\_\_  
\_\_\_\_\_  
\_\_\_\_\_  
\_\_\_\_\_  
\_\_\_\_\_  
\_\_\_\_\_  
\_\_\_\_\_  
\_\_\_\_\_  
\_\_\_\_\_  
\_\_\_\_\_



Date Located: \_\_\_\_\_  
By: \_\_\_\_\_  
Monument Description: \_\_\_\_\_  
Monument Witnesses: \_\_\_\_\_  
\_\_\_\_\_  
\_\_\_\_\_  
\_\_\_\_\_

Date Located: 8/13/92  
By: JB MOYER - EC HAINES  
Monument Description: PK NAIL  
Monument Witnesses: E. FACE OF A RR RAIL FCP - W 22.74'  
SET 1/2" X 30" REBAR W/CAP SW 30.84'  
1/2" REBAR W/CAP NW 26.15'

Date Located: \_\_\_\_\_  
By: \_\_\_\_\_  
Monument Description: \_\_\_\_\_  
Monument Witnesses: \_\_\_\_\_  
\_\_\_\_\_  
\_\_\_\_\_  
\_\_\_\_\_

Date Located: \_\_\_\_\_  
By: \_\_\_\_\_  
Monument Description: \_\_\_\_\_  
Monument Witnesses: SEE PAGE 208 "I"  
SE 15-30-6  
\_\_\_\_\_  
\_\_\_\_\_  
\_\_\_\_\_

Date Located: \_\_\_\_\_  
By: \_\_\_\_\_  
Monument Description: \_\_\_\_\_  
Monument Witnesses: \_\_\_\_\_  
\_\_\_\_\_  
\_\_\_\_\_  
\_\_\_\_\_

Date Located: 8/31/92  
By: JR MOYER - ECHAINES  
Monument Description: ALUMINUM  
Monument Witnesses: N FACE OF 8" SQ CONC FCP S 21.32  
FO 1/2" REBAR UNDER A WARASH CO MON SIGN N 15.77  
" " " AT EDGE OF PAVEMENT SW 7.16  
1/2" REBAR W/CAP NE 21.17

Date Located: \_\_\_\_\_  
By: \_\_\_\_\_  
Monument Description: \_\_\_\_\_  
Monument Witnesses: SEE PAGE 204 "I"  
SE 11-30-16

Date Located: 8/13/92  
By: JAMONA-EC NAIMES  
Monument Description: ALUM. DISK  
Monument Witnesses: \_\_\_\_\_  
FOUR NAIL IN SW. FACE OF A PP NW 29.34  
" " " " SE " " " " SW 29.89  
MAG NAIL IN "SHS" TAG POLE NW 29.37  
NAIL IN B. CAP IN ANCHOR POLE SW 30.15

Date Located: \_\_\_\_\_  
By: \_\_\_\_\_  
Monument Description: \_\_\_\_\_  
Monument Witnesses: \_\_\_\_\_  
\_\_\_\_\_  
\_\_\_\_\_  
\_\_\_\_\_

[illegible]



Field Book: \_\_\_\_\_ Page: \_\_\_\_\_

F (EAST QUARTER CORNER)

Field Book: \_\_\_\_\_ Page: \_\_\_\_\_

G (SOUTHWEST CORNER)

Field Book: \_\_\_\_\_ Page: \_\_\_\_\_

## H (SOUTH QUARTER CORNER)

Field Book: 12 Page: 67

I (SOUTHEAST CORNER)

Field Book: 2 Page: 32 UPDATED 3/26/19 JRM

### ADDITIONAL NOTES

A (NORTHWEST CORNER)

Field Book: \_\_\_\_\_ Page: \_\_\_\_\_

B (NORTH QUARTER CORNER)

Field Book: \_\_\_\_\_ Page: \_\_\_\_\_

C (NORTHEAST CORNER)

Field Book: \_\_\_\_\_ Page: \_\_\_\_\_

D (WEST QUARTER CORNER)

Field Book: \_\_\_\_\_ Page: \_\_\_\_\_

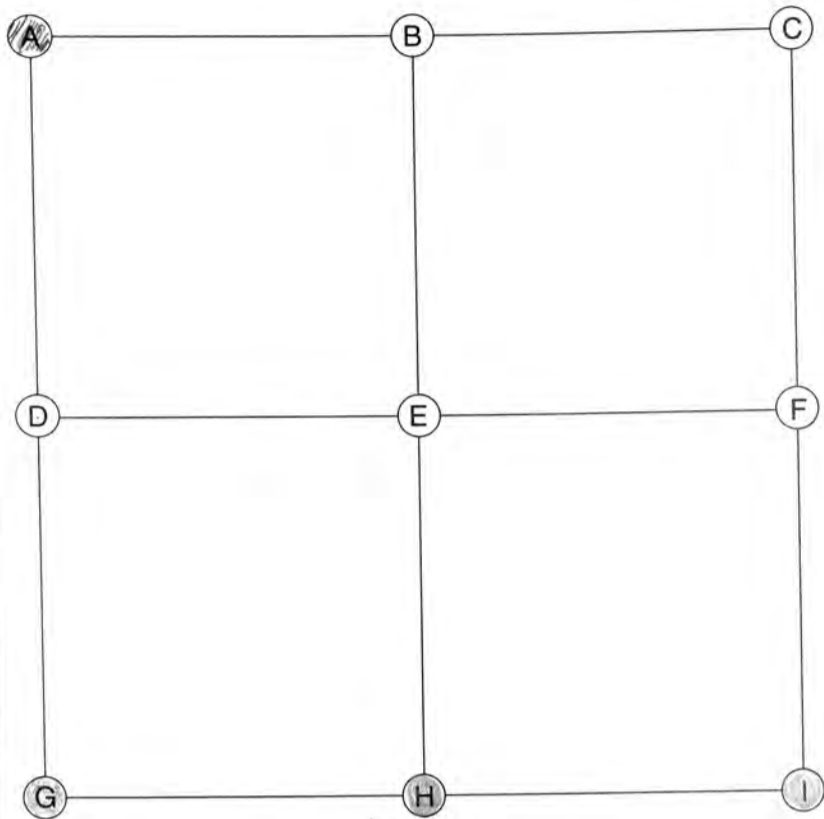

## A (NORTHWEST CORNER)

Date Located: 7/8/16  
 By: SEM  
 Monument Description: BRONZE MONUMENT  
 Monument Witnesses: SEE Pg 201 "I"

Field Book: 4 Page: 26

## B (NORTH QUARTER CORNER)

Date Located: \_\_\_\_\_  
 By: \_\_\_\_\_  
 Monument Description: \_\_\_\_\_  
 Monument Witnesses: \_\_\_\_\_

Field Book: \_\_\_\_\_ Page: \_\_\_\_\_

## C (NORTHEAST CORNER)

Date Located: \_\_\_\_\_  
 By: \_\_\_\_\_  
 Monument Description: \_\_\_\_\_  
 Monument Witnesses: \_\_\_\_\_

Field Book: \_\_\_\_\_ Page: \_\_\_\_\_

## D (WEST QUARTER CORNER)

Date Located: \_\_\_\_\_  
 By: \_\_\_\_\_  
 Monument Description: \_\_\_\_\_  
 Monument Witnesses: \_\_\_\_\_

Field Book: \_\_\_\_\_ Page: \_\_\_\_\_

## E (CENTER OF SECTION)

Date Located: \_\_\_\_\_  
 By: \_\_\_\_\_  
 Monument Description: \_\_\_\_\_  
 Monument Witnesses: \_\_\_\_\_

Field Book: \_\_\_\_\_ Page: \_\_\_\_\_

## F (EAST QUARTER CORNER)

Date Located: \_\_\_\_\_  
 By: \_\_\_\_\_  
 Monument Description: \_\_\_\_\_  
 Monument Witnesses: \_\_\_\_\_

Field Book: \_\_\_\_\_ Page: \_\_\_\_\_

## G (SOUTHWEST CORNER)

Date Located: \_\_\_\_\_  
 By: \_\_\_\_\_  
 Monument Description: \_\_\_\_\_  
 Monument Witnesses: SEE PAGE 210 "I"  
SE 17-30-6

Field Book: \_\_\_\_\_ Page: \_\_\_\_\_

## H (SOUTH QUARTER CORNER)

Date Located: 6/24/92  
 By: JR MOYER - EC HAINES  
 Monument Description: ALUMINUM  
 Monument Witnesses: FOUR IRON FENCE POST NW 28.34  
SOUTH FACE OF 8" SQ CONC. FCP N 20.00  
NORTH FACE OF 8" SQ CONC. FCP S 18.85  
NAG NAIL IN POWER POLE ENE 86.35'

Field Book: 1 Page: 64 UPDATED 10/10/16 SEM

## I (SOUTHEAST CORNER)

Date Located: 6/24/92  
 By: JR MOYER - EC HAINES  
 Monument Description: P.W. NAIL BRASS PLUG 10/10/16  
 Monument Witnesses: 1/2" REBAR w/CAP NE 62.80'  
SET NAIL IN W/ TIE CAP IN EAST FACE OF POWER POLE NWN 15.34  
1/2" REBAR w/CAP NW 62.34'  
CENTER OF A RR RAIL FCP WSW 46.10'

Field Book: 1 Page: 64 UPDATED 10/10/16 SEM

## ADDITIONAL NOTES

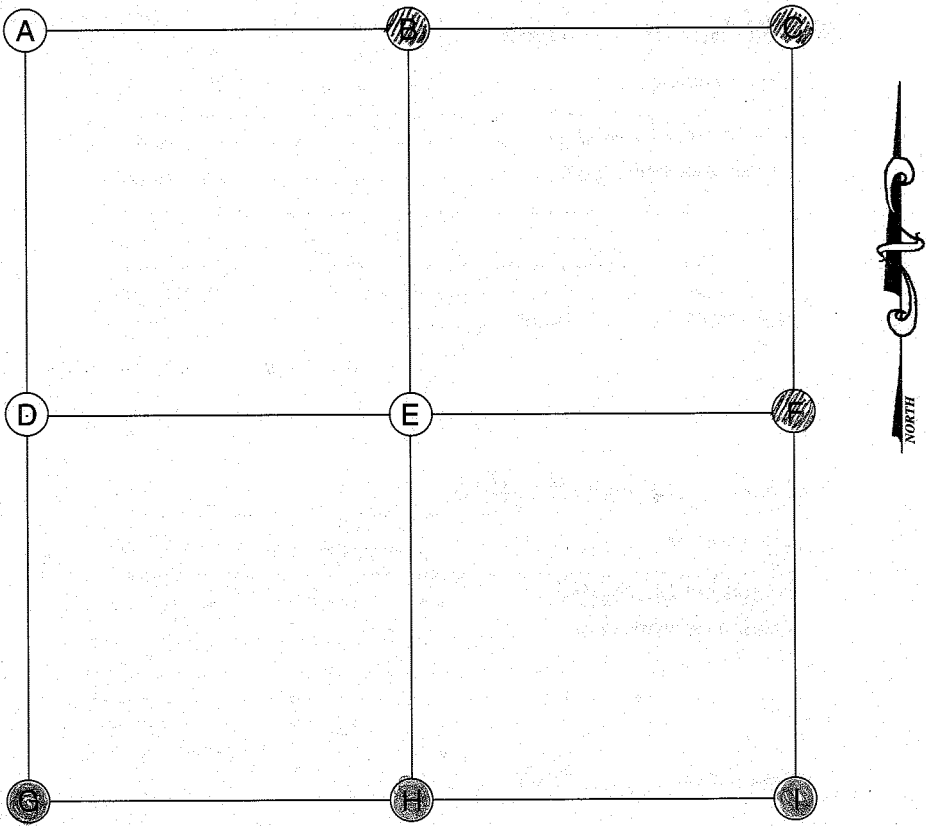

A (NORTHWEST CORNER)

Date Located: \_\_\_\_\_  
By: \_\_\_\_\_  
Monument Description: \_\_\_\_\_  
Monument Witnesses: \_\_\_\_\_  
\_\_\_\_\_

Field Book: \_\_\_\_\_ Page: \_\_\_\_\_

B (NORTH QUARTER CORNER)

Date Located: 7/8/16  
By: SRM  
Monument Description: RR SPIKE  
Monument Witnesses: SEE Pg 201 "H"  
\_\_\_\_\_

Field Book: 4 Page: 27

C (NORTHEAST CORNER)

Date Located: 7/8/16  
By: SRM  
Monument Description: BRONZE MONUMENT  
Monument Witnesses: SEE Pg 201 "I"  
\_\_\_\_\_

Field Book: 4 Page: 26

D (WEST QUARTER CORNER)

Date Located: \_\_\_\_\_  
By: \_\_\_\_\_  
Monument Description: \_\_\_\_\_  
Monument Witnesses: \_\_\_\_\_  
\_\_\_\_\_

Field Book: \_\_\_\_\_ Page: \_\_\_\_\_

E (CENTER OF SECTION)

Date Located: \_\_\_\_\_  
By: \_\_\_\_\_  
Monument Description: \_\_\_\_\_  
Monument Witnesses: \_\_\_\_\_  
\_\_\_\_\_

Field Book: \_\_\_\_\_ Page: \_\_\_\_\_

F (EAST QUARTER CORNER)

Date Located: 2/1/17  
By: SRM  
Monument Description: FO MAG NAIL  
Monument Witnesses: 1/2" REBAR W/CAP NW 38.92'  
1/2" REBAR W/CAP NE 39.82'  
W. FACE BROKEN 10" SQ CONC FCP E 20.13'  
NAIL IN TAG IN POWER POLE WSW 19.44'  
E FACE 10" SQ CONC FCP W 20.07'

Field Book: 5 Page: 63

G (SOUTHWEST CORNER)

Date Located: 6/24/92  
By: JAMMYER-EL HAINES  
Monument Description: P.K. NAIL  
Monument Witnesses: FO 1 3/4" IRON ROD - WABASH CO. MARKER NE 50.39  
FO 1 3/4" IRON ROD - WABASH CO. MARKER SE 49.83  
FO OLD SPIKE NAIL IN SW CORNER OF LARDY TRACT NW 63.25  
E OF STATE ROAD IS 2.6' WEST OF CORNER

Field Book: 1 Page: 62 UPDATED 3/27/19 SRM

H (SOUTH QUARTER CORNER)

Date Located: 6/24/92  
By: JAMMYER-EL HAINES  
Monument Description: ALUM DISH  
Monument Witnesses: FO 1 3/4" IRON ROD - WABASH CO. NWE 20.38  
FO 1 3/4" IRON ROD - WABASH CO. SE 22.79  
FO P.K. NAIL IN WASHER STAMPED THIS DIS. IN NE FACE OF D.P. SSE 21.04  
FO 1 3/4" IRON ROD - WABASH COUNTY SW 25.68

Field Book: 1 Page: 63

I (SOUTHEAST CORNER)

Date Located: 6/24/92  
By: JAMMYER-EL HAINES  
Monument Description: ALUM DISH  
Monument Witnesses: FO 1 3/4" IRON ROD - WABASH CO. NWE 40.96  
SET NAIL IN BOTTLE CAP IN NW FACE OF PHONE POLE WNW 62.44  
SET 1/2" x 30" REBAR W/CAP UNDER THE WABASH CO. SURV. MARKER SE 55.22  
FO P.K. NAIL IN WASHER STAMPED THIS DIS. IN NW FACE OF D.P. SW 30.48

Field Book: 1 Page: 63 UPDATED 10/10/16 SRM  
12 Pg 68

ADDITIONAL NOTES



Date Located: \_\_\_\_\_  
By: \_\_\_\_\_  
Monument Description: \_\_\_\_\_  
Monument Witnesses: \_\_\_\_\_  
\_\_\_\_\_  
\_\_\_\_\_  
\_\_\_\_\_  
\_\_\_\_\_

Date Located: \_\_\_\_\_  
By: \_\_\_\_\_  
Monument Description: \_\_\_\_\_  
Monument Witnesses: \_\_\_\_\_  
\_\_\_\_\_  
\_\_\_\_\_  
\_\_\_\_\_

Date Located: \_\_\_\_\_  
By: \_\_\_\_\_  
Monument Description: \_\_\_\_\_  
Monument Witnesses: \_\_\_\_\_  
\_\_\_\_\_  
\_\_\_\_\_  
\_\_\_\_\_

Date Located: 3/27/19  
By: SEM  
Monument Description: RR SPIKE  
Monument Witnesses: 1/2" REBAR W/CAP ENE 35.43'  
NAIL IN B. CAP IN REMC POLE ESE 28.83'

Date Located: \_\_\_\_\_  
By: \_\_\_\_\_  
Monument Description: \_\_\_\_\_  
Monument Witnesses: \_\_\_\_\_  
\_\_\_\_\_  
\_\_\_\_\_  
\_\_\_\_\_

Date Located: 6/24/92  
By: JR MOYER - EC NAMES  
Monument Description: AWSM DISH  
Monument Witnesses: FN 13/4" IRON ROD W/ BASIL COM MARKER SE 2  
SET 1/2"x30" REBAR W/ CAP UNDER WASH CO SURVIVOR MARKER NW  
" " " " " " " " " " SW 21

Date Located: \_\_\_\_\_  
By: \_\_\_\_\_  
Monument Description: \_\_\_\_\_  
Monument Witnesses: \_\_\_\_\_  
\_\_\_\_\_  
\_\_\_\_\_  
\_\_\_\_\_

Date Located: 3/27/19  
By: SRM  
Monument Description: WABASH CO MONUMENT  
Monument Witnesses: SEE PAGE 210 "G"  
SW 17-30-6

Date Located: \_\_\_\_\_  
By: \_\_\_\_\_  
Monument Description: \_\_\_\_\_  
Monument Witnesses: \_\_\_\_\_  
\_\_\_\_\_  
\_\_\_\_\_  
\_\_\_\_\_

[illegible]

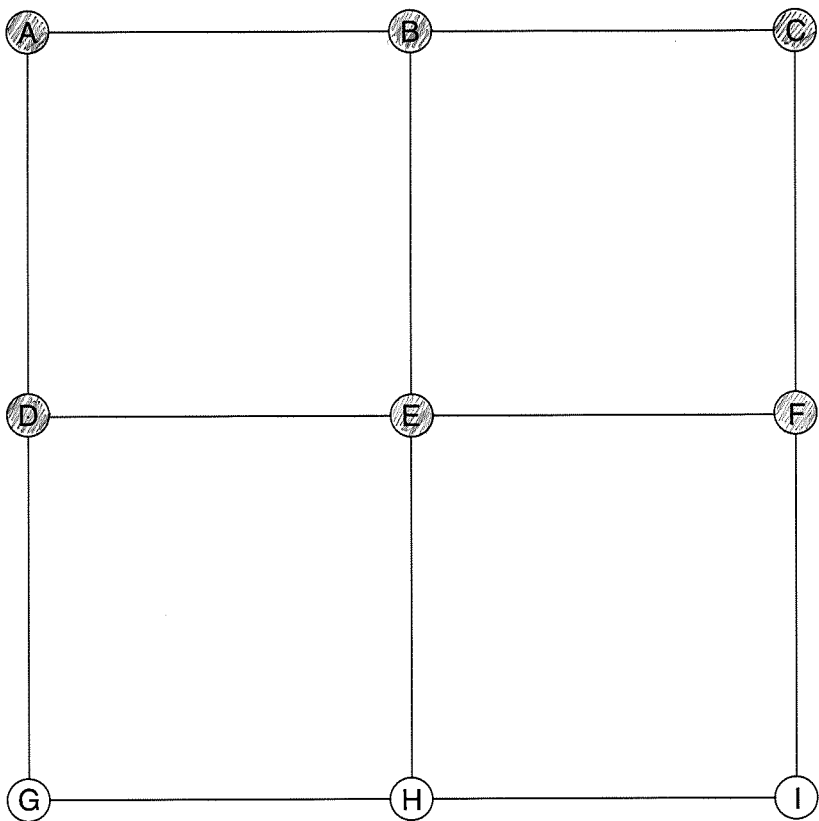

A (NORTHWEST CORNER)

Date Located: 2/2/18  
By: SEM  
Monument Description: FD RR SPIKE 5 1/2" DEEP  
Monument Witnesses: SEE Pg 365 "I"

Field Book: 8 Page: 63

B (NORTH QUARTER CORNER)

Date Located: 9/4/19  
By: SEM MWH  
Monument Description: RR SPIKE  
Monument Witnesses: SEE Pg 30 "H"

Field Book: 17 Page: 12

C (NORTHEAST CORNER)

Date Located: 8/23/18  
By: SEM  
Monument Description: HARRISON MONUMENT  
Monument Witnesses: SEE Pg 213 "A"

Field Book: 10 Page: 78

D (WEST QUARTER CORNER)

Date Located: 11/23/17  
By: SEM  
Monument Description: MAG NAIL w/ CO TAG  
Monument Witnesses: 1/2" REBAR w/CAP NW 27.32'  
1/2" REBAR w/CAP NE 36.75'  
1/2" REBAR w/CAP SE 17.23'

Field Book: 8 Page: 39

E (CENTER OF SECTION)

Date Located: 10/3/19  
By: SEM MWH  
Monument Description: MAG NAIL w/ CO TAG  
Monument Witnesses: FO PK NAIL W 153.25'  
1/2" REBAR w/CAP SW 38.41'  
RR RAIL FCP S 16.25'

Field Book: 17 Page: 68

F (EAST QUARTER CORNER)

Date Located: 10/3/19  
By: SEM MWH  
Monument Description: FD RR SPIKE  
Monument Witnesses: 1/2" REBAR w/CAP NW 40.43'  
1/2" REBAR w/CAP SW 34.86'  
NAIL IN B. CAP NIPSCO POLE SSW 16.00'

Field Book: 17 Page: 69

G (SOUTHWEST CORNER)

Date Located: \_\_\_\_\_  
By: \_\_\_\_\_  
Monument Description: \_\_\_\_\_  
Monument Witnesses: \_\_\_\_\_

Field Book: \_\_\_\_\_ Page: \_\_\_\_\_

H (SOUTH QUARTER CORNER)

Date Located: \_\_\_\_\_  
By: \_\_\_\_\_  
Monument Description: \_\_\_\_\_  
Monument Witnesses: \_\_\_\_\_

Field Book: \_\_\_\_\_ Page: \_\_\_\_\_

I (SOUTHEAST CORNER)

Date Located: \_\_\_\_\_  
By: \_\_\_\_\_  
Monument Description: \_\_\_\_\_  
Monument Witnesses: \_\_\_\_\_

Field Book: \_\_\_\_\_ Page: \_\_\_\_\_

ADDITIONAL NOTES

Field Book: 17 Page: 70

## Field Book: \_\_\_\_\_ Page: \_\_\_\_\_

## Field Book: \_\_\_\_\_ Page: \_\_\_\_\_

Field Book: 10 Page: 78Field Book: 17 Page: 11

## Field Book: \_\_\_\_\_ Page: \_\_\_\_\_

Field Book: 9 Page: 62

## Field Book: \_\_\_\_\_ Page: \_\_\_\_\_

Field Book: 17 Page: 69

## ADDITIONAL NOTES

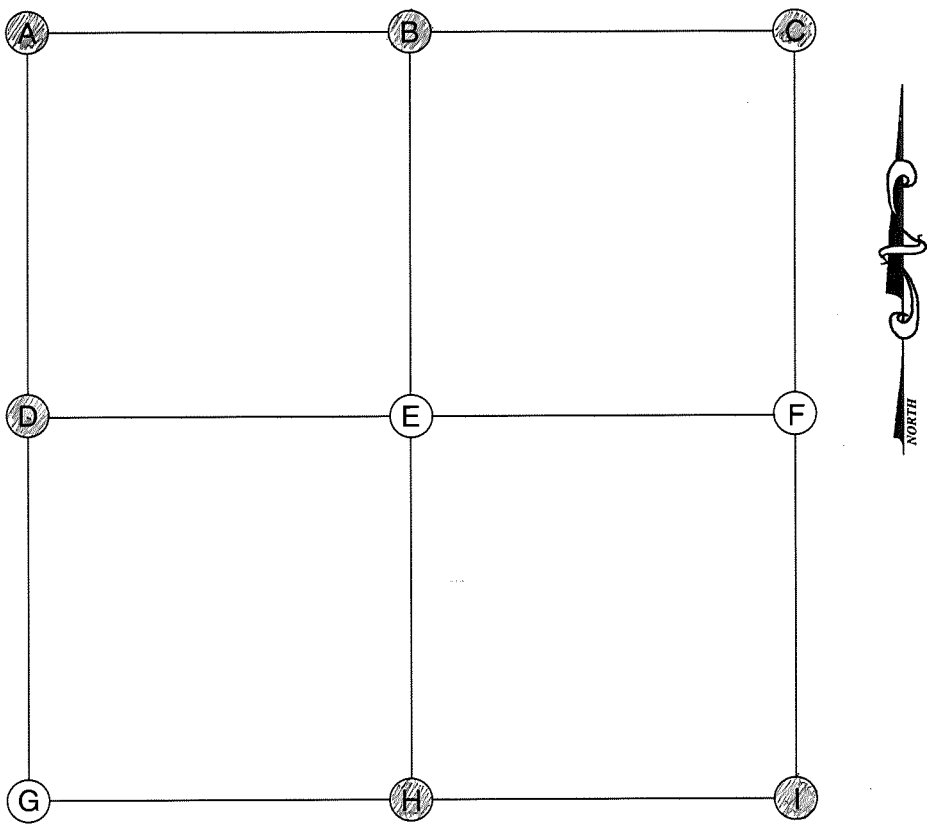

A (NORTHWEST CORNER)

Date Located: 3/14/18  
By: SEM  
Monument Description: FD 1 1/2" MAG NAIL NO TAG  
Monument Witnesses: SEE Pg 213 "C"  
  
Field Book: 9 Page: 62

B (NORTH QUARTER CORNER)

Date Located: 9/4/19  
By: SEM MNH  
Monument Description: MAG NAIL W/ CO TAG  
Monument Witnesses: SEE Pg 28 "H"  
  
Field Book: 17 Page: 10

C (NORTHEAST CORNER)

Date Located: 11/1/19  
By: SEM  
Monument Description: BRONZE MONUMENT  
Monument Witnesses: SEE Pg "27" "G"  
  
Field Book: 11 Page: 67

D (WEST QUARTER CORNER)

Date Located: 10/3/19  
By: SEM MNH  
Monument Description: FD RR SPIKE  
Monument Witnesses: 1/2" REBAR W/CAP NW 43.60'  
1/2" REBAR W/CAP SW 57.96'  
NAIL IN B. CAP POWER POLE ENE 17.67'  
  
Field Book: 17 Page: 71

E (CENTER OF SECTION)

Date Located: \_\_\_\_\_  
By: \_\_\_\_\_  
Monument Description: \_\_\_\_\_  
Monument Witnesses: \_\_\_\_\_  
  
Field Book: \_\_\_\_\_ Page: \_\_\_\_\_

F (EAST QUARTER CORNER)

Date Located: \_\_\_\_\_  
By: \_\_\_\_\_  
Monument Description: \_\_\_\_\_  
Monument Witnesses: \_\_\_\_\_  
  
Field Book: \_\_\_\_\_ Page: \_\_\_\_\_

G (SOUTHWEST CORNER)

Date Located: \_\_\_\_\_  
By: \_\_\_\_\_  
Monument Description: \_\_\_\_\_  
Monument Witnesses: \_\_\_\_\_  
  
Field Book: \_\_\_\_\_ Page: \_\_\_\_\_

H (SOUTH QUARTER CORNER)

Date Located: 10/3/19  
By: SEM MNH  
Monument Description: FD PK NAIL  
Monument Witnesses: RR RAIL FCP N 20.00'  
1/2" REBAR W/CAP NE 36.66'  
MAG NAIL W 16.50'  
  
Field Book: 17 Page: 74

I (SOUTHEAST CORNER)

Date Located: 10/3/19  
By: SEM MNH  
Monument Description: FD RR SPIKE  
Monument Witnesses: FD MAG NAIL W 50.00'  
NAIL IN B. CAP POWER POLE NW 35.66'  
RR RAIL FCP N 17.60'  
NAIL IN B. CAP POWER POLE SE 53.50'  
  
Field Book: 17 Page: 75

ADDITIONAL NOTES

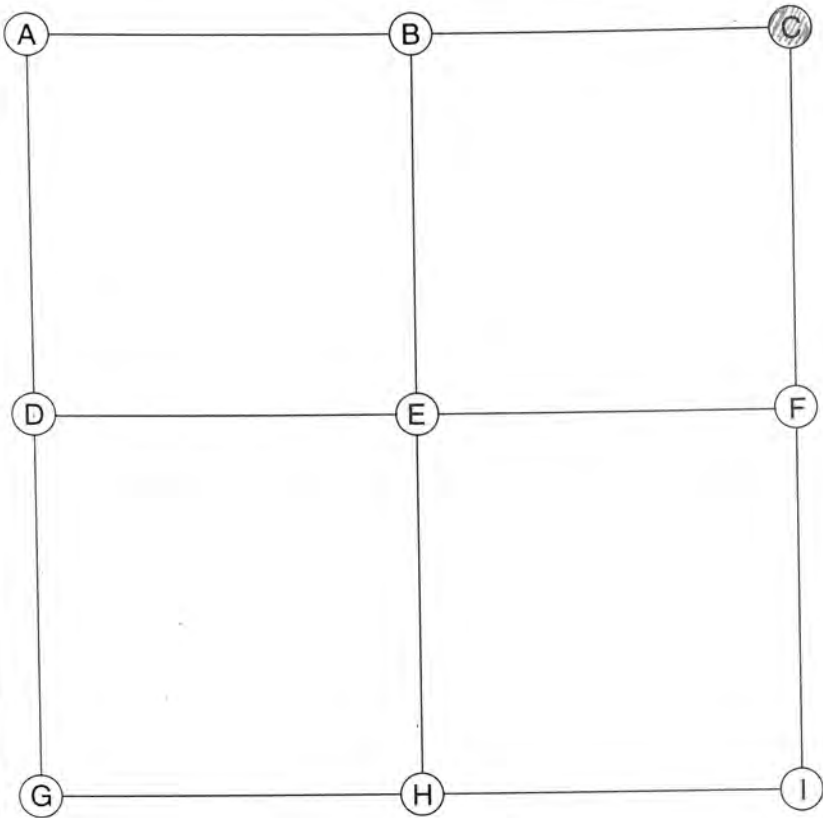

## A (NORTHWEST CORNER)

Date Located: \_\_\_\_\_  
 By: \_\_\_\_\_  
 Monument Description: \_\_\_\_\_  
 Monument Witnesses: \_\_\_\_\_

Field Book: \_\_\_\_\_ Page: \_\_\_\_\_

## B (NORTH QUARTER CORNER)

Date Located: \_\_\_\_\_  
 By: \_\_\_\_\_  
 Monument Description: \_\_\_\_\_  
 Monument Witnesses: \_\_\_\_\_

Field Book: \_\_\_\_\_ Page: \_\_\_\_\_

## C (NORTHEAST CORNER)

Date Located: 6/23/16  
 By: SRM  
 Monument Description: FO BRONZE MONUMENT  
 Monument Witnesses: SEE Pg 27 "I"

Field Book: 4 Page: 19

## D (WEST QUARTER CORNER)

Date Located: \_\_\_\_\_  
 By: \_\_\_\_\_  
 Monument Description: \_\_\_\_\_  
 Monument Witnesses: \_\_\_\_\_

Field Book: \_\_\_\_\_ Page: \_\_\_\_\_

## E (CENTER OF SECTION)

Date Located: \_\_\_\_\_  
 By: \_\_\_\_\_  
 Monument Description: \_\_\_\_\_  
 Monument Witnesses: \_\_\_\_\_

Field Book: \_\_\_\_\_ Page: \_\_\_\_\_

## F (EAST QUARTER CORNER)

Date Located: \_\_\_\_\_  
 By: \_\_\_\_\_  
 Monument Description: \_\_\_\_\_  
 Monument Witnesses: \_\_\_\_\_

Field Book: \_\_\_\_\_ Page: \_\_\_\_\_

## G (SOUTHWEST CORNER)

Date Located: \_\_\_\_\_  
 By: \_\_\_\_\_  
 Monument Description: \_\_\_\_\_  
 Monument Witnesses: \_\_\_\_\_

Field Book: \_\_\_\_\_ Page: \_\_\_\_\_

## H (SOUTH QUARTER CORNER)

Date Located: \_\_\_\_\_  
 By: \_\_\_\_\_  
 Monument Description: \_\_\_\_\_  
 Monument Witnesses: \_\_\_\_\_

Field Book: \_\_\_\_\_ Page: \_\_\_\_\_

## I (SOUTHEAST CORNER)

Date Located: \_\_\_\_\_  
 By: \_\_\_\_\_  
 Monument Description: \_\_\_\_\_  
 Monument Witnesses: \_\_\_\_\_

Field Book: \_\_\_\_\_ Page: \_\_\_\_\_

## ADDITIONAL NOTES



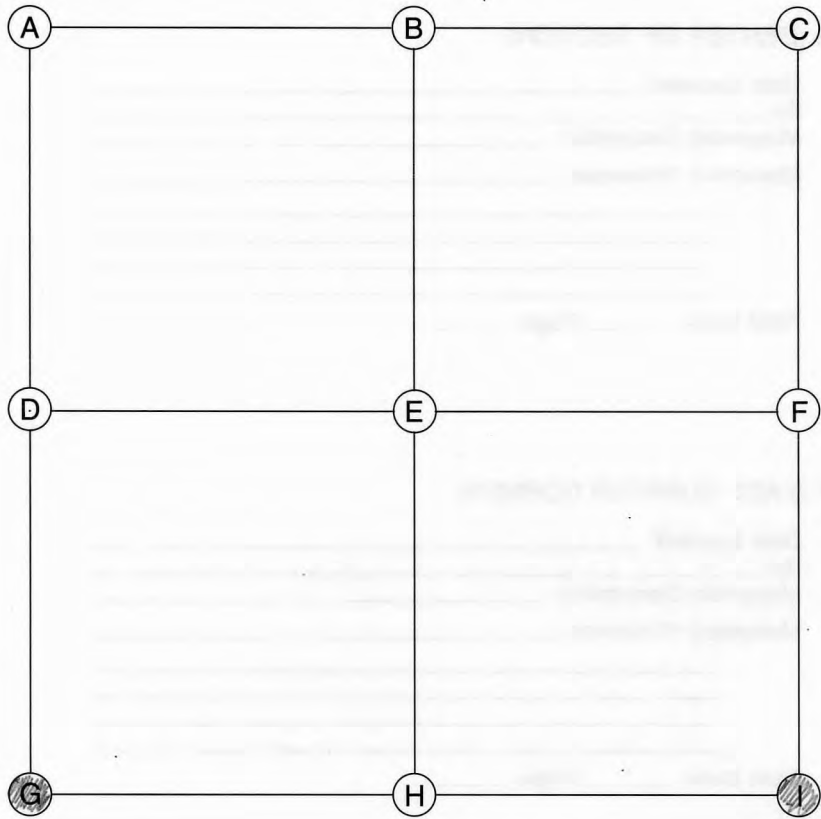

## A (NORTHWEST CORNER)

Date Located: \_\_\_\_\_  
 By: \_\_\_\_\_  
 Monument Description: \_\_\_\_\_  
 Monument Witnesses: \_\_\_\_\_

Field Book: \_\_\_\_\_ Page: \_\_\_\_\_

## B (NORTH QUARTER CORNER)

Date Located: \_\_\_\_\_  
 By: \_\_\_\_\_  
 Monument Description: \_\_\_\_\_  
 Monument Witnesses: \_\_\_\_\_

Field Book: \_\_\_\_\_ Page: \_\_\_\_\_

## C (NORTHEAST CORNER)

Date Located: \_\_\_\_\_  
 By: \_\_\_\_\_  
 Monument Description: \_\_\_\_\_  
 Monument Witnesses: \_\_\_\_\_

Field Book: \_\_\_\_\_ Page: \_\_\_\_\_

## D (WEST QUARTER CORNER)

Date Located: \_\_\_\_\_  
 By: \_\_\_\_\_  
 Monument Description: \_\_\_\_\_  
 Monument Witnesses: \_\_\_\_\_

Field Book: \_\_\_\_\_ Page: \_\_\_\_\_

## E (CENTER OF SECTION)

Date Located: \_\_\_\_\_  
 By: \_\_\_\_\_  
 Monument Description: \_\_\_\_\_  
 Monument Witnesses: \_\_\_\_\_

Field Book: \_\_\_\_\_ Page: \_\_\_\_\_

## F (EAST QUARTER CORNER)

Date Located: \_\_\_\_\_  
 By: \_\_\_\_\_  
 Monument Description: \_\_\_\_\_  
 Monument Witnesses: \_\_\_\_\_

Field Book: \_\_\_\_\_ Page: \_\_\_\_\_

## G (SOUTHWEST CORNER)

Date Located: 7/25/18  
 By: SRM  
 Monument Description: MAG NAIL W/ CO TAG  
 Monument Witnesses: NAIL IN B. CAP POWER POLE NE 27.62'  
NAIL IN B. CAP TEL POLE SE 30.38'

Field Book: 10 Page: 42

## H (SOUTH QUARTER CORNER)

Date Located: \_\_\_\_\_  
 By: \_\_\_\_\_  
 Monument Description: \_\_\_\_\_  
 Monument Witnesses: \_\_\_\_\_

Field Book: \_\_\_\_\_ Page: \_\_\_\_\_

## I (SOUTHEAST CORNER)

Date Located: 7/25/18  
 By: SRM  
 Monument Description: FO BRONZE MONUMENT  
 Monument Witnesses: SEE Pg 194 "A"

Field Book: 10 Page: 41

## ADDITIONAL NOTES