



Date Located: _____
By: _____
Monument Description: _____
Monument Witnesses: _____

Date Located: _____
By: _____
Monument Description: _____
Monument Witnesses: _____

Date Located: _____
By: _____
Monument Description: _____
Monument Witnesses: SEE PAGE 325 "I"
SE 24-34-4

Date Located: 7/28/93 UPDATED 3/25/19
By: JA MOYER - EC HAINGS SEM
Monument Description: PH NAIL MAG NAIL w/co TAG
Monument Witnesses: ED PH NAIL IN PAVEMENT SE 16.27
ED "4" CUT IN STONE SE 31.51
ED NAIL IN BOTTLE CAP IN SW FACE OF NIPSCO PP WINW 80.06
ED PH NAIL IN BOTTLE CAP SE FACE OF NIPSCO PP NE 28.45

Date Located: 7/28/92 UPDATED 3/25/19
By: JR MOYER - EG HAINES SRM
Monument Description: PKNAIL MAG NAIL w/co TAG
Monument Witnesses: SFACE OF 3" DIA CONC. FILLED TCP N 19.65
SET 1/2" REBAR W/CAD SE SLUG
SET NAIL IN BOTTLE CAPINE FACE OF MPB CO PP NW N 17.78
" " " " "W." "AG'S QUOOD REP S 19.60

Date Located: _____
By: _____
Monument Description: _____
Monument Witnesses: _____

Date Located: 7/28/92 UPDATED 3/25/19
By: JB MOYER - EC HAINES SEM
Monument Description: RR SPIKE RR SPIKE
Monument Witnesses:
ED + CUT INS. FACE OF RR RAIL FCP N 20.27
" " " " E " " 10" SO CONC. FCP SSW 21.04

Date Located: _____
By: _____
Monument Description: _____
Monument Witnesses: _____

Date Located: _____
By: _____
Monument Description: _____
Monument Witnesses: _____

Field Book: _____ Page: _____

ADDITIONAL NOTES

Jefferson
20-34-5

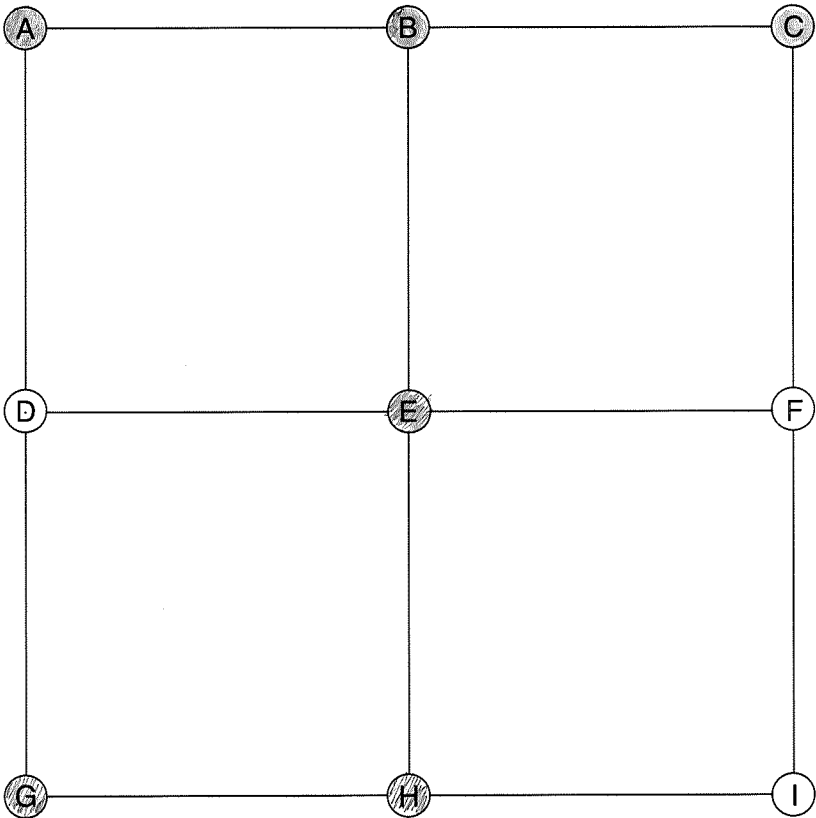

A (NORTHWEST CORNER)

Date Located: _____
By: _____
Monument Description: _____
Monument Witnesses: SEE PAGE 181 "C"
NE 19-34-5

Field Book: _____ Page: _____

B (NORTH QUARTER CORNER)

Date Located: 7/28/19
By: JA MOYER - EC HAINES
Monument Description: PK NAIL
Monument Witnesses: _____
ED NAIL IN BOTTLECAP IN NE CORNER OF NW/4 FCP SE 22.88
ED PK NAIL IN NW FACE OF NIPSCO PP SW 26.77

Field Book: 2 Page: 25

C (NORTHEAST CORNER)

Date Located: 7/28/19
By: JA MOYER - EC HAINES
Monument Description: RR SPIKE
Monument Witnesses: _____
ED 4" CUT IN 8" DIA CONG. FILLED STEEL FCP NE FACE NNW 36.54
" " " " S. FACE OF ARRRAIL FCP NNE 40.24
" " " " E " " " " " SW 39.87
ED NAIL IN S. SIDE OF A POWER POLE ESE 61.56
Field Book: 2 Page: 26

D (WEST QUARTER CORNER)

Date Located: _____
By: _____
Monument Description: _____
Monument Witnesses: _____

Field Book: _____ Page: _____

E (CENTER OF SECTION)

Date Located: 8/7/19
By: SEM MWLH
Monument Description: MAG NAIL W/CO TAG
Monument Witnesses: NAIL IN B. CAP NIPSCO POLE NE 43.90'
1/2" REBAR W/CAP SE 53.90'
NAIL IN B. CAP NIPSCO POLE SW 73.04'

Field Book: 16 Page: 41

F (EAST QUARTER CORNER)

Date Located: _____
By: _____
Monument Description: _____
Monument Witnesses: _____

Field Book: _____ Page: _____

G (SOUTHWEST CORNER)

Date Located: 5/22/19
By: SEM MWLH
Monument Description: 5/8" IRON P.N
Monument Witnesses: SEE Pg 333 "C"

Field Book: 14 Page: 24

H (SOUTH QUARTER CORNER)

Date Located: 8/2/19
By: SEM MWLH
Monument Description: 1/2" REBAR
Monument Witnesses: 1/2" REBAR W/CAP NNW 28.23'
1/2" REBAR W/CAP SE 27.96'
1/2" REBAR W/CAP SW 45.91'

Field Book: 16 Page: 49

I (SOUTHEAST CORNER)

Date Located: _____
By: _____
Monument Description: _____
Monument Witnesses: _____

Field Book: _____ Page: _____

ADDITIONAL NOTES

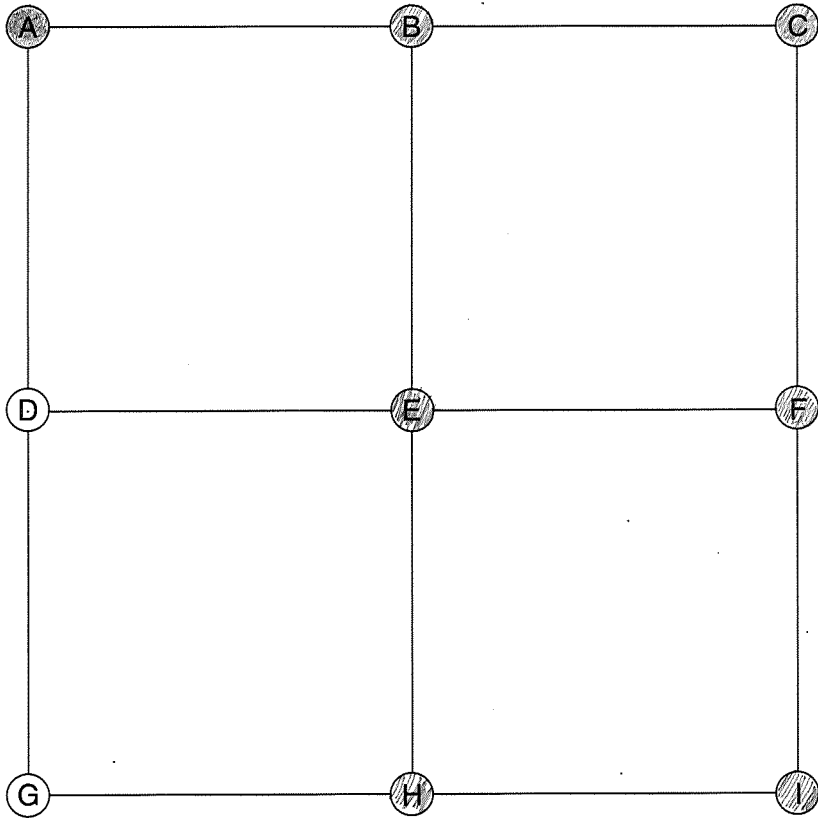

A (NORTHWEST CORNER)

Date Located: _____
By: _____
Monument Description: _____
Monument Witnesses: SEE PAGE 182 "C"
NE 20-34-5

Field Book: _____ Page: _____

B (NORTH QUARTER CORNER)

Date Located: 8/14/19
By: DEM MWH
Monument Description: 5/8" REBAR
Monument Witnesses: SEE Pg 178 "H"

Field Book: 16 Page: 57

C (NORTHEAST CORNER)

Date Located: 8/14/19
By: DEM MWH
Monument Description: 5/8" REBAR
Monument Witnesses: SEE Pg 178 "I"

Field Book: 16 Page: 58

D (WEST QUARTER CORNER)

Date Located: _____
By: _____
Monument Description: _____
Monument Witnesses: _____

Field Book: _____ Page: _____

E (CENTER OF SECTION)

Date Located: 8/7/19
By: DEMOVER MWHUFFMAN
Monument Description: 2" IRON PIPE
Monument Witnesses: NAIL IN B. CAP WOOD FP N 23.73'
1/2" REBAR W/CAP SE 28.05'
N FACE RTZ RAIL FCP S 18.33'

Field Book: 16 Page: 39

F (EAST QUARTER CORNER)

Date Located: 8/7/19
By: DEM MWH
Monument Description: MAG NAIL W/CO TAGS
Monument Witnesses: 1/2" REBAR W/CAP NW 31.73'
NAIL IN B. CAP POWER POLE SE 26.94'
1/2" REBAR W/CAP SW 35.25'

Field Book: 16 Page: 40

G (SOUTHWEST CORNER)

Date Located: _____
By: _____
Monument Description: _____
Monument Witnesses: _____

Field Book: _____ Page: _____

H (SOUTH QUARTER CORNER)

Date Located: 3/20/17
By: DEM
Monument Description: FO MAG NAIL IN 3/4" IRON PIPE
Monument Witnesses: FO 5/8" REBAR NNE 19.13'
1/2" REBAR W/CAP SE 25.41'

Field Book: 6 Page: 40

I (SOUTHEAST CORNER)

Date Located: 3/20/17
By: DEM
Monument Description: FO BRONZE / COPPER MARKER 8" DEEP
Monument Witnesses: NAIL IN TAG IN ANCHOR POLE SW 28.98'
FO PK NAIL IN POWER POLE SSE 17.32'

Field Book: 6 Page: 39

ADDITIONAL NOTES

Jefferson
22-34-5

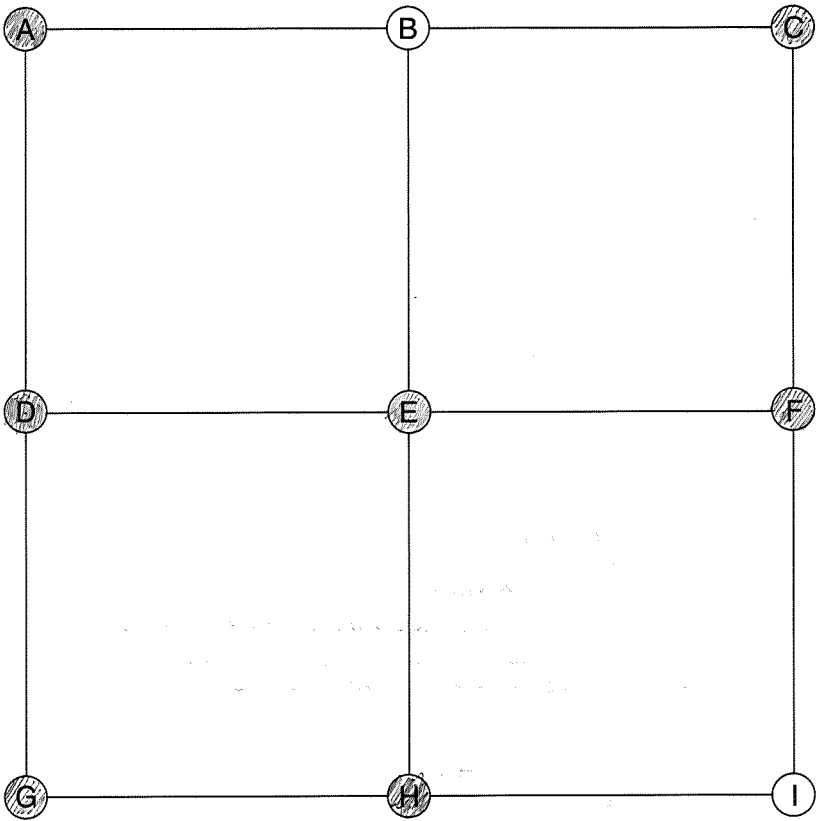

A (NORTHWEST CORNER)

Date Located: 8/14/19
By: SEM MWH
Monument Description: 5/8" REBAR
Monument Witnesses: SEE Pg 178 "I"

Field Book: 16 Page: 58

B (NORTH QUARTER CORNER)

Date Located: _____
By: _____
Monument Description: _____
Monument Witnesses: _____

Field Book: _____ Page: _____

C (NORTHEAST CORNER)

Date Located: 2/13/17
By: SEM
Monument Description: FO PK NAIL FLUSH
Monument Witnesses: SEE Pg 177 "I"

Field Book: 5 Page: 76

D (WEST QUARTER CORNER)

Date Located: 8/7/19
By: SEM MWH
Monument Description: MAG NAIL w/ CO TAG
Monument Witnesses: SEE Pg 183 "F"

Field Book: 16 Page: 40

E (CENTER OF SECTION)

Date Located: 8/8/19
By: SEM MWH
Monument Description: RR SPIKE
Monument Witnesses: 4 RR RAIL FCP N 20.70'
1/2" REBAR w/CAP NE 26.57'
NAIL IN B. CAP P. POLE SE 70.86'

Field Book: 16 Page: 45

F (EAST QUARTER CORNER)

Date Located: 2/13/17
By: SEM
Monument Description: FO 1" IRON PIPE FLUSH
Monument Witnesses: NAIL IN TAG DEMC POLE NNW 65.71'
1/2" REBAR w/CAP SE 21.33'
NAIL IN TAG IN DEMC POLE WSW 43.50'

Field Book: 5 Page: 75

G (SOUTHWEST CORNER)

Date Located: 3/20/17
By: SEM
Monument Description: FO BRONZE / COPPER MARKER 8" DEEP
Monument Witnesses: SEE Pg 183 "I"

Field Book: 6 Page: 39

H (SOUTH QUARTER CORNER)

Date Located: 8/8/19
By: SEM MWH
Monument Description: 1/2" REBAR
Monument Witnesses: SEE Pg 189 "B"

Field Book: 16 Page: 46

I (SOUTHEAST CORNER)

Date Located: _____
By: _____
Monument Description: _____
Monument Witnesses: _____

Field Book: _____ Page: _____

ADDITIONAL NOTES

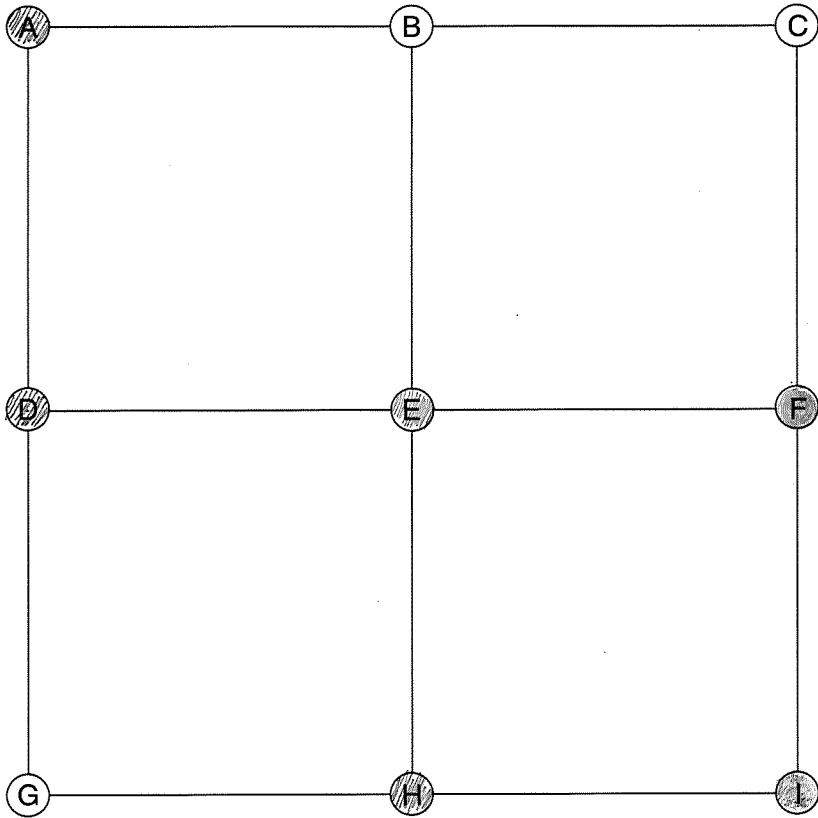

E (CENTER OF SECTION)

Date Located: 8/8/19
By: SEM MWH
Monument Description: 3/4" SO HEAD BOLT
Monument Witnesses: 1/2" REBAR W/CAP NW 31.57'
S FACE RR RAIL FCP N 23.73'
NAIL IN B. CAP POWER POLE SSW 15.90'

Field Book: 16 Page: 44

F (EAST QUARTER CORNER)

Date Located: 8/13/92
By: JB MOYER - EC HAINES
Monument Description: PK NAIL
Monument Witnesses: S. FACE OF A RR RAIL FCP N 19.98
NE CORNER OF A RR RAIL FCP SW 27.96
SET NAIL IN BOTTLE CAP IN NW FACE OF PP SW 39.73
NAIL IN B. CAP POWER POLE SSE 74.00'
NAIL IN B. CAP POWER POLE ESE 67.59'

Field Book: 2 Page: 46 UPDATED 6/26/18 SEM

A (NORTHWEST CORNER)

Date Located: 2/13/17
By: SEM
Monument Description: FO PK NAIL FLUSH
Monument Witnesses: SEE Pg 177 "I"

Field Book: 5 Page: 76

G (SOUTHWEST CORNER)

Date Located: _____
By: _____
Monument Description: _____
Monument Witnesses: _____

Field Book: _____ Page: _____

B (NORTH QUARTER CORNER)

Date Located: _____
By: _____
Monument Description: _____
Monument Witnesses: _____

Field Book: _____ Page: _____

H (SOUTH QUARTER CORNER)

Date Located: 8/8/19
By: SEM MWH
Monument Description: 1/2" REBAR
Monument Witnesses: SEE Pg 183 "B"

Field Book: 16 Page: 48

C (NORTHEAST CORNER)

Date Located: _____
By: _____
Monument Description: _____
Monument Witnesses: _____

Field Book: _____ Page: _____

I (SOUTHEAST CORNER)

Date Located: _____
By: _____
Monument Description: _____
Monument Witnesses: SEE PAGE 188 "C"
NE 26-34-5

Field Book: _____ Page: _____

D (WEST QUARTER CORNER)

Date Located: 2/13/17
By: SEM
Monument Description: FO 1" IRON PIPE FLUSH
Monument Witnesses: SEE Pg 184 "F"

Field Book: 5 Page: 75

ADDITIONAL NOTES

Jefferson
24-34-5

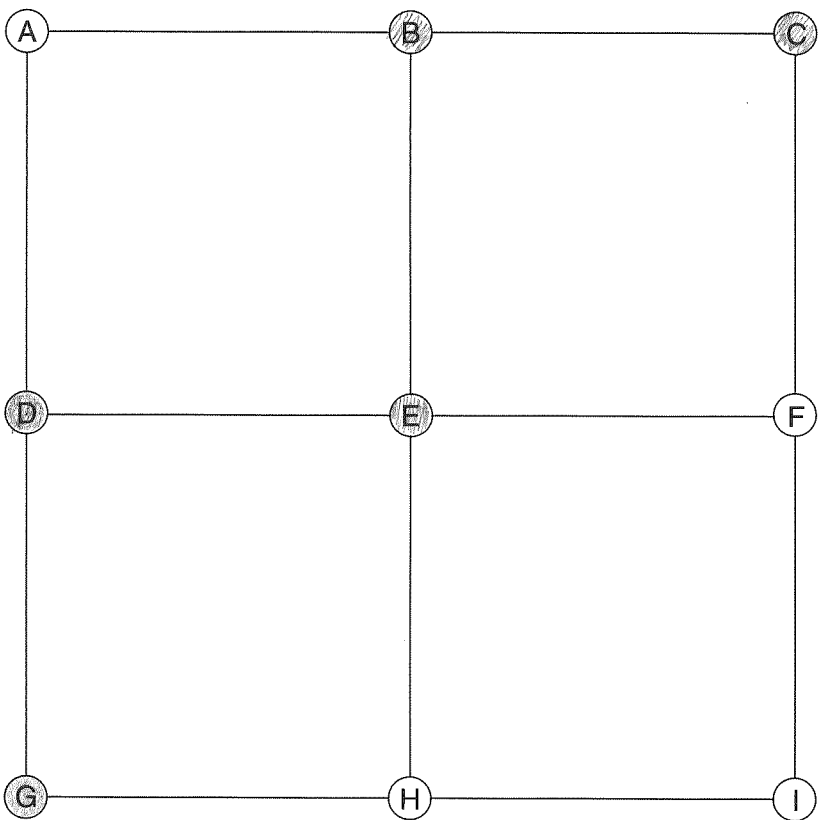

E (CENTER OF SECTION)

Date Located: 3/8/19
By: SEM MW4
Monument Description: RR SPIKE
Monument Witnesses: NEAREST EDGE RR RAIL NW 29.34'
4" DIA SOLID STEEL SHAFT NNE 21.90'
1/2" BEARING W/ CAP SE 29.00'

Field Book: 160 Page: 43

F (EAST QUARTER CORNER)

Date Located: _____
By: _____
Monument Description: _____
Monument Witnesses: _____

Field Book: _____ Page: _____

A (NORTHWEST CORNER)

Date Located: _____
By: _____
Monument Description: _____
Monument Witnesses: _____

Field Book: _____ Page: _____

G (SOUTHWEST CORNER)

Date Located: _____
By: _____
Monument Description: _____
Monument Witnesses: SEE PAGE 188 "C"
NE 26-34-5

Field Book: _____ Page: _____

B (NORTH QUARTER CORNER)

Date Located: 5/25/21
By: SEM MW4
Monument Description: FO RR RAIL FCP
Monument Witnesses: _____

Field Book: 20 Page: 17

H (SOUTH QUARTER CORNER)

Date Located: _____
By: _____
Monument Description: _____
Monument Witnesses: _____

Field Book: _____ Page: _____

C (NORTHEAST CORNER)

Date Located: 6/26/18
By: SEM
Monument Description: FB BRONZE MONUMENT
Monument Witnesses: SEE Pg 463 "A"

Field Book: 10 Page: 10

I (SOUTHEAST CORNER)

Date Located: _____
By: _____
Monument Description: _____
Monument Witnesses: _____

Field Book: _____ Page: _____

D (WEST QUARTER CORNER)

Date Located: _____
By: _____
Monument Description: _____
Monument Witnesses: SEE PAGE 185 "F"
E 1/4 POST 23-34-5

Field Book: _____ Page: _____

ADDITIONAL NOTES

Jefferson
25-34-5

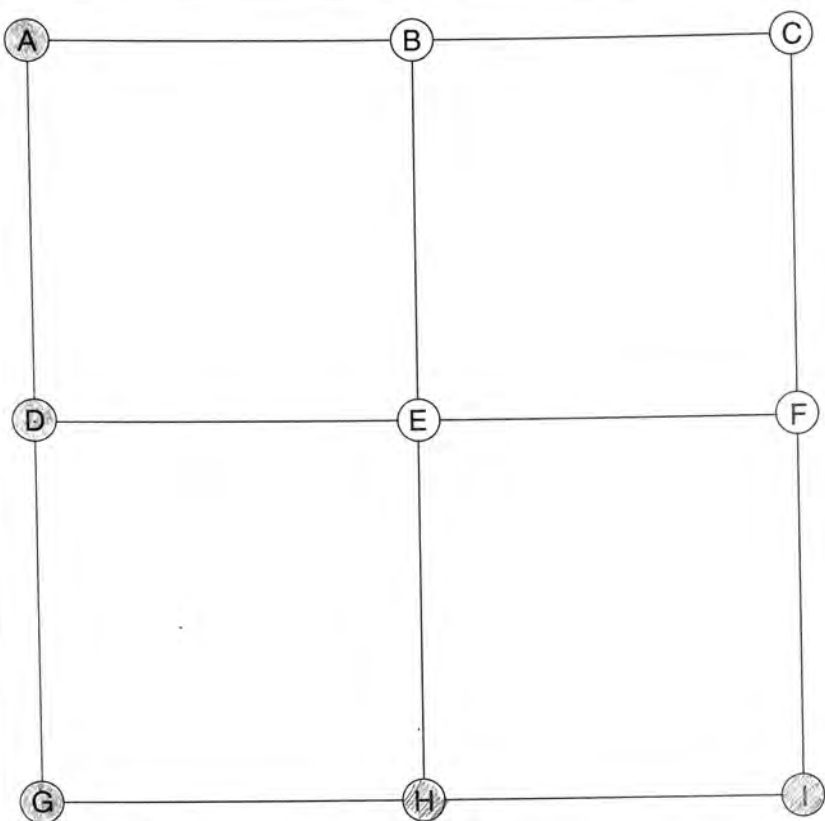

A (NORTHWEST CORNER)

Date Located: _____
By: _____
Monument Description: _____
Monument Witnesses: SEE PAGE 188 "C"
NE 26-34-5

Field Book: _____ Page: _____

B (NORTH QUARTER CORNER)

Date Located: _____
By: _____
Monument Description: _____
Monument Witnesses: _____

Field Book: _____ Page: _____

C (NORTHEAST CORNER)

Date Located: _____
By: _____
Monument Description: _____
Monument Witnesses: _____

Field Book: _____ Page: _____

D (WEST QUARTER CORNER)

Date Located: _____
By: _____
Monument Description: _____
Monument Witnesses: SEE PAGE 188 "F"
E 1/4 POST 26-34-5

Field Book: _____ Page: _____

E (CENTER OF SECTION)

Date Located: _____
By: _____
Monument Description: _____
Monument Witnesses: _____

Field Book: _____ Page: _____

F (EAST QUARTER CORNER)

Date Located: _____
By: _____
Monument Description: _____
Monument Witnesses: _____

Field Book: _____ Page: _____

G (SOUTHWEST CORNER)

Date Located: _____
By: _____
Monument Description: _____
Monument Witnesses: SEE PAGE 188 "I"
SE 26-34-5

Field Book: _____ Page: _____

H (SOUTH QUARTER CORNER)

Date Located: 6/6/16
By: SE MOYER
Monument Description: FO PK NAIL FLUSH
Monument Witnesses: SEE Pg 193 "B"

Field Book: 4 Page: 1

I (SOUTHEAST CORNER)

Date Located: _____
By: _____
Monument Description: _____
Monument Witnesses: _____

Field Book: _____ Page: _____

ADDITIONAL NOTES

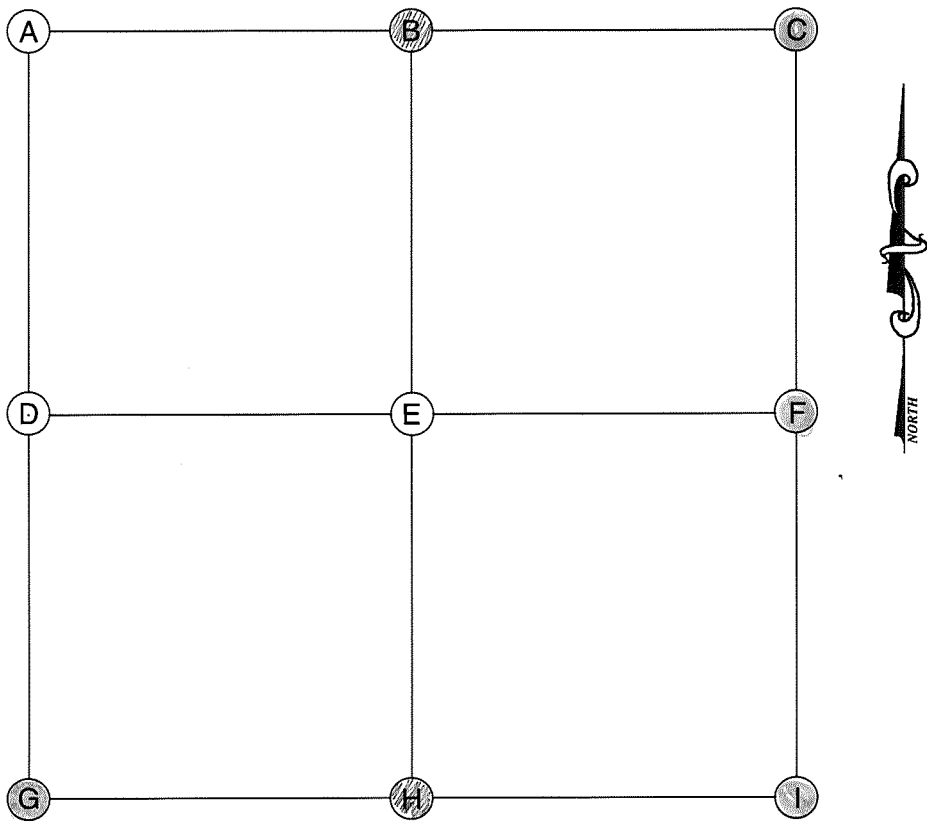
Jefferson
26-34-5

A (NORTHWEST CORNER)

Date Located: _____
By: _____
Monument Description: _____
Monument Witnesses: _____

Field Book: _____ Page: _____

B (NORTH QUARTER CORNER)

Date Located: 8/8/19
By: SRM NNNH
Monument Description: 1/2" REBAR
Monument Witnesses: FACE RR RAIL FCP N 10.87
1/2" REBAR W/CAP NE 33.95'
FACE RR RAIL FCP S 16.87'

Field Book: 16 Page: 48

C (NORTHEAST CORNER)

Date Located: 8/13/92
By: JA MOYER - EC HAINES
Monument Description: BRONZE MARKER
Monument Witnesses: SE CORNER OF RR RAIL FCP NW 32.78
CENTER OF RR RAIL FCP E 20.03
SET NAIL IN ROUTING CAP IN SW FACE OF RR E 19.74
1/2" REBAR W/CAP WSW 34.43'
1/2" REBAR W/CAP SE 34.14'
Field Book: 2 Page: 46 UPDATED 6/26/18 SRM

D (WEST QUARTER CORNER)

Date Located: _____
By: _____
Monument Description: _____
Monument Witnesses: _____

Field Book: _____ Page: _____

E (CENTER OF SECTION)

Date Located: _____
By: _____
Monument Description: _____
Monument Witnesses: _____

Field Book: _____ Page: _____

F (EAST QUARTER CORNER)

Date Located: 8/13/92
By: JA MOYER - EC HAINES
Monument Description: RR SPIKE
Monument Witnesses: CENTER OF RR RAIL FCP E 21.95
EAST FACE OF 2 1/2" x 4" I BEAM FCP W 21.95
SET 1/2" REBAR W/CAP NE 33.92'

Field Book: 2 Page: 45 UPDATED 6/7/16

G (SOUTHWEST CORNER)

Date Located: 3/26/18
By: SRM
Monument Description: FO BRONZE MONUMENT
Monument Witnesses: 1/2" REBAR W/CAP NE 33.23'
4 RR RAIL FCP S 19.55'
NAIL IN B. CAP POWER POLE WSW 71.70'

Field Book: 9 Page: 17

H (SOUTH QUARTER CORNER)

Date Located: 3/26/18
By: SRM
Monument Description: FO RR SPIKE
Monument Witnesses: NAIL IN B. CAP NIPSCO P. POLE WNW 65.93'
1/2" REBAR W/CAP NW 33.57'
4 RR RAIL FCP S 19.15'
USCGS BM 6172 SW 32.50'

Field Book: 9 Page: 16

I (SOUTHEAST CORNER)

Date Located: 8/13/92
By: JA MOYER - EC HAINES
Monument Description: PK NAIL OVER BAZ. MARKER (PK GONE 2005)
Monument Witnesses: SW CORNER OF RR RAIL FCP NE 29.51
SE CORNER OF RR RAIL FCP NW 38.49
SET NAIL IN ROUTING CAP IN NW FACE OF RR NNE 35.08
" " " " " S " " " ENE 68.03
" " " " " NW " " " WSW 62.79
Field Book: 2 Page: 45 UPDATED 6/7/16 SRM

ADDITIONAL NOTES

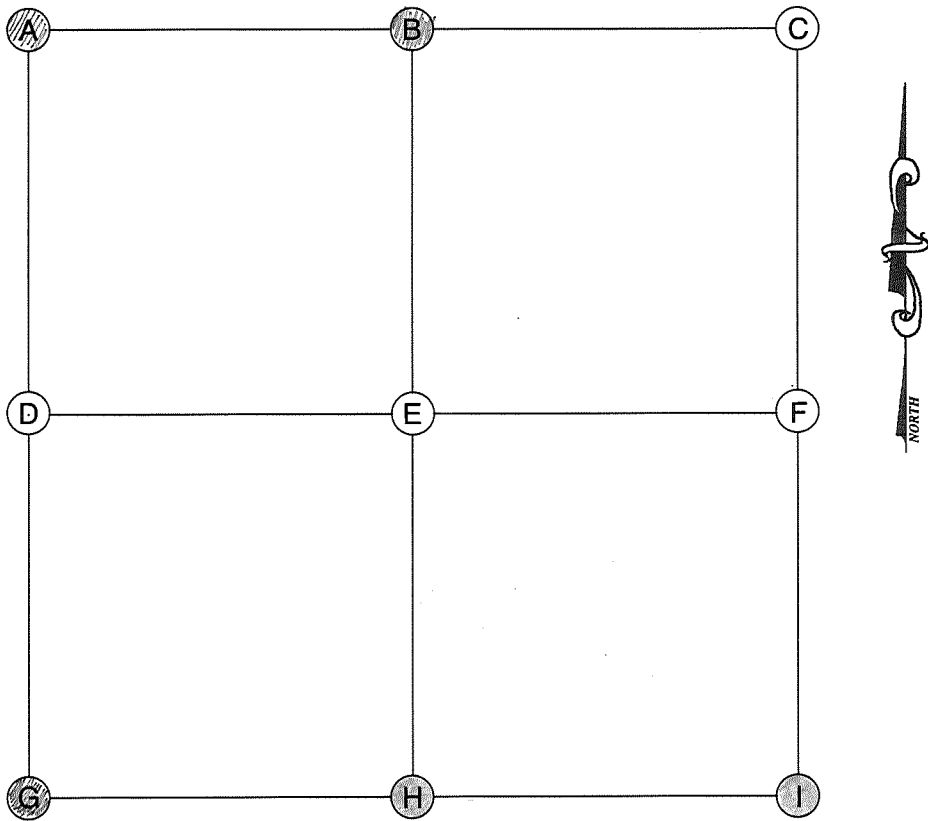

A (NORTHWEST CORNER)

Date Located: 3/20/17
By: SEM
Monument Description: FB BRONZE / COPPER MARKER 8" DEEP
Monument Witnesses: SEE PG 183 "I"

Field Book: 6 Page: 39

B (NORTH QUARTER CORNER)

Date Located: 8/8/19
By: SEM MH
Monument Description: 1/2" REBAR 4" DEEP
Monument Witnesses: NAIL IN B. CAP POWER POLE NW 40.56'
NAIL IN B. CAP RR TIE FCP N 20.35'
1/2" REBAR W/CAP NE 35.63'

Field Book: 16 Page: 46

C (NORTHEAST CORNER)

Date Located: _____
By: _____
Monument Description: _____
Monument Witnesses: _____

Field Book: _____ Page: _____

D (WEST QUARTER CORNER)

Date Located: _____
By: _____
Monument Description: _____
Monument Witnesses: _____

Field Book: _____ Page: _____

E (CENTER OF SECTION)

Date Located: _____
By: _____
Monument Description: _____
Monument Witnesses: _____

Field Book: _____ Page: _____

F (EAST QUARTER CORNER)

Date Located: _____
By: _____
Monument Description: _____
Monument Witnesses: _____

Field Book: _____ Page: _____

G (SOUTHWEST CORNER)

Date Located: 4/5/18
By: SEM & MH
Monument Description: FB SPIKE NAIL FLUSH
Monument Witnesses: NAIL IN B. CAP NIPSCO POLE ENE 64.83'
1/2" REBAR W/CAP SE 39.06'
NAIL IN B. CAP POWER POLE SW 24.63'

Field Book: 9 Page: 27

H (SOUTH QUARTER CORNER)

Date Located: 3/26/18
By: SEM
Monument Description: FB RR SPIKE
Monument Witnesses: 1/2" REBAR W/CAP NW 32.91'
1/2" REBAR W/CAP NE 29.15'
NAIL IN B. CAP POWER POLE SE 65.65'
& RR RAIL FCP

Field Book: 9 Page: 18

I (SOUTHEAST CORNER)

Date Located: 3/26/18
By: SEM
Monument Description: FB BRONZE MONUMENT
Monument Witnesses: 1/2" REBAR W/CAP NE 33.23'
& RR RAIL FCP S 19.55'
NAIL IN B. CAP POWER POLE WSW 71.70'

Field Book: 9 Page: 17

ADDITIONAL NOTES

Jefferson
28-34-5

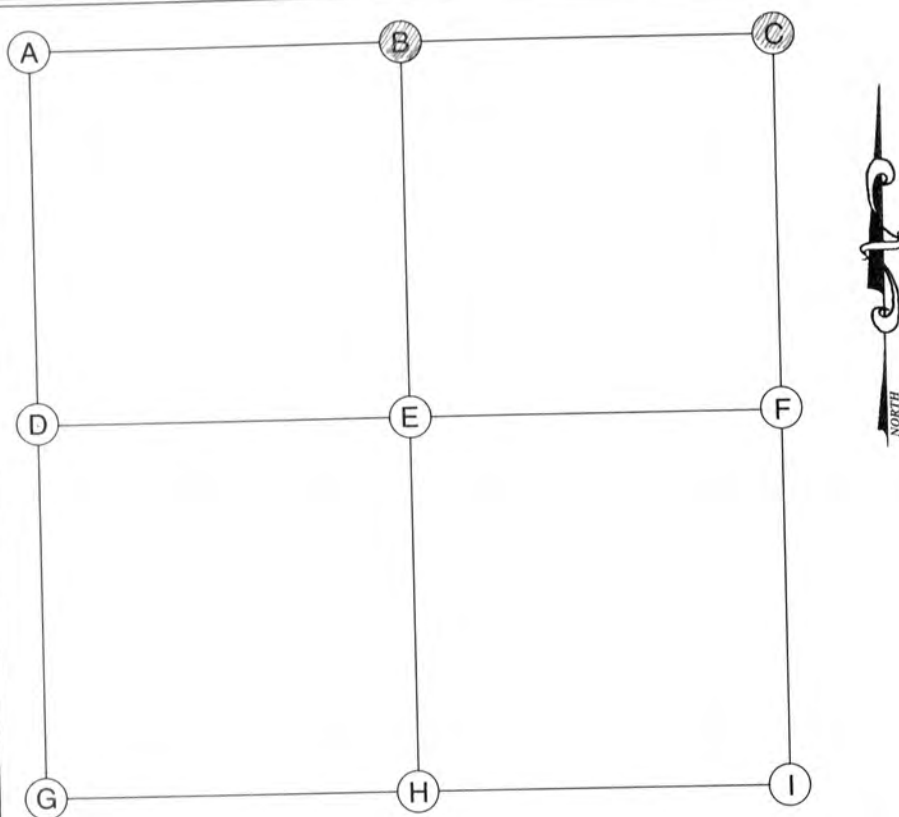

A (NORTHWEST CORNER)

Date Located: _____
By: _____
Monument Description: _____
Monument Witnesses: _____

Field Book: _____ Page: _____

B (NORTH QUARTER CORNER)

Date Located: 3/30/17
By: SEM
Monument Description: FB MAGNAIL IN 3/4" IRON PIPE
Monument Witnesses: SEE Pg 183 "H"

Field Book: 6 Page: 40

C (NORTHEAST CORNER)

Date Located: 3/20/17
By: SEM
Monument Description: FB BRONZE / COPPER MARKER 8" DEEP
Monument Witnesses: SEE Pg 183 "I"

Field Book: 6 Page: 39

D (WEST QUARTER CORNER)

Date Located: _____
By: _____
Monument Description: _____
Monument Witnesses: _____

Field Book: _____ Page: _____

E (CENTER OF SECTION)

Date Located: _____
By: _____
Monument Description: _____
Monument Witnesses: _____

Field Book: _____ Page: _____

F (EAST QUARTER CORNER)

Date Located: _____
By: _____
Monument Description: _____
Monument Witnesses: _____

Field Book: _____ Page: _____

G (SOUTHWEST CORNER)

Date Located: _____
By: _____
Monument Description: _____
Monument Witnesses: _____

Field Book: _____ Page: _____

H (SOUTH QUARTER CORNER)

Date Located: _____
By: _____
Monument Description: _____
Monument Witnesses: _____

Field Book: _____ Page: _____

I (SOUTHEAST CORNER)

Date Located: _____
By: _____
Monument Description: _____
Monument Witnesses: _____

Field Book: _____ Page: _____

ADDITIONAL NOTES

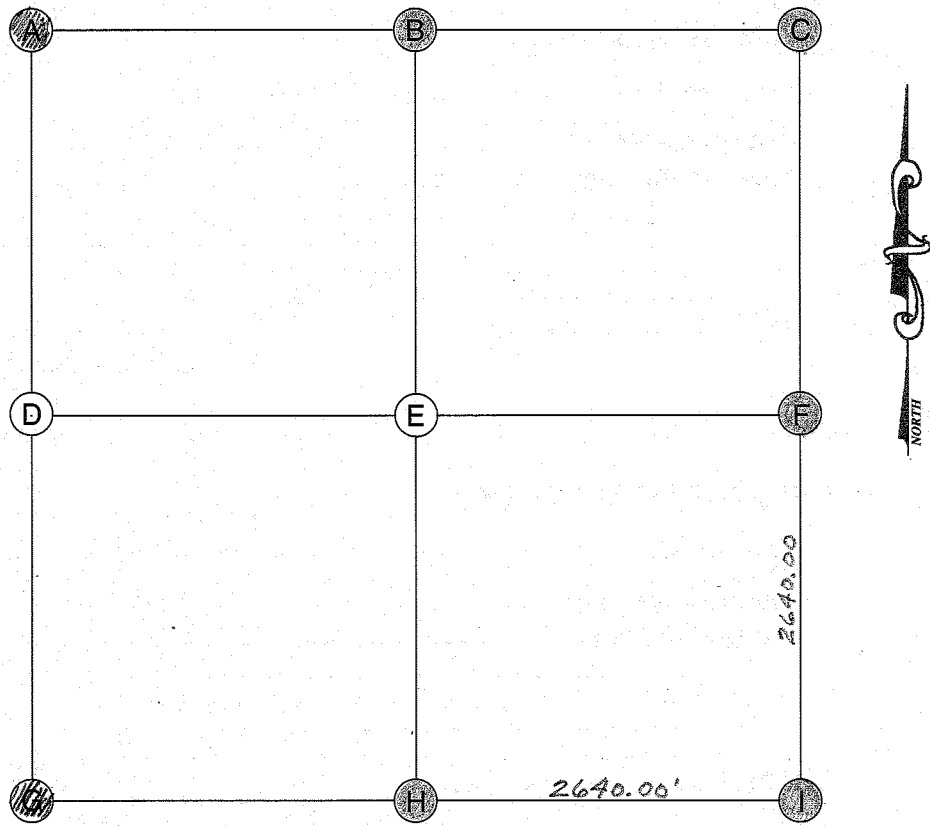

A (NORTHWEST CORNER)

Date Located: 4/5/18
By: SRM & MH
Monument Description: FO SPIKE NAIL FLUSH
Monument Witnesses: SEE P. 190 "C"

Field Book: 9 Page: 27

B (NORTH QUARTER CORNER)

Date Located: 3/26/18
By: SRM
Monument Description: RAILROAD SPIKE
Monument Witnesses: 1/2" REBAR W/CAP NW 32.91'
1/2" REBAR W/CAP NE 29.15'
NAIL IN B. CAP POWER POLE SE 65.65'
& RR RAIL FCP S 20.15'

Field Book: 9 Page: 18

C (NORTHEAST CORNER)

Date Located: 3/26/18
By: SRM
Monument Description: BRONZE MARKER
Monument Witnesses: 1/2" REBAR W/CAP NE 33.23'
& RR RAIL FCP S 19.15'
NAIL IN B. CAP POWER POLE WSW 71.70'

Field Book: 9 Page: 17

D (WEST QUARTER CORNER)

Date Located: _____
By: _____
Monument Description: _____
Monument Witnesses: _____

Field Book: _____ Page: _____

E (CENTER OF SECTION)

Date Located: _____
By: _____
Monument Description: _____
Monument Witnesses: _____

Field Book: _____ Page: _____

F (EAST QUARTER CORNER)

Date Located: 3/7/2001
By: MEK
Monument Description: RAILROAD IRON POST (RIP)
Monument Witnesses: RIP (ON SEC. LINE) 660.5' SOUTH
RIP (0.35' W. OF SEC. LINE) 1217.77' SOUTH
SEE LEGAL SURVEY BOOK 3 PAGE 160

Field Book: _____ Page: _____

G (SOUTHWEST CORNER)

Date Located: 8/1/16
By: SRM
Monument Description: FO 1/2" REBAR
Monument Witnesses: SE CORNER BRIDGE BEAM NW 41.35'
SW CORNER BRIDGE BEAM NE 45.27'
NAIL IN B. CAP IN POWER POLE SSW 20.45'

Field Book: 4 Page: 41

H (SOUTH QUARTER CORNER)

Date Located: (SET) 3/7/2001 - UPDATED 5/8/19
By: MEK
Monument Description: BRONZE MARKER W/ PLATE
Monument Witnesses: RR SPIKE 115.58' WEST of SAME LINE
1/2" REBAR W/CAP 20.6' NW, 10' N. ROULEMENT EDGE
18.9' NE 8' "
56.5' SE 17' S "
40.25' SW 16' " "

Field Book: 14 Page: 6

I (SOUTHEAST CORNER)

Date Located: (SET) 3/7/2001
By: MEK
Monument Description: 4" SQUARE CONC. MONUMENT
Monument Witnesses: WITH 1/2" REBAR (1' ABOVE GRADE)
RIP (26' SOUTH OF SEC. LINE) 91.25' WEST
E-W FENCE 2.5' SOUTH
120' E EAST OF C.R. 400 W CENTERLINE

Field Book: 14 Page: 7
SEE LEGAL SURVEY BOOK 3 PAGE 160

ADDITIONAL NOTES

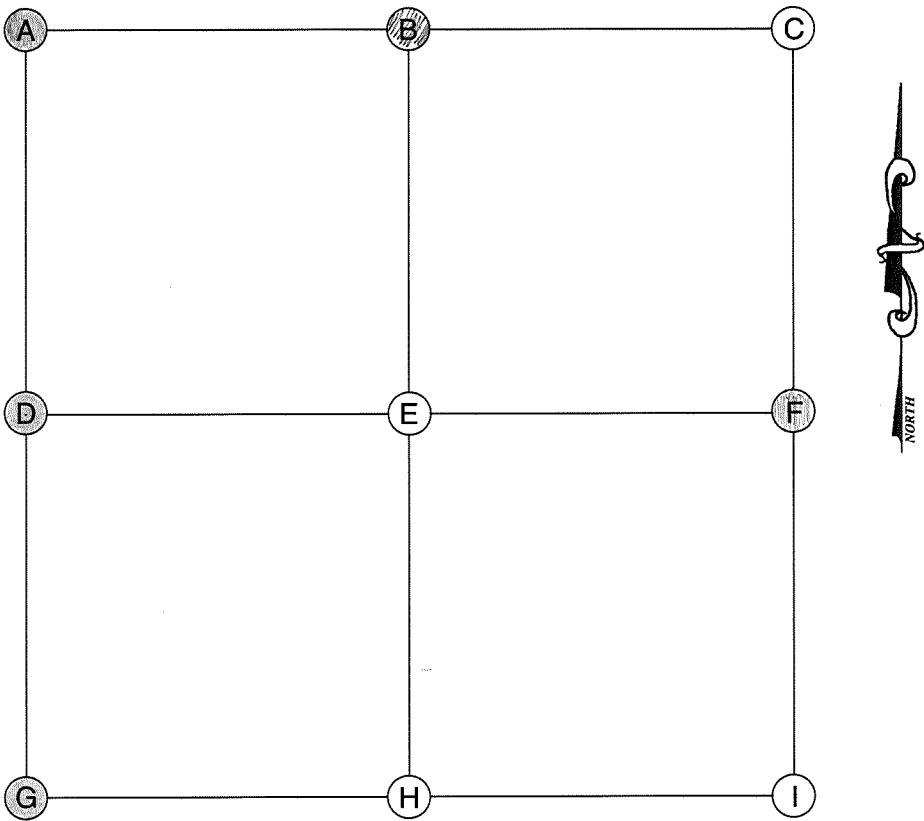

A (NORTHWEST CORNER)

Date Located: _____
By: _____
Monument Description: SEE PAGE 191 "C"
Monument Witnesses: NE 34-34-5

Field Book: _____ Page: _____

B (NORTH QUARTER CORNER)

Date Located: 3/20/18
By: SRM
Monument Description: RD RR SPIKE
Monument Witnesses: NAIL IN B. CAP NIPSCO P.P. WNW. 65.93'
1/2" X 10" REBAR W/CAP NW 23.57'
E RR RAIL FCP S 19.15'
USCGS BM G172 SW 32.50'
Field Book: 9 Page: 16

C (NORTHEAST CORNER)

Date Located: _____
By: _____
Monument Description: _____
Monument Witnesses: _____

Field Book: _____ Page: _____

D (WEST QUARTER CORNER)

Date Located: _____
By: _____
Monument Description: SEE PAGE 191 "F"
Monument Witnesses: E 1/4 Post 34-34-5

Field Book: _____ Page: _____

E (CENTER OF SECTION)

Date Located: _____
By: _____
Monument Description: _____
Monument Witnesses: _____

Field Book: _____ Page: _____

F (EAST QUARTER CORNER)

Date Located: 3/3/19
By: SRM NWHL
Monument Description: 1/2" REBAR W/CAP
Monument Witnesses: RR RAIL FCP E 19.16'
1/2" REBAR W/CAP SE 27.10'
NAIL IN B. CAP POWER POLE SSW 53.15'
Field Book: 16 Page: 42

G (SOUTHWEST CORNER)

Date Located: _____
By: _____
Monument Description: SEE PAGE 191 "I"
Monument Witnesses: SE 34-34-5

Field Book: _____ Page: _____

H (SOUTH QUARTER CORNER)

Date Located: _____
By: _____
Monument Description: _____
Monument Witnesses: _____

Field Book: _____ Page: _____

I (SOUTHEAST CORNER)

Date Located: _____
By: _____
Monument Description: _____
Monument Witnesses: _____

Field Book: _____ Page: _____

ADDITIONAL NOTES

Jefferson
36-34-5

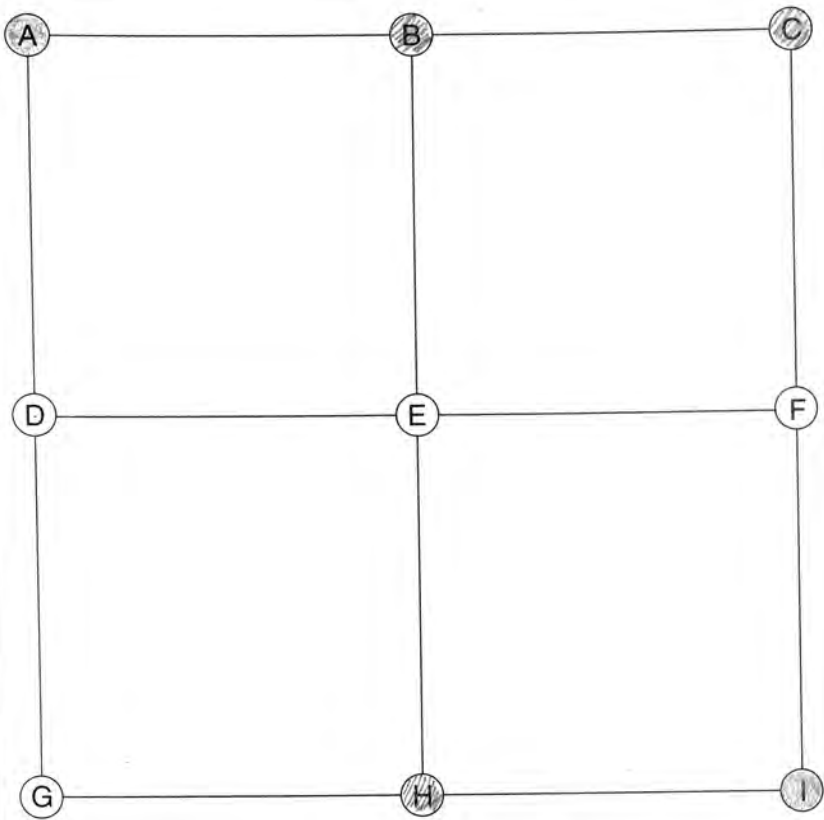

A (NORTHWEST CORNER)

Date Located: _____
By: _____
Monument Description: _____
Monument Witnesses: SEE PAGE 188 "I"
SE 26-34-5

Field Book: _____ Page: _____

B (NORTH QUARTER CORNER)

Date Located: 6/6/16
By: DR MOYER
Monument Description: FO PK NAIL FLUSH
Monument Witnesses: NAIL IN B CAP REMC POLE 0577 NNW 19.81'
NAIL IN B CAP NIPSCD POLE 031092 NNE 25.91'
MAG NAIL IN REMC POLE 0341 SE 62.43'
NAIL IN B CAP REMC POLE 0340 SSE 59.82'
USCGS BENCHMARK H 172

Field Book: 4 Page: 1

C (NORTHEAST CORNER)

Date Located: 6/6/16
By: DR MOYER
Monument Description: FO RR SPIKE 4" DEEP
Monument Witnesses: SEE Pg 474 "G"

Field Book: 4 Page: 2

D (WEST QUARTER CORNER)

Date Located: _____
By: _____
Monument Description: _____
Monument Witnesses: _____

Field Book: _____ Page: _____

E (CENTER OF SECTION)

Date Located: _____
By: _____
Monument Description: _____
Monument Witnesses: _____

Field Book: _____ Page: _____

F (EAST QUARTER CORNER)

Date Located: _____
By: _____
Monument Description: _____
Monument Witnesses: _____

Field Book: _____ Page: _____

G (SOUTHWEST CORNER)

Date Located: _____
By: _____
Monument Description: _____
Monument Witnesses: _____

Field Book: _____ Page: _____

H (SOUTH QUARTER CORNER)

Date Located: 6/22/16
By: DEM
Monument Description: FO 1" I. PIPE 6" DEEP
Monument Witnesses: SEE Pg 278 "B"

Field Book: 4 Page: 15

I (SOUTHEAST CORNER)

Date Located: _____
By: _____
Monument Description: _____
Monument Witnesses: SEE PAGE 247 "A"
NE 6-33-6

Field Book: _____ Page: _____

ADDITIONAL NOTES