

E (CENTER OF SECTION)

Date Located: _____
By: _____
Monument Description: _____
Monument Witnesses: _____

Field Book: _____ Page: _____

F (EAST QUARTER CORNER)

Date Located: 3/25/19 UPDATED
By: SRM
Monument Description: RR SPIKE
Monument Witnesses: SEE Pg. 450 "D"
1 1/4 POST 6-34-6

Field Book: 2 Page: 20

A (NORTHWEST CORNER)

Date Located: _____
By: _____
Monument Description: _____
Monument Witnesses: _____

Field Book: _____ Page: _____

G (SOUTHWEST CORNER)

Date Located: 1/9/17
By: SRM
Monument Description: FB MAG NAIL 3" DEEP
Monument Witnesses: SEE Pg 174 "A"

Field Book: 5 Page: 44

B (NORTH QUARTER CORNER)

Date Located: _____
By: _____
Monument Description: _____
Monument Witnesses: _____

Field Book: _____ Page: _____

H (SOUTH QUARTER CORNER)

Date Located: _____
By: _____
Monument Description: _____
Monument Witnesses: _____

Field Book: _____ Page: _____

C (NORTHEAST CORNER)

Date Located: _____
By: _____
Monument Description: _____
Monument Witnesses: SEE Pg. 450 "A"
NW 6-34-6

Field Book: _____ Page: _____

I (SOUTHEAST CORNER)

Date Located: 3/15/19
By: SRM MWH
Monument Description: 1/2" REBAR
Monument Witnesses: 1/2" REBAR FCP E 21'
1/2" REBAR W/CAP SE 27.68'
1/2" REBAR W/CAP SW 26.70'

Field Book: 16 Page: 68

D (WEST QUARTER CORNER)

Date Located: 3/15/19
By: SRM MWH
Monument Description: PK NAIL 6" DEEP
Monument Witnesses: SEE Pg 164 "F"

Field Book: 16 Page: 67

ADDITIONAL NOTES



Field Book: _____ Page: _____

F (EAST QUARTER CORNER)

Field Book: 16 Page: 67

A (NORTHWEST CORNER)

Field Book: 16 Page: 56

G (SOUTHWEST CORNER)

Field Book: 16 Page: 30

B (NORTH QUARTER CORNER)

Field Book: _____ Page: _____

H (SOUTH QUARTER CORNER)

Field Book: _____ Page: _____

C (NORTHEAST CORNER)

Field Book: _____ Page: _____

I (SOUTHEAST CORNER)

Field Book: 5 Page: 44

D (WEST QUARTER CORNER)

Field Book: _____ Page: _____

ADDITIONAL NOTES

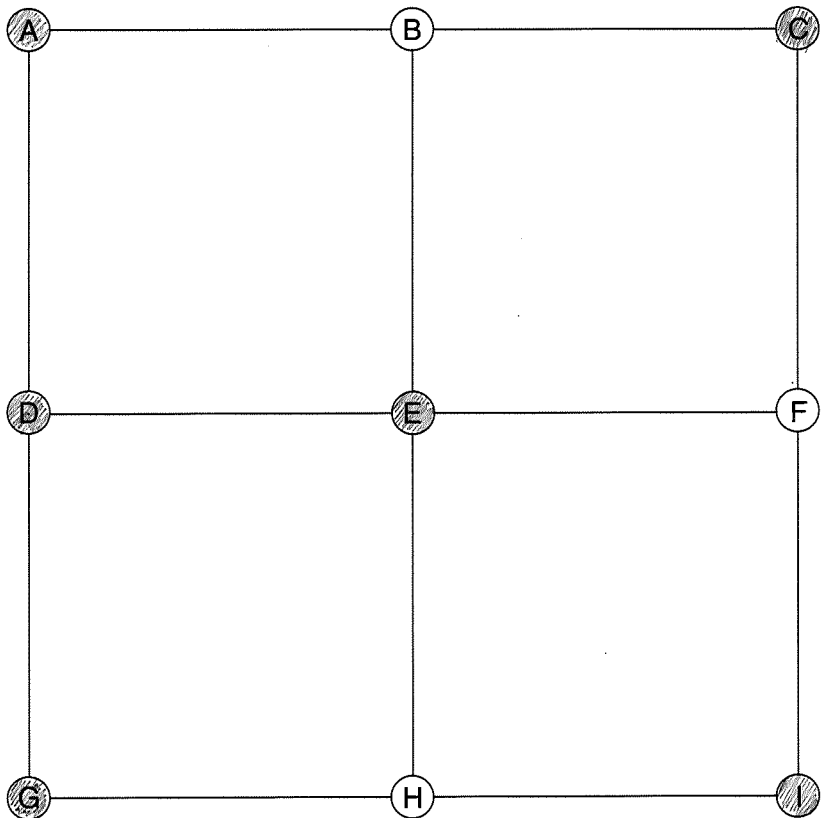

E (CENTER OF SECTION)

Date Located: 3/15/19
By: DEM MWH
Monument Description: RR SPIKE
Monument Witnesses: FACE 6"X10" I BEAM POST N 8.9'
2 1/2" DIA STEEL FCP S 20.0'
1/2" REBAR W/CAP SW 29.80'
Field Book: 16 Page: 66

F (EAST QUARTER CORNER)

Date Located: _____
By: _____
Monument Description: _____
Monument Witnesses: _____
Field Book: _____ Page: _____

G (SOUTHWEST CORNER)

Date Located: 4/2/18
By: DEM
Monument Description: FOR RR SPIKE 2" DEEP
Monument Witnesses: NAIL IN B. CAP NIPSCO POLE NNW 53.00'
NAIL IN B. CAP NIPSCO POLE ENE 29.26'
1/2" RR RAIL FCP E 20.08'
NAIL IN B. CAP NIPSCO POLE SW 59.05'
Field Book: 9 Page: 22

A (NORTHWEST CORNER)

Date Located: 3/14/19
By: DEM MWH
Monument Description: SET 1/2" REBAR W/CAP
Monument Witnesses: NAIL IN B. CAP NIPSCO POLE ENE 134.23'
EDGE RR RAIL FCP ESE 91.7'
NAIL IN B. CAP NIPSCO POLE SE 66.63'
Field Book: 16 Page: 65

B (NORTH QUARTER CORNER)

Date Located: _____
By: _____
Monument Description: _____
Monument Witnesses: _____
Field Book: _____ Page: _____

H (SOUTH QUARTER CORNER)

Date Located: _____
By: _____
Monument Description: _____
Monument Witnesses: _____
Field Book: _____ Page: _____

C (NORTHEAST CORNER)

Date Located: 3/13/19
By: DEM MOYER
Monument Description: 5/8" REBAR
Monument Witnesses: NAIL IN B. CAP NIPSCO POLE NE 19.60'
HARRISON MON (ELK CO) E 152.30'
1/2" X 24" REBAR W/CAP SW 30.95'
Field Book: 16 Page: 56

I (SOUTHEAST CORNER)

Date Located: 3/1/19
By: DEM MWH
Monument Description: FO 5/8" REBAR
Monument Witnesses: SEE Pg 172 "C"
Field Book: 16 Page: 30

D (WEST QUARTER CORNER)

Date Located: 3/14/19
By: DEM MWH
Monument Description: RR SPIKE
Monument Witnesses: NAIL IN B. CAP NIPSCO POLE NNW 66.10'
1/2" REBAR W/CAP NE 32.77'
NAIL IN B. CAP NIPSCO POLE SW 32.32'
Field Book: 16 Page: 64

ADDITIONAL NOTES

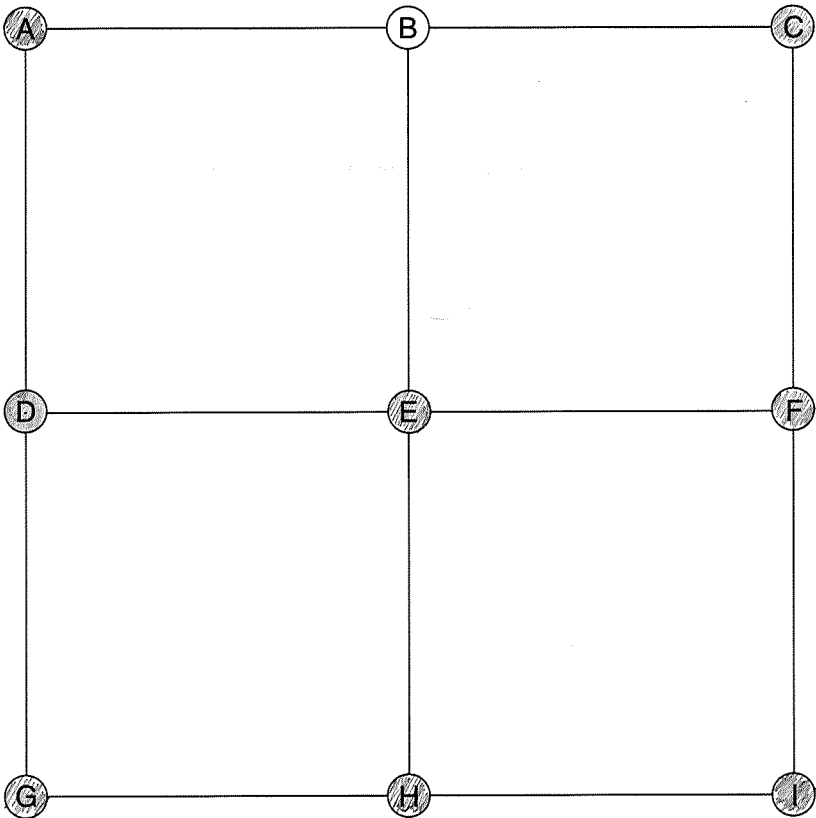

A (NORTHWEST CORNER)

Date Located: 8/14/19
By: SEM MWH
Monument Description: 3/4" IRON PIPE
Monument Witnesses: SEE Pg 167 "C"

Field Book: 16 Page: 61

B (NORTH QUARTER CORNER)

Date Located: _____
By: _____
Monument Description: _____
Monument Witnesses: _____

Field Book: _____ Page: _____

C (NORTHEAST CORNER)

Date Located: 8/14/19
By: SEM MWH
Monument Description: SET 1/2" REBAR W/CAP
Monument Witnesses: SEE Pg 165 "A"

Field Book: 16 Page: 65

D (WEST QUARTER CORNER)

Date Located: 8/14/19
By: SEM MWH
Monument Description: SEE "F" PAGE 167
Monument Witnesses: E 1/4 POST 5-34-5

Field Book: 16 Page: 62

E (CENTER OF SECTION)

Date Located: 8/14/19
By: SEM MWH
Monument Description: RR SPIKE
Monument Witnesses: 2" DIA STEEL PIPE N 22.23'
1/2" REBAR W/CAP SE 23.15'
1/2" REBAR W/CAP SW 22.08'

Field Book: 16 Page: 63

F (EAST QUARTER CORNER)

Date Located: 8/14/19
By: SEM MWH
Monument Description: RR SPIKE
Monument Witnesses: SEE Pg 165 "D"

Field Book: 16 Page: 64

G (SOUTHWEST CORNER)

Date Located: 8/8/19
By: SEM MWH
Monument Description: 1/2" REBAR
Monument Witnesses: SEE Pg 171 "A"

Field Book: 16 Page: 50

H (SOUTH QUARTER CORNER)

Date Located: 8/8/19
By: SEM MWH
Monument Description: 1/4" 50 HEAD BOLT
Monument Witnesses: SEE Pg 171 "B"

Field Book: 16 Page: 51

I (SOUTHEAST CORNER)

Date Located: 4/2/18
By: SEM
Monument Description: FOR RR SPIKE 2" DEEP
Monument Witnesses: SEE Pg 165 "G"

Field Book: 9 Page: 22

ADDITIONAL NOTES

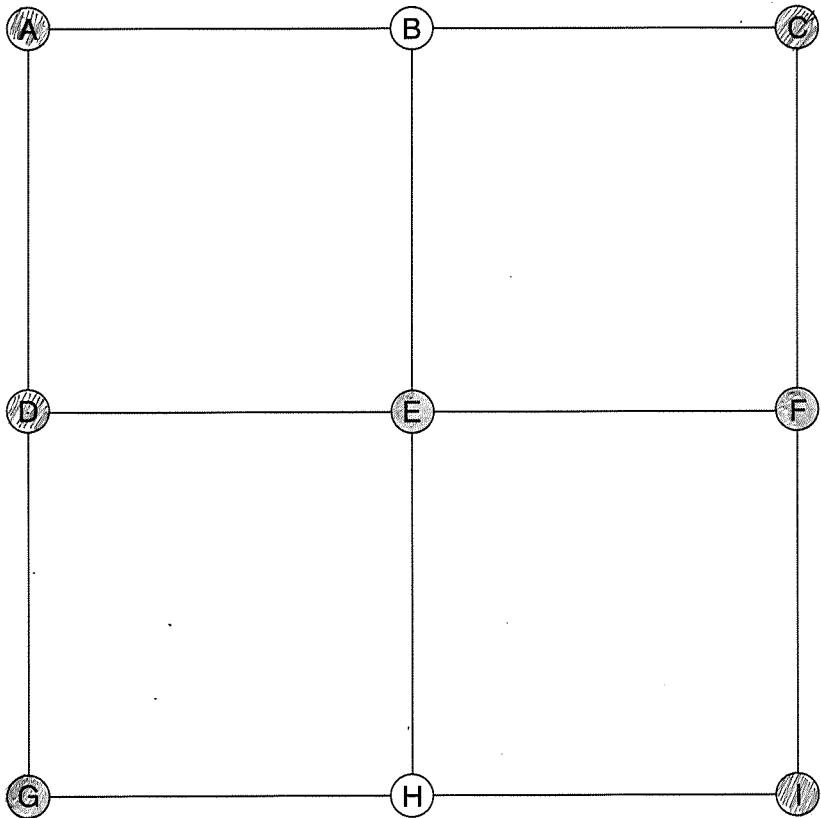

A (NORTHWEST CORNER)

Date Located: 6/21/17
By: SRM
Monument Description: 3/4" IRON PIN IN CONC
Monument Witnesses: SEE Pg 168 "C"

Field Book: 7 Page: 27

B (NORTH QUARTER CORNER)

Date Located: _____
By: _____
Monument Description: _____
Monument Witnesses: _____

Field Book: _____ Page: _____

C (NORTHEAST CORNER)

Date Located: 3/14/19
By: SRM MWH
Monument Description: 3/4" IRON PIPE
Monument Witnesses: NAIL IN B. CAP NIPSCO P NW 47.66'
1" IRON PIPE (ELK CO) E 141.2'
NAIL IN B. CAP NIPSCO POLE ESE 78.15'

Field Book: 16 Page: 61

D (WEST QUARTER CORNER)

Date Located: 9/11/17
By: SRM
Monument Description: FO 1/2" REBAR
Monument Witnesses: SEE Pg 168 "F"

Field Book: 7 Page: 62

E (CENTER OF SECTION)

Date Located: 6/18/99 3/18/19
By: SRM
Monument Description: RAILROAD SPIKE 6" DEEP
Monument Witnesses: NAIL IN B. CAP FCP N 21.34'
1/2" REBAR W/CAP NE 28.28'

Field Book: 12 Page: 56

F (EAST QUARTER CORNER)

Date Located: 3/14/19
By: SRM MWH
Monument Description: MAG NAIL W/CAP TAG
Monument Witnesses: FO PK NAIL POWER POLE NNW 54.70'
1/2" REBAR W/CAP NE 38.13'
FO PK NAIL IN POWER POLE SW 29.21'

Field Book: 16 Page: 62

G (SOUTHWEST CORNER)

Date Located: _____
By: _____
Monument Description: _____
Monument Witnesses: SEE Pg 170 "A"
NW 8-34-5

Field Book: _____ Page: _____

H (SOUTH QUARTER CORNER)

Date Located: _____
By: _____
Monument Description: _____
Monument Witnesses: _____

Field Book: _____ Page: _____

I (SOUTHEAST CORNER)

Date Located: 3/3/19
By: SRM MWH
Monument Description: 1/2" REBAR
Monument Witnesses: SEE Pg 171 "A"

Field Book: 16 Page: 50

ADDITIONAL NOTES

Jefferson
6-34-5

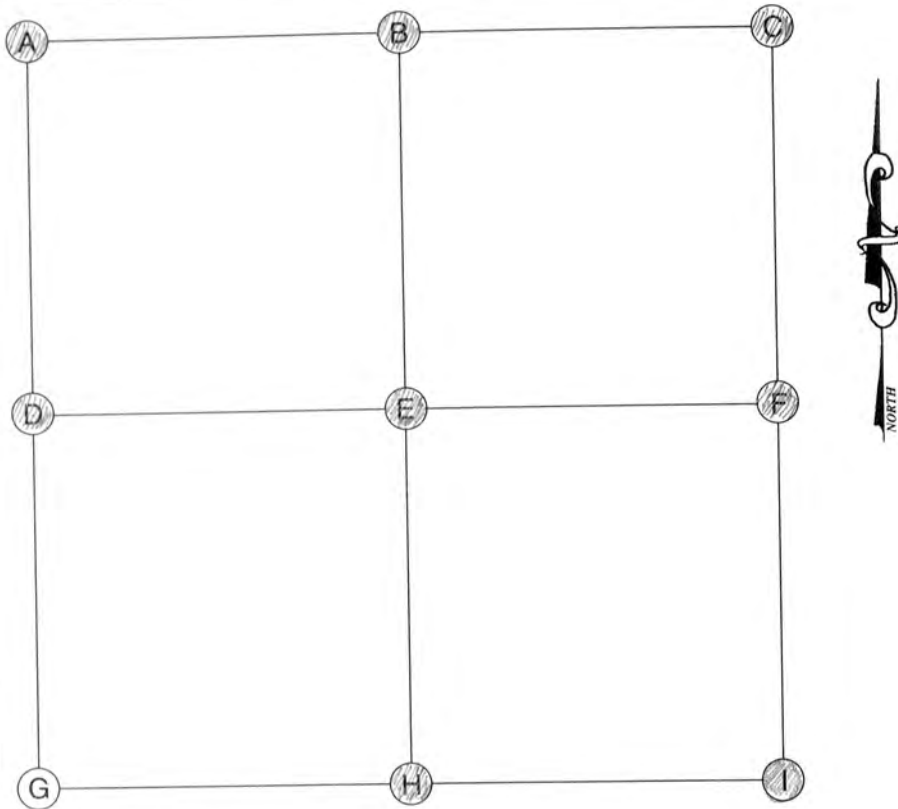

A (NORTHWEST CORNER)

Date Located: 6/21/17
By: DEM
Monument Description: HARRISON MONUMENT
Monument Witnesses: 1/2" REBAR w/CAP SW 29.36'
NAIL IN B. CAP NIPSCO PP W 20.75'
"4" CUT IN SAN SEWER MW RM ESE 40.47'
NAIL IN B. CAP NIPSCO L.P. SE 33.55'

Field Book: 7 Page: 25

B (NORTH QUARTER CORNER)

Date Located: 6/21/17
By: DEM
Monument Description: RR RAIL FCP
Monument Witnesses: 5/8" REBAR NO CAP N 2.3'
5/8" REBAR "DORLOT" CAP W 42'

Field Book: 7 Page: 26

C (NORTHEAST CORNER)

Date Located: 6/21/17
By: DEM
Monument Description: 3/4" IRON PIN IN CONG FLUSH
Monument Witnesses: 1/2" REBAR w/CAP NE 18.66'
1/2" REBAR w/CAP SE 25.50'
3/4" IRON PIN IN CONG (EX-G CORNER) W 34.00'

Field Book: 7 Page: 27

D (WEST QUARTER CORNER)

Date Located: 6/21/17
By: DEM
Monument Description: BRONZE MARKER
Monument Witnesses: 1/2" REBAR w/CAP SW 44.25'
USC & GS BM P171 1946 NW 43.04'
1/2" REBAR w/CAP NW 49.04'
NAIL IN B. CAP NIPSCO PP ESE 42.23'
NAIL IN B. CAP NIPSCO PP SSE 40.45'

Field Book: 7 Page: 24

E (CENTER OF SECTION)

Date Located: 9/11/17
By: DEM
Monument Description: FB MAG NAIL
Monument Witnesses: 1/2" REBAR w/CAP NE 34.28'
NAIL IN B. CAP NIPSCO PP 683/187 SSW 61.98'
NAIL IN B. CAP NIPSCO PP 687/503 WSW 47.26'

Field Book: 7 Page: 61

F (EAST QUARTER CORNER)

Date Located: 9/11/17
By: DEM
Monument Description: FB 1/2" REBAR 4" DEEP
Monument Witnesses: NAIL IN B. CAP NIPSCO PP NW 32.52'
1/2" REBAR w/CAP NE 50.36'
NAIL IN B. CAP NIPSCO PP 1060/475 SE 45.22'
NAIL IN B. CAP NIPSCO PP 682/446 SW 53.57'

Field Book: 7 Page: 62

G (SOUTHWEST CORNER)

Date Located: Nothing w/ FB 9/11/17 DEM
By: DEM
Monument Description:
Monument Witnesses:

Field Book: Page:

H (SOUTH QUARTER CORNER)

Date Located: 9/11/17
By: DEM
Monument Description: FB 1/2" REBAR
Monument Witnesses: 1/2" REBAR w/CAP NNE 42.11'
1/2" REBAR w/CAP ENE 43.30'
4" RR RAIL FCP W 20.3'

Field Book: 7 Page: 63

I (SOUTHEAST CORNER)

Date Located: UPDATED 9/11/17 DEM
By: DEM
Monument Description: FD 1" SQ RR BOLT
Monument Witnesses: PK NAIL IN NIPSCO PP NW 31.95'
PK NAIL IN NIPSCO PP 679/913 ESE 62.42'
1/2" x 1/2" REBAR w/CAP NE 41.30'
NE CORNER FOUNDATION CORN CRIB SW 55.60'

Field Book: 2 Page: 28

ADDITIONAL NOTES

Jefferson
7-34-5

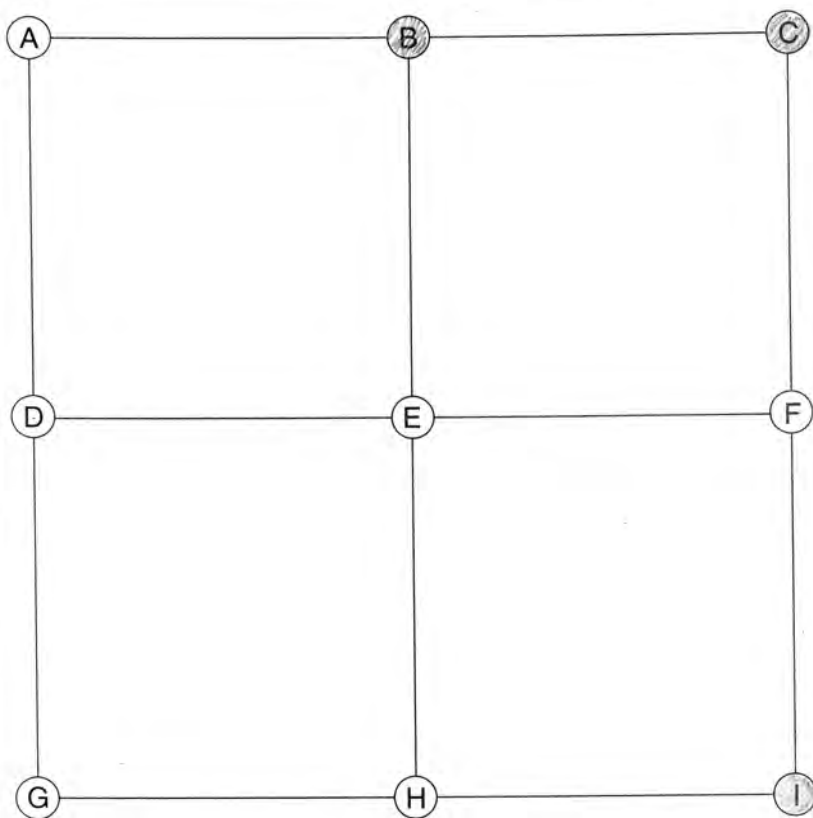

E (CENTER OF SECTION)

Date Located: _____
By: _____
Monument Description: _____
Monument Witnesses: _____

Field Book: _____ Page: _____

F (EAST QUARTER CORNER)

Date Located: _____
By: _____
Monument Description: _____
Monument Witnesses: _____

Field Book: _____ Page: _____

A (NORTHWEST CORNER)

Date Located: _____
By: _____
Monument Description: _____
Monument Witnesses: _____

Field Book: _____ Page: _____

G (SOUTHWEST CORNER)

Date Located: _____
By: _____
Monument Description: _____
Monument Witnesses: _____

Field Book: _____ Page: _____

B (NORTH QUARTER CORNER)

Date Located: 9/11/17
By: SRM
Monument Description: FB 1/2' BEAR
Monument Witnesses: SEE Pg. 168 "4"

Field Book: 7 Page: 63

H (SOUTH QUARTER CORNER)

Date Located: _____
By: _____
Monument Description: _____
Monument Witnesses: _____

Field Book: _____ Page: _____

C (NORTHEAST CORNER)

Date Located: _____
By: _____
Monument Description: _____
Monument Witnesses: SEE Pg. 170 "A"
NW 8-34-5

Field Book: _____ Page: _____

I (SOUTHEAST CORNER)

Date Located: _____
By: _____
Monument Description: _____
Monument Witnesses: SEE Pg. 179 "A"
NW 17-34-5

Field Book: _____ Page: _____

D (WEST QUARTER CORNER)

Date Located: _____
By: _____
Monument Description: _____
Monument Witnesses: _____

Field Book: _____ Page: _____

ADDITIONAL NOTES

Jefferson
8-34-5

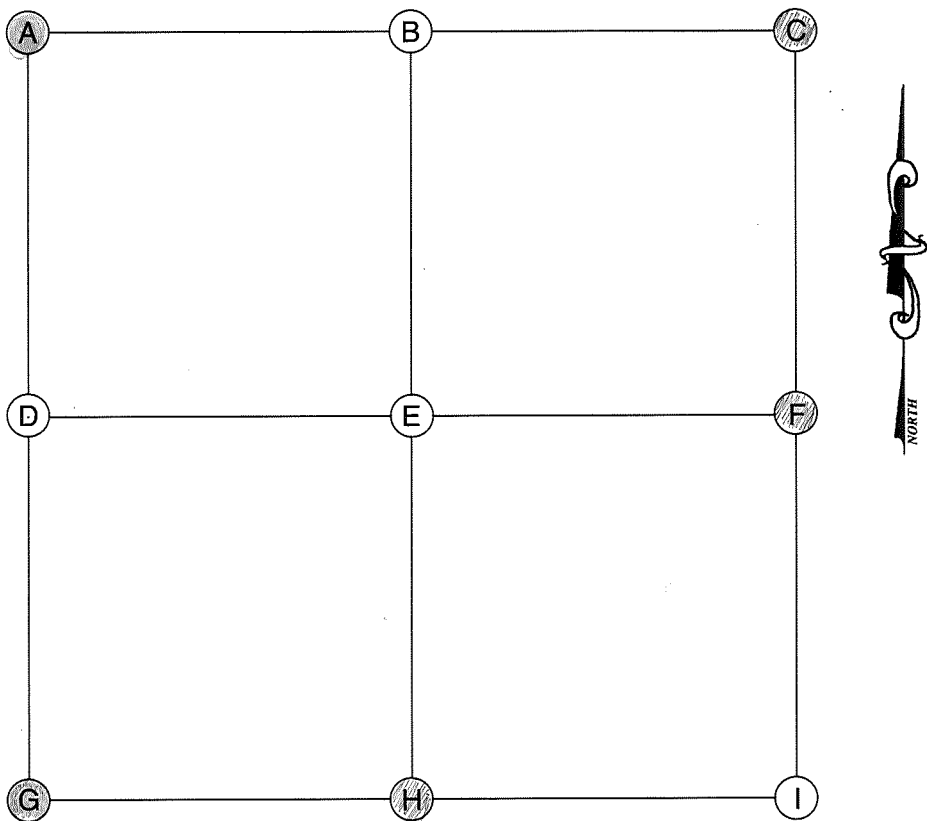

A (NORTHWEST CORNER)

Date Located: 7/29/92
By: JA MOYER - EC HAINES
Monument Description: BA BOLT
Monument Witnesses: S FACE OF A BA BAIL FOR NNE 46.40
FR PN NAIL IN NE FACE OF A NIPSCO PP NW 31.95
" " " " N " " " " " ESE 62.40
Field Book: 2 Page: 28 UPDATED 9/11/17

B (NORTH QUARTER CORNER)

Date Located: _____
By: _____
Monument Description: _____
Monument Witnesses: _____
Field Book: _____ Page: _____

C (NORTHEAST CORNER)

Date Located: 8/8/19
By: SEM MNH
Monument Description: 1/2" REBAR
Monument Witnesses: SEE Pg 171 "A"
Field Book: 16 Page: 50

D (WEST QUARTER CORNER)

Date Located: _____
By: _____
Monument Description: _____
Monument Witnesses: _____
Field Book: _____ Page: _____

E (CENTER OF SECTION)

Date Located: _____
By: _____
Monument Description: _____
Monument Witnesses: _____
Field Book: _____ Page: _____

F (EAST QUARTER CORNER)

Date Located: 8/8/19
By: SEM MNH
Monument Description: 1 1/4" SO HEAD BOLT
Monument Witnesses: SEE Pg 171 "D"
Field Book: 16 Page: 52

G (SOUTHWEST CORNER)

Date Located: _____
By: _____
Monument Description: _____
Monument Witnesses: SEE Pg 179 "A"
NW 17-34-5
Field Book: _____ Page: _____

H (SOUTH QUARTER CORNER)

Date Located: 8/14/19
By: SEM MNH
Monument Description: 3/4" IRON PIPE
Monument Witnesses: 1/2" REBAR W/CAP NW 15.00'
1/2" REBAR W/CAP NE 14.22'
1/2" REBAR W/CAP SE 17.00'
Field Book: 16 Page: 60

I (SOUTHEAST CORNER)

Date Located: _____
By: _____
Monument Description: _____
Monument Witnesses: _____
Field Book: _____ Page: _____

ADDITIONAL NOTES

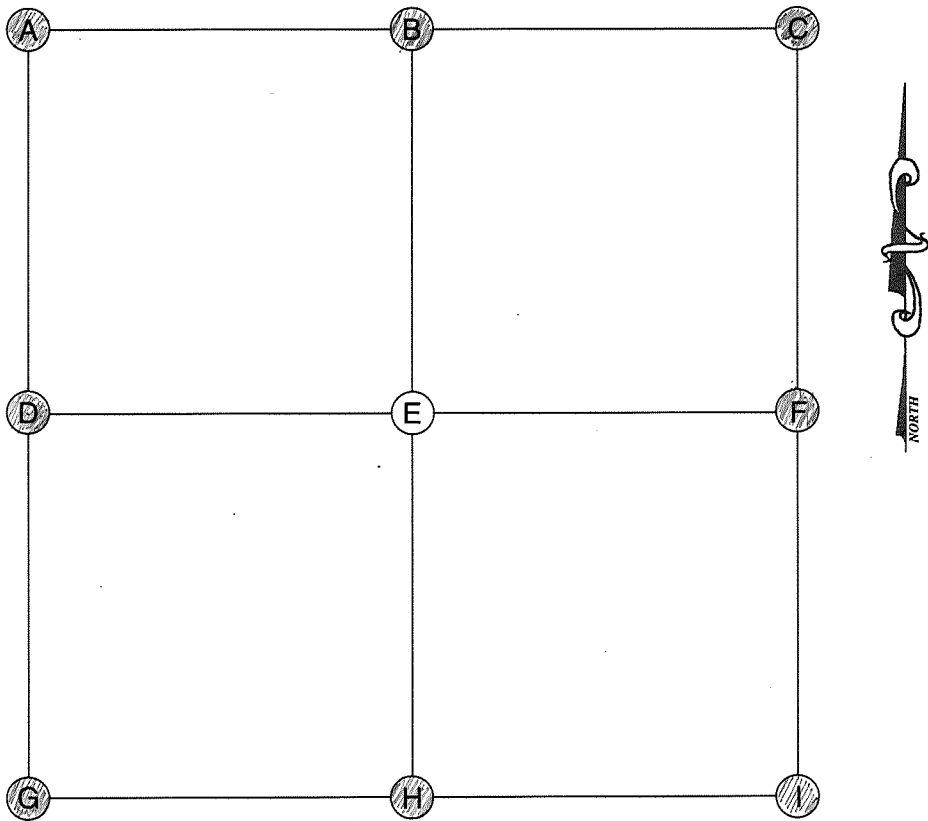

A (NORTHWEST CORNER)

Date Located: 8/8/19
By: SEM MWH
Monument Description: 1/2" REBAR
Monument Witnesses: NAIL IN B. CAP NIPSCO POLE NNW 47.75'
NAIL IN B. CAP NIPSCO POLE WNW 61.30'
NAIL IN B. CAP NIPSCO POLE SSW 53.14'
Field Book: 16 Page: 50

B (NORTH QUARTER CORNER)

Date Located: 8/8/19
By: SEM MWH
Monument Description: 1/4" 50 HEAD BOLT
Monument Witnesses: FD 5/8" REBAR N 17.70'
NAIL IN B. CAP POWER POLE SE 41.86'
1/2" REBAR W/CAP SW 19.84'
Field Book: 16 Page: 51

C (NORTHEAST CORNER)

Date Located: 4/2/13
By: SEM
Monument Description: FD RR SPIKE 2" DEEP
Monument Witnesses: SEE Pg 165 "G"
Field Book: 9 Page: 22

D (WEST QUARTER CORNER)

Date Located: 8/8/19
By: SEM MWH
Monument Description: 1/4" 50 HEAD BOLT
Monument Witnesses: 1/2" REBAR W/CAP NW 23.44'
1/2" REBAR W/CAP SE 21.53'
1/2" REBAR W/CAP SW 22.97'
Field Book: 16 Page: 52

E (CENTER OF SECTION)

Date Located: _____
By: _____
Monument Description: _____
Monument Witnesses: _____
Field Book: _____ Page: _____

F (EAST QUARTER CORNER)

Date Located: 8/1/19
By: SEM MWH
Monument Description: FD 5/8" REBAR
Monument Witnesses: SEE Pg 172 "D"
Field Book: 16 Page: 32

G (SOUTHWEST CORNER)

Date Located: 8/8/19
By: SEM MWH
Monument Description: 5/8" REBAR
Monument Witnesses: 1/2" REBAR W/CAP NE 20.94'
1/2" REBAR W/CAP SE 39.10'
1/2" REBAR W/CAP SW 23.48'
Field Book: 16 Page: 53

H (SOUTH QUARTER CORNER)

Date Located: 8/14/19
By: SEM MWH
Monument Description: 1/2" REBAR W/CAP
Monument Witnesses: SEE Pg 173 "B"
Field Book: 16 Page: 59

I (SOUTHEAST CORNER)

Date Located: 4/18/17
By: SEM
Monument Description: FD 5/8" REBAR
Monument Witnesses: 1/2" REBAR W/CAP NW 35.12'
NAIL IN B. CAP IN POWER POLE NW 37.00'
1/2" REBAR W/CAP SW 40.00'
Field Book: 6 Page: 63

ADDITIONAL NOTES

Jefferson
10-34-5

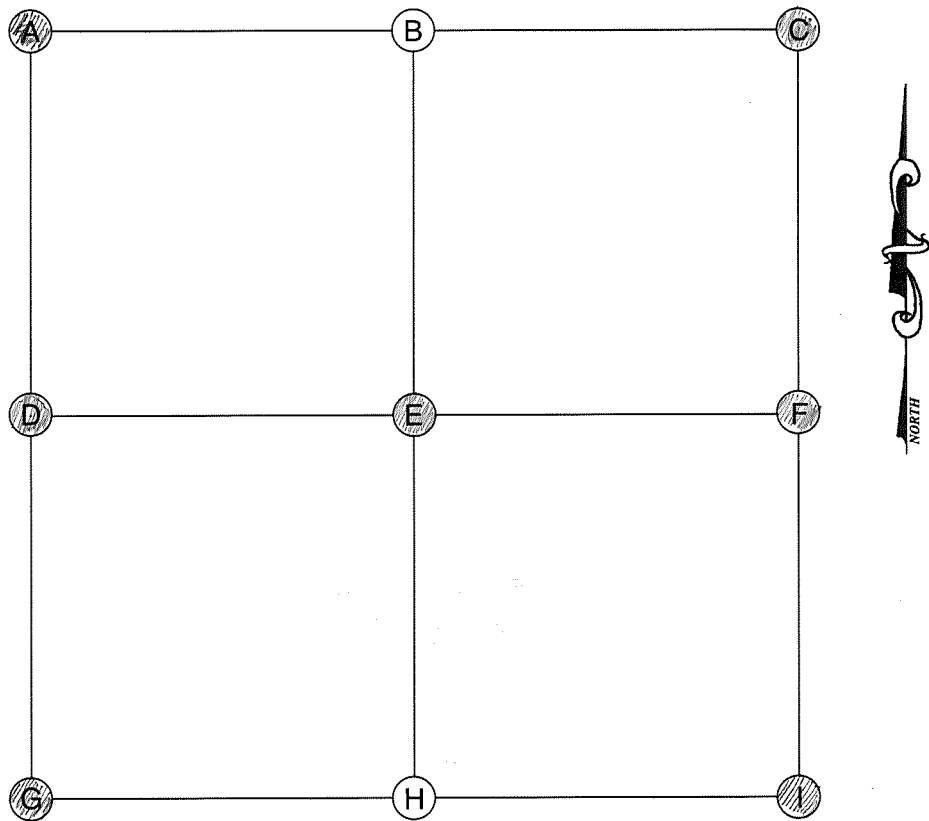

A (NORTHWEST CORNER)

Date Located: 4/2/18
By: SEM
Monument Description: FO RR SPIKE 2" DEEP
Monument Witnesses: SEE Pg 165 "G"

Field Book: 9 Page: 22

B (NORTH QUARTER CORNER)

Date Located: _____
By: _____
Monument Description: _____
Monument Witnesses: _____

Field Book: _____ Page: _____

C (NORTHEAST CORNER)

Date Located: 3/1/19
By: SEM MWH
Monument Description: FO 5/8" REBAR
Monument Witnesses: 1/2" REBAR w/CAP NW 34.82'
1/2" REBAR w/CAP NE 21.84'
2 1/2" DIA STEEL FCP W 20.35'

Field Book: 16 Page: 30

D (WEST QUARTER CORNER)

Date Located: 3/1/19
By: SEM MWH
Monument Description: FO 5/8" REBAR
Monument Witnesses: 1/2" REBAR w/CAP NE 43.43'
1/2" REBAR w/CAP ESE 58.34'
1/2" REBAR w/CAP SSW 41.36'

Field Book: 16 Page: 32

E (CENTER OF SECTION)

Date Located: 3/1/19
By: SEM MWH
Monument Description: FO RR SPIKE
Monument Witnesses: 1/2" REBAR w/CAP NW 23.30'
FACE OF RR RAIL FCP N 20.0'
NAIL IN B. CAP NIPSCO POLE SE 37.43'

Field Book: 16 Page: 31

F (EAST QUARTER CORNER)

Date Located: 3/1/19
By: SEM MWH
Monument Description: FO PK NAIL
Monument Witnesses: SEE Pg 173 "D"

Field Book: 16 Page: 29

G (SOUTHWEST CORNER)

Date Located: 4/18/17
By: SEM
Monument Description: FO 5/8" REBAR
Monument Witnesses: SEE Pg 171 "I"

Field Book: 6 Page: 63

H (SOUTH QUARTER CORNER)

Date Located: _____
By: _____
Monument Description: _____
Monument Witnesses: _____

Field Book: _____ Page: _____

I (SOUTHEAST CORNER)

Date Located: 2/1/17
By: SEM
Monument Description: FO 1/2" BOLT 3" DEEP
Monument Witnesses: SEE Pg 177 "C"

Field Book: 5 Page: 65

ADDITIONAL NOTES

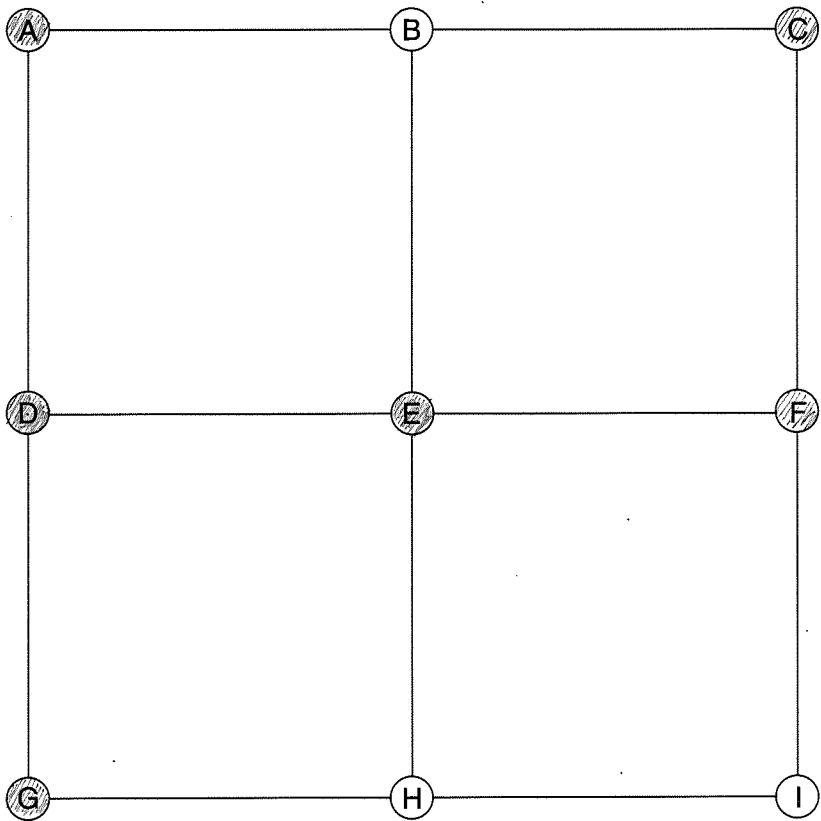

A (NORTHWEST CORNER)

Date Located: 8/1/19
By: DEM MNH
Monument Description: FO 5/8" REBAR
Monument Witnesses: SEE Pg 172 "C"

Field Book: 16 Page: 30

B (NORTH QUARTER CORNER)

Date Located: _____
By: _____
Monument Description: _____
Monument Witnesses: _____

Field Book: _____ Page: _____

C (NORTHEAST CORNER)

Date Located: 1/9/17
By: DEM
Monument Description: FO MAG NAIL 3" DEEP
Monument Witnesses: SEE Pg 174 "A"

Field Book: 5 Page: 44

D (WEST QUARTER CORNER)

Date Located: 8/1/19
By: DEM MNH
Monument Description: FO PK NAIL
Monument Witnesses: NAIL IN B. CAP NIPSCO POLE NNE 46.02'
NAIL IN B. CAP NIPSCO POLE SE 33.97'
1/2" REBAR W/ CAP

Field Book: 16 Page: 29

E (CENTER OF SECTION)

Date Located: 8/1/19
By: DEM MNH
Monument Description: FO RR SPIKE
Monument Witnesses: FO 2 1/2" DIA STEEL FCP N 20.3'
1/2" REBAR W/ CAP NE 32.18'
NAIL IN B. CAP NIPSCO POLE SE 35.78'

Field Book: 16 Page: 28

F (EAST QUARTER CORNER)

Date Located: 1/9/17
By: DEM
Monument Description: FO RR SPIKE 4" DEEP
Monument Witnesses: SEE Pg 174 "D"

Field Book: 5 Page: 45

G (SOUTHWEST CORNER)

Date Located: 2/1/17
By: DEM
Monument Description: FO 1/2" BOLT 3" DEEP
Monument Witnesses: SEE Pg 177 "C"

Field Book: 5 Page: 64

H (SOUTH QUARTER CORNER)

Date Located: _____
By: _____
Monument Description: _____
Monument Witnesses: _____

Field Book: _____ Page: _____

I (SOUTHEAST CORNER)

Date Located: _____
By: _____
Monument Description: _____
Monument Witnesses: _____

Field Book: _____ Page: _____

ADDITIONAL NOTES

Jefferson
12-34-5

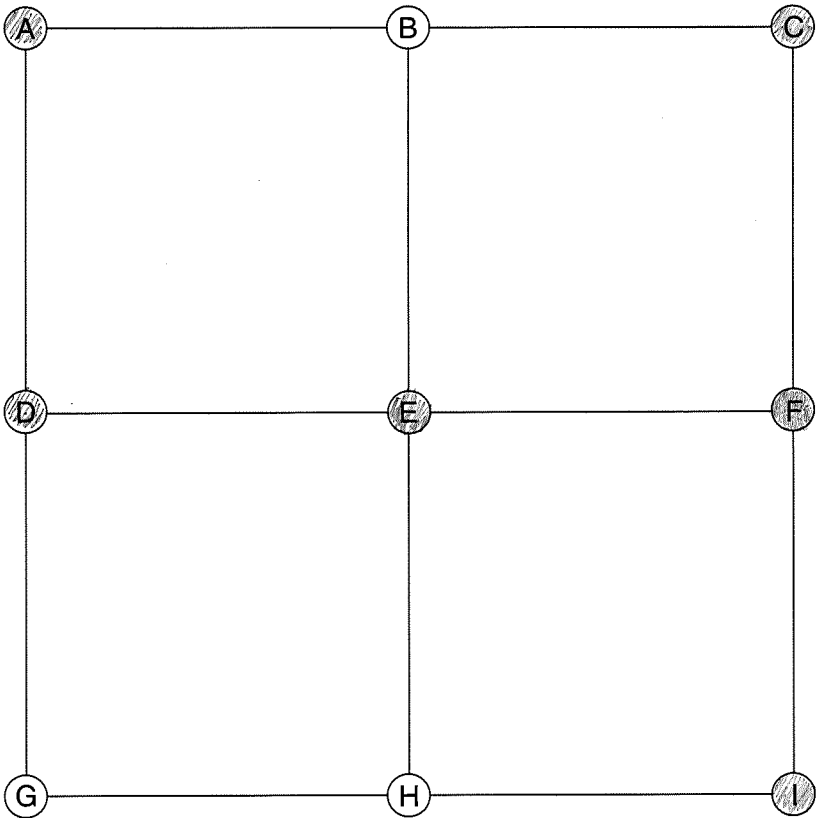

A (NORTHWEST CORNER)

Date Located: 1/9/17
By: SEM
Monument Description: FO MAG NAIL 3" DEEP
Monument Witnesses: ERR RAIL FCP W 20.04'
NAIL IN B. CAP NIPSCO PP 690/568 WNW 21.15'
NAIL IN B. CAP NIPSCO PP 690/567 NE 55.90'
1/2" REBAR W/CAP SE 26.15'
Field Book: 5 Page: 44

B (NORTH QUARTER CORNER)

Date Located: _____
By: _____
Monument Description: _____
Monument Witnesses: _____
Field Book: _____ Page: _____

C (NORTHEAST CORNER)

Date Located: 3/15/19
By: SEM MWH
Monument Description: 1/2" REBAR
Monument Witnesses: SEE Pg 163 "I"
Field Book: 16 Page: 68

D (WEST QUARTER CORNER)

Date Located: 1/9/17
By: SEM
Monument Description: FO RR SPIKE 4" DEEP
Monument Witnesses: NAIL IN B. CAP NIPSCO PP NW 51.26'
NAIL IN B. CAP NIPSCO PP 1056/513 SE 63.06'
3" IRON PIPE IN CONCRETE S 20.11'
NAIL IN B. CAP NIPSCO 1053/424 SW 44.76'
Field Book: 5 Page: 45

E (CENTER OF SECTION)

Date Located: 3/1/19
By: SEM MWH
Monument Description: FO RR SPIKE
Monument Witnesses: NAIL IN B. CAP NIPSCO POLE NNE 47.63'
"WALKER" CAPPED IRON NE 37.45'
NAIL IN B. CAP NIPSCO POLE SE 22.56'
Field Book: 16 Page: 27

F (EAST QUARTER CORNER)

Date Located: 3/25/19 UPDATED
By: SEM
Monument Description: MAG NAIL W/CO TAG
Monument Witnesses: SEE PAGE 451 "D"
W 1/4 POST 7-34-6
Field Book: 2 Page: 19

G (SOUTHWEST CORNER)

Date Located: _____
By: _____
Monument Description: _____
Monument Witnesses: _____
Field Book: _____ Page: _____

H (SOUTH QUARTER CORNER)

Date Located: _____
By: _____
Monument Description: _____
Monument Witnesses: _____
Field Book: _____ Page: _____

I (SOUTHEAST CORNER)

Date Located: 3/13/19
By: SEM MOYER
Monument Description: 5/8" REBAR
Monument Witnesses: SEE Pg 175 "C"
Field Book: 16 Page: 55

ADDITIONAL NOTES



ADDITIONAL NOTES

Jefferson
14-34-5

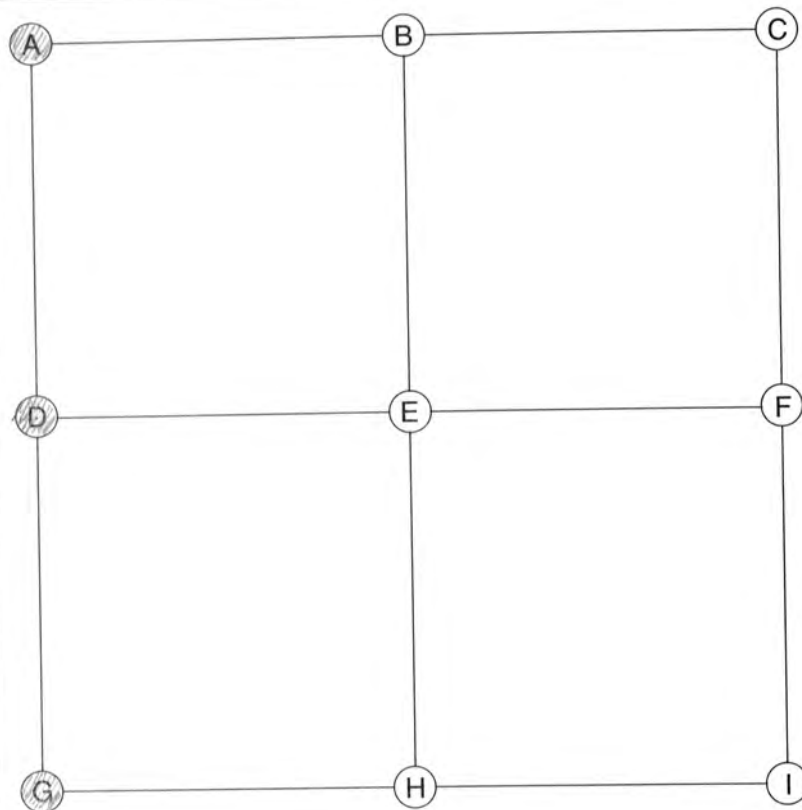

A (NORTHWEST CORNER)

Date Located: 2/1/17
By: SEM
Monument Description: FO 1/2" BOLT 3" DEEP
Monument Witnesses: SEE Pg 177 "O"

Field Book: 5 Page: 64

B (NORTH QUARTER CORNER)

Date Located: _____
By: _____
Monument Description: _____
Monument Witnesses: _____

Field Book: _____ Page: _____

C (NORTHEAST CORNER)

Date Located: _____
By: _____
Monument Description: _____
Monument Witnesses: _____

Field Book: _____ Page: _____

D (WEST QUARTER CORNER)

Date Located: 2/2/17
By: SEM
Monument Description: FO MAG NAIL FLUSH
Monument Witnesses: SEE Pg 177 "F"

Field Book: 5 Page: 65

E (CENTER OF SECTION)

Date Located: _____
By: _____
Monument Description: _____
Monument Witnesses: _____

Field Book: _____ Page: _____

F (EAST QUARTER CORNER)

Date Located: _____
By: _____
Monument Description: _____
Monument Witnesses: _____

Field Book: _____ Page: _____

G (SOUTHWEST CORNER)

Date Located: 2/13/17
By: SEM
Monument Description: FO PK NAIL FLUSH
Monument Witnesses: SEE Pg 177 "I"

Field Book: 5 Page: 76

H (SOUTH QUARTER CORNER)

Date Located: _____
By: _____
Monument Description: _____
Monument Witnesses: _____

Field Book: _____ Page: _____

I (SOUTHEAST CORNER)

Date Located: _____
By: _____
Monument Description: _____
Monument Witnesses: _____

Field Book: _____ Page: _____

ADDITIONAL NOTES

Jefferson
15-34-5

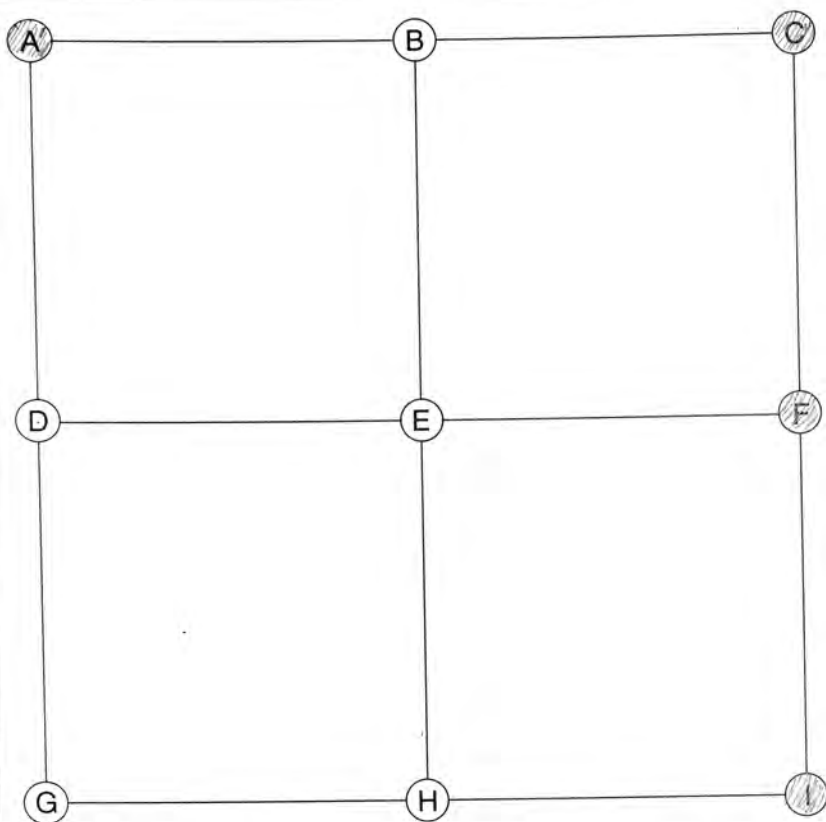

A (NORTHWEST CORNER)

Date Located: 4/18/17
By: DEM
Monument Description: FO 5/8" REBAR
Monument Witnesses: SEE Pg 17/ "I"

Field Book: 6 Page: 63

B (NORTH QUARTER CORNER)

Date Located: _____
By: _____
Monument Description: _____
Monument Witnesses: _____

Field Book: _____ Page: _____

C (NORTHEAST CORNER)

Date Located: 2/1/17
By: DEM
Monument Description: FO 1/2" BOLT 3" DEEP
Monument Witnesses: 1/2" REBAR W/CAP NW 45.09'
& RR RAIL FCP E 16.19'
NAIL IN TAG IN POWER POLE E 16.06'

Field Book: 5 Page: 64

D (WEST QUARTER CORNER)

Date Located: _____
By: _____
Monument Description: _____
Monument Witnesses: _____

Field Book: _____ Page: _____

E (CENTER OF SECTION)

Date Located: _____
By: _____
Monument Description: _____
Monument Witnesses: _____

Field Book: _____ Page: _____

F (EAST QUARTER CORNER)

Date Located: 2/2/17
By: DEM
Monument Description: FO MAG NAIL FLUSH
Monument Witnesses: NAIL IN TAG P. POLE NW 48.16'
& RE RAIL FCP NW 39.40'
1/2" REBAR W/CAP NE 51.65'
1/2" REBAR W/CAP SW 34.17'

Field Book: 5 Page: 65

G (SOUTHWEST CORNER)

Date Located: _____
By: _____
Monument Description: _____
Monument Witnesses: _____

Field Book: _____ Page: _____

H (SOUTH QUARTER CORNER)

Date Located: _____
By: _____
Monument Description: _____
Monument Witnesses: _____

Field Book: _____ Page: _____

I (SOUTHEAST CORNER)

Date Located: 2/13/17
By: DEM
Monument Description: FO PK NAIL FLUSH
Monument Witnesses: 1/2" REBAR W/CAP NW 44.45'
1/2" REBAR W/CAP NE 46.87'
NAIL IN TAG IN RAIL POLE SE 55.00'
NAIL IN TAG IN RAIL POLE SW 42.30'

Field Book: 5 Page: 76

ADDITIONAL NOTES



ADDITIONAL NOTES

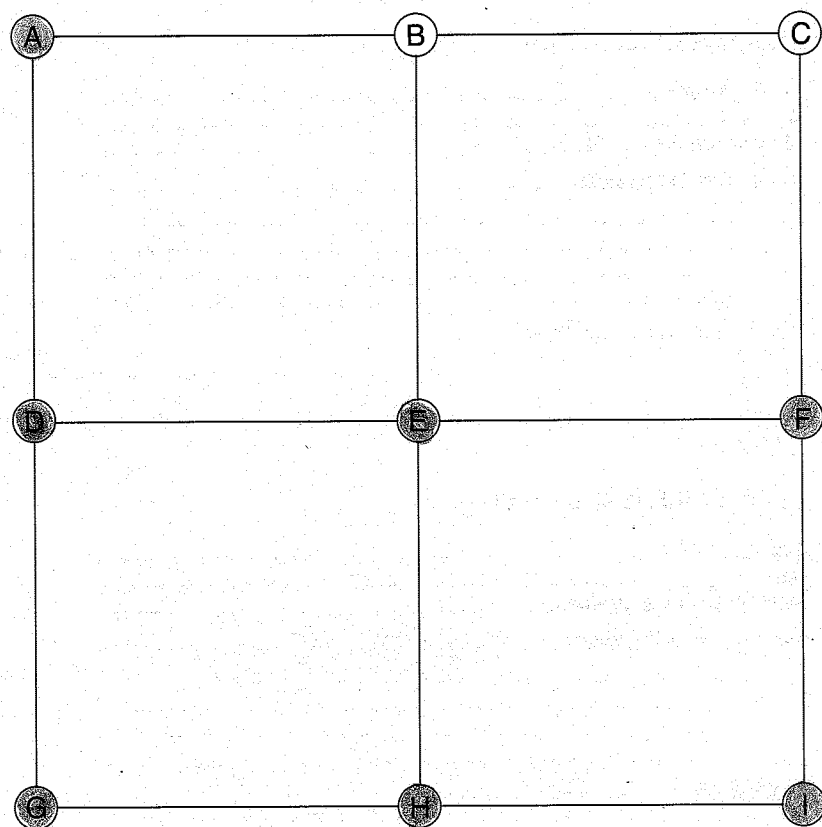

Date Located: 7/28/92
By: JR MOYER - EC HAINES
Monument Description: BR SPIKE
Monument Witnesses: SET 1/2" x 3/4" REBAR WICAP NW 25.87
SET 3/4" IRON PIPE WICAP SW 23.25

Field Book: 2 Page: 28 UPDATED 3/19/19 JRM

Date Located: _____
By: _____
Monument Description: _____
Monument Witnesses: _____

Field Book: _____ Page: _____

Date Located: _____
By: _____
Monument Description: _____
Monument Witnesses: _____

Field Book: _____ Page: _____

Date Located: 7/28/92
By: JR MOYER - EC HAINES
Monument Description: PK NAIL
Monument Witnesses: _____
FO NAIL IN BOTTLE CAP IN NE FACE OF NIPSCO PP #49-105
" " " " " N. " " " " " ESE 60.108
SET NAIL IN BOTTLE CAP IN E. OF G*30 WOOD FCP 5 30-25
1/2" REBAR W/ CAP NW 34.60

Field Book: 2 Page: 27 UPDATED 3/19/19 SRM

Date Located: 7/28/92
By: JR MOYER - EC HAINES
Monument Description: Pk Nail
Monument Witnesses: _____
CENTER OF 3 CUT MARKS FO IN SW. EDGE OF RR RAIL FPN 20.50
ED 2D SPIKE NAIL IN SW FACE OF MID SCO PP SSE 68.18
" " " " "NW " " " WSW 40.38

Field Book: 2 Page: 27 UPDATED 3/19/19 SEM

Date Located: 7/28/92
By: JR MOYER & EC HAINES
Monument Description: 3/4" IRON BAR
Monument Witnesses:
FD " + " CUT IN SQ CONC. FCP, SOUTH FACE 31.83' NW
FD " + " CUT IN NORTH FACE OF RR RAIL FCP 20.03' E
FD 20D SPIKE NAIL IN SW FACE ADJACENT POLE 68.90' SE
FD " " " " " " " " " " " " 68.90' 900 51.62' WSW
FD " + " CUT IN NORTH FACE OF A RR RAIL FCP 26.77' SW

Field Book: 2 Page: 26 UPDATED 3/19/19 JEM

Date Located: _____
By: _____
Monument Description: _____
Monument Witnesses: *SEE PAGE 181 "C"*
NE 19-34-5

Field Book: _____ Page: _____

Date Located: 3/19/19
By: SRM
Monument Description: RR SPIKE
Monument Witnesses: NAIL W B. CAP P. POLE SW ZG. 82
1/2" REBAR W/ CAP NW 37.52'

Field Book: 2 Page: 25

Date Located: 3/19/19
By: STEM
Monument Description: RR SPIKE
Monument Witnesses: NAIL IN B. CAP P POLE ESE 56.25'
NAIL IN B. CAP POWER POLE NNW 63.19'

Field Book: 2 Page: 26

ADDITIONAL NOTES

Je f ferson
18-34-5

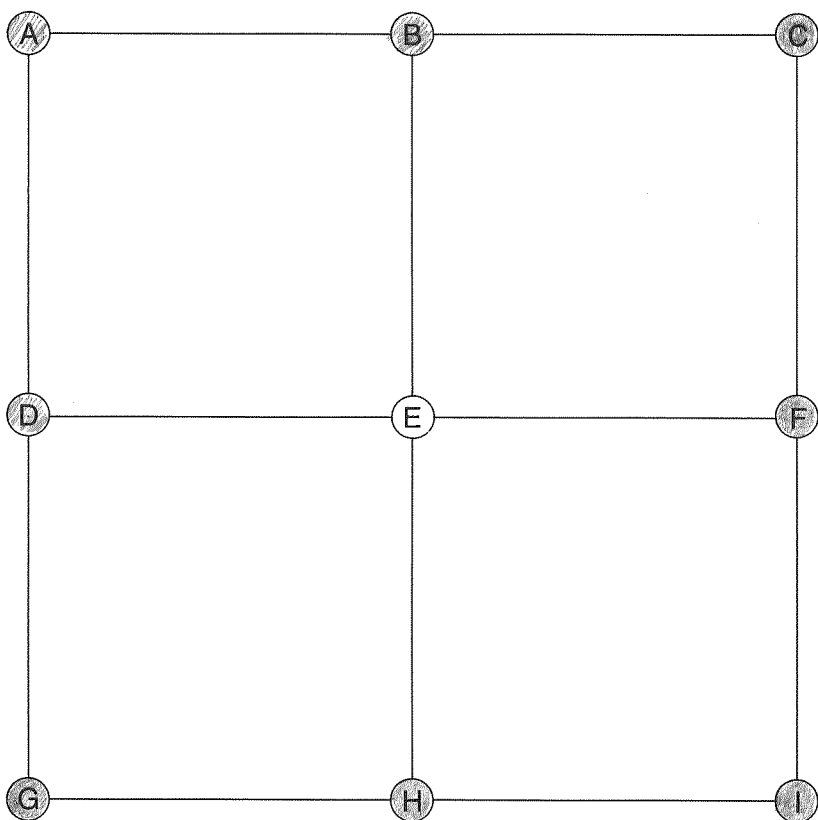

E (CENTER OF SECTION)

Date Located: _____
By: _____
Monument Description: _____
Monument Witnesses: _____

Field Book: _____ Page: _____

F (EAST QUARTER CORNER)

Date Located: _____
By: _____
Monument Description: _____
Monument Witnesses: SEE PAGE 179 "D"
W/4 POST 17-34-5

Field Book: _____ Page: _____

A (NORTHWEST CORNER)

Date Located: 10/9/18
By: SEM
Monument Description: MAG NAIL
Monument Witnesses: SEE Pg 319 "I"

Field Book: 21 Page: 50

G (SOUTHWEST CORNER)

Date Located: _____
By: _____
Monument Description: _____
Monument Witnesses: SEE PAGE 181 "A"
NE 19-34-5

Field Book: _____ Page: _____

B (NORTH QUARTER CORNER)

Date Located: 5/12/21
By: SRM MWH
Monument Description: 3/4" IRON PIN
Monument Witnesses: 1 RAIL FCP

Field Book: 20 Page: 14

H (SOUTH QUARTER CORNER)

Date Located: _____
By: _____
Monument Description: _____
Monument Witnesses: SEE PAGE 181 "B"
N/4 Post 19-34-5

Field Book: _____ Page: _____

C (NORTHEAST CORNER)

Date Located: _____
By: _____
Monument Description: _____
Monument Witnesses: SEE PAGE 179 "N"
NW 17-34-5

Field Book: _____ Page: _____

I (SOUTHEAST CORNER)

Date Located: _____
By: _____
Monument Description: _____
Monument Witnesses: SEE PAGE 181 "C"
NE 19-34-5

Field Book: _____ Page: _____

D (WEST QUARTER CORNER)

Date Located: 3/25/19
By: JRM
Monument Description: MAG NAIL w/CO TAG
Monument Witnesses: NAIL IN B CAP NIPSCO POLE NE 53.34'
1/2" REBAR w/CAP SE 34.90'

Field Book: 12 Page: 63

ADDITIONAL NOTES

ADDITIONAL NOTES