

Date Located: 1/22/18
By: SEM
Monument Description: 3" DIA CONC-FILLED STEEL FCP
Monument Witnesses: _____

Date Located: 1/22/18
By: DEM
Monument Description: STONE IN CONCRETE BASE RR RAIL FCP
Monument Witnesses: _____

Date Located: 6/19/18
By: DEM
Monument Description: MAG NAIL
Monument Witnesses: NAIL IN B. CAP REMOVED POLE NW 27.48
1/2" REBAR W/CAP W 73.21

Date Located: 6/18/92
By: JA MOYER - EC HAINES
Monument Description: BOLT w/CAP
Monument Witnesses: FACE OF A BAIL FCP N 19.70
SET 1/2" REBAR w/CAP 12" DEEP N/E 43.86
CENTER OF A BAIL FCP/ANING WEST S 19.4

Date Located: 1/22/18
By: SEM
Monument Description: MAG NAIL w/ CO TAG
Monument Witnesses: SOUTH FACE 12" CONC FCP N 19.95°
1/2" REBAR w/CAP NE 27.60°
NAIL IN B. CAP POWER POLE SE 52.32°

Date Located: 1/22/18
By: SEM
Monument Description: RR SPIKE
Monument Witnesses: 1/2" REBAR W/CAP NW Z4 68'
NAIL IN B. CAP IN POWER POLE NE 68.75'
& RR RAIL FCP S 20.50'

Date Located: 8/29/89 UPDATED 10/12/17 JEM
By: JRM/over
Monument Description: PK NAIL OVER 3/4" I.P. BURIED 0.2'
Monument Witnesses: SET NAIL IN BOTTLE CAP IN E. FACE
OF TELEPHONE POLE ENE SB. 20
- S. FACE OF 12"x8" CONC. F.C.P. @ BASE
N 19.65
- SET 1/2"x30" REBAR W/LAP NW Z7.33'
Field Book: 1 Page: 12 10/12/17 REPLACED PK
WITH DB SPIKE

Field Book: 1 Page: 12 10/19/17 REPLACED PK
WITH RZ SPIKE

Date Located: 10/24/17
By: SEM
Monument Description: FD 3" DIA CONC FILLED STEEL FCP
Monument Witnesses:

Date Located: _____
By: _____
Monument Description: _____
Monument Witnesses: _____

Field Book: _____ Page: _____

ADDITIONAL NOTES

Harrison
4-32-5

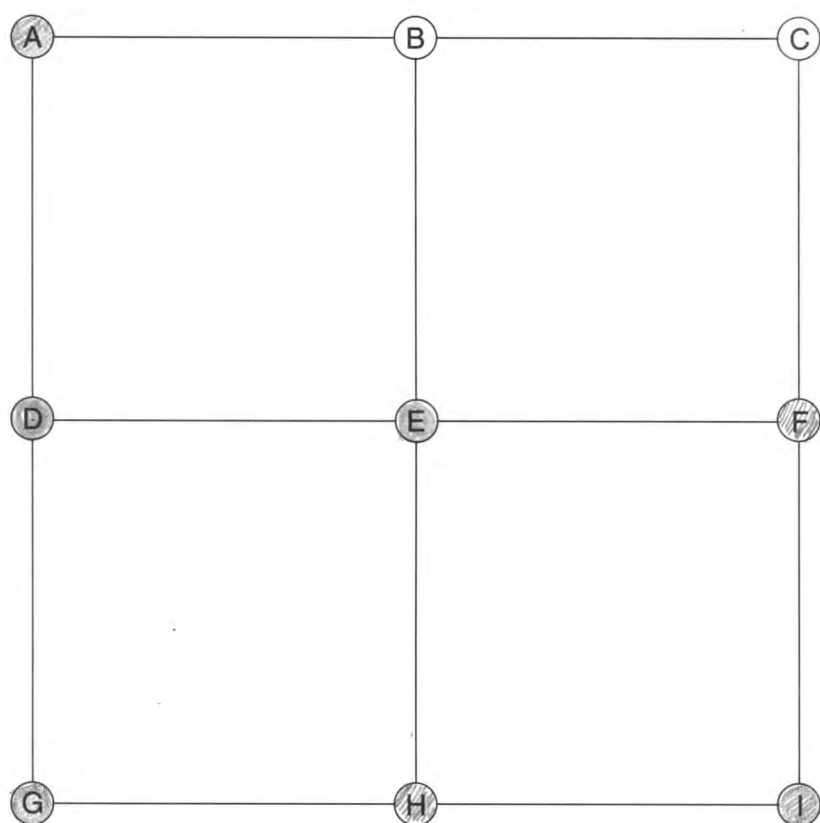

E (CENTER OF SECTION)

Date Located: 12/19/91
 By: JR MOYER
 Monument Description: REBAR w/CAP
 Monument Witnesses: 4 RR RAIL FCP S 88.4'

Field Book: 1 Page: 38 UPDATED 12/6/17

F (EAST QUARTER CORNER)

Date Located: 10/24/17
 By: SEM
 Monument Description: 3" DIA CONC FILLED STEEL FCP
 Monument Witnesses: _____

Field Book: 8 Page: 17

A (NORTHWEST CORNER)

Date Located: _____
 By: _____
 Monument Description: _____
 Monument Witnesses: SEE PG. 106 "C"
NE 5-32-5

Field Book: _____ Page: _____

G (SOUTHWEST CORNER)

Date Located: _____
 By: _____
 Monument Description: _____
 Monument Witnesses: SEE PG. 106 "I"
SE 5-32-5

Field Book: _____ Page: _____

B (NORTH QUARTER CORNER)

Date Located: _____
 By: _____
 Monument Description: _____
 Monument Witnesses: _____

Field Book: _____ Page: _____

H (SOUTH QUARTER CORNER)

Date Located: 1/22/18
 By: SEM
 Monument Description: FO 1/2" CARRIAGE BOLT
 Monument Witnesses: 1/2" REBAR w/CAP NW 31.48'
4 RR RAIL FCP N 20.1'
NAIL IN B. CAP POWER POLE NNE 21.18'
NAIL IN B. CAP POWER POLE ESE 28.40'

Field Book: _____ Page: _____

C (NORTHEAST CORNER)

Date Located: _____
 By: _____
 Monument Description: _____
 Monument Witnesses: _____

Field Book: _____ Page: _____

I (SOUTHEAST CORNER)

Date Located: _____
 By: _____
 Monument Description: _____
 Monument Witnesses: SEE PG. 104 "G"
SW 3-32-5

Field Book: _____ Page: _____

D (WEST QUARTER CORNER)

Date Located: 12/19/91
 By: JR MOYER
 Monument Description: WELL POINT
 Monument Witnesses: _____

Field Book: 1 Page: 38

ADDITIONAL NOTES

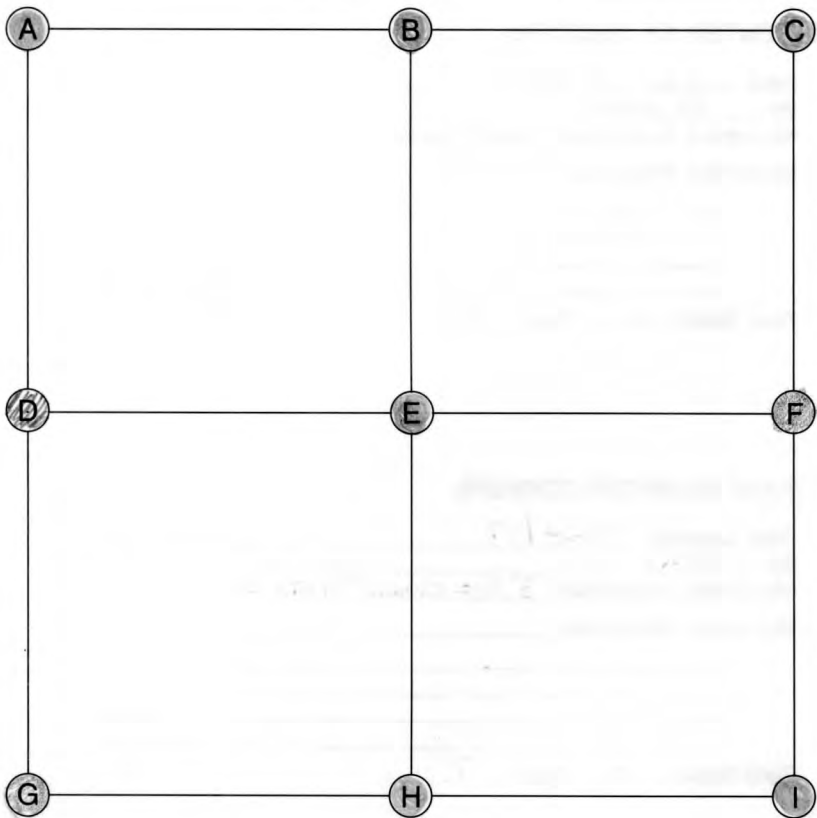

E (CENTER OF SECTION)
Date Located: 12/19/91
By: JR MOYER
Monument Description: R.R. SPIKE
Monument Witnesses: SET 3"x3" CONC. MON. W/WITNESS OF NE 41.70
WEST FACE OF RR RAIL FCP E 20.35
EAST FACE OF RR RAIL FCP W 20.40
SET "+" CUT IN SOUTH FACE OF RR RAIL NW 25.60
Field Book: 1 Page: 37 UPDATED 12/6/17 JRM

F (EAST QUARTER CORNER)
Date Located:
By:
Monument Description:
Monument Witnesses: SEE PG 105 "D"
W 1/4 POST 4-32-5
Field Book: Page:

G (SOUTHWEST CORNER)
Date Located:
By:
Monument Description:
Monument Witnesses: SEE PG. 107 "I"
SE 6-32-5
Field Book: Page:

H (SOUTH QUARTER CORNER)
Date Located: 12/19/91
By: JR MOYER
Monument Description: 1/2" x 30" REBAR W/CAP
Monument Witnesses: SET 3"x3" CONC. MON. W/WITNESS CAP NW 25.32
" " " " " " " " NE 25.52
SET NAIL IN BOTTLECAP IN SE FACE OF POULCE POLE SW 52.85
FD PK NAIL FOR BRIDGE WORK N 10.5
SOUTH END OF BRIDGE APPROACH N 86.55
Field Book: 1 Page: 36 UPDATED 10/13/16

I (SOUTHEAST CORNER)
Date Located: 12/11/91
By: JR MOYER
Monument Description: IRON PIPE W/CAP
Monument Witnesses: N FACE OF A 8" sq. CONC FCP S 19.85
SET NAIL IN BOTTLECAP IN SE FACE OF PHONE POLE NNE 64.90
" " " " " " SW " POWER POLE ESE 45.90
" " " " " " NE " " " " NNW 35.00
Field Book: 1 Page: 36

ADDITIONAL NOTES

A (NORTHWEST CORNER)
Date Located: 7/18/90
By: JR MOYER/BD LADSON
Monument Description: 1/2" x 30" REBAR WITH CAP
Monument Witnesses: NAIL W/CAP NE FACE PP 0198 ESE 33.00'
PK ON SECTION N 33.00'
NAIL W/CAP E FACE PP 0200 S 17.00'
EDGE PAVEMENT N 11.80'
Field Book: 1 Page: 18
1 19

B (NORTH QUARTER CORNER)
Date Located: 6/5/92
By: JR MOYER-EC HAINES
Monument Description: REBAR W/CAP
Monument Witnesses: NAIL IN B. CAP REMC POLE SSW 80.96'
1/2" REBAR W/CAP NW 67.45'
1/2" REBAR W/CAP SW 46.65'
Field Book: 1 Page: 48 UPDATED 12/6/17

C (NORTHEAST CORNER)
Date Located: 3/24/92
By: JR MOYER-EC HAINES
Monument Description: 1/2" x 30" REBAR
Monument Witnesses: E OF POLE RUN W 210
6" SQ RAIL TIE WOOD FCP W 185
Field Book: 1 Page: 44

D (WEST QUARTER CORNER)
Date Located: 4/25/17
By: JRM
Monument Description: FD PK NAIL 3" DEEP
Monument Witnesses: NAIL IN B. CAP REMC POLE NNE 78.18
1/2" REBAR W/CAP NE 26.98'
E RR RAIL FCP E 20.3'
1/2" REBAR W/CAP SE 33.72'
Field Book: 6 Page: 66

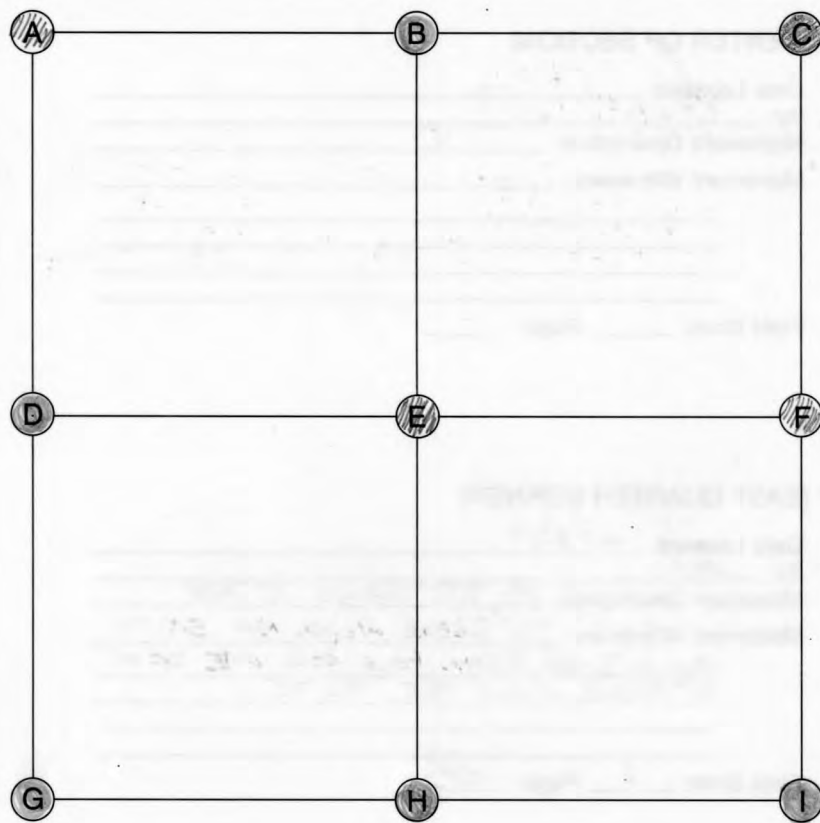

E (CENTER OF SECTION)

Date Located: 6/12/18
 By: SRM
 Monument Description: RR SPIKE
 Monument Witnesses: 1/2" REBAR W/WALKER CAP W 20.0'
NAIL IN B. CAP POWER POLE NNW 93.86'

Field Book: 9 Page: 76

F (EAST QUARTER CORNER)

Date Located: 4/25/17
 By: SRM
 Monument Description: FO PK NAIL 3" DEEP
 Monument Witnesses: SEE Pg 106 "D"

Field Book: 6 Page: 66

A (NORTHWEST CORNER)

Date Located: 4/17/17
 By: SRM
 Monument Description: RR SPIKE 4" MAG NAIL W/ CO TAG OVER
 Monument Witnesses: 4" STEEL POST NW 29.7'
NAIL IN B. CAP IN POWER POLE NW 30.00'
NW CORNER CONC FCP SE 28.9'
1/2" REBAR W/CAP SW 38.88'

Field Book: 6 Page: 62

G (SOUTHWEST CORNER)

Date Located: 8/28/92
 By: JR MOYER - ECHAINES
 Monument Description: REBAR W/CAP
 Monument Witnesses: SW CORNER OF A RR RAIL FCP NNE 60.55
SET NAIL IN BOTTLE CAP IN NW FACE OF APP SSW 118.78'
1/2" REBAR W/CAP AT BASE OF RR TIE FCP NE 63.27'
FO NAIL IN B. CAP IN 35" OAK, HEAD HIGH SE 62.08

Field Book: 2 Page: 67 UPDATED 10/13/16

B (NORTH QUARTER CORNER)

Date Located: 7/23/90
 By: JR MOYER / RD LADSON
 Monument Description: 1/2" X 3/4" RE-BAR W/CAP
 Monument Witnesses: NAIL W/CAP NW FACE DP NE 27.90'
S/A CORNER 3133.5 W 102.72'
NAIL W/CAP NW FACE TEL POLE SSW 88.70'
CMP UNDER RD SURFACE S 15'

Field Book: 1 Page: 19 UPDATED 4/17/17

H (SOUTH QUARTER CORNER)

Date Located: 8/28/92
 By: JR MOYER - ECHAINES
 Monument Description: CENTER OF A RR RAIL FCP S 20.03
SET NAIL IN BOTTLE W/W FACE OF A PP SSW 19.85
(MONUMENT DESCRIPTION NOT POSTED IN FIELD BOOK)

Field Book: 2 Page: 66 UPDATED 6/12/18 SRM

C (NORTHEAST CORNER)

Date Located: _____
 By: _____
 Monument Description: _____
 Monument Witnesses: SEE Pg 106 "A"
NW 5-32-5

Field Book: _____ Page: _____

I (SOUTHEAST CORNER)

Date Located: 8/28/92
 By: JR MOYER - ECHAINES
 Monument Description: PK NAIL OVER BRONZE MARKER
 Monument Witnesses: SET NAIL IN BOTTLE CAP IN NW FACE OF PP NNE 97.83'
" " " " " S " " " " ENE 69.72'

Field Book: 2 Page: 66 UPDATED 10/13/16

D (WEST QUARTER CORNER)

Date Located: 8/28/92
 By: JR MOYER - ECHAINES
 Monument Description: RR SPIKE
 Monument Witnesses: CENTER OF A RR RAIL FCP E 80.03
SE CORNER OF A 12" SQ CONC. FCP WNW 19.64

Field Book: 2 Page: 67 UPDATED 6/12/18 SRM

ADDITIONAL NOTES

Harrison

7-32-5

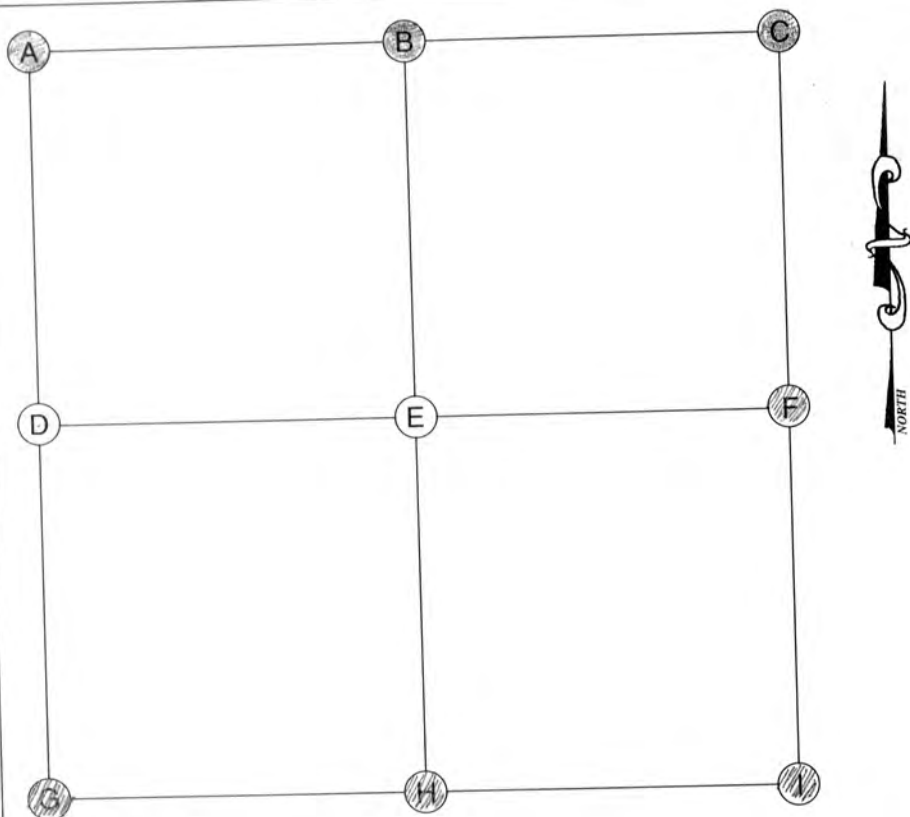

A (NORTHWEST CORNER)

Date Located: _____
 By: _____
 Monument Description: _____
 Monument Witnesses: SEE PG. 107 "G"
SW 6-32-5

Field Book: _____ Page: _____

B (NORTH QUARTER CORNER)

Date Located: _____
 By: _____
 Monument Description: _____
 Monument Witnesses: SEE PG. 107 "H"
5/4 POST 6-32-5

Field Book: _____ Page: _____

C (NORTHEAST CORNER)

Date Located: _____
 By: _____
 Monument Description: _____
 Monument Witnesses: SEE PG. 107 "I"
SECOR 6-32-5

Field Book: _____ Page: _____

D (WEST QUARTER CORNER)

Date Located: _____
 By: _____
 Monument Description: _____
 Monument Witnesses: _____

Field Book: _____ Page: _____

E (CENTER OF SECTION)

Date Located: _____
 By: _____
 Monument Description: _____
 Monument Witnesses: _____

Field Book: _____ Page: _____

F (EAST QUARTER CORNER)

Date Located: 4/18/17
 By: SEM
 Monument Description: FO RR SPIKE 3" DEEP
 Monument Witnesses: 1/2" REBAR w/CAP NW 54.75'
NAIL IN B. CAP REMC POLE 6240 ENE 20.02'
1/2" REBAR w/CAP SE 20.72'

Field Book: 6 Page: 65

G (SOUTHWEST CORNER)

Date Located: 8/3/16
 By: SEM
 Monument Description: FO STONE
 Monument Witnesses: NAIL IN B. CAP IN PP SW 29.97'
RR RAIL FCP WSW 18.44'
1/2" REBAR WITH CAP NW 18.42'
NAIL IN B. CAP IN PP N 40.11'

Field Book: 4 Page: 46

H (SOUTH QUARTER CORNER)

Date Located: 8/3/16
 By: SEM
 Monument Description: FO 1/4" IRON PIPE 12" DEEP
 Monument Witnesses: NAIL IN PP SW 22.26'
CRYSTAL LAKE RD S 46.5'
4" ANGLE IRON FCP S 73.42'

Field Book: 4 Page: 49

I (SOUTHEAST CORNER)

Date Located: 8/2/16
 By: SEM
 Monument Description: FO MAG NAIL IN CO. SURVEYOR WASHER
 Monument Witnesses: SEE PG 109 "G"

Field Book: 4 Page: 43

ADDITIONAL NOTES

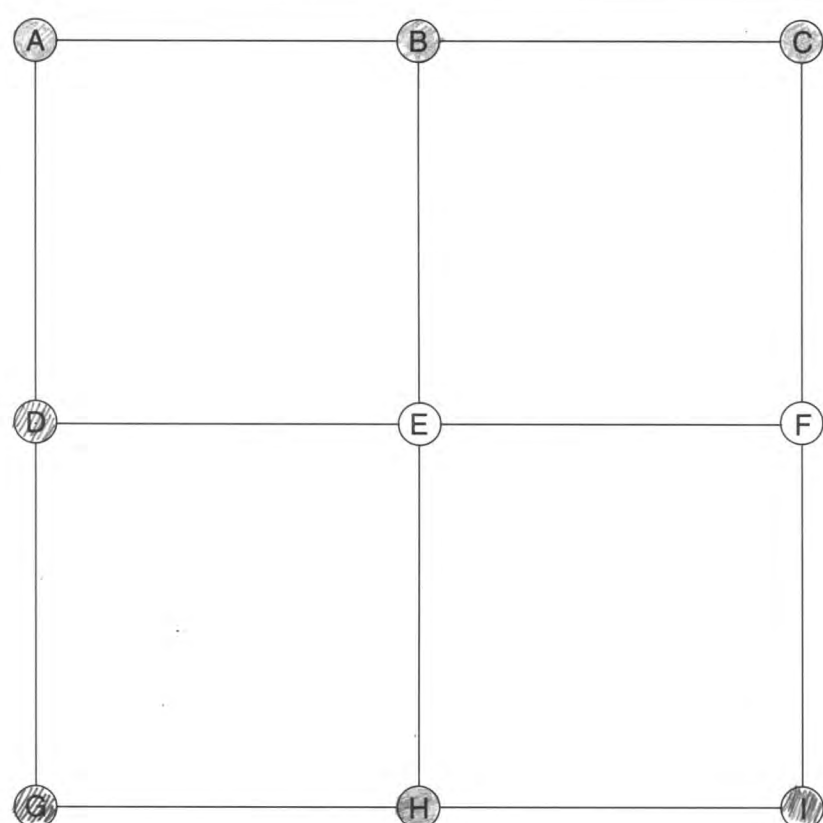

A (NORTHWEST CORNER)

Date Located: _____
 By: _____
 Monument Description: _____
 Monument Witnesses: SEE PG. 107 "I"
SE 6-32-5

Field Book: _____ Page: _____

B (NORTH QUARTER CORNER)

Date Located: _____
 By: _____
 Monument Description: _____
 Monument Witnesses: SEE PG. 106 "H"
5/4 POST 5-32-5

Field Book: _____ Page: _____

C (NORTHEAST CORNER)

Date Located: UPDATED 1/22/18
 By: SRM
 Monument Description: FO 3/4" PIPE SET MAG NAIL INSIDE
 Monument Witnesses: NAIL IN B. CAP P. POLE NW 35.54'
NAIL IN B. CAP POWER POLE ESE 47.11'
NAIL IN B. CAP POWER POLE S 47.96'

Field Book: 1 Page: 36

D (WEST QUARTER CORNER)

Date Located: 4/18/17
 By: SRM
 Monument Description: FO RR SPIKE 3" DEEP
 Monument Witnesses: SEE PG 108 "F"

Field Book: 6 Page: 65

E (CENTER OF SECTION)

Date Located: _____
 By: _____
 Monument Description: _____
 Monument Witnesses: _____

Field Book: _____ Page: _____

F (EAST QUARTER CORNER)

Date Located: _____
 By: _____
 Monument Description: _____
 Monument Witnesses: _____

Field Book: _____ Page: _____

G (SOUTHWEST CORNER)

Date Located: 8/2/16
 By: SRM
 Monument Description: FO MAG NAIL IN CO SURVEYOR WASHER
 Monument Witnesses: SW CORNER OF RR RAIL FCP ENE 71.79'
1/2" REBAR w/ CAP SE 44.80'
NAIL IN B. CAP IN POWER POLE S 19.10'
NW CORNER OF HSE SW 76.3'

Field Book: 4 Page: 43

H (SOUTH QUARTER CORNER)

Date Located: _____
 By: _____
 Monument Description: SEE PAGE 116 "B"
 Monument Witnesses: _____

Field Book: _____ Page: _____

I (SOUTHEAST CORNER)

Date Located: _____
 By: _____
 Monument Description: _____
 Monument Witnesses: SEE Pg 115 "A"

Field Book: 3 Page: 27

ADDITIONAL NOTES

Harrison
9-32-5

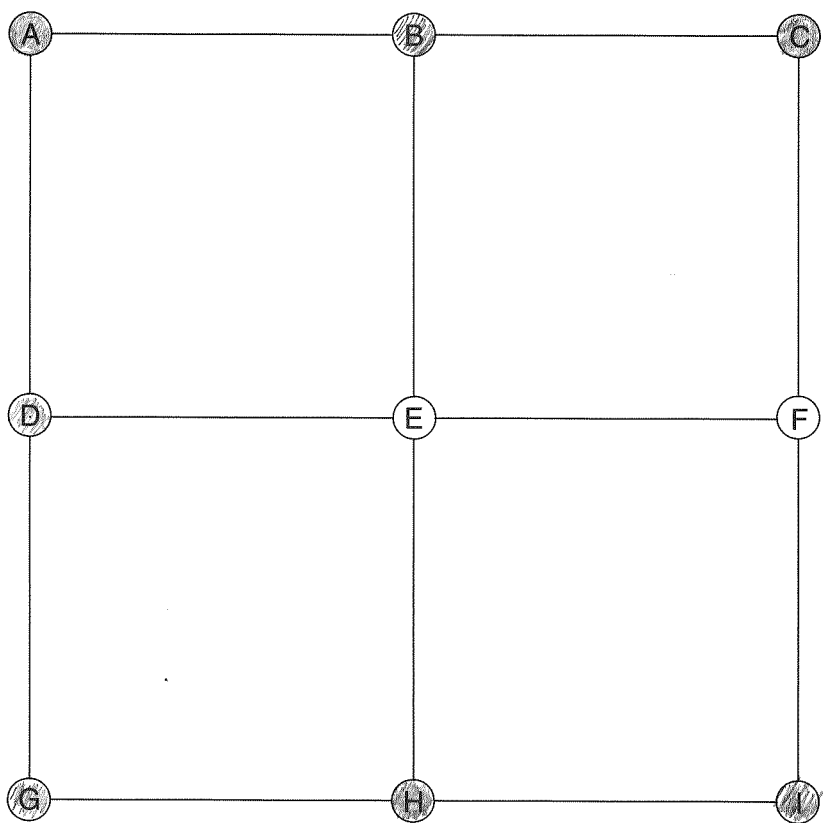

E (CENTER OF SECTION)

Date Located: _____
By: _____
Monument Description: _____
Monument Witnesses: _____

Field Book: _____ Page: _____

F (EAST QUARTER CORNER)

Date Located: _____
By: _____
Monument Description: _____
Monument Witnesses: _____

Field Book: _____ Page: _____

A (NORTHWEST CORNER)

Date Located: _____
By: _____
Monument Description: _____
Monument Witnesses: SEE PG. 106 "I"
SE 5-32-5

Field Book: _____ Page: _____

G (SOUTHWEST CORNER)

Date Located: _____
By: _____
Monument Description: _____
Monument Witnesses: SEE PG 115 "A"

Field Book: 3 Page: 27

B (NORTH QUARTER CORNER)

Date Located: 1/22/18
By: SEM
Monument Description: FD 1/2" CARRIAGE BOLT
Monument Witnesses: SEE PG 105 "H"

Field Book: 8 Page: 53

H (SOUTH QUARTER CORNER)

Date Located: _____
By: _____
Monument Description: _____
Monument Witnesses: SEE PG 115 "B"

Field Book: 3 Page: 28

C (NORTHEAST CORNER)

Date Located: _____
By: _____
Monument Description: _____
Monument Witnesses: SEE PG. 104 "G"
SW 3-32-5

Field Book: _____ Page: _____

I (SOUTHEAST CORNER)

Date Located: 11/5/15
By: _____
Monument Description: _____
Monument Witnesses: SEE PG 114 "A"

Field Book: 3 Page: 26

D (WEST QUARTER CORNER)

Date Located: 5/5/21
By: SEM MWH
Monument Description: "McCREA" CAPPED IRON
Monument Witnesses: _____

Field Book: 20 Page: 10

ADDITIONAL NOTES



F (EAST QUARTER CORNER)

G (SOUTHWEST CORNER)

H (SOUTH QUARTER CORNER)

I (SOUTHEAST CORNER)

ADDITIONAL NOTES

[illegible]

A (NORTHWEST CORNER)

Date Located: _____
By: _____
Monument Description: _____
Monument Witnesses: SEE PG. 104 "G"
SW 3-32-5

Field Book: _____ Page: _____

B (NORTH QUARTER CORNER)

Date Located: 1/22/18
By: JEM
Monument Description: RR SPIKE
Monument Witnesses: 1/2" REBAR W/CAP NW 24.68
NAIL IN B. CAP IN POWER POLE NE 68.75'
4 RR RAIL FCP S 20.5'

Field Book: 8 Page: SZ

C (NORTHEAST CORNER)

Date Located: _____
By: _____
Monument Description: _____
Monument Witnesses: _____

Field Book: _____ Page: _____

D (WEST QUARTER CORNER)

Date Located: _____
By: _____
Monument Description: _____
Monument Witnesses: _____

Field Book: _____ Page: _____

Harrison / Wayne
11-32-5

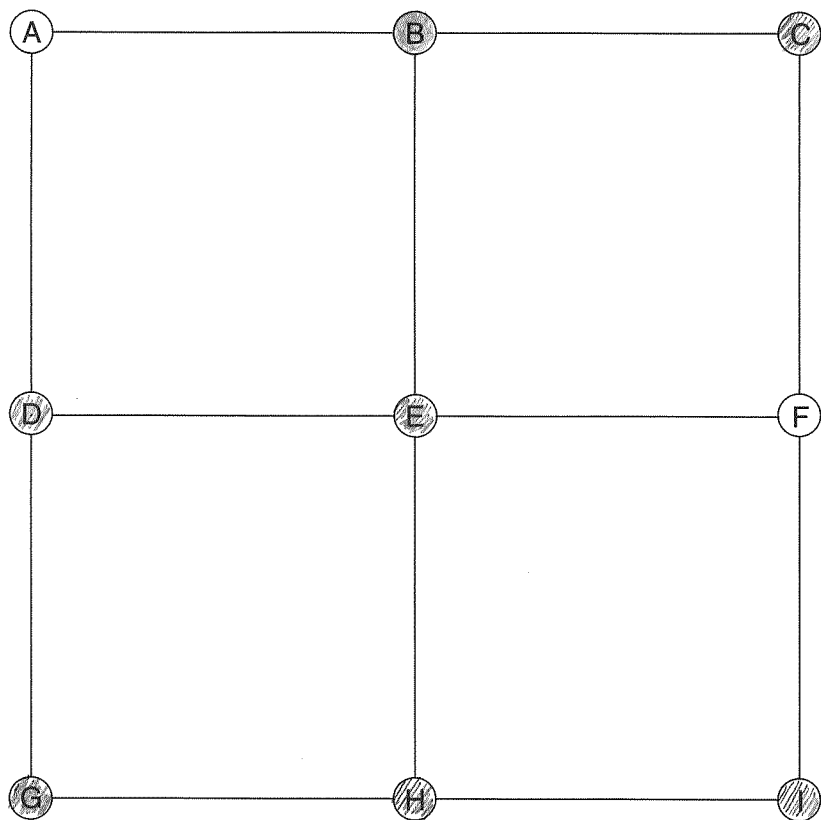

E (CENTER OF SECTION)

Date Located: 10/18/17
By: JRM
Monument Description: FD RR RAIL FCP
Monument Witnesses: 8' WOOD RR TIE POST W 13.8'

Field Book: 8 Page: 12

F (EAST QUARTER CORNER)

Date Located: _____
By: _____
Monument Description: _____
Monument Witnesses: _____

Field Book: _____ Page: _____

A (NORTHWEST CORNER)

Date Located: _____
By: _____
Monument Description: _____
Monument Witnesses: _____

Field Book: _____ Page: _____

G (SOUTHWEST CORNER)

Date Located: 11/23/15
By: _____
Monument Description: _____
Monument Witnesses: SEE Pg 114 "C"

Field Book: 3 Page: 29

B (NORTH QUARTER CORNER)

Date Located: _____
By: _____
Monument Description: _____
Monument Witnesses: SEE PNGE 103 "H"
S 1/4 POST 2-32-5

Field Book: 1 Page: 14
STATE PLANE COORDINATES PHASE I 12/2017

H (SOUTH QUARTER CORNER)

Date Located: 6/28/16
By: JRM
Monument Description: RR SPIKE IN CONC 8" DEEP
Monument Witnesses: NAIL IN B. CAP IN TEL POLE NNW 18.11
& RR RAIL FCP S 18.82'
NAIL IN B. CAP IN POWER POLE WSW 62.25'

Field Book: 4 Page: 25

C (NORTHEAST CORNER)

Date Located: 4/17/19
By: SEM MWH
Monument Description: MAG NAIL W/ CO TAG
Monument Witnesses: 1/2" REBAR W/ CAP SE 45.45'
1/2" REBAR W/ CAP SW 46.52'

Field Book: 13 Page: 24

I (SOUTHEAST CORNER)

Date Located: 6/24/16
By: SRM
Monument Description: 4" GIN SPINDLE OVER RR SPIKE
Monument Witnesses: SEE Pg 519 "A"

Field Book: 4 Page: 20

D (WEST QUARTER CORNER)

Date Located: 4/7/21
By: SEM MWH
Monument Description: RR RAIL FCP
Monument Witnesses: _____

Field Book: 19 Page: 72

ADDITIONAL NOTES

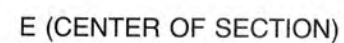

Field Book: _____ Page: _____

F (EAST QUARTER CORNER)

Field Book: _____ Page: _____

G (SOUTHWEST CORNER)

Field Book: _____ Page: _____

H (SOUTH QUARTER CORNER)

Field Book: _____ Page: _____

I (SOUTHEAST CORNER)

Field Book: 5 Page: 25

ADDITIONAL NOTES

A (NORTHWEST CORNER)

Field Book: 3 Page: 26

B (NORTH QUARTER CORNER)

Field Book: 3 Page: 25

C (NORTHEAST CORNER)

Field Book: 3 Page: 29

D (WEST QUARTER CORNER)

Field Book: _____ Page: _____

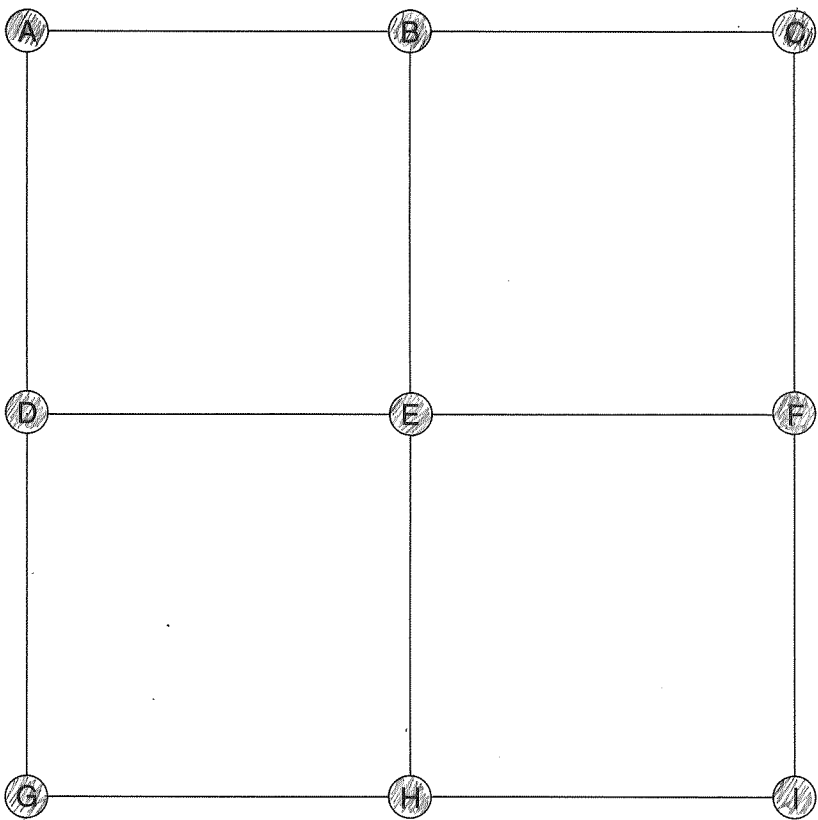

E (CENTER OF SECTION)

Date Located: 4/22/19
By: SRM
Monument Description: FO RR RAIL FCP
Monument Witnesses: _____

Field Book: 13 Page: 33

F (EAST QUARTER CORNER)

Date Located: 7/16/20
By: SRM MWH
Monument Description: SET RR SPIKE
Monument Witnesses: RR RAIL FCP WSW 17.25'
1/2" REBAR W/CAP NE 25.50'
NAIL IN B. CAP POWER POLE SE 54.13'

Field Book: 19 Page: 13

A (NORTHWEST CORNER)

Date Located: 11/10/15
By: SR MOYER
Monument Description: RR SPIKE FLUSH
Monument Witnesses: 1/2" REBAR W/CAP 61.36' WSW
1/2" REBAR W/CAP 75.30' SSW
NAIL IN BOTTLE CAP W FACE OF P POLE 60.19' SSE
NEAREST EDGE RR RAIL FCP 35.20' SE

Field Book: 3 Page: 27

G (SOUTHWEST CORNER)

Date Located: 2/28/19
By: SRM
Monument Description: MAGN NAIL W/TAG
Monument Witnesses: NAIL IN B. CAP POWER POLE NW 32.02'
NAIL IN B. CAP POWER POLE NNE 70.23'
1/2" REBAR W/CAP NE 34.94'

Field Book: 12 Page: 22

B (NORTH QUARTER CORNER)

Date Located: 11/10/15
By: SR MOYER
Monument Description: RR SPIKE 8" DEEP
Monument Witnesses: 1/2" REBAR W/CAP 57.41' SE
1/2" REBAR W/CAP 27.92' S 18.2' SOUTH OF PAV
NAIL IN BOTTLE CAP IN E FACE OF P POLE 58.73' ESE
NEAREST EDGE OF RR RAIL FCP 22.87' SSW

Field Book: 3 Page: 28

H (SOUTH QUARTER CORNER)

Date Located: 2/28/19
By: SRM
Monument Description: RR SPIKE
Monument Witnesses: NAIL IN B. CAP P. POLE SSW 70.97'
NAIL IN B. CAP POWER POLE NW 32.46'
EDGE RR RAIL FCP SE 43.35'

Field Book: 12 Page: 21

C (NORTHEAST CORNER)

Date Located: 11/5/15
By: _____
Monument Description: _____
Monument Witnesses: SEE Pg 114 "A"

Field Book: 3 Page: 26

I (SOUTHEAST CORNER)

Date Located: 2/28/19
By: SRM
Monument Description: BRONZE MONUMENT
Monument Witnesses: 1/2" REBAR W/CAP SW 30.36'
4 RR RAIL FCP S 19.45'
NAIL IN B. CAP POWER POLE ESE 67.76'

Field Book: 12 Page: 20

D (WEST QUARTER CORNER)

Date Located: 7/16/20
By: SRM MWH
Monument Description: SET RR SPIKE
Monument Witnesses: 1/2" REBAR W/CAP WSW 27.01'
1/2" REBAR W/CAP ENE 26.93'
1/2" REBAR W/CAP SE 53.23'

Field Book: 19 Page: 12

ADDITIONAL NOTES

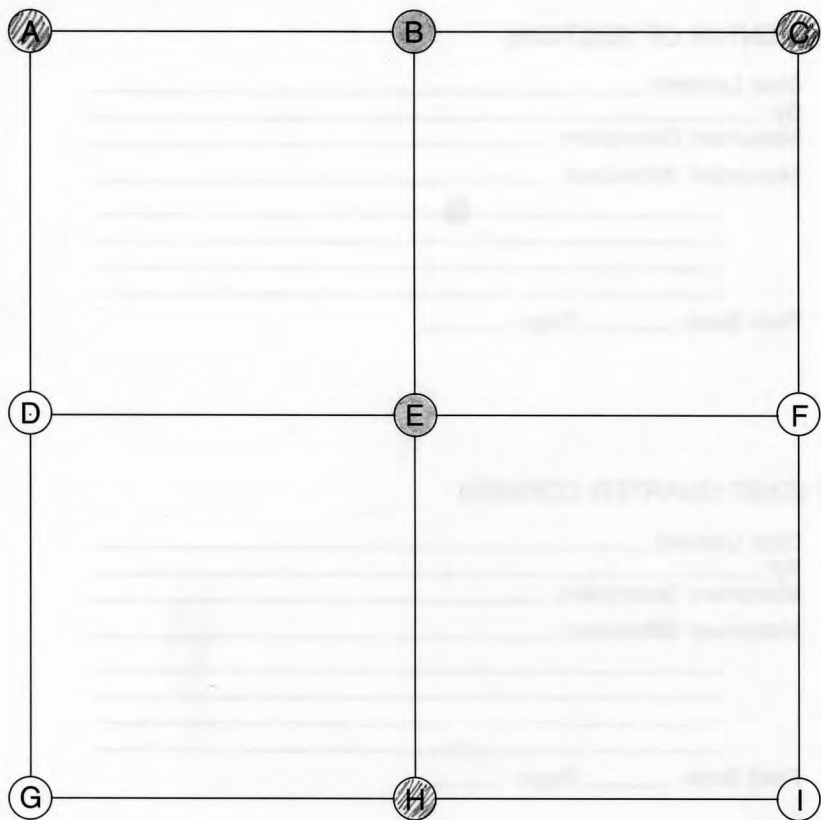

Date Located: 6/6/2002
By: MEL + ED
Monument Description: RAILROAD SPIKE (OVER RAILROAD SPIKE)
Monument Witnesses: -FACE R/P 19.63' EAST + WEST
- CAPPED 1/2" REBAR 34.94' NE
- CAPPED 1/2" " (1' EAST OF X'S WIRE FENCE)
30.81' NW
NAIL IN B.CAP REMC POLE SSW 60.60'
Field Book: 10 Page: 56 8/9/18 SRM

Field Book: 10 Page: 56 8/9/18 JRM

Date Located: _____
By: _____
Monument Description: _____
Monument Witnesses: _____

Field Book: _____ Page: _____

Date Located: 8/2/16
By: SRM
Monument Description: FO MAG NAIL IN CO SURVEYOR WASHER
Monument Witnesses: SEE P 109 "G"

Field Book: 4 Page: 43

Date Located: _____
By: _____
Monument Description: _____
Monument Witnesses: _____

Field Book: _____ Page: _____

Date Located: 6/17/2002
By: MEK + ED
Monument Description: Bronze Marker (Required PM
NAIL + RR SAIL)
Monument Witnesses:
- 1/2" CRAPPED IRON REBAR 50.35' NW
- " " " " 66.77' NE
- ROUND STEEL POST 88.61' W-NW
- NEAREST EDGE OF LEADING RIP 29.3' SE
" " " " 28.6' SW
Field Book: _____ Page: _____

Field Book: _____ Page: _____ 28.6' SW

Date Located: 8/9/18
By: SEM
Monument Description: FORR SPIKE
Monument Witnesses: NAIL IN B. CAP TEL POLE NW 53.00
NAIL IN B. CAP REMC POLE NE 45.62
NAIL IN B. CAP REMC POLE S 24.17'

Field Book: 10 Page: 57

Date Located: _____
By: _____
Monument Description: _____
Monument Witnesses: SEE Pg 115 "A"

Field Book: 3 Page: 27

Date Located: _____
By: _____
Monument Description: _____
Monument Witnesses: _____

Field Book: _____ Page: _____

Date Located: _____
By: _____
Monument Description: _____
Monument Witnesses: _____

Field Book: _____ Page: _____

ADDITIONAL NOTES

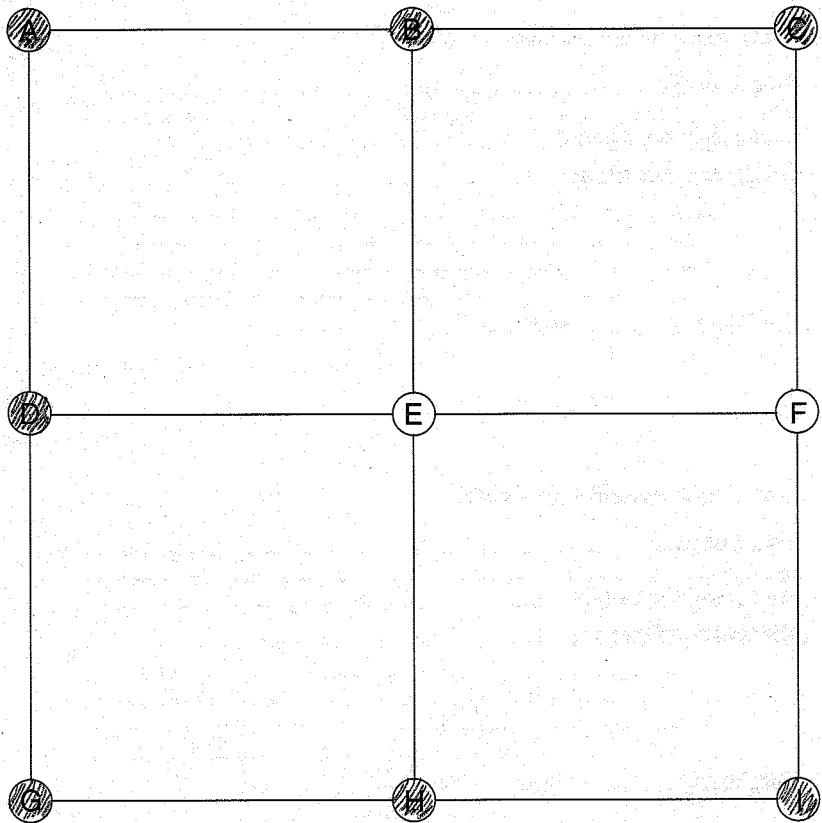

E (CENTER OF SECTION)

Date Located: _____
By: _____
Monument Description: _____
Monument Witnesses: _____

Field Book: _____ Page: _____

F (EAST QUARTER CORNER)

Date Located: _____
By: _____
Monument Description: _____
Monument Witnesses: _____

Field Book: _____ Page: _____

G (SOUTHWEST CORNER)

Date Located: 1/31/17
By: SEM
Monument Description: FOR SPIKE 5" DEEP
Monument Witnesses: SEE PG 118 "A"

Field Book: 5 Page: 62

A (NORTHWEST CORNER)

Date Located: 8/3/16
By: SEM
Monument Description: FO STONE
Monument Witnesses: SEE PG 108 "G"

Field Book: 4 Page: 46

B (NORTH QUARTER CORNER)

Date Located: 8/8/16
By: SEM
Monument Description: FO 1 1/4" IRON PIPE 12" DEEP
Monument Witnesses: NAIL IN POLE SSW 22.26'
& CRYSTAL LAKE RD S 46.5'
4" ANGLE IRON FCP S 73.42'

Field Book: 4 Page: 49

H (SOUTH QUARTER CORNER)

Date Located: 4/18/17
By: SEM
Monument Description: FO 1/2" BOLT FLUSH
Monument Witnesses: NAIL IN TAG IN POLE NE 27.53'
NAIL IN TAG IN ANCHOR POLE SE 25.80'

Field Book: 6 Page: 64

C (NORTHEAST CORNER)

Date Located: 8/2/16
By: SEM
Monument Description: FO MAG NAIL IN CO SURVEYOR WASHER
Monument Witnesses: SEE PG 109 "G"

Field Book: 4 Page: 43

I (SOUTHEAST CORNER)

Date Located: 2/28/19
By: SEM
Monument Description: MAG NAIL W/TAG
Monument Witnesses: 1/2" REBAR W/CAP NW 27.61'
NAIL IN B. CAP REMO POLE SSE 18.71'
& RR RAIL FCP S 20.35'
1/2" REBAR W/CAP SW 33.68'

Field Book: 12 Page: 23

D (WEST QUARTER CORNER)

Date Located: 5/10/18
By: SEM
Monument Description: FO PK NAIL FLUSH
Monument Witnesses: & 2" DIA STEEL FCP E 19.65'
FO MAG NAIL 2" DEEP N 32.83'

Field Book: 9 Page: 61

ADDITIONAL NOTES

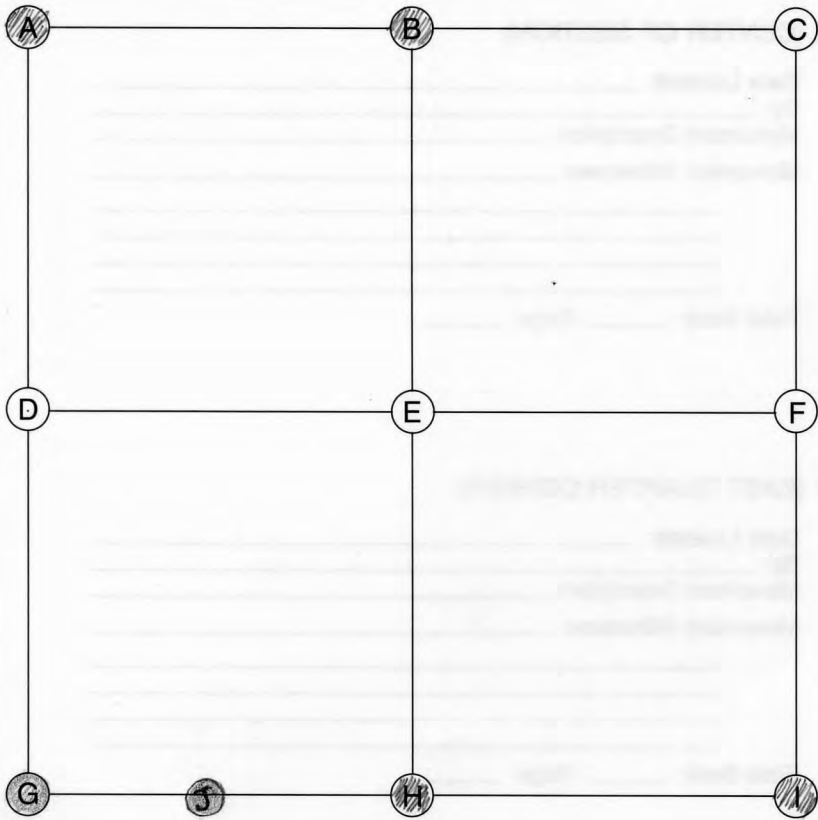

A (NORTHWEST CORNER)

Date Located: 1/31/17
By: SEM
Monument Description: FD RR SPIKE 5" DEEP
Monument Witnesses: 1/2" REBAR W/CAP NE 57.52'
MAG NAIL W/KOS CO TAG N 39.47
FACE OF 2" DIA FCP SE 26.71'
NAIL IN TAG IN POWER POLE SSE 40.92'

Field Book: 5 Page: 62

B (NORTH QUARTER CORNER)

Date Located: 4/18/17
By: SEM
Monument Description: FD 1/2" BOLT FLUSH
Monument Witnesses: SEE Pg 117 "H"

Field Book: 6 Page: 64

C (NORTHEAST CORNER)

Date Located: _____
By: _____
Monument Description: _____
Monument Witnesses: _____

Field Book: _____ Page: _____

D (WEST QUARTER CORNER)

Date Located: _____
By: _____
Monument Description: _____
Monument Witnesses: _____

Field Book: _____ Page: _____

E (CENTER OF SECTION)

Date Located: _____
By: _____
Monument Description: _____
Monument Witnesses: _____

Field Book: _____ Page: _____

F (EAST QUARTER CORNER)

Date Located: _____
By: _____
Monument Description: _____
Monument Witnesses: _____

Field Book: _____ Page: _____

G (SOUTHWEST CORNER)

Date Located: _____
By: _____
Monument Description: _____
Monument Witnesses: SEE PG. 127 "A"
NW 30-32-5

Field Book: _____ Page: _____

H (SOUTH QUARTER CORNER)

Date Located: 8/13/18
By: SEM
Monument Description: FD RR SPIKE 4" DEEP
Monument Witnesses: 4 RR RAIL FCP S 20.3'
NAIL IN B. CAP POWER POLE ESE 76.36'

Field Book: 10 Page: 61

I (SOUTHEAST CORNER)

Date Located: 5/3/17
By: SEM
Monument Description: RESET MAG NAIL IN CO TAG
Monument Witnesses: SEE Pg 126 "A"

Field Book: 6 Page: 76

ADDITIONAL NOTES

J. SEE PG. 127

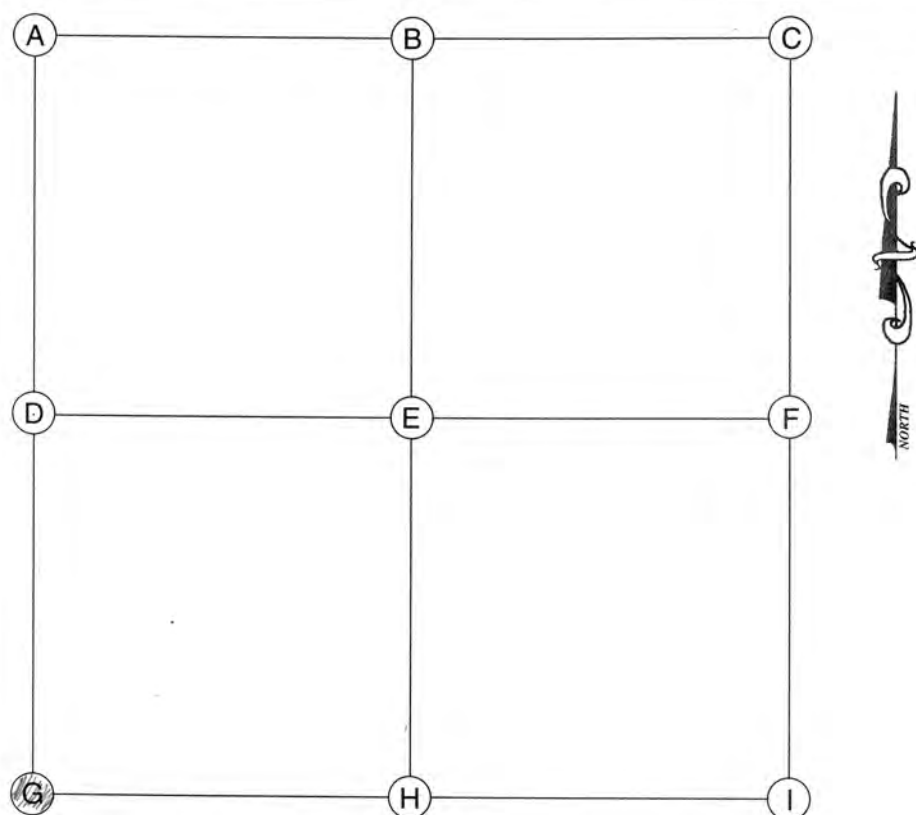

E (CENTER OF SECTION)

Date Located: _____
 By: _____
 Monument Description: _____
 Monument Witnesses: _____

Field Book: _____ Page: _____

F (EAST QUARTER CORNER)

Date Located: _____
 By: _____
 Monument Description: _____
 Monument Witnesses: _____

Field Book: _____ Page: _____

A (NORTHWEST CORNER)

Date Located: _____
 By: _____
 Monument Description: _____
 Monument Witnesses: _____

Field Book: _____ Page: _____

G (SOUTHWEST CORNER)

Date Located: 5/3/17
 By: DEM
 Monument Description: RESET MAG NAIL IN CO TAG
 Monument Witnesses: SEE Pg 126 "A"

Field Book: 6 Page: 76

B (NORTH QUARTER CORNER)

Date Located: _____
 By: _____
 Monument Description: _____
 Monument Witnesses: _____

Field Book: _____ Page: _____

H (SOUTH QUARTER CORNER)

Date Located: _____
 By: _____
 Monument Description: _____
 Monument Witnesses: _____

Field Book: _____ Page: _____

C (NORTHEAST CORNER)

Date Located: _____
 By: _____
 Monument Description: _____
 Monument Witnesses: _____

Field Book: _____ Page: _____

I (SOUTHEAST CORNER)

Date Located: _____
 By: _____
 Monument Description: _____
 Monument Witnesses: _____

Field Book: _____ Page: _____

D (WEST QUARTER CORNER)

Date Located: _____
 By: _____
 Monument Description: _____
 Monument Witnesses: _____

Field Book: _____ Page: _____

ADDITIONAL NOTES

Harrison
21-32-5

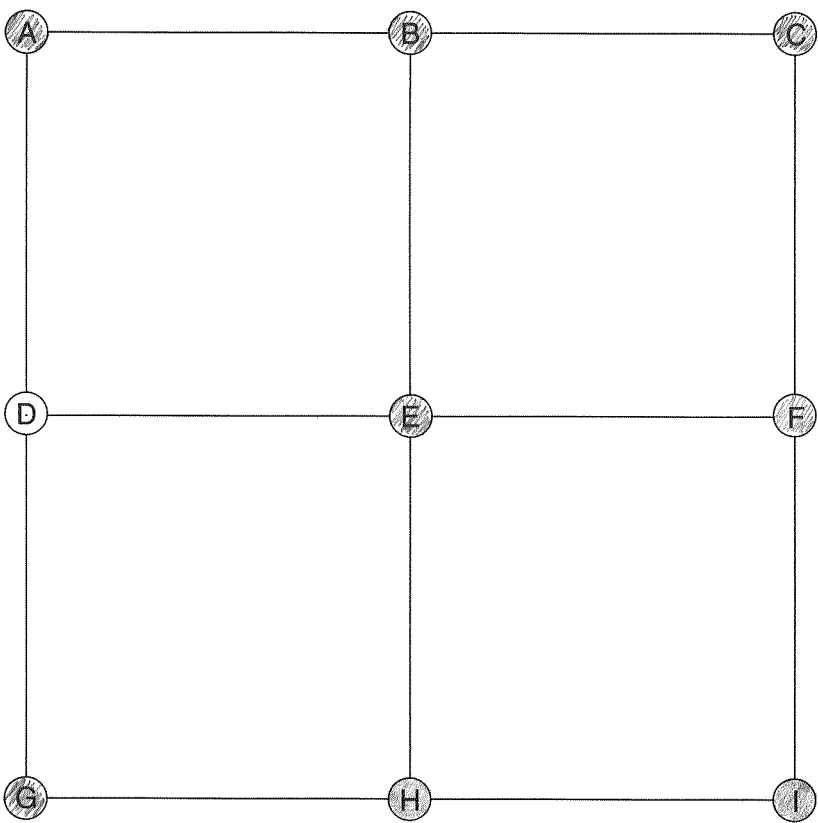

E (CENTER OF SECTION)

Date Located: 3/13/19
By: SEM
Monument Description: RR SPIKE
Monument Witnesses: 4 RR RAIL FCP ENE 20.6'
NAIL IN B. CAP POWER POLE SSW 89.35'

Field Book: 12 Page: 32

F (EAST QUARTER CORNER)

Date Located: 4/27/21
By: SEM MWH
Monument Description: RR RAIL FCP
Monument Witnesses:

Field Book: 20 Page: 60

A (NORTHWEST CORNER)

Date Located: 2/28/19
By: SEM
Monument Description: MAG NAIL w/ TAG
Monument Witnesses: SEE Pg 115 "G"

Field Book: 12 Page: 22

G (SOUTHWEST CORNER)

Date Located: 8/17/18
By: SEM
Monument Description: BRONZE MONUMENT
Monument Witnesses: SEE Pg 119 "I"

Field Book: 10 Page: 67

B (NORTH QUARTER CORNER)

Date Located: 2/28/19
By: SEM
Monument Description: RR SPIKE
Monument Witnesses: SEE Pg 115 "H"

Field Book: 12 Page: 21

H (SOUTH QUARTER CORNER)

Date Located: 7/2/92
By: JB MOYER - EC HAINES
Monument Description: RR SPIKE
Monument Witnesses: SET NAIL IN BOTTLE CAP IN S. FACE OF A P. POLE WNW 53.32
" " " " " " "SE " " NIPPLED P. POLE SSW 64.40
" " " " " " "N " " " " WSW 86.26

Field Book: 1 Page: 74

C (NORTHEAST CORNER)

Date Located: 2/28/19
By: SEM
Monument Description: BRONZE MONUMENT
Monument Witnesses: SEE Pg 115 "I"

Field Book: 12 Page: 20

I (SOUTHEAST CORNER)

Date Located: _____
By: _____
Monument Description: _____
Monument Witnesses: SEE Pg. 121 "G"
SW 22-32-5

Field Book: _____ Page: _____

D (WEST QUARTER CORNER)

Date Located: _____
By: _____
Monument Description: _____
Monument Witnesses: _____

Field Book: _____ Page: _____

ADDITIONAL NOTES



Date Located: 4/7/21
By: SEM MMH
Monument Description: RR RAIL FCP
Monument Witnesses: _____

Date Located: _____
By: _____
Monument Description: _____
Monument Witnesses: _____

Date Located: 7/21/92
By: JAMoyer-EC HAINES
Monument Description: BRONZE MARKER
Monument Witnesses: CENTER OF A RR MAIL FCP N 20 38
CENTER OF A RR MAIL FCP S 20.44
SET NAIL IN BOTTLE CAP IN E. FACE OF A.P.P. NNW 01.00
NAIL IN B. CAP IN POWER POLE NNW 27.05

Date Located: 7/21/92
By: JR MOYER - EC HAINES
Monument Description: PK NAIL
Monument Witnesses: CENTER OF A BAIL FCP N 19.96
CENTER OF A BAIL FCP S 20.31
1/2" REBAR W/CAP SW 27.17'
NAIL IN B. CAP IN POWER POLE WNW 71.33'

Date Located: 7/2/92 UPDATED 6/28/17
By: JAMoyer - EC HAINES
Monument Description: PK NAIL MAG NAIL
Monument Witnesses: SEE Pg 122 'G'

SET NAIL IN BOTTLE CAP IN NEEL OF REMC P.B NW 38.24
" " " " " " " " " "
" " " " " " " " " "
" " " " " " " " " "
NW " " " " "
SW 44.1A

— ADDITIONAL NOTES

Date Located: 2/28/19
By: SEM
Monument Description: BRONZE MONUMENT
Monument Witnesses: SEE Pg 115 "I"

Date Located: 2/28/19
By: SRM
Monument Description: GIN SPINDLE
Monument Witnesses: AMIL W B CAP POWER POLE WSW 65.94'
4 RR RAIL FCP S 20.55'
1/2" REBAR W/CAP SE 27.60

Date Located: 10/31/16
By: JEM
Monument Description: FO 1/2" COPPER ROD FLUSH
Monument Witnesses: SEE Pg 12Z "A"

Date Located: 4/27/21
By: SEM MWH
Monument Description: RR RAIL FCP
Monument Witnesses: _____

Field Book: 20 Page: 60

Harrison
27-32-5

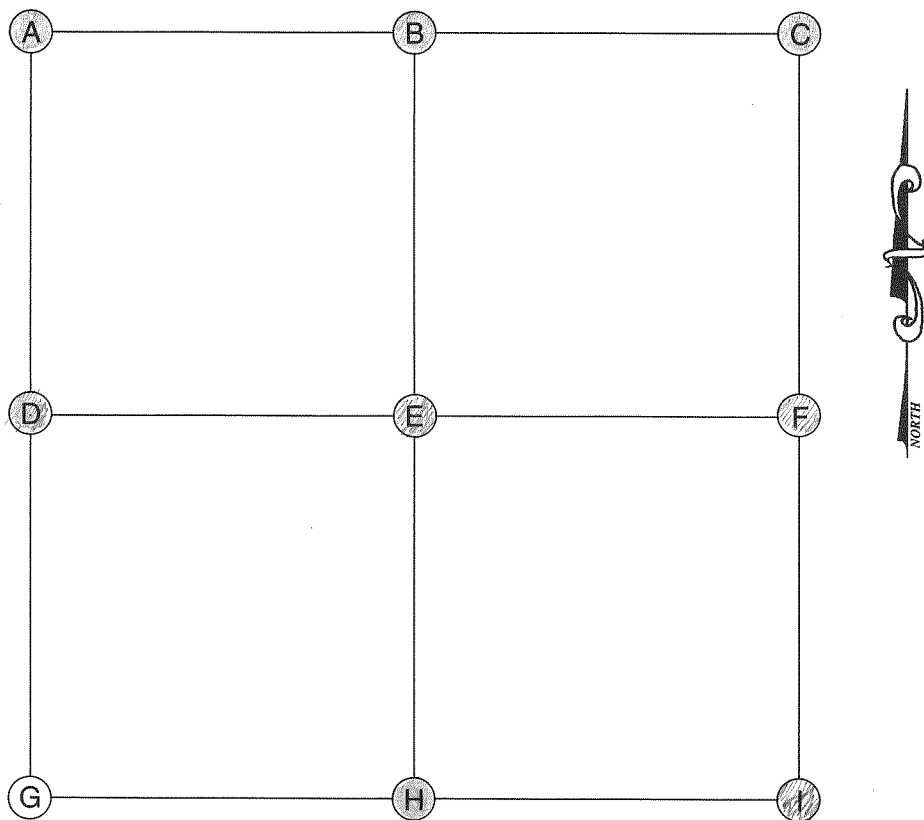

A (NORTHWEST CORNER)

Date Located: _____
By: _____
Monument Description: _____
Monument Witnesses: SEE PG 121 "6"
SW 22-32-5

B (NORTH QUARTER CORNER)

Date Located: _____
By: _____
Monument Description: _____
Monument Witnesses: SEE PG. 121 "H")
54 POST 22-32-5

Field Book: _____ Page: _____

C (NORTHEAST CORNER)

Date Located: _____
By: _____
Monument Description: _____
Monument Witnesses: SEE PG. 121 "I"
SE 22-32-5

Field Book: _____ Page: _____

D (WEST QUARTER CORNER)

Date Located: 1/27/12
By: JEAN MWH
Monument Description: CRAN FCP
Monument Witnesses: _____

Field Book: 20 Page: 8

E (CENTER OF SECTION)

Date Located: 4/27/21
By: SEN MWH
Monument Description: RR RAIL FCP
Monument Witnesses: _____

Field Book: 20 Page: 7

F (EAST QUARTER CORNER)

Date Located: 8/29/18
By: SEM
Monument Description: RR SPIKE
Monument Witnesses: SEE Pg 123 "D"

Field Book: 11 Page: 7

G (SOUTHWEST CORNER)

Date Located: _____
By: _____
Monument Description: _____
Monument Witnesses: _____

Field Book: _____ Page: _____

H (SOUTH QUARTER CORNER)

Date Located: 8/9/95 5/16/19
By: BREWER - M HISSINGER SJM MJH
Monument Description: AEBAR
Monument Witnesses: RAILROAD IRON POST (CENTER) E 12.00
PKNAIL WEST FACE POWER POLE SSW 45.95

Field Book: 2 Page: 70
14 R 19

I (SOUTHEAST CORNER)

Date Located: 6/12/19
By: SEM MWLH
Monument Description: SET MAG NAIL
Monument Witnesses: SEE Pg 123 "G"

Field Book: 1A Page: 68

ADDITIONAL NOTES

(Blank handwriting practice area)



E (CENTER OF SECTION)

Date Located: 6/21/99 3/5/18
 By: MM + WES R. SRM
 Monument Description: RAILROAD SPIKE / MAG NAIL W/TAG
 Monument Witnesses: 5" DIA IRON BAR FCP W 21.24'
NAIL IN B CAP NIPSCO PIPE NNW 63.35'
1/2" REBAR W/CAP NW 30.98'

Field Book: 9 Page: 6

F (EAST QUARTER CORNER)

Date Located: _____
 By: _____
 Monument Description: _____
 Monument Witnesses: _____

Field Book: _____ Page: _____

A (NORTHWEST CORNER)

Date Located: _____
 By: _____
 Monument Description: _____
 Monument Witnesses: _____

Field Book: _____ Page: _____

G (SOUTHWEST CORNER)

Date Located: _____
 By: _____
 Monument Description: _____
 Monument Witnesses: _____

Field Book: _____ Page: _____

B (NORTH QUARTER CORNER)

Date Located: 7/2/92
 By: JRM + ECH
 Monument Description: RAILROAD SPIKE
 Monument Witnesses: 52.18'
NAIL IN BOTTLE CAP IN SOUTH FACE OF POWER POLE 53.32' WNW
" " " " SE " " NIPSCO " 620/120 64.40' SSW
" " " " NORTH " " " " 621/448 86.26' WSW

Field Book: 1 Page: 74 UPDATED 2/21/18 SRM

H (SOUTH QUARTER CORNER)

Date Located: 3/5/18
 By: SRM
 Monument Description: FD 3/4" IRON PIPE FLUSH
 Monument Witnesses: 4 I-BEAM FCP W 20.15'
NAIL IN B. CAP NIPSCO PIPE NW 18.85'
1/2" REBAR W/CAP NE 29.01'
4 RR RAIL FCP E 19.69'

Field Book: 9 Page: 5

C (NORTHEAST CORNER)

Date Located: _____
 By: _____
 Monument Description: _____
 Monument Witnesses: SEE PAGE 121 "G"
(SW 22-32-5)

Field Book: _____ Page: _____

I (SOUTHEAST CORNER)

Date Located: _____
 By: _____
 Monument Description: _____
 Monument Witnesses: _____

Field Book: _____ Page: _____

D (WEST QUARTER CORNER)

Date Located: _____
 By: _____
 Monument Description: _____
 Monument Witnesses: _____

Field Book: _____ Page: _____

ADDITIONAL NOTES

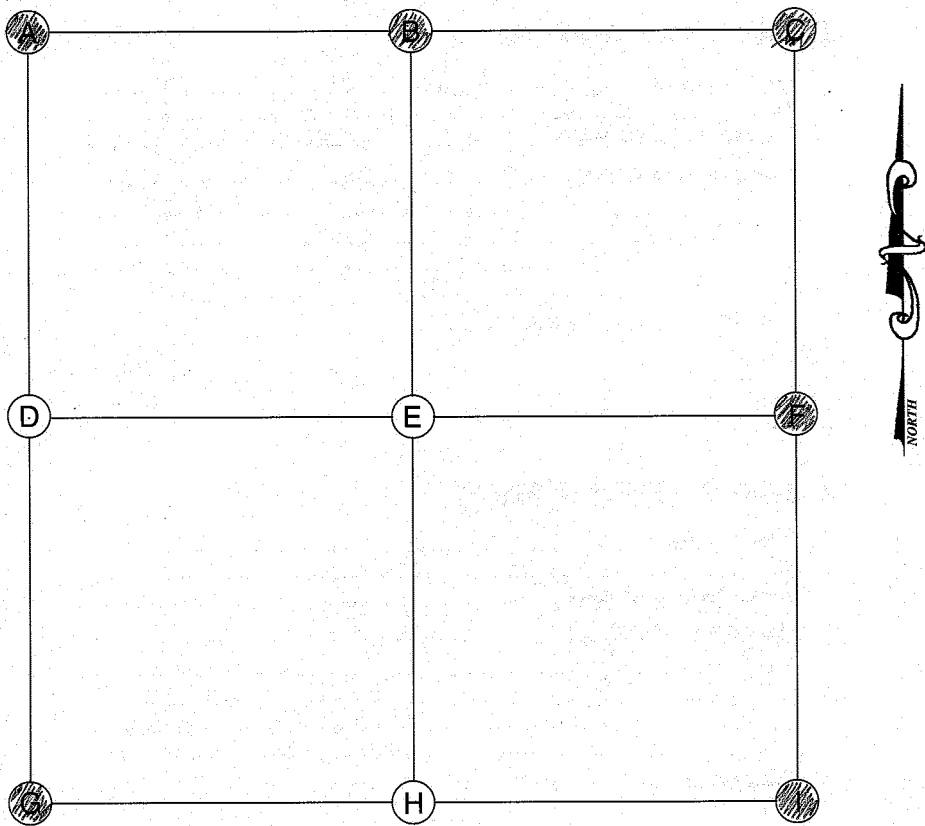

A (NORTHWEST CORNER)

Date Located: 5/3/17
By: SRM
Monument Description: FB PK NAIL RESET MAG NAIL W/TAG
Monument Witnesses: NAIL IN B. CAP P POLE WNW 78.01'
5/8" REBAR NO CAP N 20.25'
BRIDGE DECK E 112.7'
NAIL IN B. CAP IN P POLE ESE 42.14'
NAIL IN B. CAP TOP RR TIE FBST SW 89.20'

Field Book: 6 Page: 76

B (NORTH QUARTER CORNER)

Date Located: 8/17/18
By: SRM
Monument Description: FB RR SPIKE
Monument Witnesses: SEE P₃ 119 "H"

Field Book: 10 Page: 66

C (NORTHEAST CORNER)

Date Located: 8/17/18
By: SRM
Monument Description: BRONZE MONUMENT
Monument Witnesses: SEE P₃ 119 "I"

Field Book: 10 Page: 67

D (WEST QUARTER CORNER)

Date Located: _____
By: _____
Monument Description: _____
Monument Witnesses: _____

Field Book: _____ Page: _____

E (CENTER OF SECTION)

Date Located: _____
By: _____
Monument Description: _____
Monument Witnesses: _____

Field Book: _____ Page: _____

F (EAST QUARTER CORNER)

Date Located: 3/13/19
By: SRM
Monument Description: MAG NAIL W/ CO TAG
Monument Witnesses: 1/2" REBAR W/CAP NW 39.40'

Field Book: 12 Page: 33

G (SOUTHWEST CORNER)

Date Located: 3/13/19
By: SRM
Monument Description: BRONZE MONUMENT
Monument Witnesses: SEE P₃ 128 "C"

Field Book: 12 Page: 35

H (SOUTH QUARTER CORNER)

Date Located: _____
By: _____
Monument Description: _____
Monument Witnesses: _____

Field Book: _____ Page: _____

I (SOUTHEAST CORNER)

Date Located: 3/13/19
By: SRM
Monument Description: MAG NAIL W/ CO TAG
Monument Witnesses: SEE P₃ 129 "C"

Field Book: 12 Page: 34

ADDITIONAL NOTES

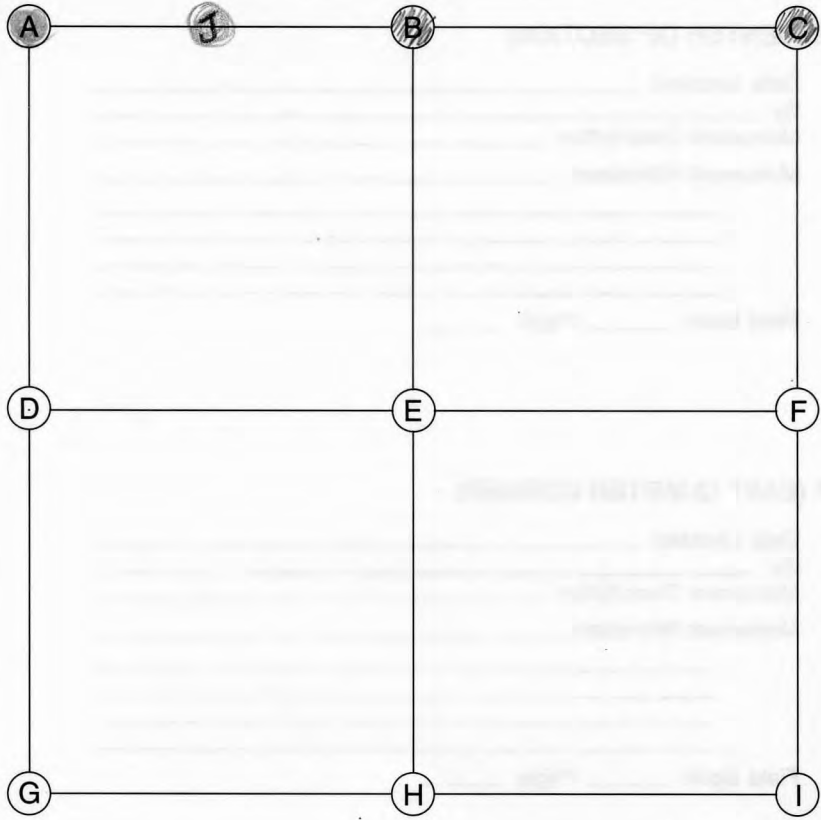

E (CENTER OF SECTION)

Date Located: _____
By: _____
Monument Description: _____
Monument Witnesses: _____

Field Book: _____ Page: _____

F (EAST QUARTER CORNER)

Date Located: _____
By: _____
Monument Description: _____
Monument Witnesses: _____

Field Book: _____ Page: _____

A (NORTHWEST CORNER)

Date Located: 6/17/91
By: JR MOYER - EC HAINES
Monument Description: BRONZE MARKER
Monument Witnesses: SET NAIL IN BOTTLE CAP IN SE FACE R.P. POLE ENE 31.22
SET 4" CUT IN SW FACE OF 10" DIA CONC FCP SE 27.58
SET CUT IN NE EDGE OF BRIDGE BEAM FCP SW 29.85
Field Book: 1 Page: 23

G (SOUTHWEST CORNER)

Date Located: _____
By: _____
Monument Description: _____
Monument Witnesses: _____

Field Book: _____ Page: _____

B (NORTH QUARTER CORNER)

Date Located: 8/13/18
By: SEM
Monument Description: FORR SPIKE 4" DEEP
Monument Witnesses: SEE Pg 118 "H"
Field Book: 10 Page: 61

H (SOUTH QUARTER CORNER)

Date Located: _____
By: _____
Monument Description: _____
Monument Witnesses: _____

Field Book: _____ Page: _____

C (NORTHEAST CORNER)

Date Located: 5/3/17
By: SEM
Monument Description: FORR NAIL RESET MAGNAIL IN CO TAG
Monument Witnesses: SEE Pg 126 "A"
Field Book: 6 Page: 76

I (SOUTHEAST CORNER)

Date Located: _____
By: _____
Monument Description: _____
Monument Witnesses: _____

Field Book: _____ Page: _____

D (WEST QUARTER CORNER)

Date Located: _____
By: _____
Monument Description: _____
Monument Witnesses: _____

Field Book: _____ Page: _____

ADDITIONAL NOTES

NE COR. NW 1/4 NW 1/4
5. RAILROAD SPIKE 3" DEEP
- NAIL IN BOTTLE CAP IN SE FACE OF R. POLE
36.55' NE
- CUT IN NE EDGE OF STEEL "I" BEAM 41.30' SW
- "4" CUT IN EAST FACE OF R.I.P. P&P 28.62' NW

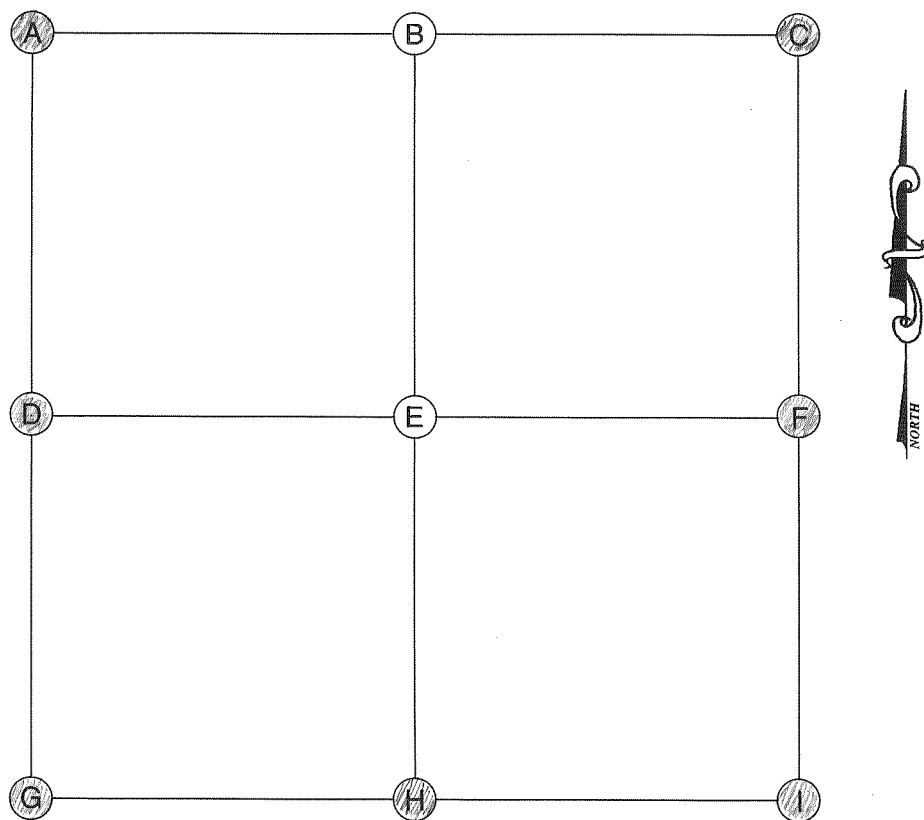

ADDITIONAL NOTES

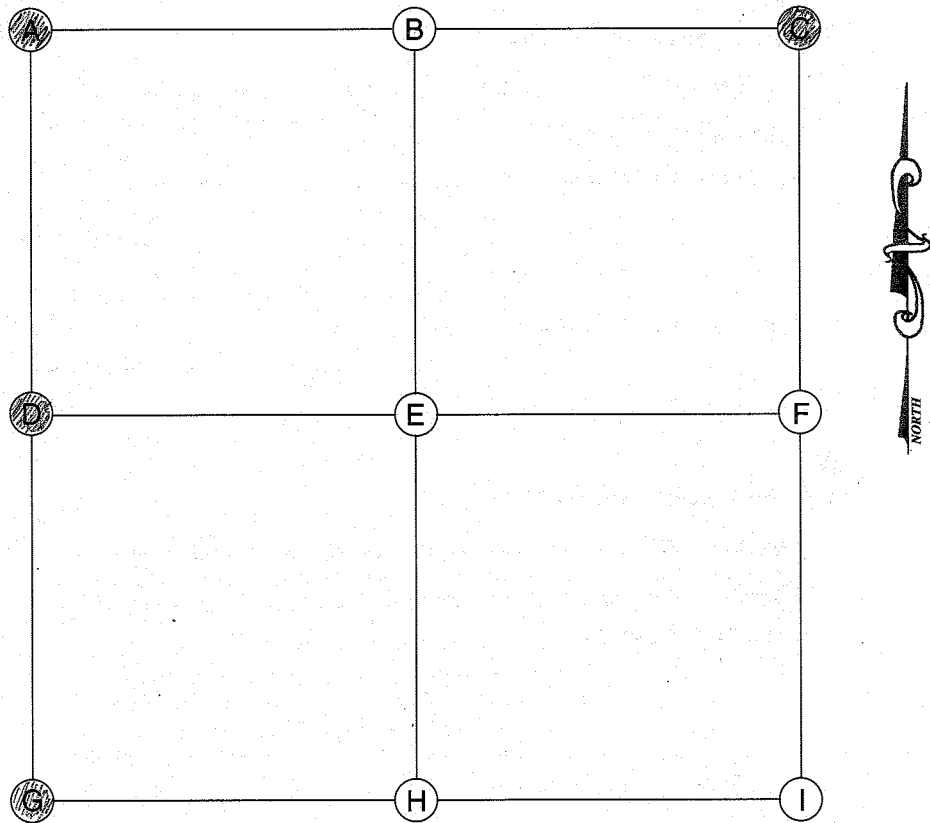

A (NORTHWEST CORNER)

Date Located: 3/13/19
By: SEM
Monument Description: BRONZE MONUMENT
Monument Witnesses: SEE Pg 128 "C"

Field Book: 12 Page: 35

B (NORTH QUARTER CORNER)

Date Located: _____
By: _____
Monument Description: _____
Monument Witnesses: _____

Field Book: _____ Page: _____

C (NORTHEAST CORNER)

Date Located: 3/13/19
By: SEM
Monument Description: MAG NAIL W/ CO TAG
Monument Witnesses: NAIL IN BCAP P.P. WSW 24.25'
FO 1/2" REBAR NO CAP W 20.00'

Field Book: 12 Page: 34

D (WEST QUARTER CORNER)

Date Located: 6/4/19
By: SEM
Monument Description: 1/2" IRON PIN
Monument Witnesses: 1/2" REBAR W/CAP NE 25.16'
& RR RAIL FCP E 20.2'
& RR RAIL FCP W 20.05'

Field Book: 14 Page: 54

E (CENTER OF SECTION)

Date Located: _____
By: _____
Monument Description: _____
Monument Witnesses: _____

Field Book: _____ Page: _____

F (EAST QUARTER CORNER)

Date Located: _____
By: _____
Monument Description: _____
Monument Witnesses: _____

Field Book: _____ Page: _____

G (SOUTHWEST CORNER)

Date Located: 5/25/16
By: DE MOYER
Monument Description: FD PK NAIL FLUSH
Monument Witnesses: BENCHMARK S 145 NE 34.38'
SET MAG NAIL IN P POLE NW 37.00'
SET 1/2" REBAR W/CAP BESIDE BE BEAM FCP NE 48.56'

Field Book: 3 Page: 60

H (SOUTH QUARTER CORNER)

Date Located: _____
By: _____
Monument Description: _____
Monument Witnesses: _____

Field Book: _____ Page: _____

I (SOUTHEAST CORNER)

Date Located: _____
By: _____
Monument Description: _____
Monument Witnesses: _____

Field Book: _____ Page: _____

ADDITIONAL NOTES



Date Located: _____
By: _____
Monument Description: _____
Monument Witnesses: _____

Date Located: 3/5/18
By: JRM
Monument Description: FO 3/4" IRON PIPE 12" DEEP
Monument Witnesses: K BRUNER RO W 33.65'
1" AXLE BESIDE I. BEAM FCP W 15.4'
I. BEAM FCP E 13.2'

Date Located: _____
By: _____
Monument Description: _____
Monument Witnesses: _____

Date Located: _____
By: _____
Monument Description: _____
Monument Witnesses: _____

Date Located: _____
By: _____
Monument Description: _____
Monument Witnesses: _____

Date Located: _____
By: _____
Monument Description: _____
Monument Witnesses: _____

Date Located: 3/5/18
By: SEM
Monument Description: FD 3/4" IRON PIPE FLUSH
Monument Witness: 4 I-BEAM FCP W 20.15'
NAIL IN B. CAP NIPSCO P POLE NW 18.85'
1/2" REBAR W/CAP NE 29.01'

Date Located: _____
By: _____
Monument Description: _____
Monument Witnesses: _____

Date Located: _____
By: _____
Monument Description: _____
Monument Witnesses: _____

Field Book: _____ Page: _____

ADDITIONAL NOTES

[illegible]

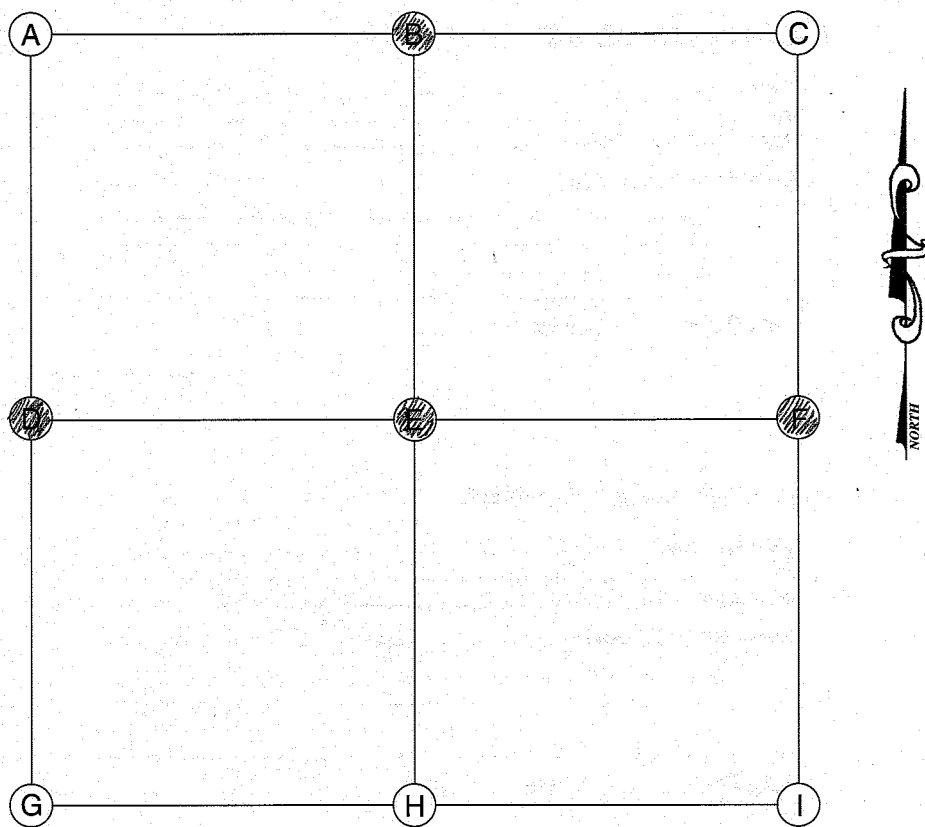

Date Located: _____
By: _____
Monument Description: _____
Monument Witnesses: _____

Field Book: _____ Page: _____

Date Located: 2/19/19
By: SEM
Monument Description: RR RAIL FCP
Monument Witnesses: STONE NNE 10.5

Field Book: 12 Page: 2

Date Located: _____
By: _____
Monument Description: _____
Monument Witnesses: _____

Field Book: _____ Page: _____

Date Located: 12/21/17
By: JEM
Monument Description: FD 5/8" REBAR FLUSH
Monument Witnesses: NAIL IN B. CAP IN P POLE NW 36.53
1/2" REBAR W/CAP NE 41.43'
NAIL IN B. CAP IN P POLE ENE 67.90'
RE RAIL FCP SE 32.3'

Field Book: 8 Page: 46

Date Located: 8/23/18
By: JRM
Monument Description: 5/8" REBAR
Monument Witnesses: 4 RR RAIL FCP N 20.25'
1/2" REBAR w/CAP NE 25.38'

Field Book: 11 Page: 4

Date Located: 8/23/18
By: SEM
Monument Description: RR SPIKE
Monument Witnesses: 1/2" REBAR w/CAP NW 28.15'
& RR RAIL FCP N 20.1'

Field Book: 11 Page: 3

Date Located: _____
By: _____
Monument Description: _____
Monument Witnesses: _____

Field Book: _____ Page: _____

Date Located: _____
By: _____
Monument Description: _____
Monument Witnesses: _____

Field Book: _____ Page: _____

Date Located: _____
By: _____
Monument Description: _____
Monument Witnesses: _____

Field Book: _____ Page: _____

ADDITIONAL NOTES