

E (CENTER OF SECTION)

Date Located: _____
 By: _____
 Monument Description: _____
 Monument Witnesses: _____

Field Book: _____ Page: _____

F (EAST QUARTER CORNER)

Date Located: 6/3/16
 By: SR MOVED
 Monument Description: FORR SPIRE A" DEEP SET MARK OVER
 Monument Witnesses: 1/2" REBAR W/CAP NW 39.44'
NAIL IN B. CAP IN P POLE SE 37.53'
NAIL IN B. CAP IN P POLE SW 44.10

Field Book: 3 Page: 76

A (NORTHWEST CORNER)

Date Located: _____
 By: _____
 Monument Description: _____
 Monument Witnesses: _____

Field Book: _____ Page: _____

G (SOUTHWEST CORNER)

Date Located: _____
 By: _____
 Monument Description: _____
 Monument Witnesses: _____

Field Book: _____ Page: _____

B (NORTH QUARTER CORNER)

Date Located: _____
 By: _____
 Monument Description: _____
 Monument Witnesses: _____

Field Book: _____ Page: _____

H (SOUTH QUARTER CORNER)

Date Located: _____
 By: _____
 Monument Description: _____
 Monument Witnesses: _____

Field Book: _____ Page: _____

C (NORTHEAST CORNER)

Date Located: _____
 By: _____
 Monument Description: _____
 Monument Witnesses: _____

Field Book: _____ Page: _____

I (SOUTHEAST CORNER)

Date Located: 5/23/16
 By: SR MOVED
 Monument Description: FO BRONZE MONUMENT 3" DEEP
 Monument Witnesses: SEE Pg 252 "C"

Field Book: 3 Page: 57

D (WEST QUARTER CORNER)

Date Located: _____
 By: _____
 Monument Description: _____
 Monument Witnesses: _____

Field Book: _____ Page: _____

ADDITIONAL NOTES

Plain
9-33-6

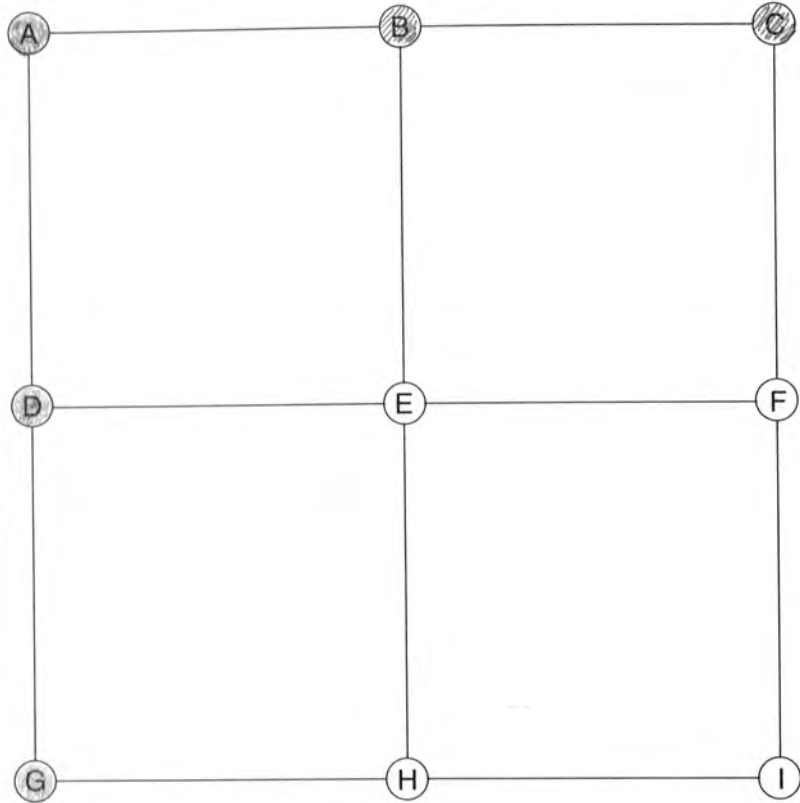

E (CENTER OF SECTION)

Date Located: _____
 By: _____
 Monument Description: _____
 Monument Witnesses: _____

 Field Book: _____ Page: _____

F (EAST QUARTER CORNER)

Date Located: _____
 By: _____
 Monument Description: _____
 Monument Witnesses: _____

 Field Book: _____ Page: _____

A (NORTHWEST CORNER)

Date Located: _____
 By: _____
 Monument Description: _____
 Monument Witnesses: SEE PAGE 249 "C"
NE 8-33-6

 Field Book: _____ Page: _____

G (SOUTHWEST CORNER)

Date Located: _____
 By: _____
 Monument Description: _____
 Monument Witnesses: SEE PAGE 249 "I"
SE 8-33-6

 Field Book: _____ Page: _____

B (NORTH QUARTER CORNER)

Date Located: 9/1/16
 By: DE MOYER
 Monument Description: SET MAG NAIL
 Monument Witnesses: NAIL IN B. CAP IN TEL POLE NE 20.48'
2" DIA IRON PIPE S 20.00'
NAIL IN B. CAP IN NIPSCO PPG30/255 SW 40.51'

 Field Book: 4 Page: 59

H (SOUTH QUARTER CORNER)

Date Located: _____
 By: _____
 Monument Description: _____
 Monument Witnesses: _____

 Field Book: _____ Page: _____

C (NORTHEAST CORNER)

Date Located: 10/17/16
 By: SRM
 Monument Description: EQ 1/2" IRON PIPE IN CONC PAVEMENT
 Monument Witnesses: NAIL IN B. CAP IN TEL POLE NW 24.71'
1/2" REBAR W/CAP NE 41.13'
1/2" REBAR W/CAP SE 30.11'

 Field Book: 5 Page: 15

I (SOUTHEAST CORNER)

Date Located: _____
 By: _____
 Monument Description: _____
 Monument Witnesses: _____

 Field Book: _____ Page: _____

D (WEST QUARTER CORNER)

Date Located: _____
 By: _____
 Monument Description: _____
 Monument Witnesses: SEE PAGE 249 "F"
E 1/4 POST 8-33-6

 Field Book: _____ Page: _____

ADDITIONAL NOTES

Plain
11-33-6

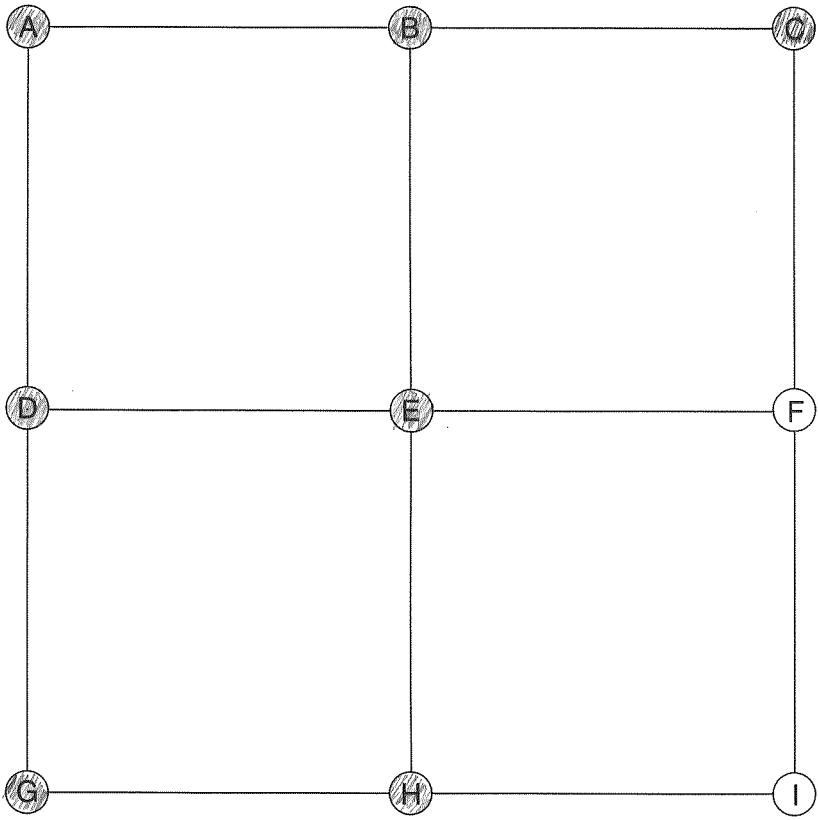

E (CENTER OF SECTION)

Date Located: 11/16/19
 By: SEM MWH
 Monument Description: RR RAIL FCP
 Monument Witnesses: RR RAIL POST N 15.65'

Field Book: 18 Page: 16

F (EAST QUARTER CORNER)

Date Located: _____
 By: _____
 Monument Description: _____
 Monument Witnesses: _____

Field Book: _____ Page: _____

G (SOUTHWEST CORNER)

Date Located: 7/17/19
 By: SEM MWH
 Monument Description: PK NAIL
 Monument Witnesses: SEE Pg 255 "A"

Field Book: 15 Page: 61

H (SOUTH QUARTER CORNER)

Date Located: 4/24/19
 By: SEM MWH
 Monument Description: RR RAIL FCP
 Monument Witnesses: _____

Field Book: 13 Page: 37

I (SOUTHEAST CORNER)

Date Located: _____
 By: _____
 Monument Description: _____
 Monument Witnesses: _____

Field Book: _____ Page: _____

ADDITIONAL NOTES

A (NORTHWEST CORNER)

Date Located: 11/16/19
 By: SEM MWH
 Monument Description: MAG NAIL w/ CO TAG
 Monument Witnesses: NAIL IN B. CAP POWER POLE NW 55.69'
1/2" REBAR NE 42.62'
1/2" REBAR SE 38.93'

Field Book: 18 Page: 14

B (NORTH QUARTER CORNER)

Date Located: 7/17/19
 By: SEM MWH
 Monument Description: RR SPIKE
 Monument Witnesses: 1/2" REBAR w/CAP SW 28.35'
NAIL IN B. CAP TEL POLE NE 27.45'
FACE RR RAIL FCP

Field Book: 15 Page: 62

C (NORTHEAST CORNER)

Date Located: 5/23/16
 By: SEM MOYER
 Monument Description: BRONZE MONUMENT 3" DEEP
 Monument Witnesses: 1/2" REBAR w/CAP 39.45' NW
NAIL IN BOTTLE CAP IN P. POLE 36.34' NE

Field Book: 3 Page: 57

D (WEST QUARTER CORNER)

Date Located: 11/16/19
 By: SEM MWH
 Monument Description: MAG NAIL w/ CO TAG
 Monument Witnesses: NAIL IN B. CAP POWER POLE WNW 17.55'
1/2" REBAR w/CAP NE 41.15'
1/2" REBAR w/CAP SE 27.80'

Field Book: 18 Page: 15

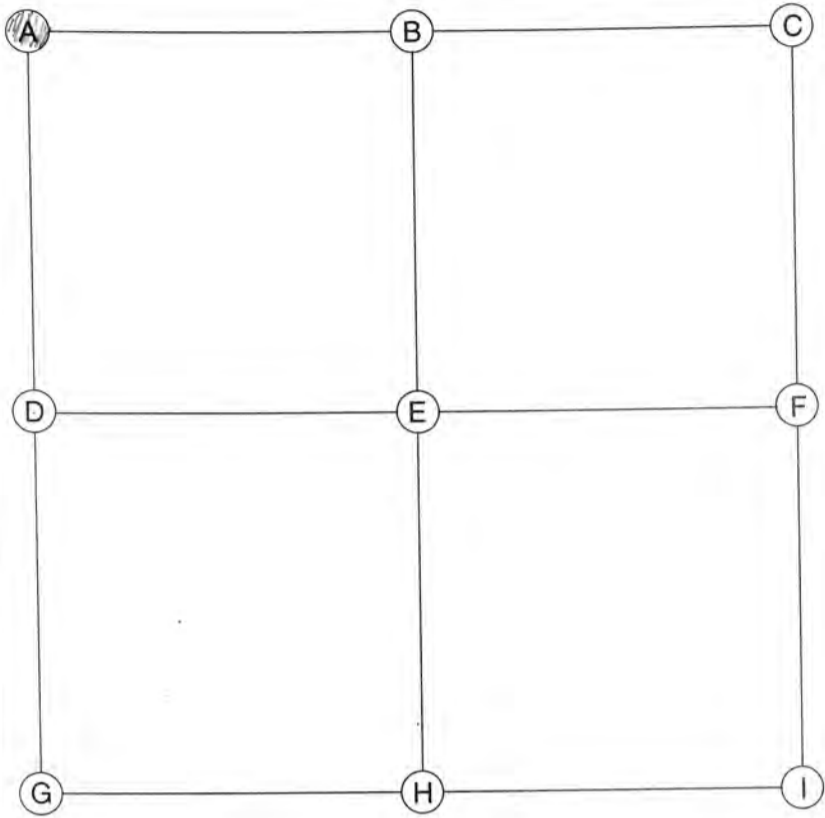

E (CENTER OF SECTION)

Date Located: _____
 By: _____
 Monument Description: _____
 Monument Witnesses: _____

Field Book: _____ Page: _____

F (EAST QUARTER CORNER)

Date Located: _____
 By: _____
 Monument Description: _____
 Monument Witnesses: _____

Field Book: _____ Page: _____

G (SOUTHWEST CORNER)

Date Located: _____
 By: _____
 Monument Description: _____
 Monument Witnesses: _____

Field Book: _____ Page: _____

H (SOUTH QUARTER CORNER)

Date Located: _____
 By: _____
 Monument Description: _____
 Monument Witnesses: _____

Field Book: _____ Page: _____

I (SOUTHEAST CORNER)

Date Located: _____
 By: _____
 Monument Description: _____
 Monument Witnesses: _____

Field Book: _____ Page: _____

A (NORTHWEST CORNER)

Date Located: 5/23/16
 By: SEMOYER
 Monument Description: FO BRONZE MONUMENT 2" DEEP
 Monument Witnesses: SEE P. 252 "C"

Field Book: 3 Page: 57

B (NORTH QUARTER CORNER)

Date Located: _____
 By: _____
 Monument Description: _____
 Monument Witnesses: _____

Field Book: _____ Page: _____

C (NORTHEAST CORNER)

Date Located: _____
 By: _____
 Monument Description: _____
 Monument Witnesses: _____

Field Book: _____ Page: _____

D (WEST QUARTER CORNER)

Date Located: _____
 By: _____
 Monument Description: _____
 Monument Witnesses: _____

Field Book: _____ Page: _____

ADDITIONAL NOTES

253
 12-33-6

Plain
13-33-6

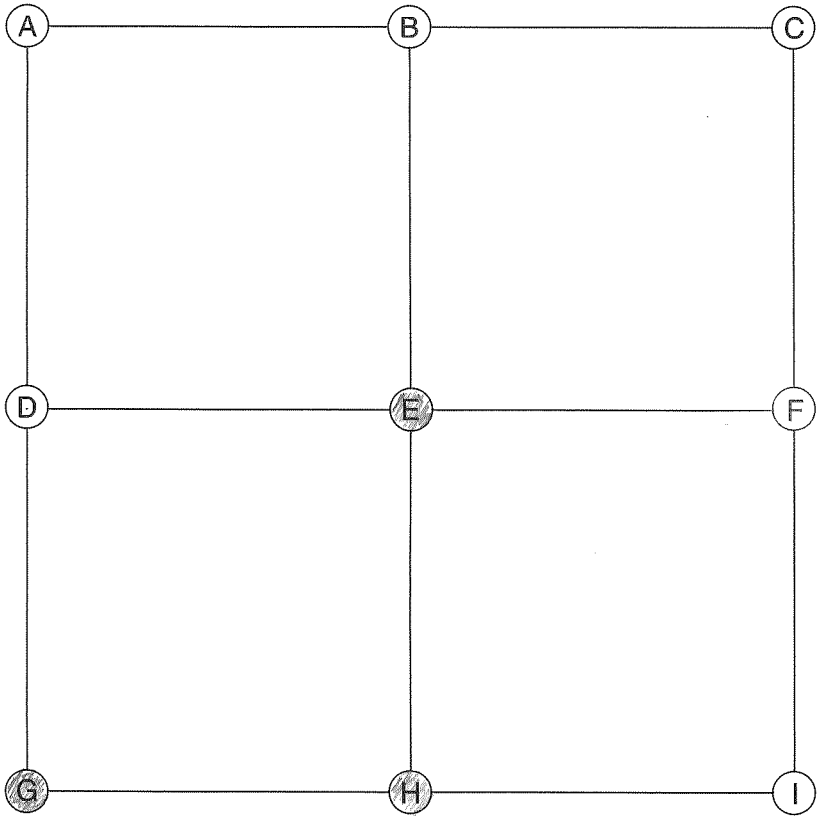

E (CENTER OF SECTION)

Date Located: 10/8/20
 By: SEM MWH
 Monument Description: FD RR RAIL FCP
 Monument Witnesses: _____

 Field Book: 19 Page: 53

F (EAST QUARTER CORNER)

Date Located: _____
 By: _____
 Monument Description: _____
 Monument Witnesses: _____

 Field Book: _____ Page: _____

G (SOUTHWEST CORNER)

Date Located: 7/9/19
 By: SRMOYER
 Monument Description: MAG NAIL
 Monument Witnesses: 1/2" REBAR w/CAP NW 23.95'
4" RR RAIL FCP E 20.08'
1/2" REBAR w/CAP SW 36.78'

 Field Book: 15 Page: 48

H (SOUTH QUARTER CORNER)

Date Located: 10/8/20
 By: SEM MWH
 Monument Description: FD RR RAIL FCP
 Monument Witnesses: _____

 Field Book: 19 Page: 52

I (SOUTHEAST CORNER)

Date Located: _____
 By: _____
 Monument Description: _____
 Monument Witnesses: _____

 Field Book: _____ Page: _____

ADDITIONAL NOTES

A (NORTHWEST CORNER)

Date Located: _____
 By: _____
 Monument Description: _____
 Monument Witnesses: _____

 Field Book: _____ Page: _____

B (NORTH QUARTER CORNER)

Date Located: _____
 By: _____
 Monument Description: _____
 Monument Witnesses: _____

 Field Book: _____ Page: _____

C (NORTHEAST CORNER)

Date Located: _____
 By: _____
 Monument Description: _____
 Monument Witnesses: _____

 Field Book: _____ Page: _____

D (WEST QUARTER CORNER)

Date Located: _____
 By: _____
 Monument Description: _____
 Monument Witnesses: _____

 Field Book: _____ Page: _____

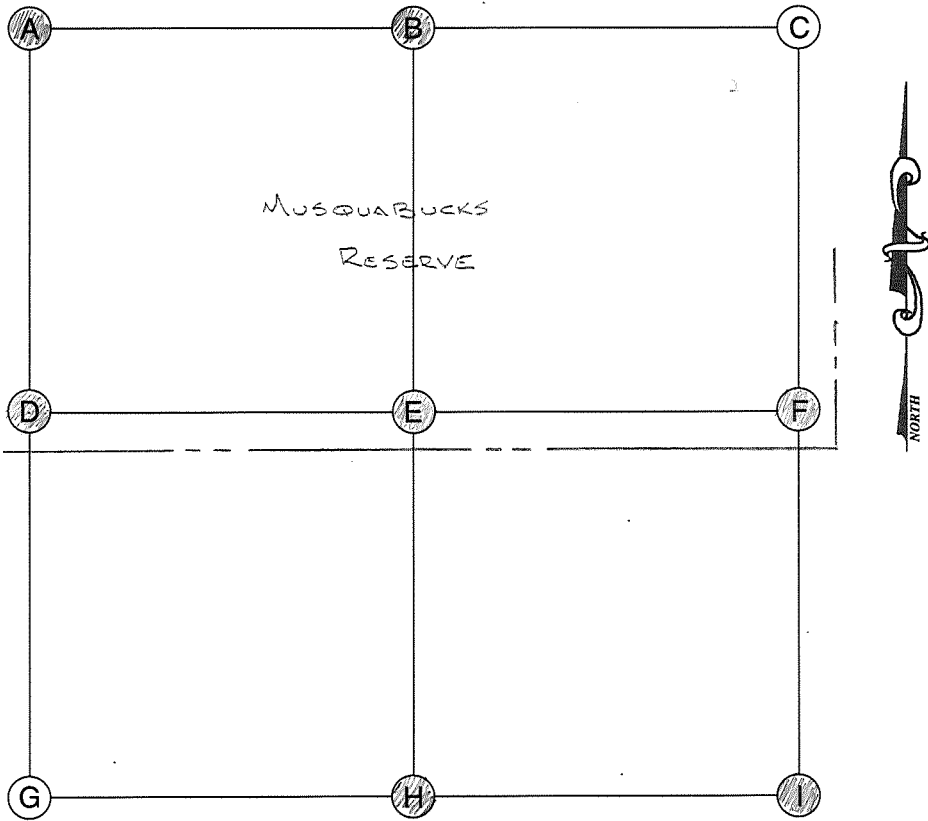

E (CENTER OF SECTION) - NE CORNER GOVERNMENT LOT 3

Date Located: 8/21/19
 By: SEM MWH
 Monument Description: MAG NAIL w/CO TAG
 Monument Witnesses: 1/2" REBAR w/CAP NE 28.15'
1/2" REBAR w/CAP SE 26.71'
NAIL IN B. CAP POWER POLE SW 44.73'

Field Book: 16 Page: 72

F (EAST QUARTER CORNER) - NE CORNER GOVERNMENT LOT 1

Date Located: 8/21/19
 By: SEM MWH
 Monument Description: MAG NAIL w/CO TAG
 Monument Witnesses: NAIL IN B. CAP NIPSCO POLE NNE 73.20'
1/2" REBAR w/CAP SE 31.25'
NAIL IN B. CAP WOOD FCP W 23.95'

Field Book: 16 Page: 71

A (NORTHWEST CORNER)

Date Located: 7/17/19
 By: SEM MWH
 Monument Description: PK NAIL
 Monument Witnesses: 1/2" REBAR w/CAP NW 26.68'
1/2" REBAR w/CAP NE 26.63'
NAIL IN B. CAP POWER POLE E 19.50'

Field Book: 15 Page: 61

G (SOUTHWEST CORNER)

Date Located: _____
 By: _____
 Monument Description: _____
 Monument Witnesses: _____

Field Book: _____ Page: _____

B (NORTH QUARTER CORNER)

Date Located: 4/24/19
 By: SEM MWH
 Monument Description: RR RAIL FCP
 Monument Witnesses: _____

Field Book: 13 Page: 37

H (SOUTH QUARTER CORNER)

Date Located: 9/26/17
 By: SEM
 Monument Description: FO 3/4" BOLT 3" DEEP
 Monument Witnesses: SEE Pg 264 "B"

Field Book: 7 Page: 72
STATE PLANE COORDINATES PHASE II 2/2018

C (NORTHEAST CORNER)

Date Located: _____
 By: _____
 Monument Description: _____
 Monument Witnesses: _____

Field Book: _____ Page: _____

I (SOUTHEAST CORNER)

Date Located: 7/9/19
 By: SEM MOYER
 Monument Description: MAG NAIL
 Monument Witnesses: SEE Pg 254 "G"

Field Book: 15 Page: 48

ADDITIONAL NOTES

D (WEST QUARTER CORNER) NW CORNER GOVERNMENT LOT 4

Date Located: 8/21/19
 By: SEM MWH
 Monument Description: RR SPIKE
 Monument Witnesses: NAIL IN B. CAP POWER POLE NE 24.80'
2 1/2" STEEL ANGLE IRON FCP SE 25.00'
1/2" REBAR w/CAP SW 30.95'

Field Book: 16 Page: 73

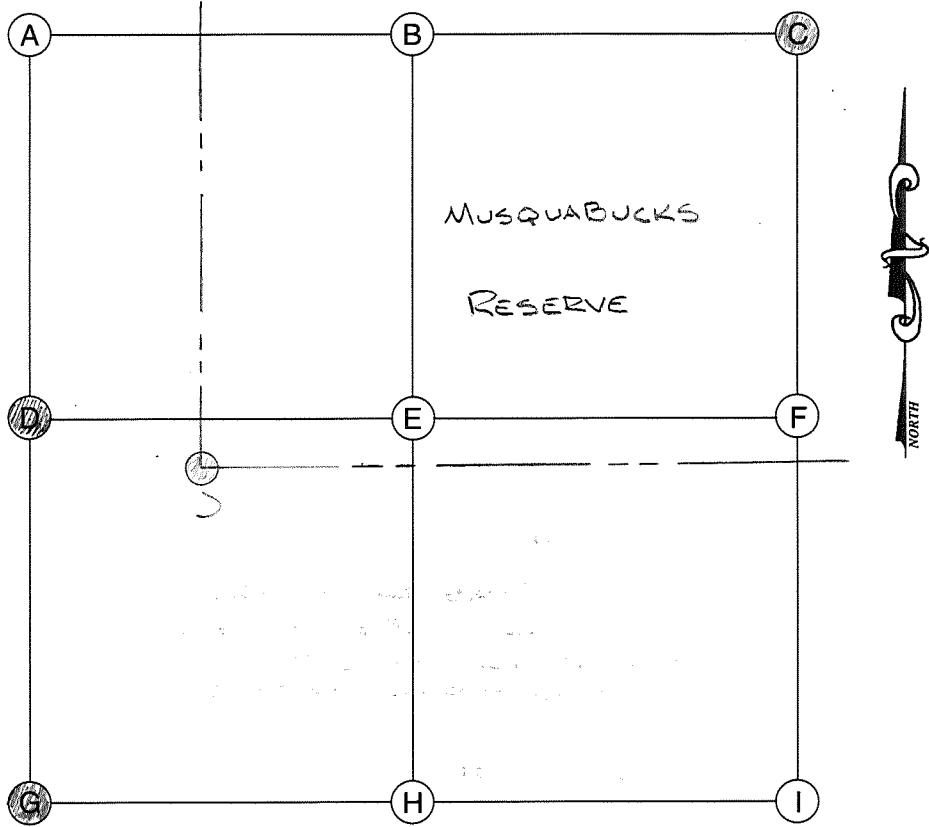

E (CENTER OF SECTION)

Date Located: _____
 By: _____
 Monument Description: _____
 Monument Witnesses: _____

 Field Book: _____ Page: _____

F (EAST QUARTER CORNER)

Date Located: _____
 By: _____
 Monument Description: _____
 Monument Witnesses: _____

 Field Book: _____ Page: _____

A (NORTHWEST CORNER)

Date Located: _____
 By: _____
 Monument Description: _____
 Monument Witnesses: _____

 Field Book: _____ Page: _____

G (SOUTHWEST CORNER)

Date Located: 4/11/16
 By: SRM
 Monument Description: FB BRONZE MONUMENT FLUSH
 Monument Witnesses: SEE Pg 257 "I"

 Field Book: 3 Page: 44

B (NORTH QUARTER CORNER)

Date Located: _____
 By: _____
 Monument Description: _____
 Monument Witnesses: _____

 Field Book: _____ Page: _____

H (SOUTH QUARTER CORNER)

Date Located: _____
 By: _____
 Monument Description: _____
 Monument Witnesses: _____

 Field Book: _____ Page: _____

C (NORTHEAST CORNER)

Date Located: 7/17/19
 By: SRM MWH
 Monument Description: PK NAIL
 Monument Witnesses: SEE Pg 255 "A"

 Field Book: 15 Page: 61

I (SOUTHEAST CORNER)

Date Located: _____
 By: _____
 Monument Description: _____
 Monument Witnesses: _____

 Field Book: _____ Page: _____

D (WEST QUARTER CORNER)

Date Located: 4/11/16
 By: SRM
 Monument Description: FB 5/8" IRON PIN 3" DEEP
 Monument Witnesses: SEE Pg 257 "F"

 Field Book: 3 Page: 43

ADDITIONAL NOTES

(S) 8/21/19 SRM MWH MAG Nail w/CO TAG FB 16 Pg 74

Plain
17-33-6

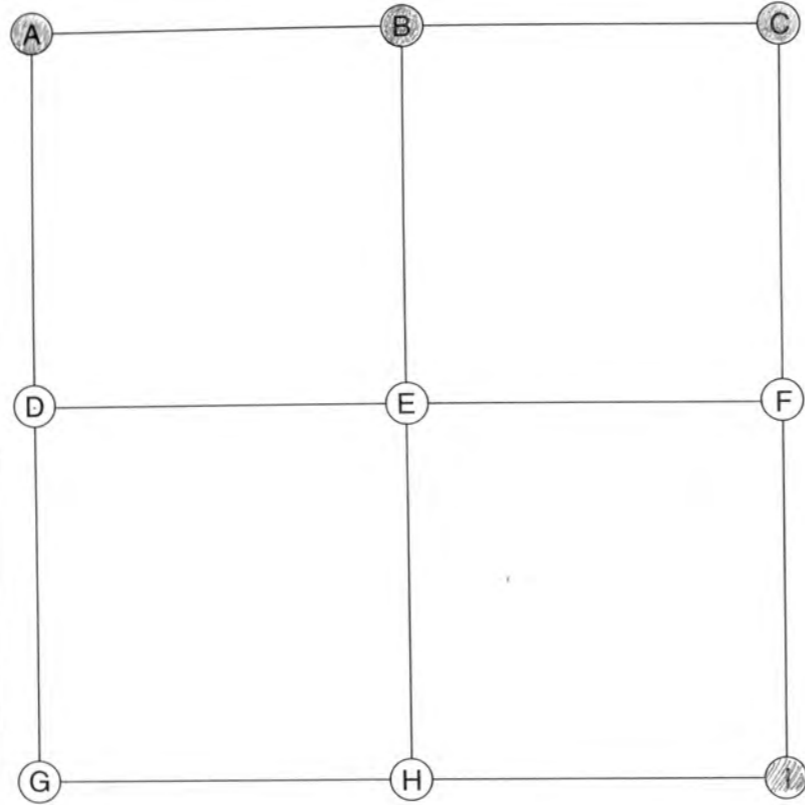

E (CENTER OF SECTION)

Date Located: _____
 By: _____
 Monument Description: _____
 Monument Witnesses: _____

 Field Book: _____ Page: _____

F (EAST QUARTER CORNER)

Date Located: _____
 By: _____
 Monument Description: _____
 Monument Witnesses: _____

 Field Book: _____ Page: _____

A (NORTHWEST CORNER)

Date Located: _____
 By: _____
 Monument Description: _____
 Monument Witnesses: SEE PAGE 249 "G"
SW 8-33-6

 Field Book: _____ Page: _____

G (SOUTHWEST CORNER)

Date Located: _____
 By: _____
 Monument Description: _____
 Monument Witnesses: _____

 Field Book: _____ Page: _____

B (NORTH QUARTER CORNER)

Date Located: _____
 By: _____
 Monument Description: _____
 Monument Witnesses: SEE PAGE 249 "H"
1/4 Post 8-33-6

 Field Book: _____ Page: _____

H (SOUTH QUARTER CORNER)

Date Located: _____
 By: _____
 Monument Description: _____
 Monument Witnesses: _____

 Field Book: _____ Page: _____

C (NORTHEAST CORNER)

Date Located: _____
 By: _____
 Monument Description: _____
 Monument Witnesses: SEE PAGE 249 "I"
SE 8-33-6

 Field Book: _____ Page: _____

I (SOUTHEAST CORNER)

Date Located: 8/31/16
 By: SR MOYER
 Monument Description: FB BRONZE MARKER
 Monument Witnesses: SEE Pg 261 "C"

 Field Book: 4 Page: 58

D (WEST QUARTER CORNER)

Date Located: _____
 By: _____
 Monument Description: _____
 Monument Witnesses: _____

 Field Book: _____ Page: _____

ADDITIONAL NOTES

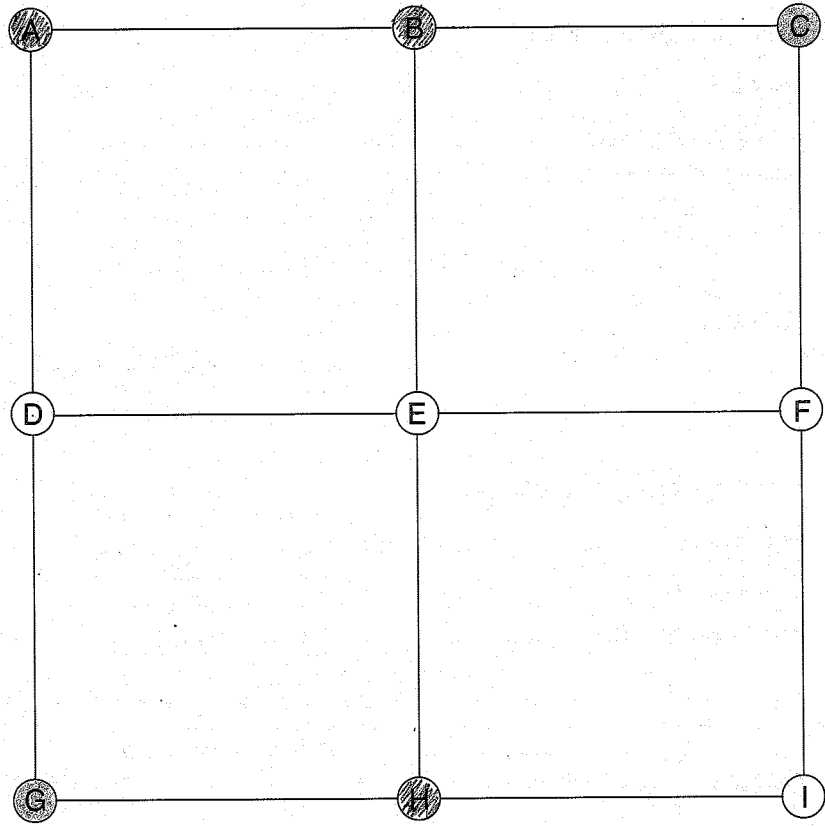

E (CENTER OF SECTION)

Date Located: _____
 By: _____
 Monument Description: _____
 Monument Witnesses: _____

 Field Book: _____ Page: _____

F (EAST QUARTER CORNER)

Date Located: _____
 By: _____
 Monument Description: _____
 Monument Witnesses: _____

 Field Book: _____ Page: _____

G (SOUTHWEST CORNER)

Date Located: _____
 By: _____
 Monument Description: _____
 Monument Witnesses: SEE PAGE 301 "C"
NE 24-33-5

 Field Book: _____ Page: _____
 STATE PLANE COORDINATES PHASE III 2/2019

A (NORTHWEST CORNER)

Date Located: 4/17/19
 By: SEM MWH
 Monument Description: PK NAIL
 Monument Witnesses: 1/2" REBAR w/CAP NW 38.53'
1/2" REBAR w/CAP NE 39.93'

 Field Book: 13 Page: 31

H (SOUTH QUARTER CORNER)

Date Located: 3/19/18
 By: SEM
 Monument Description: FO RR SPIKE
 Monument Witnesses: SEE Pg 260 "B"

 Field Book: 9 Page: 11
 STATE PLANE COORDINATES PHASE III 2/2019

B (NORTH QUARTER CORNER)

Date Located: 4/20/18
 By: SEM M4
 Monument Description: FO STONE 18" DEEP
 Monument Witnesses: 1/2" REBAR w/CAP NE 32.23'
1/2" REBAR w/CAP SE 45.27'
NAIL IN B. CAP NIPSCO POWER POLE SW 34.19'

 Field Book: 9 Page: 51
 STATE PLANE COORDINATE PHASE III 2/2019

I (SOUTHEAST CORNER)

Date Located: _____
 By: _____
 Monument Description: _____
 Monument Witnesses: _____

 Field Book: _____ Page: _____

C (NORTHEAST CORNER)

Date Located: _____
 By: _____
 Monument Description: _____
 Monument Witnesses: SEE PAGE 249 "G"
SW 8-33-6

 Field Book: _____ Page: _____
 STATE PLANE COORDINATES PHASE III 2/2019

D (WEST QUARTER CORNER)

Date Located: _____
 By: _____
 Monument Description: _____
 Monument Witnesses: _____

 Field Book: _____ Page: _____

ADDITIONAL NOTES

