

Date Located: _____
By: _____
Monument Description: _____
Monument Witnesses: SEE PAGE 104 "C"
NE 3-32-5

Field Book: _____ Page: _____

Date Located: 8/30/09
By: JD MAYER
Monument Description: 1/2" X 26" IRON PIPE WITH CAP
Monument Witnesses: 1/2" RE-BAR W/CAP NW 38.04'
NAIL WITH CAP N FACE PP ENE 41.73'
SET 1/2" REBAR W/CAP SW 42.03'
SET 1/2" REBAR W/CAP SE 41.04' 60-55 BETWEEN
REBARS

Field Book: 1 Page: 13 updated 5/13/16 SEM

Date Located: 5/17/16
By: SR MOYER
Monument Description: FO MAG NAIL FLUSH
Monument Witnesses: FO MAG NAIL W 19.92'
FACE OF SQ CONC FCP S 19.87'

Field Book: 1 Page: 13

Date Located: _____
By: _____
Monument Description: _____
Monument Witnesses: _____

Field Book: _____ Page: _____

Date Located: 3/2000
By: M. KISSINGER
Monument Description: BRONZE MARKER (PK. FD BRIMMER SET)
Monument Witnesses: SET 1/2" REBAR W/CAP 5' FROM E/P 24.10' NE
SET 1/2" REBAR W/CAP 4' FROM E/P 24.16' SE
4 RE BAR FCP 17.32' W

Field Book: 3 Page: 55

Date Located: _____
By: _____
Monument Description: _____
Monument Witnesses: SEE Pg. 317 D
WY4 POST 1-32-5

Field Book: _____ Page: _____

Date Located: _____
By: _____
Monument Description: _____
Monument Witnesses: _____

Field Book: _____ Page: _____

Date Located: 10/14/89
By: JR MOYER
Monument Description: R.R SPIKE IN 1" IRON PIPE
Monument Witnesses: END OF BRIDGE S 121.75
SET NAIL IN BOTTLE CAP IN S. FACE OF LIGHT POLE SE 67.32
" " " " " NE " WIRE OPP NW 29.80

Field Book: 1 Page: 14

Date Located: _____
By: _____
Monument Description: _____
Monument Witnesses: _____

Field Book: _____ Page: _____

ADDITIONAL NOTES

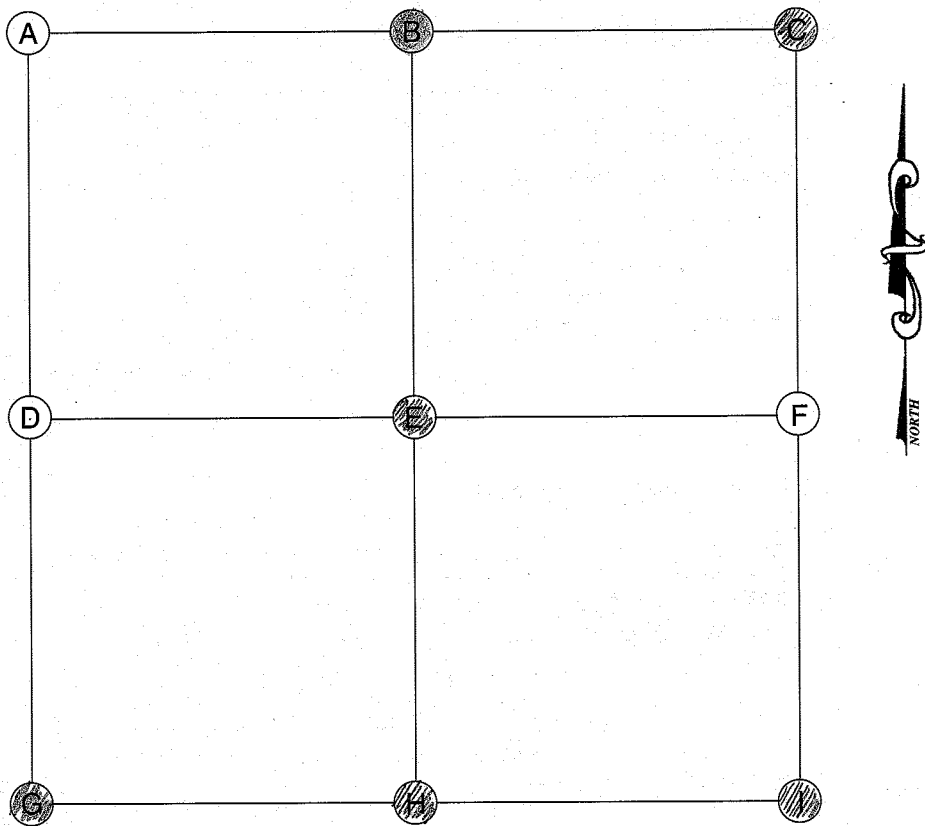

ADDITIONAL NOTES

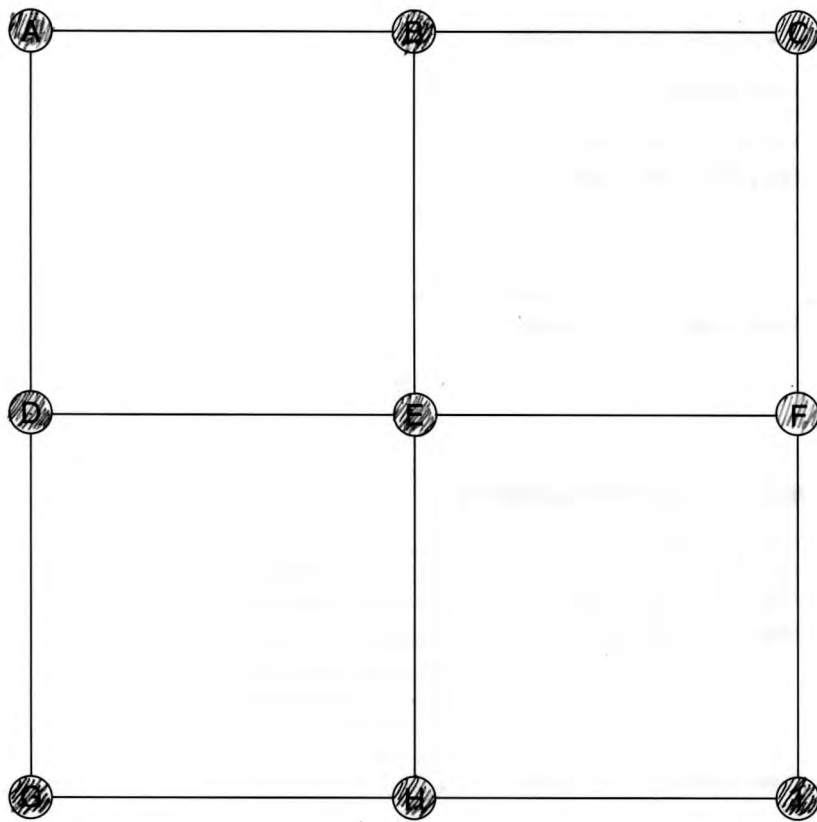

A (NORTHWEST CORNER)

Date Located: 11/23/15
By: SRM
Monument Description:
Monument Witnesses: SEE PAGE 114 "C"

Field Book: 3 Page: 29

B (NORTH QUARTER CORNER)

Date Located: 6/28/16
By: SRM
Monument Description: RR SPIKE 8" DEEP N CONC
Monument Witnesses: SEE Pg 112 "H"

Field Book: 4 Page: 25

C (NORTHEAST CORNER)

Date Located: 6/24/16
By: SRM
Monument Description: 4" GIN SPINDLE OVER RR SPIKE
Monument Witnesses: SEE Pg 519 "A"

Field Book: 4 Page: 20

D (WEST QUARTER CORNER)

Date Located: 10/2/17
By: SRM
Monument Description: FO STONE 5" DEEP
Monument Witnesses: FO NAIL IN & RD N 110.5'
1/2" REBAR W/CAP NE 28.12'
1/2" REBAR W/CAP SE 26.73'
& RR RAIL FCP W 20.07'

Field Book: 7 Page: 75

E (CENTER OF SECTION)

Date Located: 11/13/17
By: SRM
Monument Description: 4" DIA CONC FILLED STEEL FCP
Monument Witnesses:

Field Book: 8 Page: 26

F (EAST QUARTER CORNER)

Date Located: 3/17/16
By: SR MOYER
Monument Description:
Monument Witnesses: SURVEY RECORDED BOOK 4 Pg 28 & 29
CALLS FOR STONE WITH STONE WITNESS 15.18' EAST
FO OLD FENCE REMAINS

Field Book: Page:

G (SOUTHWEST CORNER)

Date Located: 10/31/16
By: SRM
Monument Description: FO 1/2" COPPER ROD FLUSH
Monument Witnesses: SEE Pg 122 "A"

Field Book: 5 Page: 25

H (SOUTH QUARTER CORNER)

Date Located: 10/31/16
By: SRM
Monument Description: FO RR SPIKE 2" DEEP
Monument Witnesses: 1/2" REBAR W/CAP NW 35.22'
N FACE OF 2" ANGLE IRON FCP S 19.5'
1/2" REBAR W/CAP SW 31.97'

Field Book: 5 Page: 24

I (SOUTHEAST CORNER)

Date Located: 10/31/16
By: SRM
Monument Description: FO 1/2" BOLT 2" DEEP
Monument Witnesses: SEE Pg 519 "G"

Field Book: 5 Page: 23

ADDITIONAL NOTES

Harrison / Wayne

23-32-5

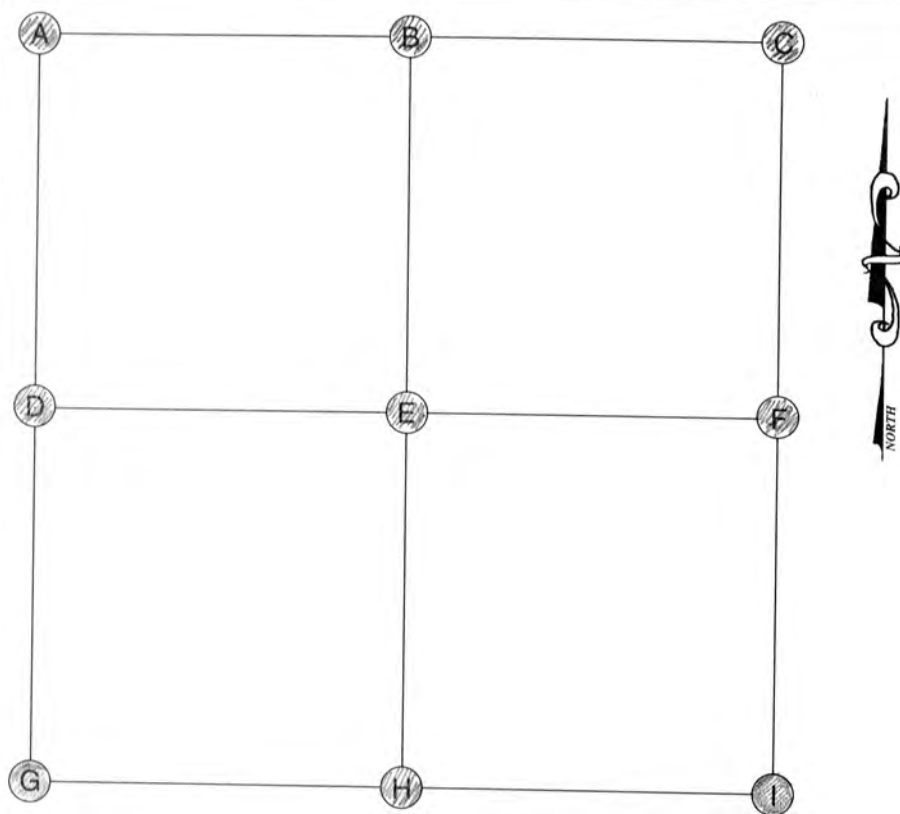

A (NORTHWEST CORNER)

Date Located: 10/31/16
 By: SRM
 Monument Description: FO 1/2" COPPER ROD FLUSH
 Monument Witnesses: PK NAIL IN REMG P. POLE NE 49.39'
1/2" REBAR W/CAP SE 38.52'
NAIL IN WASHER IN P. POLE SW 64.48'

Field Book: 5 Page: 25

B (NORTH QUARTER CORNER)

Date Located: 10/31/16
 By: SRM
 Monument Description: FO RR SPIKE 2" DEEP
 Monument Witnesses: SEE Pg 113 "H"

Field Book: 5 Page: 24

C (NORTHEAST CORNER)

Date Located: 10/31/16
 By: SRM
 Monument Description: FO 1/2" BOLT 2" DEEP
 Monument Witnesses: SEE Pg 519 "G"

Field Book: 5 Page: 23

D (WEST QUARTER CORNER)

Date Located: 6/28/17
 By: SRM
 Monument Description: RR SPIKE MAG NAIL W/TAG OVER TOP
 Monument Witnesses: RR RAIL FCP W 20.5'
1/2" REBAR W/CAP NE 45.20'
NAIL IN B. CAP IN POWER POLE ENE 68.47'
NAIL IN B. CAP IN POWER POLE SSE 49.07'

Field Book: 7 Page: 31

E (CENTER OF SECTION)

Date Located: 4/26/17
 By: SRM
 Monument Description: FO RR SPIKE SET MAG NAIL OVER
 Monument Witnesses: RR RAIL FCP N 19.15'
1/2" REBAR W/CAP NE 30.81'

Field Book: 6 Page: 69

F (EAST QUARTER CORNER)

Date Located: 4/12/17
 By: SRM
 Monument Description: FO RR SPIKE 3" DEEP
 Monument Witnesses: SEE Pg 520 "D"

Field Book: 6 Page: 59

G (SOUTHWEST CORNER)

Date Located: 6/28/17 UPDATED
 By: SRM
 Monument Description: FO MAG NAIL
 Monument Witnesses: 1/2" REBAR W/CAP NE 31.32'
FO NAIL IN B. CAP IN P. POLE ANCHOR ESE 49.93'
FO NAIL IN B. CAP IN P. POLE SW 44.31'
SET NAIL IN B. CAP IN POWER POLE NW 39.67'

Field Book: 1 Page: 72

H (SOUTH QUARTER CORNER)

Date Located: 4/26/17
 By: SRM
 Monument Description: FO RR SPIKE
 Monument Witnesses: RR RAIL FCP N 22.95'
FO NAIL IN B. CAP IN POWER POLE SE 36.81'
RR RAIL FCP S 20.16'

Field Book: 6 Page: 68

I (SOUTHEAST CORNER)

Date Located: _____
 By: _____
 Monument Description: _____
 Monument Witnesses: SEE Pg. 520 "G"
SW 24-32-5

Field Book: _____ Page: _____

ADDITIONAL NOTES

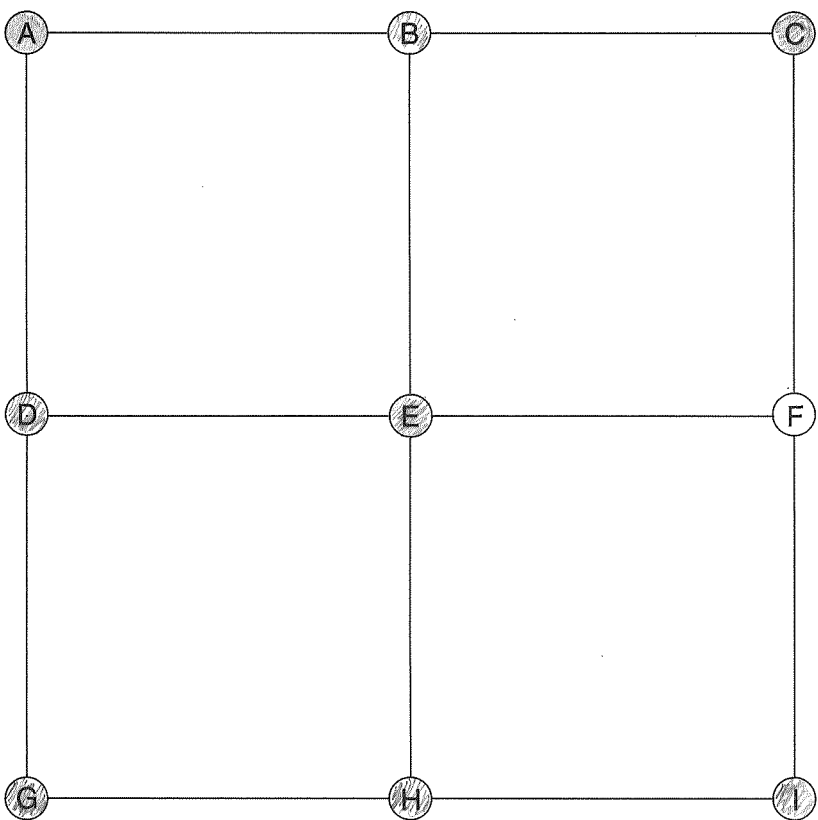

E (CENTER OF SECTION)

Date Located: 11/12/20
By: DEM MWH
Monument Description: STONE
Monument Witnesses: _____

Field Book: 19 Page: 65

F (EAST QUARTER CORNER)

Date Located: _____
By: _____
Monument Description: _____
Monument Witnesses: _____

Field Book: _____ Page: _____

A (NORTHWEST CORNER)

Date Located: _____
By: _____
Monument Description: _____
Monument Witnesses: SEE PG. 121 "I"
SE 22-32-5

Field Book: _____ Page: _____

G (SOUTHWEST CORNER)

Date Located: 6/12/19
By: DEM MWH
Monument Description: SET NAG NAIL W/ CO TAG
Monument Witnesses: 1/2" REBAR W/CAP NE 32.32'
NAIL IN B. CAP POWER POLE NE 38.43'
FO 1" IRON PIPE SW 29.31'

Field Book: 14 Page: 68

B (NORTH QUARTER CORNER)

Date Located: 4/26/17
By: DEM
Monument Description: FO RR SPIKE
Monument Witnesses: SEE PG 122 "H"

Field Book: 6 Page: 68

H (SOUTH QUARTER CORNER)

Date Located: 2/19/19
By: DEM
Monument Description: RR RAIL FCP
Monument Witnesses: SEE PG 132 "B"

Field Book: 12 Page: 2

C (NORTHEAST CORNER)

Date Located: _____
By: _____
Monument Description: _____
Monument Witnesses: SEE PG. 520 "G"
SW 24-32-5

Field Book: _____ Page: _____
STATE PLANE COORDINATES PHASE II 2/2018

I (SOUTHEAST CORNER)

Date Located: 11/12/20
By: DEM MWH
Monument Description: RR RAIL FCP
Monument Witnesses: _____

Field Book: 19 Page: 66

D (WEST QUARTER CORNER)

Date Located: 8/29/18
By: DEM
Monument Description: RR SPIKE
Monument Witnesses: 1/2" REBAR w/CAP SW 21.18'
& RR RAIL FCP W 20.0'
SE COR 1/2" FOUNDATION NW 29.04'
NAIL IN B. CAP TEL POLE SE 19.25'

Field Book: 11 Page: 7

ADDITIONAL NOTES

Harrison / Wayne
35-32-5

35-32-5

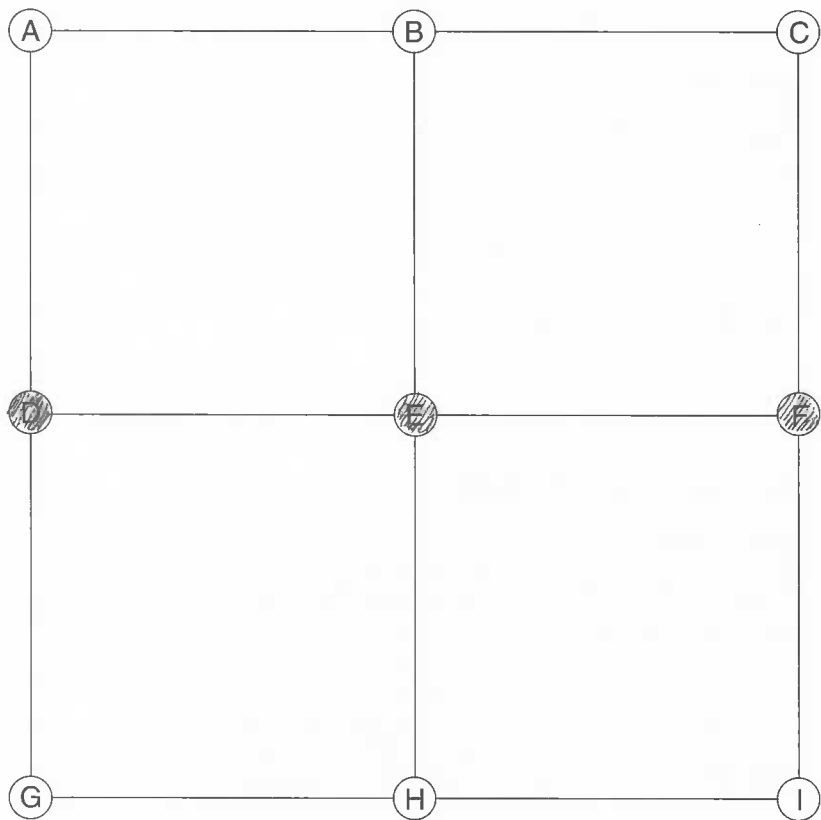

E (CENTER OF SECTION)

Date Located: 8/23/18
By: DEM
Monument Description: 5/8" REBAR
Monument Witnesses: 4 RR RAIL FGP N 20 25'
1/2" REBAR, w/CAP NE 25.38'

Field Book: 11 Page: 4

F (EAST QUARTER CORNER)

Date Located: 8/23/18
By: DEM
Monument Description: RR SPIKE
Monument Witnesses: 1/2" REBAR w/CAP NW 28.15'
4 REBAR FCP N 20.1'

Field Book: 11 Page: 3

A (NORTHWEST CORNER)

Date Located: _____
By: _____
Monument Description: _____
Monument Witnesses: _____

Field Book: _____ Page: _____

G (SOUTHWEST CORNER)

Date Located: _____
By: _____
Monument Description: _____
Monument Witnesses: _____

Field Book: _____ Page: _____

B (NORTH QUARTER CORNER)

Date Located: _____
By: _____
Monument Description: _____
Monument Witnesses: _____

Field Book: _____ Page: _____

H (SOUTH QUARTER CORNER)

Date Located: _____
By: _____
Monument Description: _____
Monument Witnesses: _____

Field Book: _____ Page: _____

C (NORTHEAST CORNER)

Date Located: _____
By: _____
Monument Description: _____
Monument Witnesses: _____

Field Book: _____ Page: _____

I (SOUTHEAST CORNER)

Date Located: _____
By: _____
Monument Description: _____
Monument Witnesses: _____

Field Book: _____ Page: _____

D (WEST QUARTER CORNER)

Date Located: 12/31/17
By: JEM
Monument Description: FD 5/8" REBAR FLUSH
Monument Witnesses: NAIL IN B. CAP IN P.Pole NW 36.52
1/2" REBAR W/CAP NE 41.43'
NAIL IN B. CAP IN P.Pole ENE 67.90'
RE BAR FCP SE 32.3'

Field Book: 8 Page: 46

ADDITIONAL NOTES

[illegible]